

# LEDiL's System reflectors

## – Versatile ecosystem for all lighting needs

LEDiL has a full ecosystem of System Reflectors available as standard parts. The ecosystem consists of three interfaces each with its own compatible families. All three ecosystems share LEDiL's philosophy of easy optical component interchangeability. Whether your choice is LENA/LENINA, MIRELLA-PF/BARBARA-PF or ANGELA/ANGELINA – we offer full luminaire configurability during the last stages of manufacturing. Each of these three systems offer optical interfaces for a range of COB's from most LED suppliers and have a full range of optics from narrow spot to wide flood. For flexible design options and a minimized time to market – design in System Reflectors.

LEDiL has qualified it's ANGELA and ANGELINA families to be used with Cree's CXA35 family of COBs together with IDEAL solderless connector. For details, go to <http://www.ledil.com/cxa35>

## LENA / LENINA

## Cree

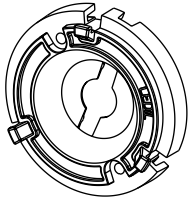

CXA15

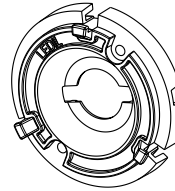
**C13186\_LENA-STD-BASE-CXA15**Diameter: 58.7 mm  
Height: 6.95 mm

CXA18

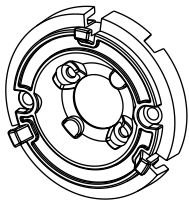
**C14146\_LENA-STD-BASE-CXA18**Diameter: 58.7 mm  
Height: 14.2 mm

CXA20

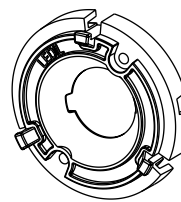
**C12105\_LENA-STD-BASE-CXA20**Diameter: 58.7 mm  
Height: 14.2 mm

CXA25

**C13324\_LENA-STD-BASE-CXA25**Diameter: 58.7 mm  
Height: 14.5 mm

## Bridgelux

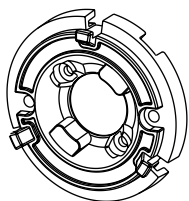

BXRA ES R

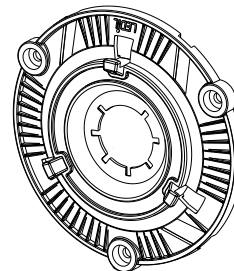
**C12153\_LENA-STD-BASE-BXRA**

Vero13

Vero18

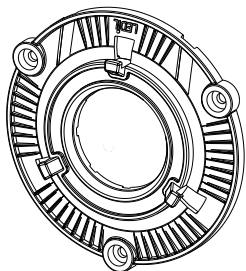
**C13868\_LENA-STD-BASE-VERO13-18**Diameter: 80 mm  
Height: 11.6 mm

BXRA RS

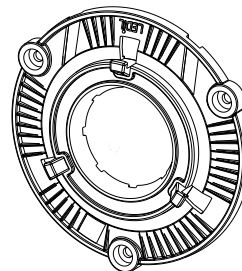
**C12229\_LENA-STD-BASE-RS**Diameter: 80 mm  
Height: 11.7 mm

Vero29

**C13867\_LENA-STD-BASE-VERO29**Diameter: 80 mm  
Height: 11.6 mm

## Sharp

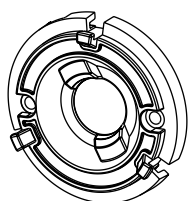

Mega Zenigata

**C12292\_LENA-STD-BASE-MEZ**Diameter: 58.6 mm  
Height: 12.8 mm

## Nichia

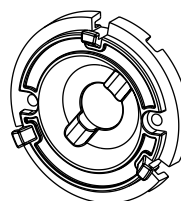

COB204

**C11981\_LENA-STD-BASE-COB-L110**Diameter: 58.6 mm  
Height: 12.8 mm

## Citizen

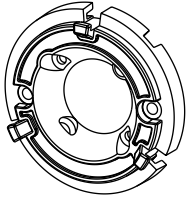

CL-L340

**C11995\_LENA-STD-  
BASE-CL340**

Diameter: 58.6 mm  
Height: 13.3 mm

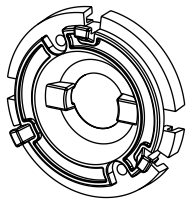

CLL030

**C12691\_LENA-STD-  
BASE-CLL030**

Diameter: 58.6 mm  
Height: 12.6 mm

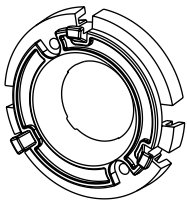

CLL040

**C12692\_LENA-STD-  
BASE-CLL040**

Diameter: 58.6 mm  
Height: 13.5 mm

## Osram

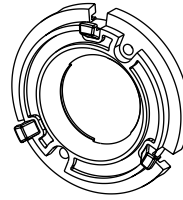

Soleriq E30

**C13088\_LENA-STD-  
BASE-E30**

Diameter: 58.7 mm  
Height: 11.9 mm

## Philips Lumileds

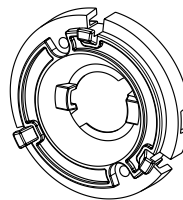

LX K12

LX K16

**C12924\_LENA-STD-  
BASE-LUXEON-K**

Diameter: 58.7 mm  
Height: 13.7 mm

## ANGELA / ANGELINA

## Cree

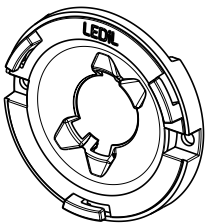

CXA15

CXA18

**C14123\_CLAMP-  
CXA15-18**

Diameter: 49,6 mm  
Height: 9.3 mm

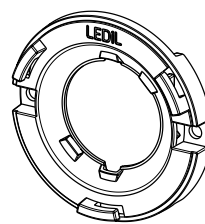

CXA25

CXA30

**C14036\_CLAMP-  
CXA25-30**

Diameter: 50 mm  
Height: 9.3 mm

## Bridgelux

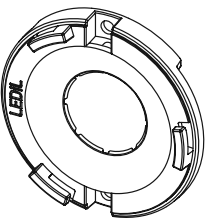

Vero13

Vero18

**C13658\_CLAMP-  
VERO13-18**

Diameter: 50 mm  
Height: 9.3 mm

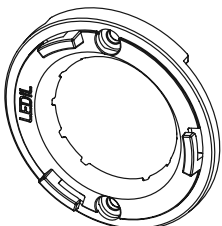

Vero29

**C13584\_CLAMP-  
VERO29**

Diameter: 53 mm  
Height: 5.5 mm

## Philips Lumileds

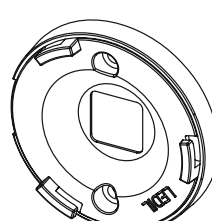

LX S2000

LX S3000

LX S5000

**C13395\_CLAMP-S2000  
C13397\_CLAMP-S3000  
C13399\_CLAMP-S5000**

Diameter: 50 mm  
Height: 10 mm

## PF-SYSTEM

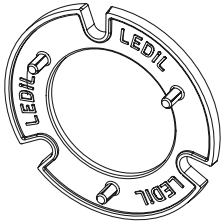

Universal

**C13083\_PF-SOCKET**

Diameter: 38 mm  
Height: 5.5 mm

## Cree

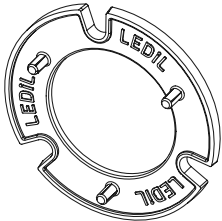

CXA15

**C13761\_PF-SOCKET-CXA15**

Diameter: 38 mm  
Height: 2.3 mm

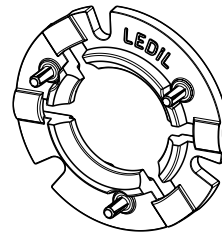

CXA15

CXA1816

**C14115\_PF-SOCKET-CXA15-18**

Diameter: 38 mm  
Height: 4.3 mm

## Bridgelux

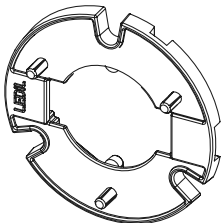

Vero10

**C13708\_PF-SOCKET-VERO10**

Diameter: 38 mm  
Height: 3 mm

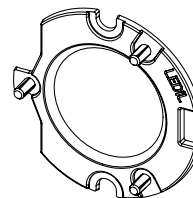

Vero13

Vero18

**C13709\_PF-SOCKET-VERO13-18**

Diameter: 38 mm  
Height: 2.2 mm

## Nichia

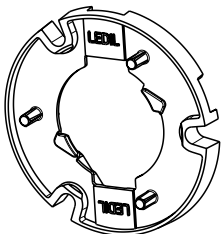

NSC x L036A

NSB x L121A

NSB x L066A

NSC x J216A

**C14037\_PF-NSX-SOCKET**

Diameter: 38.6 mm  
Height: 6.5 mm