

**FEATURES**

- With magnetic shield against radiation.
- Super low resistance with high current rating and high energy storage.
- Suitable for surface mount equipment.

**特 征**

- 磁屏蔽结构，防止高频辐射干扰；
- 超低的直流电阻及高额定电流和高能量储存；
- 适合表面贴装。

**APPLICATIONS**

- Power supply choke for small electrical equipments such as VTR,LCD display, Note book, communication equipment , OA equipments , Mother board , display card ,sound card; Power supply or MP3, MP4 , MP5,PDA ,IPAD,IPHONE, DC-DC converter DC –AC inverters etc.

**用 途**

- 录像机、液晶显示器、笔记本电脑、通讯设备、电脑主机板、声卡、显卡、办公自动化设备的电源扼流；MP3、MP4、MP5,PDA、IPAD、IPHONE,直流-直流整流器，直流-交流换流器等的电源供应器。

**ORDERING CODE**

SEB 8040 - 100 M T

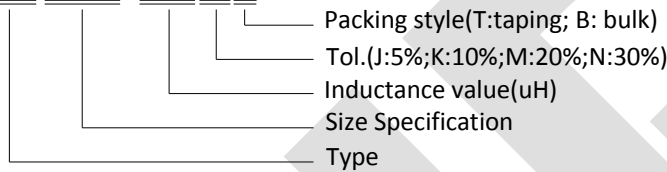

**SHAPE**

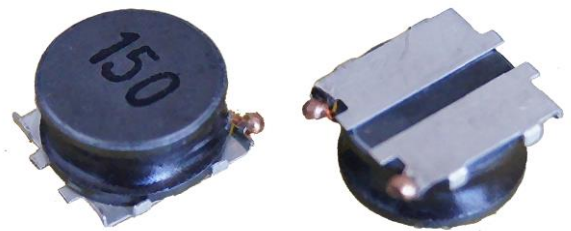

**DIMENSIONS AND LAND PATTERNS(mm)**

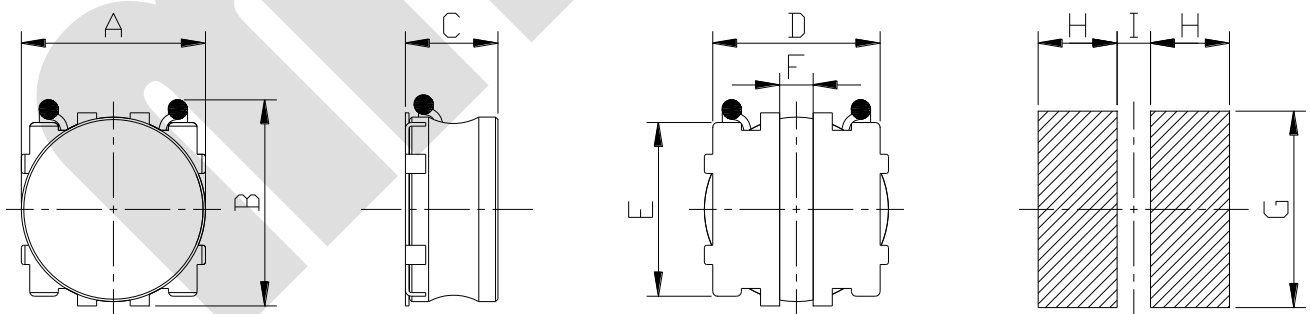

TYPE	A(Max)	B(Max)	C(Max)	D(Ref)	E(Ref)	F(Ref)	G(Ref)	H(Ref)	I(Ref)
SEB6045-	6.6	6.8	4.5	5.6	6.0	1.2	8.2	3.3	1.4
SEB8040-	8.0	8.8	4.2	7.7	8.0	1.2	8.2	3.3	1.4

**SEB6045-SERIES**

P/N	L( $\mu$ H) Inductance	Inductance Tolerance	DCR( $\Omega$ ) DC Resistance	Test Freq. KHz	Isat(A) Inductance decrease current	Idc(A) Temperature rise current
			Max		Typ.	Typ.
1R0N	1.0	$\pm 30\%$	0.017	100	8.6	6.5
1R5N	1.5	$\pm 30\%$	0.025	100	7.2	5.4
2R2M	2.2	$\pm 20\%$	0.030	100	6.4	5.1
3R3M	3.3	$\pm 20\%$	0.035	100	5.2	4.6
4R7M	4.7	$\pm 20\%$	0.040	100	4.4	4.1
6R8M	6.8	$\pm 20\%$	0.060	100	3.8	3.3
100M	10.0	$\pm 20\%$	0.075	100	3.2	3.0
150M	15.0	$\pm 20\%$	0.110	100	2.5	2.3
220M	22.0	$\pm 20\%$	0.140	100	2.1	2.0
330M	33.0	$\pm 20\%$	0.200	100	1.6	1.5
470M	47.0	$\pm 20\%$	0.300	100	1.4	1.4

**SEB8040-SERIES**

P/N	L( $\mu$ H) Inductance	Inductance Tolerance	DCR( $\Omega$ ) DC Resistance	Test Freq. KHz	Isat(A) Inductance decrease current	Idc(A) Temperature rise current
			Max		Typ.	Typ.
1R0N	1.0	$\pm 30\%$	0.012	100	9.4	7.0
1R5N	1.5	$\pm 30\%$	0.013	100	7.8	6.7
2R2M	2.2	$\pm 20\%$	0.015	100	6.7	6.2
3R3M	3.3	$\pm 20\%$	0.020	100	5.2	5.2
4R7M	4.7	$\pm 20\%$	0.025	100	4.4	4.5
6R8M	6.8	$\pm 20\%$	0.035	100	3.6	4.0
100M	10.0	$\pm 20\%$	0.048	100	3.2	3.5
150M	15.0	$\pm 20\%$	0.068	100	2.6	2.9
220M	22.0	$\pm 20\%$	0.075	100	2.2	2.5
330M	33.0	$\pm 20\%$	0.110	100	1.8	2.1
470M	47.0	$\pm 20\%$	0.160	100	1.5	1.7

Remark : Inductance decrease current: Value of inductance decrease within 30%.

Temperature rise current: A rise in temperature of core surface is within 40°C.