



Molded Case Circuit Breakers



LG Industrial Systems

META MEC

New face of LG MCCBs!

Increased Interrupting Ratings & Life
Designed for Easy Access & Installation of Accessories
Certificated according to International Standards



Up to 225A and 35kAIC AB Type Fixed Rated

- Offering economical solution with compact and increased interrupting capacities compared to the existing breakers.
- Employing a fixed thermal and fixed magnetic trip.
- Frames made of rigid materials of engineering plastics.
- 3-pole Earth leakage breakers which are physically interchangeable with 3-pole MCCBs are available.
- Offering more accessories such as rear connection and extended rotary type handles.
- KEMA certificated according to IEC60947-2.

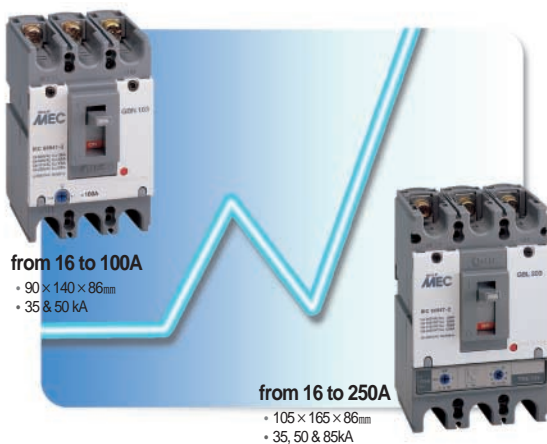

Up to 250A and 85kAIC GB Type Adjustable

- Suitable for use in the system where higher fault currents exist.
- Employing an adjustable thermal and fixed or adjustable magnetic trip.
- Current adjustments are made by knobs on the front of the trip unit.
- For applications that call for system coordinations Electronic trip breakers are also available.
- Electric auxiliaries are common use up to 250 amperes.
- KEMA certificated according to IEC60947-2.

250 to 800A and 65kAIC AB Type Rating plug

- Each breaker uses the individual rating plug for determining the continuous current rating. Rating plug is available with fixed ampere rating and the installed one is field interchangeable with the other.
- Electric auxiliaries are common use between 250 to 800 amperes.
- 3-pole Earth leakage breakers which are physically interchangeable with 3-pole MCCBs are available.
- Electronic trip breakers for system coordinations are under development.
- CE marked according to IEC60947-2.







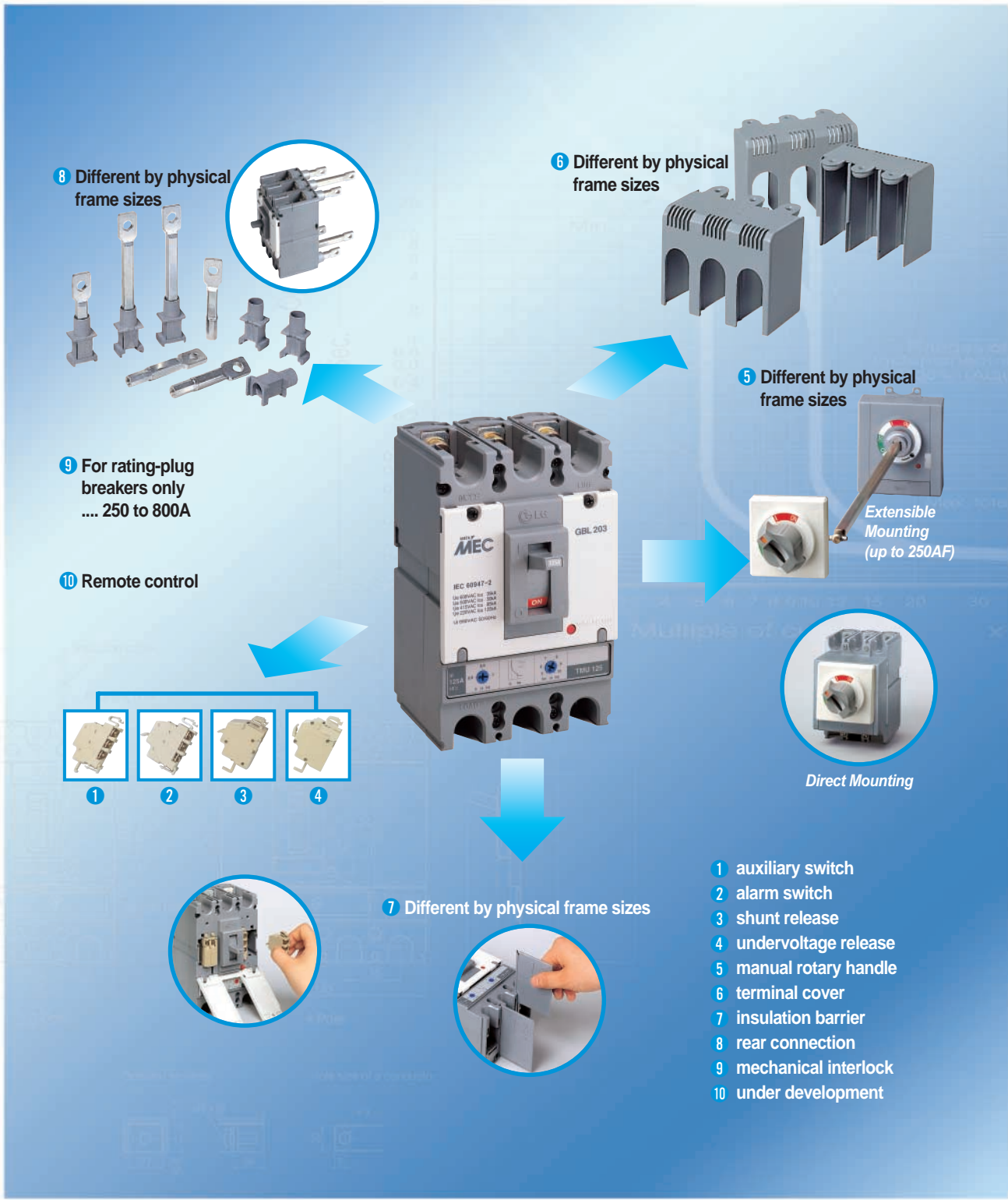

Auxiliaries & Accessories

META-MEC offers more accessories for varied applications and allows easy access to install them, especially for the electrical auxiliaries and rotary handles



Selection Table

Frame Size(AF)		30		50		60		
								
Frame Type		ABS	ABH	ABE	ABS	ABH	ABE	ABS
Breaking capacity(kA), Icu at 415Vac		5	10	5	10	25	5	10
Number of poles		2, 3	2, 3	2, 3	2, 3, 4	2, 3, 4	2, 3	2, 3, 4
Type	2 pole	ABS32b	ABH32b	ABE52b	ABS52b	ABH52b	ABE62b	ABS62b
	3 pole	ABS33b	ABH33b	ABE53b	ABS53b	ABH53b	ABE63b	ABS63b
	4 pole				ABS54b	ABH54b		ABS64b
Rated current (A) In at 40 °C		5, 10, 15, 20, 30		5, 10, 15, 20, 30, 40, 50		15, 20, 30, 40, 50	60	
Technical data conforming to IEC / EN60947-2								
Rated operational voltage(V), Ue(50 / 60Hz)		600	600	600	600	600	600	600
Rated operational voltage(V), Ue(DC)		250	250	250	250	250	250	250
Rated insulation voltage(V), Ui(50 / 60Hz)		690	690	690	690	690	690	690
Rated impulse withstand voltage(kV), Uimp		6	6	6	6	6	6	6
Ultimate breaking capacity(kA), Icu	220 / 240V	10	25	10	25	50	10	25
	380 / 415V	7.5 / 5	14 / 10	7.5 / 5	14 / 10	25	7.5 / 5	14 / 10
AC 50 / 60Hz	440 / 460V	5	10	5	10	25	5	10
	480 / 500V	2.5	7.5	2.5	7.5	14	2.5	7.5
	600V	2.5	5	2.5	5	10	2.5	5
DC	125V	5	10	5	10	20	5	10
	250V	2.5	5	2.5	5	14	2.5	5
Service breaking capacity(%Icu), Ics		50	50	50	50	50	50	50
Category of use		A	A	A	A	A	A	A
Endurance	mechanical	8500	8500	8500	8500	8500	8500	8500
(number of operations)	electrical	1500	1500	1500	1500	1500	1500	1500
Type of trip unit								
Thermal-magnetic release						fixed		
Electronic release								
Pre-alarm via LED								
Hydraulic-magnetic release		fixed	fixed	fixed	fixed		fixed	fixed
Magnetic release only (without thermal trip)								
Earth leakage protection for 3 pole		▲	▲	▲	▲	▲	▲	▲
Accessories								
Electrical auxiliaries	auxiliary switch	●	●	●	●	●	●	●
	alarm switch	●	●	●	●	●	●	●
	shunt release	●	●	●	●	●	●	●
	undervoltage release	●	●	●	●	●	●	●
External accessories	manual rotary handle	●	●	●	●	●	●	●
	terminal cover	●	●	●	●	●	●	●
	Insulation barrier	●	●	●	●	●	●	●
	rear connection	●	●	●	●	●	●	●
	mechanical interlock							
	remote control							
Dimensions (mm)	3 pole breaker	see Fig. 1		see Fig. 1		see Fig. 2	see Fig. 1	
Weight(kg)	2 pole	0.45	0.45	0.45	0.45	0.7	0.45	0.45
	3 pole	0.65	0.65	0.65	0.65	1	0.65	0.65
	4 pole				0.85	1.2		0.85

Note : ● applicable or available
 ▲ available as a separate breaker
 ※ under development

Fig. 1

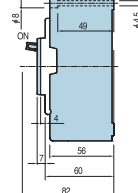
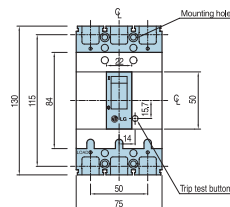
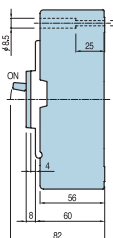
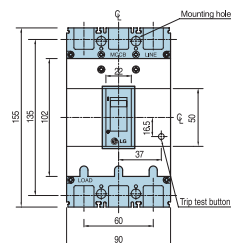

Fig. 2



100

225



ABE	ABS	ABH	GBN	GBH	GBL	ABE	ABS	ABH
10	25	35	35	50	85	18	25	35
2, 3, 4	2, 3, 4	2, 3, 4	2, 3, 4	2, 3, 4	2, 3, 4	2, 3, 4	2, 3, 4	2, 3, 4
ABE102b	ABS102b	ABH102b	GBN102	GBH102	GBL102	ABE202b	ABS202b	ABH202b
ABE103b	ABS103b	ABH103b	GBN103	GBH103	GBL103	ABE203b	ABS203b	ABH203b
ABE104b	ABS104b	ABH104b	GBN104	GBH104	GBL104	ABE204b	ABS204b	ABH204b

5, 10, 15, 20, 30, 40, 50, 60, 75, 100	15, 20, 30, 40, 50, 60, 75, 100	16, 20, 25, 32, 40, 50, 63, 80, 100 Thermally adjustable : (0.8- 0.9-1.0) × In				100, 125, 150, 175, 200, 225		
--	------------------------------------	---	--	--	--	---------------------------------	--	--

600	600	600	600	600	600	600	600	600
250	250	250	250	250	250	250	250	250
690	690	690	690	690	690	690	690	690
6	6	6	6	6	6	6	6	6
25	50	65	50	85	125	35	50	65
14 / 10	25	35	35	50	85	18	25	35
10	25	35	35	50	85	18	25	35
7.5	14	25	30 / 22	42 / 35	65 / 50	10	14	25
5	10	18	18	25	35	7.5	10	18
10	20	25				15	20	25
5	14	18	35	50	85	10	14	18
50	50	50	75	75	75	50	50	50
A	A	A	A	A	A	A	A	A
8500	8500	8500	20000	20000	10000	7000	7000	7000
1500	1500	1500	10000	10000	5000	1000	1000	1000

	fixed	fixed	adjustable-thermal, fixed-magnetic			fixed	fixed	fixed
--	-------	-------	------------------------------------	--	--	-------	-------	-------

fixed					▲			
▲	▲	▲				▲	▲	▲

●	●	●	●	●	●	●	●	●
●	●	●	●	●	●	●	●	●
●	●	●	●	●	●	●	●	●
●	●	●	●	●	●	●	●	●
●	●	●	●	●	●	●	●	●
●	●	●	●	●	●	●	●	●
●	●	●	●	●	●	●	●	●
●	●	●	●	●	●	●	●	●

see Fig. 1	see Fig. 2		see Fig. 4		see Fig. 5	see Fig. 3		
0.45	0.7	0.7	1.1	1.1	1.5	1.1	1.1	1.1
0.65	1	1	1.2	1.2	1.7	1.2	1.2	1.2
0.85	1.2	1.2	1.5	1.5	2.1	1.5	1.5	1.5

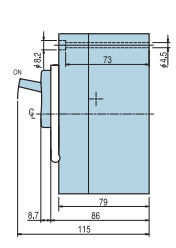
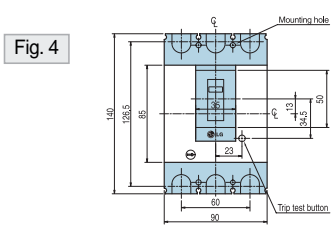
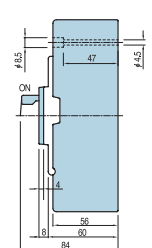
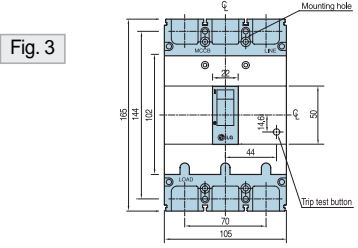



 **LG Industrial Systems Co., Ltd.**

LG constantly endeavors to improve our products, so that information in this catalog is subject to change without notice.

Miami Breaker, Inc. □

7060 NW 52nd Street, Miami FL 33166 □

Phone : (786) 336 5780 / (800) 941 1112 □

Fax : (786) 336 5790 / (888) 941 1112