

Standard Recovery Diodes (Stud Version), 16A

Features

- Diffused Series
- Industrial grade
- Available in Normal and Reverse polarity
- Metric and UNF thread type

Electrical Specifications (T_A = 25°C, unless otherwise noted)

| Symbol | Parameters | Values | Units |
|--------------------|--|--------|--------------------|
| I _{F(AV)} | Maximum avg. forward current @ T _A = 150°C | 16 | A |
| V _{FM} | Maximum peak forward voltage drop @ rated I _{F(AV)} | 1.3 | V |
| I _{FSM} | Maximum peak one cycle (non-rep) surge current @ 10 msec | 300 | A |
| I ² t | Maximum I ² t rating (non-rep) for fusing | 450 | A ² sec |



DO-203AA (DO-4)

Voltage Ratings (T_A = 25°C, unless otherwise noted)

| Type number | Voltage Code | V _{RRM} , Maximum repetitive peak reverse voltage (V) | V _{R(RMS)} , Maximum RMS reverse voltage (V) | V _R , Maximum DC blocking voltage (V) | Recommended RMS working voltage (V) | I _{RRM} , Maximum reverse leakage current (mA) |
|-------------|--------------|--|---|--|-------------------------------------|---|
| 16NS(R) | 10 | 100 | 70 | 100 | 40 | 12 |
| | 20 | 200 | 140 | 200 | 80 | |
| | 40 | 400 | 280 | 400 | 160 | |
| | 60 | 600 | 420 | 600 | 240 | |
| | 80 | 800 | 560 | 800 | 320 | |
| | 100 | 1000 | 700 | 1000 | 400 | |
| | 120 | 1200 | 840 | 1200 | 480 | |
| | 140 | 1400 | 980 | 1400 | 560 | |
| | 160 | 1600 | 1120 | 1600 | 640 | |

Thermal & Mechanical Specifications (T_A = 25°C, unless otherwise noted)

| Symbol | Parameters | Values | Units |
|---------------------|--|------------|-------|
| R _{th(JC)} | Maximum thermal resistance, junction to case | 1.5 | °C/W |
| T _J | Operating junction temperature range | -65 to 150 | °C |
| T _{stg} | Storage temperature | -65 to 150 | °C |
| F | Mounting torque (non-lubricated threads) | 1.5 ± 10% | Nm |
| W | Approximate allowable weight | 7 | g |

Package Outline

Dimensions for DO-203AA (DO-4) (in millimeters)

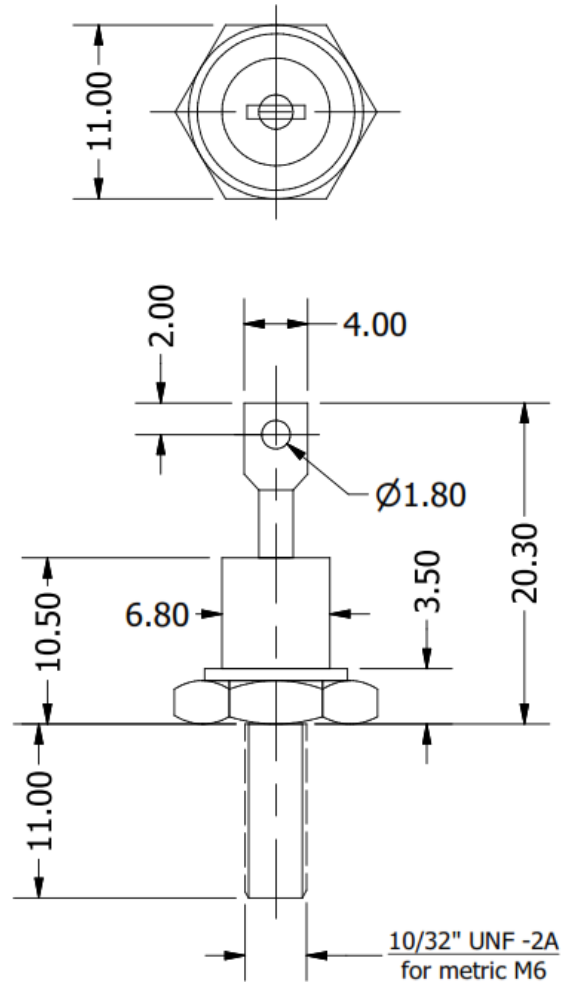

Ordering Table

| 16 | NS | R | 120 |
|----|----|---|-----|
| 1 | 2 | 3 | 4 |

1 – Current Rating = $I_F(AV)$

2 – Rectifier Diode

3 – Polarity:

> None = Normal (Cathode to Stud)

> R = Reverse (Anode to Stud)

4 – Voltage Code x 10 = V_{RRM} (See Voltage Ratings Table)