

Transducer controlled constant current regulators

Application

Constant Current Regulators (CCR) designed for supplying airport approach and runway series lamp systems.

Specifications

The regulators are constructed according to specifications given in ICAO Aerodrome Design Manual, part 5 Electrical Systems and EU technical directives.

Design

The Noratel CCRs are using Transducer technology for power control. The use of Transducers is giving a very robust system with no generation of radio frequency interference to other equipment. The CCRs are provided with Open Circuit protection, Overcurrent protection and Earth Fault Detectors. The CCRs are made for Local and Remote operation with a six steps intensity control: 0,3-1-3-10-30-100%, and are equipped with two operating hour counters for the registration of total time and 100% intensity time.

Characteristics

Supply voltages: 120-240 Volts single phase 50 Hz (60 Hz on request)
380-415 Volts two phase 50 Hz (60 Hz on request)

Power ratings: Standard: 6,6 – 12 – 16 – 20 kW output power.
Other ratings up to 20 kW on request.
Power factor better than 0,90 (uncompensated) at rated Voltage and load.

Efficiency: Ca. 92% at rated Voltage and load.

Output current: 2,5 – 6,6 Amp. (5,0 – 13,2 Amp. on request)

Output voltage: Open circuit voltage is maximum 1,4 x rated output Voltage.

Accuracy: Regulation tolerances are +/- 2% provided that the number of faulty lamps does not exceed 10% of the total figure.

Ambient conditions: The CCRs are designed for indoor installation and convection cooling at ambient temperatures between 0 and +55°C.

Dimensions in mm:

Size	Height	Width	Depth	Weight
6,6 kW	902,0	599,5	499,5	150 kg
10-20 kW	1835,0	499,5	280-340 kg	

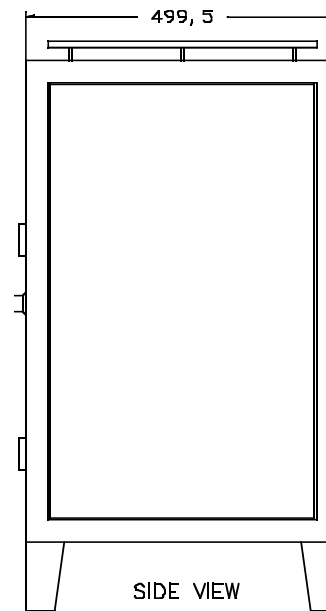

SIDE VIEW

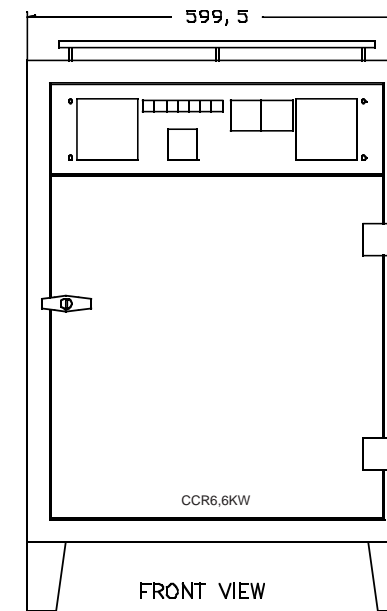

FRONT VIEW

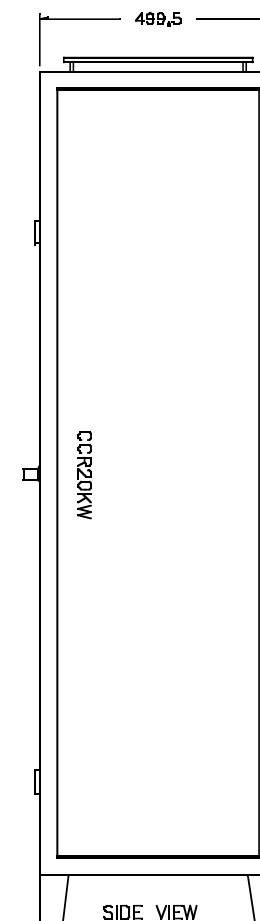

SIDE VIEW

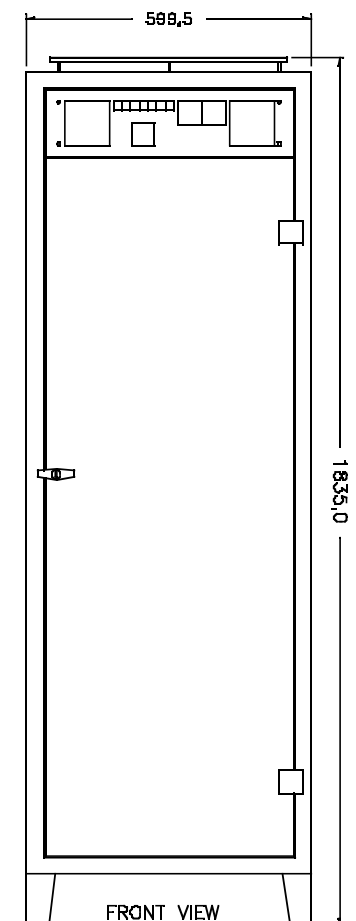

FRONT VIEW

Noratel is also producing a line of rugged isolated series transformers for use together with its CCRs.