

PD
MINI TYPE

Branch Tee

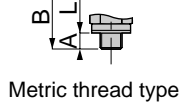

Metric thread type

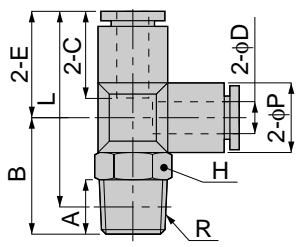

unit:mm

Model	Tube dia. φD	R	A	B	L	φP	C	E	H	Mass (g)	Orifice (φmm)	Eff. a. (mm ²)	
PD 3-M3M	3	M3×0.5	2.5	12	20.5	6.5	9.5	11	5.5	2	1.2	0.7	
PD 3-M5M		M5×0.8	3	13.5	21.5				8	4.5		2.2	
PD 3-M6M		M6×1	4	14.5	21.5				8	4.5		2	
PD 4-M3M	4	M3×0.5	2.5	15	26	8.5	11	13.5	8	4	1.2	0.9	
PD 4-M5M		M5×0.8	3	14.5	24.5					5	2.4	2.1	
PD 4-M6M		M6×1	4	15.5	24.5					5	2.5	2.2	
PD 4-01M		R1/8	8	17	26			10		7	3	4.5	
PD 6-M5M	6	M5×0.8	3	15.5	27.5	11	11.5	15	8	6	2.4	2.2	
PD 6-M6M		M6×1	4	16.5	27.5				10	8.5	3	2.5	3.3
PD 6-01M		R1/8	8	18	29				10	8.5	3	8.9	
PD 1/8-M3M	1/8	M3×0.5	2.5	15	26	8.5	11	13.5	8	4	1.2	0.9	
PD 1/8-M5M		M5×0.8	3	14.5	24.5					5	2.4	2.4	
PD 1/8-M6M		M6×1	4	15.5	24.5					5	2.5	2	
PD 1/8-01M		R1/8	8	17	26			10		7.5	3	2.5	

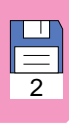

unit:inch

MODEL	Tube dia. φ D	NPT	A	B	L	φ P	C	E	H	Weight (g)	Orifice φ MM	Eff.a. mm ²	Cv
PD 1/8-U10MU	1/8	10-32UNF	0.14	0.57	0.43	0.31	0.43	0.51	5/16	4.3	2.4	2.4	0.13
PD 1/8-N1MU	1/8	1/8	0.31	0.67	0.51	0.31	0.43	0.51	7/16	8.1	2.5	2.5	0.14
PD 5/32-U10MU	5/32	10-32UNF	0.14	0.57	0.43	0.31	0.43	0.51	5/16	4.2	2.4	2.1	0.11
PD 5/32-N1MU	5/32	1/8	0.31	0.67	0.51	0.31	0.43	0.51	7/16	7.9	2.5	4.5	0.24

PY
MINI TYPE

Union Y

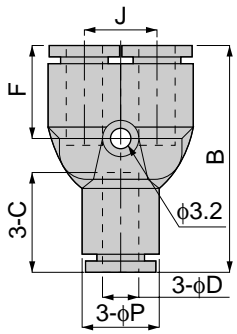

unit:mm

Model	Tube dia. φD	B	φP	C	J	F	Mass (g)	Orifice (φmm)	Eff. a. (mm ²)
PY 3M	3	28	8	9.5	8	13	3	2	2
PY 4M	4	27.5	8	11	8	12.5	3	2	2.3
PY 6M	6	31	10.5	11.5	10.5	14	5.5	3	6.8
PY 1/8M	1/8	27.5	8	11	8	12.5	3	2.5	1.1



PW
MINI TYPE

Different Dam. Union Y

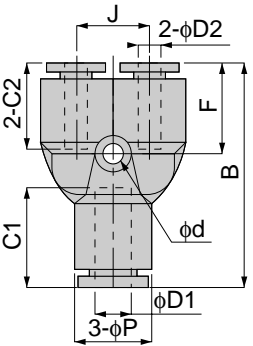

unit:mm

Model	Tube dia. φD1	Tube dia. φD2	B	φP	C1	C2	J	F	Mass (g)	Orifice (φmm)	Eff. a. (mm ²)	
PW 4-3M	4	3	27.5	8	11	9.5	8	12.5	3	1.5	2.1	
PW 4-1/8M		1/8				11				2.5	1.8	
PW 6-3M	6	3	30.5	10.5	11.5	11	10.5	13.5	5.5	2.5	2.5	
PW 6-4M		4								5	3	6.2
PW 6-1/8M		1/8								5	3	2.4
PW 1/8-3M	1/8	3	27.5	8	11	9.5	8	12.5	3	1.5	1.7	

