

ELECTRICAL OPTIONS/ SPECIFICATIONS

OUTPUT SUPPLY  
 CODE 'A' 0.5 TO 4.5V RATIO METRIC 5V  
 SUPPLY CURRENT 12mA TYP. 20mA MAX.

CABLE LENGTH, OPTION 'Lxx', ORDERED IN cm, 50cm STANDARD OR AS REQUIRED;  
 3-CORE SCREENED: 0.2mm<sup>2</sup>, ø4mm PUR JACKET

CABLE/CONNECTOR CONNECTIONS;

3 CORE PINS  
 RED '1' +Ve  
 BLACK '2' 0V  
 WHITE '3' OUTPUT  
 SCREEN BODY

RANGE OF DISPLACEMENT FROM 30° TO 140°, IN INCREMENTS OF 1°.

BODY MATERIAL:- ALUMINIUM ALLOY.

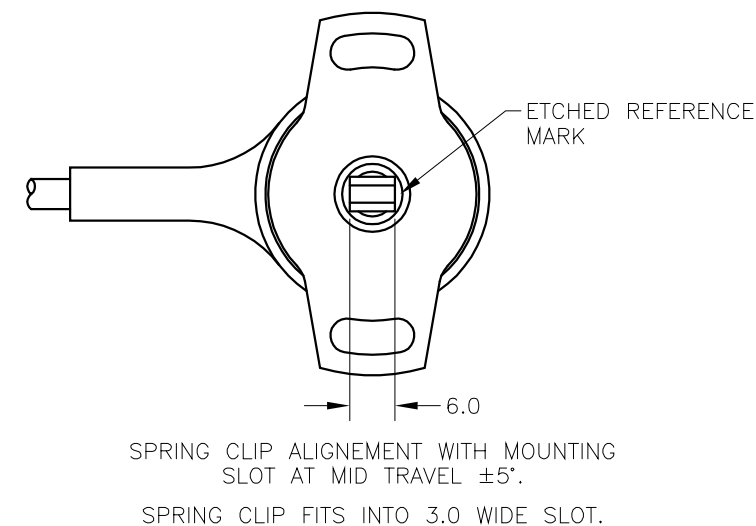
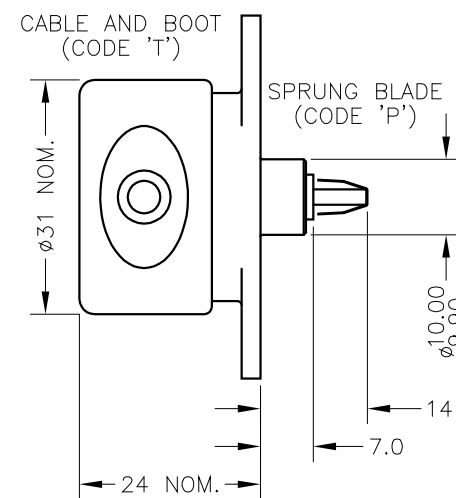
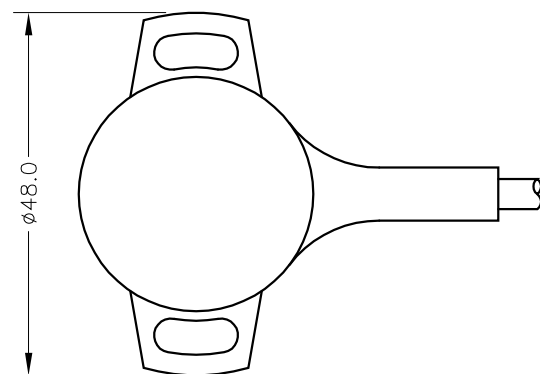
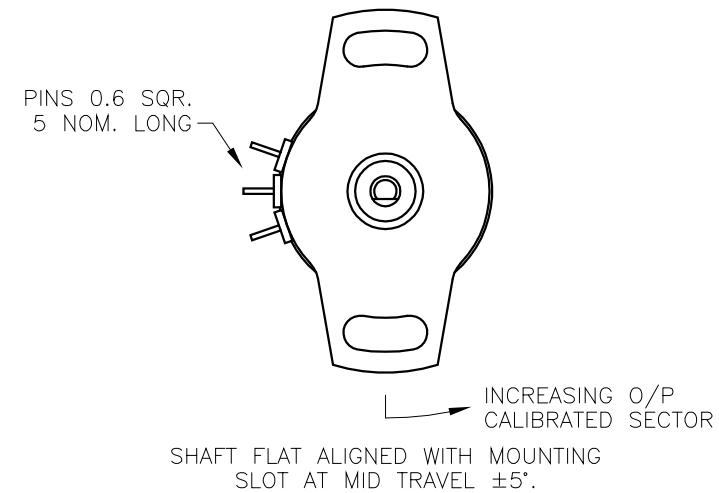
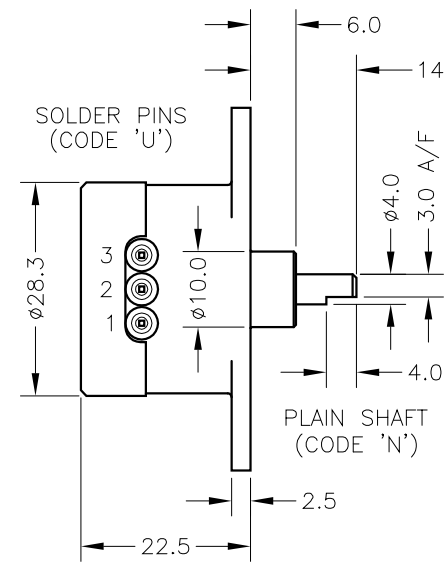
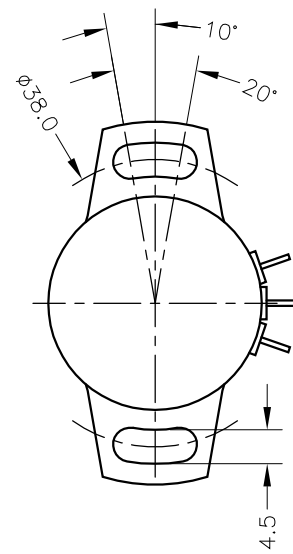

H	REDRAWN	PDM
I	BOSS Ø10.00 ADDED	PDM
J	ADDITIONAL DIMS/VIEWS ADDED.	PDM

DRAWINGS NOT TO BE CHANGED WITHOUT REFERENCE TO THE CHANGE PROCEDURE.  
 CHANGES TO PARTS USED IN INTRINSICALLY SAFE PRODUCT MUST BE APPROVED  
 BY THE AUTHORISED PERSON  
 THIS IS AN UNCONTROLLED PRINT AND WILL NOT BE UPDATED.

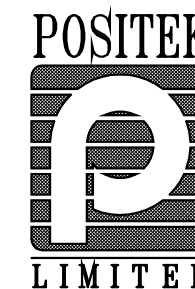

H	19/10/06		CHECKED BY	X	±0.4
I	15/01/09		RDS	X.X	±0.2
J	06/07/11			X.XX	±0.1
DESCRIPTION					DIMS mm
P501 RIPS MINIATURE ROTARY SENSOR					
SCALE	10mm	DRAWING NUMBER	P501-11	REV	J
					SHEET 1 OF 1