

GAIN AND OFFSET ADJUSTMENTS SEALED (CODE 'Y')

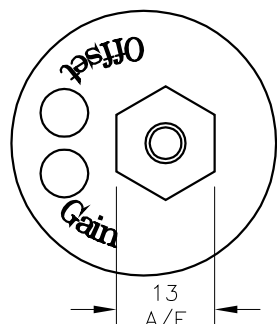

IP67 SHORT CABLE GLAND (CODE 'Mxx')

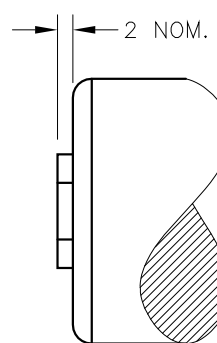

NOTE: SENSORS WITH TRAVEL UP TO 50mm ARE MADE IN STANDARD LENGTHS.

TRAVEL: (mm)	BODY LENGTH: (mm)		
2 - 10	10	STANDARD	'Y' FLANGE
11 - 20	20	65.0	81.3
21 - 30	30	75.0	91.3
31 - 50	50	85.0	101.3
		105.0	121.3

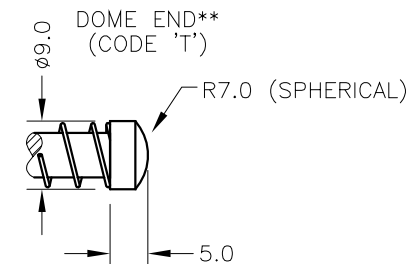

ELECTRICAL OPTIONS/ SPECIFICATIONS

OUTPUT OPTION	OUTPUT	SUPPLY	
A	0.5 TO 4.5V RATIO METRIC	5V	STANDARD
B	±5V	±15V	
C	0.5 TO 9.5V	24V	
D	±10V	±15V	BUFFERED
E	0.5 TO 4.5V	24V	
F	SUPPLY CURRENT 12mA TYP. 20mA MAX.	24V	
G	4 TO 20mA 2-WIRE	24V	
H	4 TO 20mA 3-WIRE SINK	24V	
	4 TO 20mA 3-WIRE SOURCE	24V	

SINK VERSION OUTPUT COMPLIANCE 5-28V
SOURCE VERSION DRIVE 300Ω MAX TO 0V

CABLE LENGTH, OPTIONS 'Lxx' OR 'Mxx', ORDERED IN cm, 50cm STANDARD OR AS REQUIRED.

3-CORE SCREENED: 0.2mm², ø4mm PUR JACKET
4-CORE SCREENED: 0.2mm², ø4.6mm PUR JACKET

CABLE/CONNECTOR CONNECTIONS*;
3 CORE 4 CORE CONNECTOR

RED	RED	:1	+Ve
BLACK	GREEN	:3	0V
	YELLOW	:4	-Ve - OPTIONS: B OR D
WHITE	BLUE	:2	OUTPUT
SCREEN	SCREEN	:4	BODY - OPTIONS: A, C, E-H

*CONNECTORS; MAXIMUM CONDUCTOR CROSS SECTION 0.75mm²
RANGE OF DISPLACEMENT FROM 2mm TO 50mm, IN INCREMENTS OF 1mm.

BODY MATERIAL: STAINLESS STEEL.
FLANGE MATERIAL: ALUMINIUM (CODE 'N')

FURTHER OPTIONS:

SINGLE PAIR OF BODY CLAMPS (CODE 'P')

SPRUNG PLUNGER, TO EXTENDED POSITION (CODE 'R')

DOMED END (CODE 'T') IN CONJUNCTION WITH SPRUNG PLUNGER (CODE 'R')**

PLUNGER FREE (CODE 'V')

N.b. NOT AVAILABLE WITH SPRUNG OPTIONS.

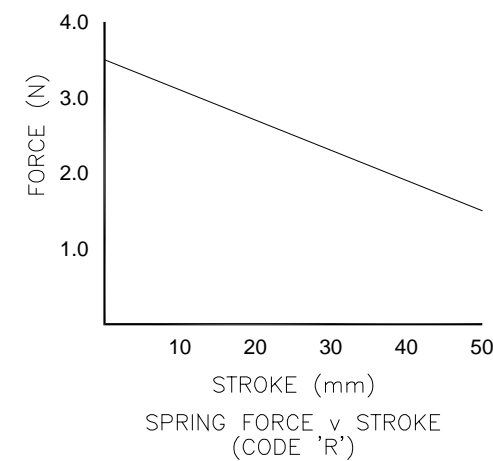

L	1.5-3.5N WAS 0.25-1.25N - RAN449.	PDM
M	CALIBRATION START MOVED -0.5 - RAN449	PDM
N	STROKE NOTES AMENDED.	PDM
O	STANDARD VERSION AMENDED - RAN467.	PDM
P	STROKE 2-10 WAS 10 - RAN1063	PDM

THE PLUNGER RETRACTS 5mm FROM START OF CALIBRATED TRAVEL (2mm FOR SPRUNG VERSIONS) AND EXTENDS 9.5mm* BEYOND END OF MECHANICAL TRAVEL. *DOES NOT INCLUDE DIFFERENCE BETWEEN CALIBRATED AND MECHANICAL TRAVEL, DIMENSIONS ARE NOMINAL. 'V' CODED PLUNGER WILL DEPART SENSOR BODY.

DRAWINGS NOT TO BE CHANGED WITHOUT REFERENCE TO THE CHANGE PROCEDURE.
CHANGES TO PARTS USED IN INTRINSICALLY SAFE PRODUCT MUST BE APPROVED BY THE AUTHORISED PERSON
THIS IS AN UNCONTROLLED PRINT AND WILL NOT BE UPDATED.

POSITEK
P
LIMITED

L	21/10/13	CHECKED BY PDM	X	±0.4
M	23/10/13		X.X	±0.2
N	21/11/13		X.XX	±0.1
O	10/12/13	DESCRIPTION		DIMS mm
P	10/11/15	P103 LIPS SHORT STROKE LINEAR POSITION SENSOR		
SCALE 10mm		DRAWING NUMBER P103-11	REV P	
		SHEET 1 OF 1		