

N.b. ROD-EYE ORIENTATION NOT GUARANTEED.

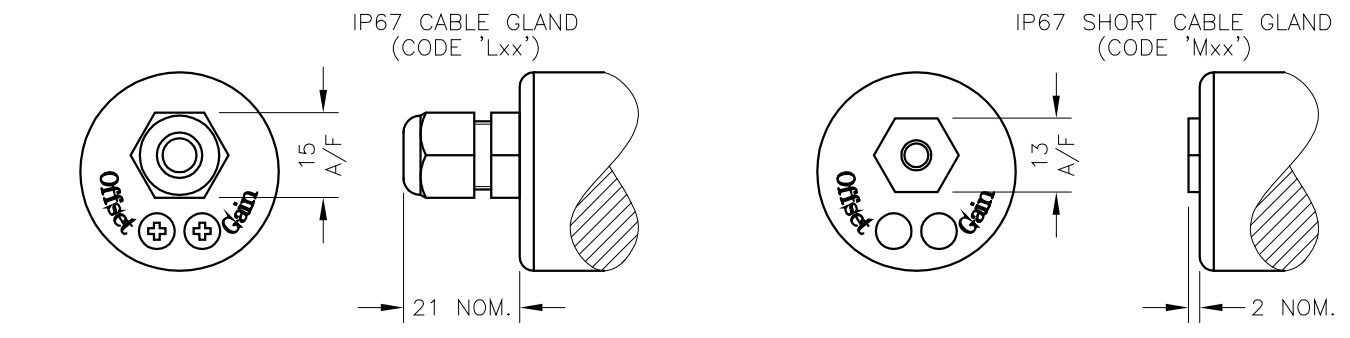
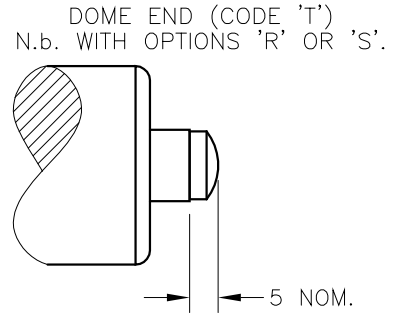
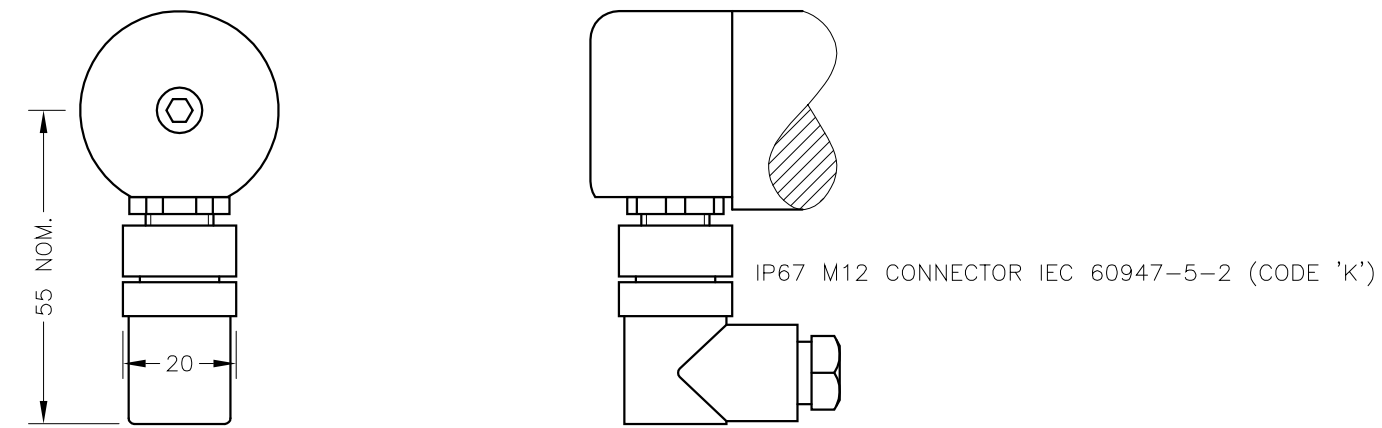
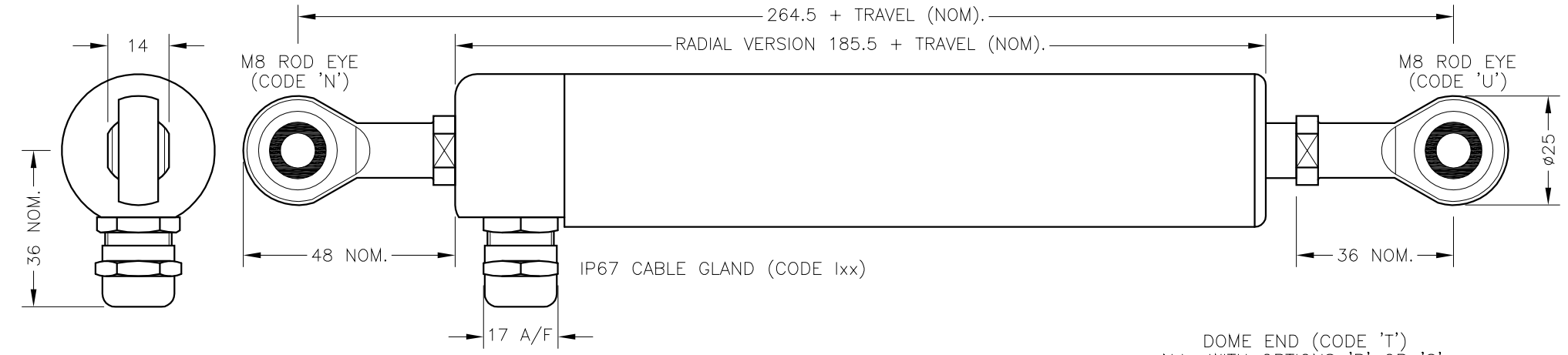
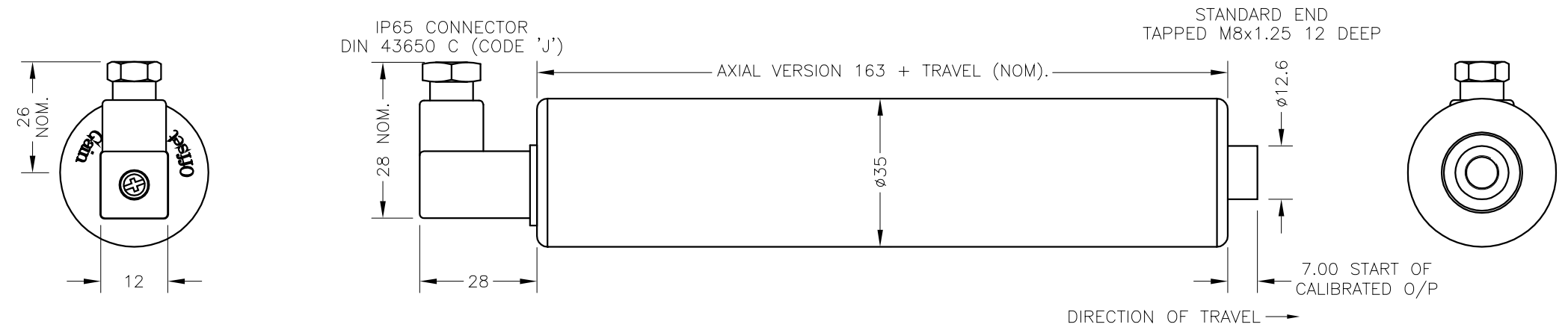

ELECTRICAL OPTIONS/ SPECIFICATIONS

OUTPUT OPTION	OUTPUT		SUPPLY		STANDARD
	A	B	5V	±15V	
C	0.5 TO 4.5V RATIO METRIC		24V		}
D	±5V		±15V		
E	0.5 TO 9.5V		24V		}
F	±10V		±15V		
G	0.5 TO 4.5V		24V		}
H	SUPPLY CURRENT 12mA TYP.	20mA MAX.	24V		
	4 TO 20mA 2-WIRE		24V		}
	4 TO 20mA 3-WIRE SINK		24V		
	4 TO 20mA 3-WIRE SOURCE		24V		

SINK VERSION OUTPUT COMPLIANCE 5-28V
SOURCE VERSION DRIVE 300Ω MAX TO 0V

CABLE LENGTH, OPTIONS 'Ixx', 'Lxx' OR 'Mxx', ORDERED IN cm, 50cm STANDARD OR AS REQUIRED.

3-CORE SCREENED: 0.2mm², Ø4mm PUR JACKET
4-CORE SCREENED: 0.2mm², Ø4.6mm PUR JACKET

CABLE/CONNECTOR CONNECTIONS*;
3 CORE 4 CORE CONNECTOR
RED RED :1 +Ve
BLACK GREEN :3 0V
YELLOW :4 -Ve - OPTIONS: B OR D
WHITE BLUE :2 OUTPUT
SCREEN SCREEN :4 BODY - OPTIONS: A, C, E-H

*CONNECTORS; MAXIMUM CONDUCTOR CROSS SECTION 0.75mm²
RANGE OF DISPLACEMENT FROM 5mm TO 800mm, IN INCREMENTS OF 1mm.

BODY MATERIAL: STAINLESS STEEL.
FURTHER OPTIONS:
SINGLE PAIR OF BODY CLAMPS 'P'
TWO PAIRS OF BODY CLAMPS 'P2'
SPRING RETURN PUSH-ROD, TRAVEL ≤300mm
RETURN TO EXTENDED POSITION (CODE R)
RETURN TO RETRACTED POSITION (CODE S)
PUSH-ROD FREE (CODE 'V') - NOT AVAILABLE WITH SPRUNG OPTIONS.

GAIN AND OFFSET ADJUSTMENTS NOT AVAILABLE WITH RADIAL BODY, CODE 'Ixx' AND 'K', OPTIONS.

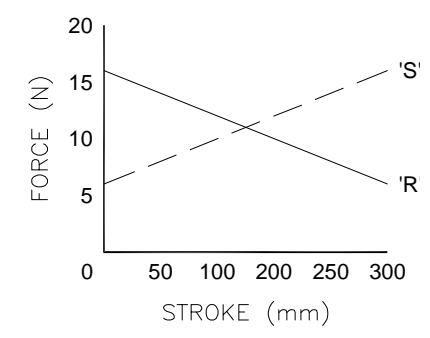

THE PUSH-ROD RETRACTS A FURTHER 4mm NOM. FROM START OF CALIBRATED TRAVEL. STANDARD VERSIONS THE PUSH-ROD EXTENDS A FURTHER 8mm NOM. FROM END OF CALIBRATED TRAVEL, FOR SPRUNG VERSIONS: 'R': 1mm, 'S': 2mm. 'V' CODED PUSH-ROD WILL DEPART SENSOR BODY.

I	ADDITIONAL DIMS/VIEWS ADDED.	PDM
J	RADIAL ENDCAP MODIF'D - RAN 335	PDM
K	SPRUNG OPTIONS 300 WAS 250 - RAN 473.	PDM
L	OPTIONS 'R' & 'S' OVER TRAVEL DIMS MODIFIED - RAN1030.	PDM
M	RANGE WAS 50-600mm RAN1056	RDS

DRAWINGS NOT TO BE CHANGED WITHOUT REFERENCE TO THE CHANGE PROCEDURE. CHANGES TO PARTS USED IN INTRINSICALLY SAFE PRODUCT MUST BE APPROVED BY THE AUTHORISED PERSON
THIS IS AN UNCONTROLLED PRINT AND WILL NOT BE UPDATED.

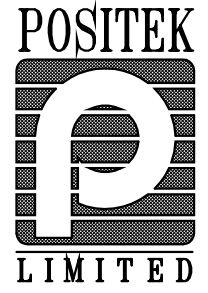

I	05/07/11	CHECKED BY PDM	X	±0.4
J	08/03/13		X.X	±0.2
K	08/04/14		X.XX	±0.1
L	28/07/15	DESCRIPTION		
M	9/11/15	P111 LIPS RUGGED STAND ALONE LINEAR POSITION SENSOR		
SCALE 13mm		DRAWING NUMBER P111-11	REV M	
				SHEET 1 OF 1