

Datasheet

Fiber delivery system accessory opto-mechanics - laserPLATE

Qioptiq has introduced a series of accessories for the kineFLEX™ range of laser to fiber couplers that now make fiber to laser alignment easier than ever. With the introduction of the laserPLATE™, users can now buy a complete mechanical mounting and packaging system for the Compass™, Sapphire™ and Cube™ range of OEM lasers from Coherent®. All optical and mechanical alignment and mounting considerations are resolved with the laserPLATE and users now only need take care of the fiber output to the application.

The system comprises a combined heatsink and chassis to house the laser; including pre-fitted dowels and fixings specifically positioned for the Compass DPSS, Sapphire OPSL and Cube diode lasers. Once the laser head is fixed in the chassis, the controller module is easily connected directly to the laser through an open access in the chassis. Finally a lid is provided to complete the laser housing.

The laserPLATE is only sold in conjunction with a kineFLEX fiber beam delivery system and is shipped already pre-fitted with the 4-axis fiber manipulator. Final laser to fiber alignment is then performed in the usual straightforward manner using the kineFLEX fiber beam delivery system.

Other OEM laser packaging solutions are available from Qioptiq. Please call for details.

Coherent, Sapphire, Compass and Cube are all trademarks of Coherent Inc.

Some of the product features include:

- Combined laser chassis and heatsink design
- Ease of integration and alignment
- Pre-fitted dowels and fixings for accurate positioning
- Opto-mechanically stable enclosure design
- Fully compatible with Qioptiq's kineFLEX range
- Integrated kineMATIX-P2™ manipulator



Technical Specifications

Product line		Units
Sapphire A		
Wavelength	488	nm
Power range	10 - 50	mW
Compatible models	488 LP	-
Compass A		
Wavelength	532, 561	nm
Power range	10 - 150	mW
Compatible models	215, 315, 561	-
Cube		
Wavelength	405, 445, 635, 660	nm
Power range	8 - 60	mW
Compatible models	405, 455, 635, 660	-

Note: OEM versions available please call

Sapphire

Order code: laserPLATE -

Product line: Compass, Cube, Sapphire

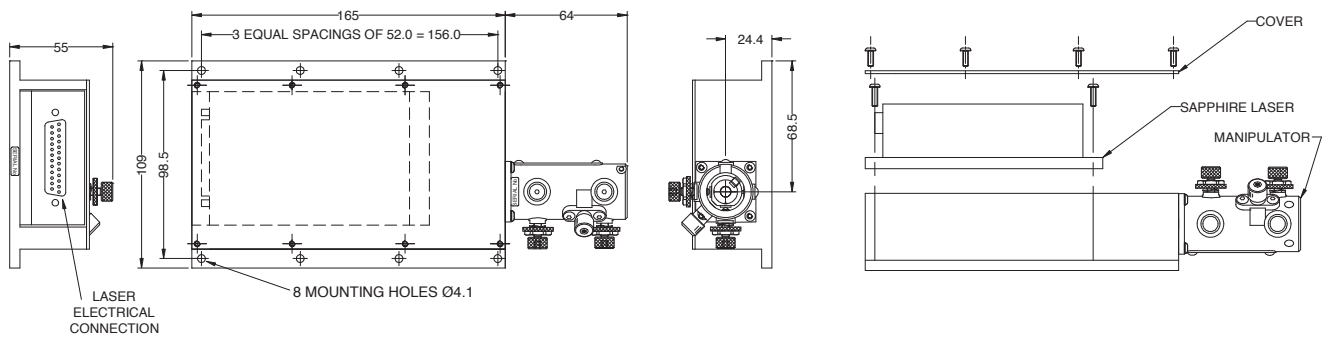

Compass

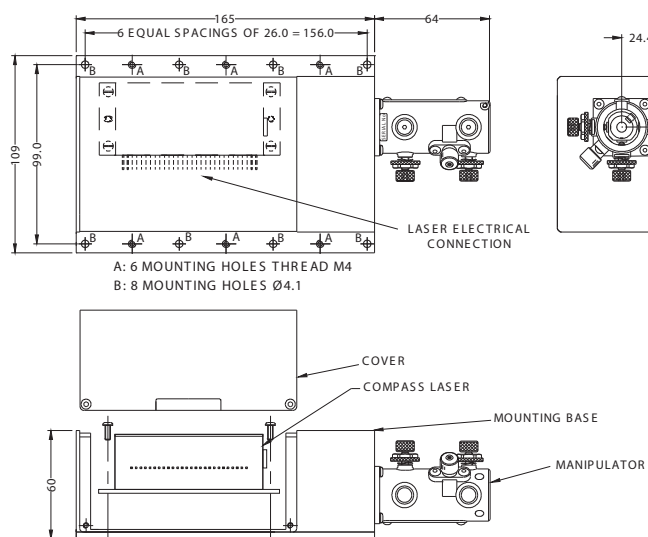

Cube

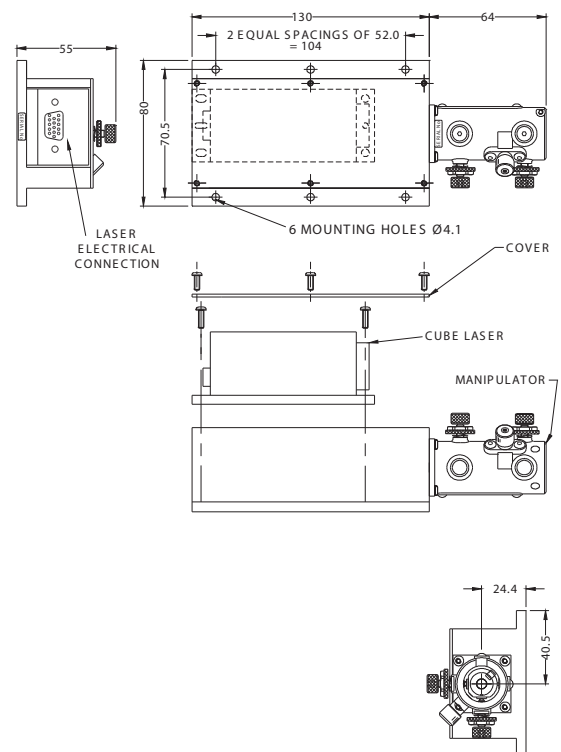

Fiber Optics



kineFLEX™

Robust laser beam delivery system for precision measurement applications

- Fiber coupling for DPSS, diode and gas lasers
- Highly repeatable and stable operation
- Greater than 65% coupling efficiency



kineFLEX-HPV™ / kineFLEX-UV™

Robust high power laser beam delivery system for precision measurement applications

- Input power up to 500mW for 488nm or higher
- Input power up to 20mW for 375nm
- OEM multiple wavelength versions available



kineFLEX-DUO™

Robust laser beam delivery system for two laser sources at visible wavelengths

- Efficient and simple beam combination
- Visible wavelengths
- Rugged platform for industrial applications

Lasers



iFLEX2000™

Extremely reliable and robust fiber coupled laser designed for volume manufacturing

- UV, Visible and NIR Wavelengths
- Integrated drive and temperature control electronics
- Modular singlemode fiber delivery system



iFLEX-Mustang™

Fiber coupled solid state laser with on-board acousto-optic modulation

- DPSS lasers, 488, 532 and 561nm
- High long term stability and low noise
- 25mW of output power



iFLEX-Q3™

Compact laser diode system for precision optical instrumentation

- Exceptional brightness, stability and long-term reliability
- Highly polarized beam
- Versatile, small form laser head and remote electronics module

Engines

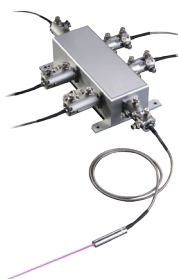

iFLEX-Adder™

5 into 1 fiber-coupled laser beam combination system

- True 'Plug & Play' capability enabling ultimate flexibility of laser suite
- Upgradeable from 2 to 5 wavelengths as required
- Compatible with kineFLEX™ and kineFLEX-HPV™



iFLEX-Viper™

The world's first integrated Multi-laser Engine

- Combines 5 wavelengths in one instrument
- Delivers wavelengths via a singlemode fiber optic cable
- On-board acousto-optic modulation up to 3MHz

For further information please contact:

Mitchell Point, Ensign Way, Hamble, Hampshire, SO31 4RF
Email: sales@qpl.qioptiq.com
Tel: +44 (0) 23 80 744 500 Fax: +44 (0) 23 80 744 501
www.qioptiq.com



www.qioptiq.com/diode-lasers
www.qioptiq.com/fiber-optics

laserPLATE™ is a trademark of Qioptiq Photonics Ltd. Copyright ©2011 Qioptiq Photonics Ltd.
Qioptiq Photonics Ltd. follows a policy of continuous improvement. Specifications are subject to change without notification.