

PERFORMANCE SPECIFICATIONS:

Part Number: RPT300-10
 Frequency: DC-4.0GHz
 VSWR (Max): 1.10:1 DC to 1.5 GHz
 1.35:1 1.5 to 4.0 GHz

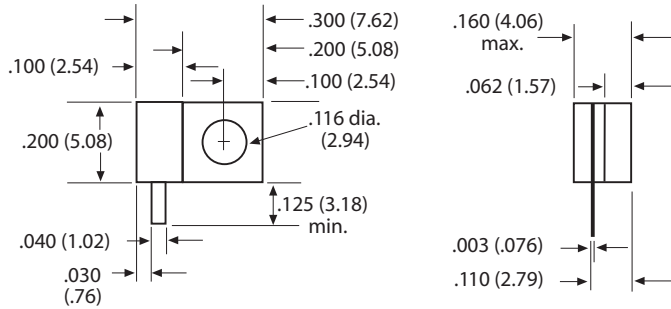

10 Watts (1KW Peak)

PERFORMANCE SPECIFICATIONS:

Part Number: RPT301-10
 Frequency: DC-4.0GHz
 VSWR (Max): 1.10:1 DC to 1.5 GHz
 1.35:1 1.5 to 4.0 GHz

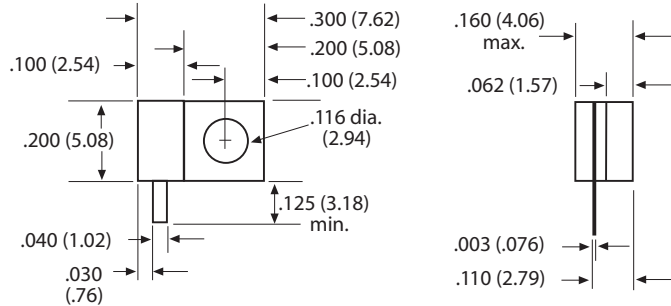

10 Watts (1KW Peak)

PERFORMANCE SPECIFICATIONS:

Part Number: RPT500-12
 Frequency: DC-4.0GHz
 VSWR (Max): 1.10:1 DC to 1.5 GHz
 1.35:1 1.5 to 4.0 GHz

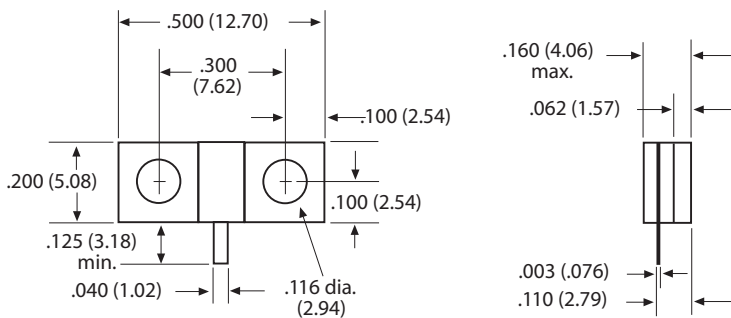

12 Watts (1KW Peak)