



1225 Isley Road, Gastonia, NC  
28052  
Phone: [800-634-7704](tel:800-634-7704) Fax:  
800-253-6634  
[www.rwmcasters.com](http://www.rwmcasters.com)

# 2-76 Series Kingpinless™ Casters

*Kingpinless™ Dual Wheel Casters*

RWM's 2-76 Series Kingpinless™ Dual Wheel Casters feature all of the benefits of our patented Kingpinless™ raceway and offer twice the capacity load.

Our 2-76 Series Casters are proudly made in the USA! Log in below to download CAD drawings of this caster.

Dual wheel rigid casters top plates utilize a larger surface area on many sizes to accommodate the width of the wheels and leg spacing required. These casters will utilize special top plates combining the adapter plate and mounting plate together in one plasma cut component which look like this ([DOWNLOAD](#)). Dimensions stated as top plate size on these pages are the general outside dimensions of the standard plate when these tabs are not necessary such as on small sizes. Please contact the factory for specifics or if any questions in regards to the items you are looking at.



2-76-DUR-0625-S-SL-CWB

## Top Plates

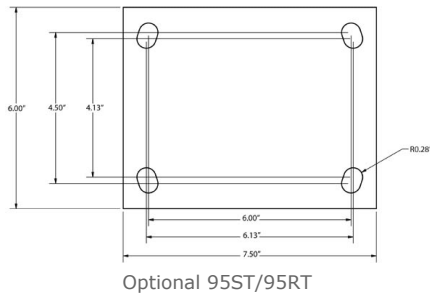
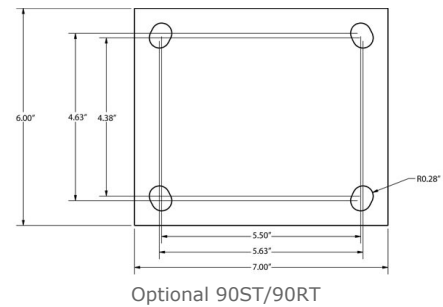
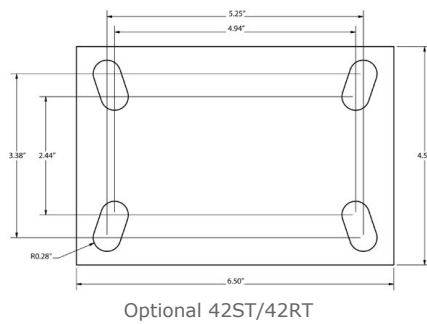
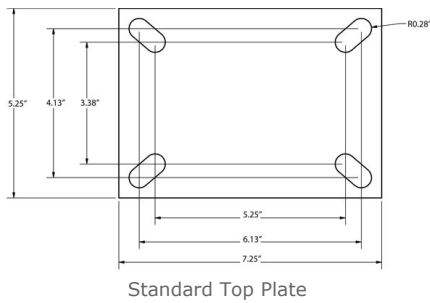

## Features

**Raceway Design:** Patented Kingpinless™ single ball bearing precision machined raceway hardened to 53 Rockwell C minimum. Swivel section features a 3" diameter raceway with 1/2" ball bearings. Notched yoke is standard.

**Capacity:** 7000 lbs.

**Axle:** 3/4" bolt with locking or slotted nut as required

**Finish:** Laguna Blue powder coat

**Wheels:** Wheels are available with either 1" roller bearings which rotate on hardened and ground spanner bushings or 3/4" tapered bearings that rotate on the axle. All wheels are equipped with a lubrication fitting.

**Mounting Plate Size:** 5-1/4" x 7-1/4" x 3/8"

**Bolt Hole Spacing:** 3-3/8" x 5-1/4", slotted to 4-1/8" x 6-1/8"

**Mounting Bolt Diameter:** 1/2"

**Leg Thickness:** 3/8"

## Applications

Dual wheel casters offer high weight capacities with minimal overall heights, better load distribution, floor protection and mobility than single wheel casters. This is a result of spreading the weight over a wider floor area while offering wheel differential action, resulting in less friction between the wheels and the floor, requiring less effort for the caster to swivel. Dual wheel casters are ideal for tow lines, shock load applications and abusive conditions, production line dollies and trucks used in various industries including but not limited to boat and ship molding and building, automotive, aerospace, metal fabricating, metal forging, heavy machinery and equipment, military equipment, mobile homes, etc. tractor pulled trailers, extreme duty platform trucks and material handling carts, air cargo and ground support equipment, storage tanks, gantries and heavy duty processing equipment, coliseum and gymnasium equipment, shipping / receiving carts, warehousing and freight terminal dollies and carts, and other extra heavy duty applications.

## Options

**CWB:** Cam Wheel Brake

**DSL:** Demountable Swivel Lock

**HT:** High Temperature Lubrication

**LT:** Low Temperature Lubrication

**SL:** Swivel Lock

**SR:** Sealed Swivel Raceway

**ZP:** Zinc Plated  
**HTP:** High Temperature Paint  
**FG:** Foot Guard  
**LSL:**L-Type Swivel Lock  
**VSL:**Vertical Swivel Lock  
**SWP:**Sweeper Brush

## Benefits of Kingpinless™ Raceway

Our patented offset precision-machined raceway exerts radial force evenly where there is full contact between the ball bearing and the raceway. RWM's unique design adds more mass at key points. This, plus more thorough heat treatment, provides additional strength and combats brinelling into the core material.

### The Result:

- No direct "hammering" forces on the intersections of the raceways
- Vastly reduced raceway wear
- Elimination of the "pull apart" forces of stress in the swivel section
- Smoother swiveling action
- High maneuverability
- Longer service life
- Less maintenance
- Extra impact resistance
- High radial force absorption

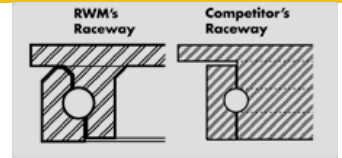

## Optional Mounting Plates

Optional Top Plate Number	Mounting Plate	Bolt Hole Spacing	Bolt Size
90ST*	6" x 7"	4-5/8" x 5-1/2" slotted to 4-3/8" x 5-5/8"	1/2"
90RT	6" x 7"	4-5/8" x 5-1/2" slotted to 4-3/8" x 5-5/8"	1/2"
95ST*	6" x 7-1/2"	4-1/2" x 6" slotted to 4-1/8" x 6-1/8"	1/2"
95RT	6" x 7-1/2"	4-1/2" x 6" slotted to 4-1/8" x 6-1/8"	1/2"
75ST**	4-1/2" x 6- 1/2"	2-7/16" x 4-15/16" slotted to 3-3/8" x 5-1/4"	1/2"
75RT**	4-1/2" x 6- 1/2"	2-7/16" x 4-15/16" slotted to 3-3/8" x 5-1/4"	1/2"

\* Add 1/8" to caster overall height when using this top plate.

\*\* Deduct 1/16" from caster overall height when using this top plate.

## Specifications

Wheel Diameter	Wheel Width	Wheel Type	lbs. Capacity	Overall Height	Straight Roller Bearing	Ball Bearing	Tapered Roller Bearing	Swivel Lead	Approx Weight
6"	2-1/2"	Cast Iron	3600	8-1/16"	2-76- <b>CIR</b> -0625-S		2-76- <b>CIT</b> -0625-S	2-1/16"	37
6"	2-1/2"	Durastan	3200	8-1/16"	2-76- <b>DUR</b> -0625-S			2-1/16"	21.7
6"	2-1/2"	GT	4600	8-1/16"		2-76- <b>GTB</b> -0625-S		2-1/16"	21
6"	2-1/2"	Rubber on Iron-EHT	2160	8-1/16"	2-76- <b>RIR</b> -0625-S-EHT		2-76- <b>RIT</b> -0625-S-EHT	2-1/16"	36.5
6"	2-1/2"	Urethane on Iron	3240	8-1/16"	2-76- <b>UIR</b> -0625-S		2-76- <b>UIT</b> -0625-S	2-1/16"	39.5
6"	2-1/2"	Rubber on Iron	1080	8-1/16"	2-76- <b>RIR</b> -0625-S			2-1/16"	36.5
6"	3"	Cast Iron	6000	8-1/16"	2-76- <b>CIR</b> -0630-S		2-76- <b>CIT</b> -0630-S	2-1/16"	39
6"	3"	Durastan	4000	8-1/16"	2-76- <b>DUR</b> -0630-S			2-1/16"	24
6"	3"	Nylatron HD	5200	8-1/16"		2-76- <b>NYB</b> -0630-S		2-1/16"	22
6"	3"	Rubber on Iron-EHT	2160	8-1/16"	2-75- <b>RIR</b> -0630-S-EHT		2-76- <b>RIT</b> -0630-S-EHT	2-1/16"	33
6"	3"	Urethane on Iron	4000	8-1/16"	2-76- <b>UIR</b> -0630-S		2-76- <b>UIT</b> -0630-S	2-1/16"	33
6"	3"	Solid Urethane	4000	8-1/16"	2-76- <b>MUR</b> -0630-S	2-76- <b>MUB</b> -0630-S		2-1/16"	24
6"	3"	Rubber on Iron	1360	8-1/16"	2-76- <b>RIR</b> -0630-S			2-1/16"	33
8"	2-1/2"	Cast Iron	4000	10-1/2"	2-76- <b>CIR</b> -0825-S		2-76- <b>CIT</b> -0825-S	2-3/4"	52
8"	2-1/2"	Durastan	4000	10-1/2"	2-76- <b>DUR</b> -0825-S			2-3/4"	29
8"	2-1/2"	GT	4800	10-1/2"		2-76- <b>GTB</b> -0825-S		2-3/4"	28
8"	2-1/2"	Rubber on Iron-EHT	2680	10-1/2"	2-76- <b>RIR</b> -0825-S-EHT		2-76- <b>RIT</b> -0825-S-EHT	2-3/4"	41.5
8"	2-1/2"	Urethane on Iron	3600	10-1/2"	2-76- <b>UIR</b> -0825-S		2-76- <b>UIT</b> -0825-S	2-3/4"	48.5
8"	2-1/2"	Rubber on Iron	1340	10-1/2"	2-76- <b>RIR</b> -0825-S			2-3/4"	41.5
8"	3"	Cast Iron	6000	10-1/2"	2-76- <b>CIR</b> -0830-S		2-76- <b>CIT</b> -0830-S	2-3/4"	49
8"	3"	Durastan	5000	10-1/2"	2-76- <b>DUR</b> -0830-S			2-3/4"	28

8"	3"	Nylatron HD	7000	10-1/2"		2-76- <b>NYB</b> -0830-S		2-3/4"	29
8"	3"	Rubber on Iron-EHT	3360	10-1/2"	2-76- <b>RIR</b> -0830-S-EHT		2-76- <b>RIT</b> -0830-S-EHT	2-3/4"	52
8"	3"	Urethane on Iron	5000	10-1/2"	2-76- <b>UIR</b> -0830-S		2-76- <b>UIT</b> -0830-S	2-3/4"	52
8"	3"	Solid Urethane	5000	10-1/2"	2-76- <b>MUR</b> -0830-S	2-76- <b>MUB</b> -0830-S		2-3/4"	28
8"	3"	Rubber on Iron	1680	10-1/2"	2-76- <b>RIR</b> -0830-S			2-3/4"	52
10"	2-1/2"	Cast Iron	5000	12-1/2"	2-76- <b>CIR</b> -1025-S		2-76- <b>CIT</b> -1025-S	3-1/4"	63.5
10"	2-1/2"	Durastan	5000	12-1/2"	2-76- <b>DUR</b> -1025-S			3-1/4"	30.5
10"	2-1/2"	Rubber on Iron-EHT	3460	12-1/2"	2-76- <b>RIR</b> -1025-S-EHT		2-76- <b>RIT</b> -1025-S-EHT	3-1/4"	47.5
10"	2-1/2"	Urethane on Iron	4740	12-1/2"	2-76- <b>UIR</b> -1025-S		2-76- <b>UIT</b> -1025-S	3-1/4"	58.5
10"	2-1/2"	Rubber on Iron	1580	12-1/2"	2-76- <b>RIR</b> -1025-S		2-76- <b>RIT</b> -1025-S	3-1/4"	47.5
10"	3"	Durastan	5800	12-1/2"	2-76- <b>DUR</b> -1030-S			3-1/4"	31
10"	3"	GT	6800	12-1/2"		2-76- <b>GTB</b> -1030-S		3-1/4"	31
10"	3"	Rubber on Aluminum-EHT	4000	12-1/2"		2-76- <b>RAB</b> -1030-S-EHT	2-76- <b>RAT</b> -1030-S-EHT	3-1/4"	61
10"	3"	Rubber on Iron-EHT	4000	12-1/2"	2-76- <b>RIR</b> -1030-S-EHT		2-76- <b>RIT</b> -1030-S-EHT	3-1/4"	61
10"	3"	Solid Urethane	6000	12-1/2"	2-76- <b>MUR</b> -1030-S	2-76- <b>MUB</b> -1030-S		3-1/4"	31
10"	3"	Ultra Thick Urethane	6800	12-1/2"	2-76- <b>URT</b> -1030-S		2-76- <b>UTT</b> -1030-S	3-1/4"	64
10"	3"	Urethane on Iron	6000	12-1/2"	2-76- <b>UIR</b> -1030-S		2-76- <b>UIT</b> -1030-S	3-1/4"	61
10"	3"	Rubber on Iron	2000	12-1/2"	2-76- <b>RIR</b> -1030-S		2-76- <b>RIT</b> -1030-S	3-1/4"	61
12"	2-1/2"	Durastan	6000	15-1/2"	2-76- <b>DUR</b> -1225-S			4-1/8"	44.5
12"	2-1/2"	Rubber on Iron	1800	15-1/2"	2-76- <b>RIR</b> -1225-S		2-76- <b>RIT</b> -1225-S	4-1/8"	55.5
12"	2-1/2"	Urethane on Iron	5400	15-1/2"	2-76- <b>UIR</b> -1225-S		2-76- <b>UIT</b> -1225-S	4-1/8"	76.2
12"	3"	Cast Iron	7000	15-1/2"	2-76- <b>CIR</b> -1230-S		2-76- <b>CIT</b> -1230-S	4-1/8"	88
12"	3"	Durastan	7000	15-1/2"	2-76- <b>DUR</b> -1230-S			4-1/8"	34
12"	3"	Rubber on Aluminum-EHT	4560	15-1/2"		2-76- <b>RAB</b> -1230-S-EHT	2-76- <b>RAT</b> -1230-S-EHT	4-1/8"	88
12"	3"	Rubber on Iron-EHT	4560	15-1/2"	2-76- <b>RIR</b> -1230-S-EHT		2-76- <b>RIT</b> -1230-S-EHT	4-1/8"	88
12"	3"	Ultra Thick Urethane	7000	15-1/2"	2-76- <b>URT</b> -1230-S		2-76- <b>UTT</b> -1230-S	4-1/8"	101
12"	3"	Urethane on Iron	6800	15-1/2"	2-76- <b>UIR</b> -1230-S		2-76- <b>UIT</b> -1230-S	4-1/8"	88
12"	3"	Rubber on Iron	2280	15-1/2"	2-76- <b>RIR</b> -1230-S		2-76- <b>RIT</b> -1230-S	4-1/8"	88

To order a rigid caster, change the "S" to "R" in the model number. For example: "2-76-CIR-0630-R". To order rig only, omit the blue letters. For example: "2-76-0630-S". Dimensions shown are nominal. If precise dimensions are required, consult your RWM representative. For approximate weight of our rigid casters, deduct 5.4 pounds per item.

- \* Add 1/8" to caster overall height when using this top plate.
- \*\* Deduct 1/16" from caster overall height when using this top plate.