

RWM's CargoMax™ is the strongest, most durable air cargo caster on the market. The CargoMax™ caster features an optional demountable foot guard built specifically for use on sorting decks. The foot guard prevents foot entry into the caster mounting hole on decks and assists in providing a safer, more productive working environment on sortation decks.

Features

Precision Ball Bearing: All wheels and swivel raceways have precision ball bearings for better load distribution, strength in side thrust application, and ease of mobility.

Dust Shield, Water Guard & Thread Guard:

Prevents wheel and swivel assembly from becoming contaminated

Capacity: 500 lbs.

Finish: Zinc plated to protect against corrosion

Benefits

CargoMax™ can take the heaviest blows from all types of cargo containers with the highest rated impact resistance in the air cargo industry, even under the most extreme conditions. It outshines the competition in endurance with exclusive features such as three sealed precision bearings, high strength thread and dust guards, high-strength polymer wheels and a rivet-protecting water shield.



26-USB-2713-S-TG-FG

26-USB-2713-S-TG

Available with optional foot guard

Options

FG Foot Guard

SPECIFICATIONS

Wheel Diameter	Wheel Width	Wheel Type	Capacity lbs.	Overall Height	Ball Bearing	Swivel Lead	Approx Weight lbs.
2-5/16"	1-5/16"	Hytrel	500	3-25/32"	26-USB-2313-S-TG	1"	1.62
					26-USB-2313-S6-TG		1.62
					26-USB-2313-S-TG-FG		2.46
					26-USB-2313-S6-TG-FG		2.46
2-3/4"	1-5/16"	Hytrel	500	4"	26-USB-2713-S-TG	1"	1.71
					26-USB-2713-S6-TG		1.71
					26-USB-2713-S-TG-FG		2.54
					26-USB-2713-S6-TG-FG		2.54

UP TO 500 POUND CAPACITY

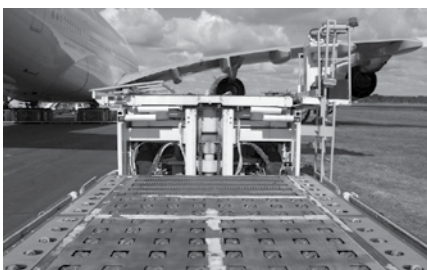

Standard Top Plate (S)

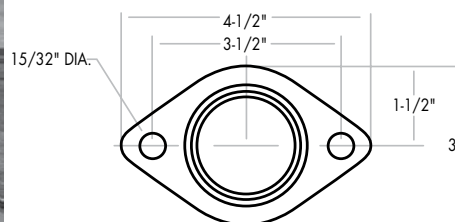

Optional Rectangular Top Plate (S6)

