



1225 Isley Road, Gastonia, NC  
28052  
Phone: [800-634-7704](tel:800-634-7704) Fax:  
800-253-6634  
[www.rwmcasters.com](http://www.rwmcasters.com)

# 2-95 Series Kingpinless™ Casters

*Kingpinless™ Dual Wheel Casters*

RWM's 2-95 Series Kingpinless™ Dual Wheel Casters feature all of the benefits of our patented Kingpinless™ raceway and offer twice the capacity load.

Our 2-95 Series Casters are proudly made in the USA! Log in below to download CAD drawings of this caster.

Dual wheel rigid casters top plates utilize a larger surface area on many sizes to accommodate the width of the wheels and leg spacing required. These casters will utilize special top plates combining the adapter plate and mounting plate together in one plasma cut component which look like this ([DOWNLOAD](#)). Dimensions stated as top plate size on these pages are the general outside dimensions of the standard plate when these tabs are not necessary such as on small sizes. Please contact the factory for specifics or if any questions in regards to the items you are looking at.



2-95-UIR-0830-S

## Top Plates

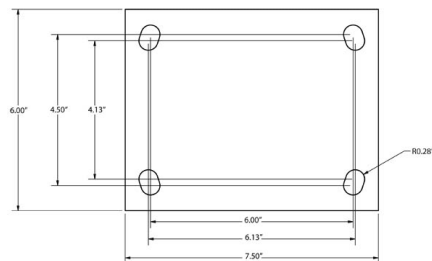

Standard Swivel Top Plate

## Features

**Raceway Design:** 4-1/2" diameter with 3/4" diameter carbon steel balls. Precision machined and hardened to 53 Rockwell C minimum. Load and thrust are accommodated by our patented design. Sealed raceway is standard.

**Capacity:** 20000 lbs.

**Axle:** 3/4" bolt and nut for 3" wide, 1" or 1-1/4" bolt and nut for 4" wide, 1-1/4" bolt and nut for 5" wide.

**Finish:** Laguna Blue powder coat

**Wheels:** 3" wide wheels are available with either a 1" roller bearing that rotates on 3/4" x 1" x 3-9/16" hardened and ground spanner bushings or 3/4" tapered bearings that rotate on a 3/4" axle. 4" and 5" wheels are available with either a 1-1/4" I.D. roller bearings which rotate on a hardened and ground spanner bushing or 1- 1/4" tapered

bearings which rotate on the axle. All wheels are equipped with lubrication fitting.

**Mounting Plate Size:** 6-1/4" x 7-1/2" x 1/2" swivel top plate, 6" x 7-1/2" x 1/2" rigid top plate

**Bolt Hole Spacing:** 4-1/2" x 6", slotted to 4-1/8" x 6-1/8"

**Mounting Bolt Diameter:** 1/2"

**Leg Thickness:** 3/8" thick

**Mounting Plate Thickness:** 1/2"

## Applications

Dual wheel casters offer high weight capacities with minimal overall heights, better load distribution, floor protection and mobility than single wheel casters. This is a result of spreading the weight over a wider floor area while offering wheel differential action, resulting in less friction between the wheels and the floor, requiring less effort for the caster to swivel. Dual wheel casters are ideal for tow lines, shock load applications and abusive conditions, production line dollies and trucks used in various industries including but not limited to boat and ship molding and building, automotive, aerospace, metal fabricating, metal forging, heavy machinery and equipment, military equipment, mobile homes, etc. tractor pulled trailers, extreme duty platform trucks and material handling carts, air cargo and ground support equipment, storage tanks, gantries and heavy duty processing equipment, coliseum and gymnasium equipment, shipping / receiving carts, warehousing and freight terminal dollies and carts, and other extra heavy duty applications.

## Options

**CWB:** Cam Wheel Brake

**DSL:** Demountable Swivel Lock - When ordering the Demountable Swivel Lock (DSL), you must also order the Notched Yoke (NY).

**HDSL:** Heavy Duty Demountable Swivel Lock

**HT:** High Temperature Lubrication

**LT:** Low Temperature Lubrication

**PCWB:** Poly Cam Wheel Brake

**NY:** Notched Yoke Base

**SL:** Swivel Lock

**WS:** Wheel Seals (Contact RWM)

**ZP:** Zinc Plated

**FG:** Foot Guard

**LSL:**L-Type Swivel Lock

**VSL:**Vertical Swivel Lock

**SWP:**Sweeper Brush

Add 1/4" to the Casters Overall Height with the addition of a swivel lock

## Benefits of Kingpinless™ Raceway

Our patented offset precision-machined raceway exerts radial force evenly where there is full contact between the ball bearing and the raceway. RWM's unique design adds more mass at key points. This, plus more thorough heat treatment, provides additional strength and combats brinelling into the core material.

### The Result:

- No direct "hammering" forces on the intersections of the raceways
- Vastly reduced raceway wear
- Elimination of the "pull apart" forces of stress in the swivel section
- Smoother swiveling action
- High maneuverability
- Longer service life
- Less maintenance
- Extra impact resistance
- High radial force absorption

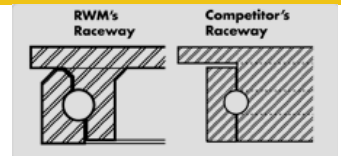

## Specifications

Wheel Diameter	Wheel Width	Wheel Type	lbs. Capacity	Overall Height	Straight Roller Bearing	Ball Bearing	Tapered Roller Bearing	Swivel Lead	Approx Weight
6"	3"	Cast Iron	6000	8-3/4"	2-95- <b>CIR</b> -0630-S		2-95- <b>CIT</b> -0630-S	1-9/16"	39
6"	3"	Durastan	4000	8-3/4"	2-95- <b>DUR</b> -0630-S			1-9/16"	24
6"	3"	Forged Steel	14000	8-3/4"	2-95- <b>FSR</b> -0630-S		2-95- <b>FST</b> -0630-S	1-9/16"	55
6"	3"	Solid Urethane	4000	8-3/4"	2-95- <b>MUR</b> -0630-S	2-95- <b>MUB</b> -0630-S		1-9/16"	24
6"	3"	Nylatron HD	20000	8-3/4"		2-95- <b>NYB</b> -0630-S		1-9/16"	24
6"	3"	Urethane on Iron	4000	8-3/4"	2-95- <b>UIR</b> -0630-S		2-95- <b>UIT</b> -0630-S	1-9/16"	33
8"	3"	Cast Iron	6000	10-3/4"	2-95- <b>CIR</b> -0830-S		2-95- <b>CIT</b> -0830-S	2-1/16"	49

8"	3"	Durastan	5000	10-3/4"	2-95-DUR-0830-S		2-1/16"	28
8"	3"	Forged Steel	11000	10-3/4"	2-95-FSR-0830-S	2-95-FST-0830-S	2-1/16"	56
8"	3"	Nylatron HD	20000	10-3/4"		2-95-NYB-0830-S	2-1/16"	29
8"	3"	Omega	3200	10-3/4"	2-95-UOR-0830-S	2-95-UOT-0830-S	2-1/16"	52
8"	3"	Rubber on Iron-EHT	3360	10-3/4"	2-95-RIR-0830-S-EHT	2-95-RIT-0830-S-EHT	2-1/16"	50
8"	3"	Solid Urethane	5000	10-3/4"		2-95-MUB-0830-S	2-1/16"	28
8"	3"	Urethane on Iron	5000	10-3/4"	2-95-UIR-0830-S	2-95-UIT-0830-S	2-1/16"	52
8"	3"	Rubber on Iron	1680	10-3/4"	2-95-RIR-0830-S	2-95-RIT-0830-S	2-1/16"	50
8"	4"	Cast Iron	8000	10-3/4"	2-95-CIR-0840-S	2-95-CIT-0840-S	2-1/16"	68
8"	4"	Forged Steel	20000	10-3/4"	2-95-FSR-0840-S	2-95-FST-0840-S	2-1/16"	88
8"	4"	Urethane on Iron	7000	10-3/4"	2-95-UIR-0840-S	2-95-UIT-0840-S	2-1/16"	64
10"	3"	Cast Iron	8000	12-3/4"	2-95-CIR-1030-S	2-95-CIT-1030-S	2-9/16"	74
10"	3"	Durastan	5800	12-3/4"	2-95-DUR-1030-S		2-9/16"	31
10"	3"	Forged Steel	12000	12-3/4"	2-95-FSR-1030-S	2-95-FST-1030-S	2-9/16"	76
10"	3"	GT	6800	12-3/4"		2-95-GTB-1030-S	2-9/16"	45
10"	3"	Nylatron HD	20000	12-3/4"		2-95-NYB-1030-S	2-9/16"	46
10"	3"	Omega	4000	12-3/4"	2-95-UOR-1030-S	2-95-UOT-1030-S	2-9/16"	61
10"	3"	Rubber on Aluminum-EHT	4000	12-3/4"		2-95-RAB-1030-S-EHT 2-95-RAT-1030-S-EHT	2-9/16"	61
10"	3"	Rubber on Iron-EHT	4000	12-3/4"	2-95-RIR-1030-S-EHT	2-95-RIT-1030-S-EHT	2-9/16"	54
10"	3"	Solid Urethane	6000	12-3/4"		2-95-MUB-1030-S	2-9/16"	31
10"	3"	Ultra Thick Urethane	6800	12-3/4"	2-95-UTR-1030-S	2-95-UTT-1030-S	2-9/16"	64
10"	3"	Urethane on Iron	6000	12-3/4"	2-95-UIR-1030-S	2-95-UIT-1030-S	2-9/16"	61
10"	3"	Rubber on Iron	2000	12-3/4"	2-95-RIR-1030-S	2-95-RIT-1030-S	2-9/16"	54
10"	4"	Cast Iron	10000	12-3/4"	2-95-CIR-1040-S	2-95-CIT-1040-S	2-9/16"	116
10"	4"	Forged Steel	10000	12-3/4"	2-95-FSR-1040-S		2-9/16"	110
10"	4"	Forged Steel	20000	12-3/4"		2-95-FST-1040-S	2-9/16"	110
10"	4"	Rubber on Iron	3420	12-3/4"	2-95-RIR-1040-S	2-95-RIT-1040-S	2-9/16"	72
10"	4"	Ultra Thick Urethane	9000	12-3/4"	2-95-UTR-1040-S	2-95-UTT-1040-S	2-9/16"	76
10"	4"	Urethane on Iron	8400	12-3/4"	2-95-UIR-1040-S	2-95-UIT-1040-S	2-9/16"	76
12"	3"	Cast Iron	10000	15-1/2"	2-95-CIR-1230-S	2-95-CIT-1230-S	3-7/16"	83
12"	3"	Durastan	7000	15-1/2"	2-95-DUR-1230-S		3-7/16"	34
12"	3"	Rubber on Aluminum-EHT	4560	15-1/2"		2-95-RAB-1230-S-EHT 2-95-RAT-1230-S-EHT	3-7/16"	88
12"	3"	Rubber on Iron-EHT	4560	15-1/2"	2-95-RIR-1230-S-EHT	2-95-RIT-1230-S-EHT	3-7/16"	83
12"	3"	Ultra Thick Urethane	8200	15-1/2"	2-95-UTR-1230-S	2-95-UTT-1230-S	3-7/16"	101
12"	3"	Urethane on Iron	6800	15-1/2"	2-95-UIR-1230-S	2-95-UIT-1230-S	3-7/16"	88
12"	3"	Rubber on Iron	2280	15-1/2"	2-95-RIR-1230-S	2-95-RIT-1230-S	3-7/16"	83
12"	4"	Ultra Thick Urethane	10600	15-1/2"	2-95-UTR-1240-S	2-95-UTT-1240-S	3-7/16"	106
12"	4"	Urethane on Iron	9600	15-1/2"	2-95-UIR-1240-S	2-95-UIT-1240-S	3-7/16"	96
12"	5"	Ultra Thick Urethane	13000	15-1/2"	2-95-UTR-1250-S	2-95-UTT-1250-S	3-7/16"	155
12"	5"	Urethane on Iron	12000	15-1/2"	2-95-UIR-1250-S	2-95-UIT-1250-S	3-7/16"	155
12"	6"	Urethane on Iron	15000	15-1/2"	2-95-UIR-1260-S	2-95-UIT-1260-S	3-7/16"	180
14"	3"	Ultra Thick Urethane	9600	18"	2-95-UTR-1430-S	2-95-UTT-1430-S	3-7/8"	126
14"	4"	Ultra Thick Urethane	12400	18"	2-95-UTR-1440-S	2-95-UTT-1440-S	3-7/8"	156
14"	5"	Ultra Thick Urethane	15200	18"	2-95-UTR-1450-S	2-95-UTT-1450-S	3-7/8"	170
14"	6"	Urethane on Iron	18000	18"	2-95-UIR-1460-S	2-95-UIT-1460-S	3-7/8"	178
16"	3"	Durastan	8000	19"	2-95-DUR-1630-S		4-1/8"	89
16"	3"	Ultra Thick Urethane	10800	19"	2-95-UTR-1630-S	2-95-UTT-1630-S	4-1/8"	94
16"	3"	Urethane on Iron	9200	19"	2-95-UIR-1630-S	2-95-UIT-1630-S	4-1/8"	115
16"	4"	Ultra Thick Urethane	14200	19"	2-95-UTR-1640-S	2-95-UTT-1640-S	4-1/8"	165
16"	4"	Urethane on Iron	12000	19"	2-95-UIR-1640-S	2-95-UIT-1640-S	4-1/8"	165
16"	5"	Ultra Thick Urethane	17600	19"	2-95-UTR-1650-S	2-95-UTT-1650-S	4-1/8"	205

16" 5" Urethane on Iron 16800 19" 2-95-**UIR**-1650-S 2-95-**UIT**-1650-S 4-1/8" 185

To order a rigid caster, change the "S" to "R" in the model number. For example: "2-95-DUR-0830-R". To order rig only, omit the blue letters. For example: "2-95-0830-S". Dimensions shown are nominal. If precise dimensions are required, consult your RWM representative. For approximate weight of our rigid casters, deduct 5.4 pounds per item.