



1225 Isley Road, Gastonia, NC 28052
Phone: [800-634-7704](tel:800-634-7704) Fax: 800-253-6634
www.rwmcasters.com

54 Series Casters

Heavy Duty Casters



RWM Caster's 54 Series is even stronger than our popular 53 series. This series is our largest conventional heavy duty kingpin style caster and is proudly Made in U.S.A. If you don't find the right caster for your application, let our engineering team custom design one for you.

If considering the 54 series for a project you may wish to evaluate the [75 series](#) or [76 series](#) as a better [Kingpinless](#) product with quicker deliveries. Due to the volumes produced we are actually able to offer those Series at a better price despite being a considerable upgrade over the 54.



54-RIR-0625-S

Top Plates

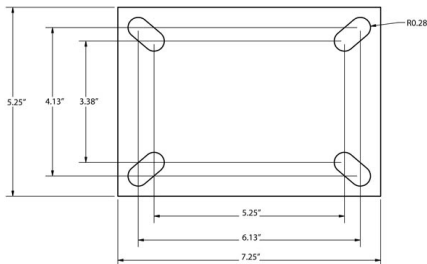

Standard Top Plate

Swivel Sections and Cross Sections

Swivel Cross Section

Rivet Cross Section

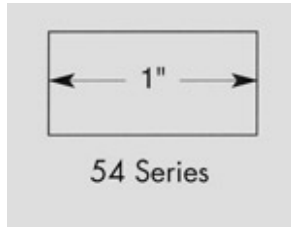
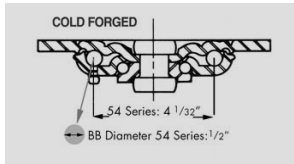

Features

Swivel Section: Cold formed top plate, yoke and button are all heat treated to prevent brinelling, improve swivel action and increase service life. Both load and thrust bearings are hardened and raceway bearings rotate on hardened raceways. Top plate is forged from 3/8" thick steel plate. All swivel sections are equipped with a lubrication fitting for field maintenance. RWM lubricates all swivel sections prior to shipment.

Capacity: 3,000 lbs.

Kingpin: 1" bolt and lock nut for increased swivel section strength

Leg Thickness: 5/16" formed steel welded inside and outside for additional strength

Axle: 3/4" bolt with lock or slotted nut as required

Finish: Zinc plated to protect against corrosion

Wheels: Wheels are available with either 1" I.D. diameter straight roller bearings which rotate on a 1" O.D. hardened and ground spanner bushing or a 3/4" I.D. tapered bearing which rotates on a 3/4" axle. The tapered bearing configuration is highly recommended for high speed and side thrust applications. All wheels are supplied with a lubrication fitting for field maintenance.

Mounting Plate Size: 5-1/4" x 7-1/4" x 3/8"

Bolt Hole Spacing: 3-3/8" x 5-1/4", slotted to 4-1/8" x 6-1/8"

Mounting Bolt Diameter: 1/2"

Applications

The 54 Series is the perfect solution for:

- production racks and fixtures
- live skids and box trucks
- heavy equipment
- maintenance carts

Options

CWB: Cam Wheel Brake

DSL: Demountable Swivel Lock

HT: High Temperature Lubrication

LT: Low Temperature Lubrication

SL: Swivel Lock

SR: Sealed Swivel Raceway

Specifications

Wheel Diameter	Wheel Width	Wheel Type	lbs. Capacity	Overall Height	Straight Roller Bearing	Ball Bearing	Tapered Roller Bearing	Swivel Lead	Approx Weight
4-1/2"	2-1/2"	Cast Iron	1500	6-1/2"	54-CIR-4525-S		54-CIT-4525-S	1-9/16"	18.1
6"	2-1/2"	Cast Iron	1800	7-3/4"	54-CIR-0625-S		54-CIT-0625-S	1-15/16"	19.3
6"	2-1/2"	Durastan	1600	7-3/4"	54-DUR-0625-S			1-15/16"	15.0
6"	2-1/2"	Forged Steel	3000	7-3/4"	54-FSR-0625-S		54-FST-0625-S	1-15/16"	23.0
6"	2-1/2"	GT	2300	7-3/4"		54-GTB-0625-S		1-15/16"	15.0
6"	2-1/2"	Rubber on Iron	540	7-3/4"	54-RIR-0625-S			1-15/16"	18.0
6"	2-1/2"	Urethane on Iron	1620	7-3/4"	54-UIR-0625-S		54-UIT-0625-S	1-15/16"	21.2
6"	2-1/2"	V-Groove Iron	2500	7-3/4"	54-VIR-0625-S		54-VIT-0625-S	1-15/16"	21.4

6"	3"	Cast Iron	3000	7-3/4"	54- CIR -0630-S	54- CIT -0630-S	1-15/16"	20.1
6"	3"	Durastan	2000	7-3/4"	54- DUR -0630-S		1-15/16"	16.0
6"	3"	Urethane on Iron	2000	7-3/4"	54- UIR -0630-S	54- UIT -0630-S	1-15/16"	22.0
6"	3"	V-Groove Forged	3000	7-3/4"	54- VFT -0630-S	54- VFT -0630-S	1-15/16"	24.4
6"	3"	Rubber on Iron	680	7-3/4"	54- RIR -0630-S		1-15/16"	17.0
8"	2-1/2"	Cast Iron	2000	9-3/4"	54- CIR -0825-S	54- CIT -0825-S	2-7/16"	23.8
8"	2-1/2"	Durastan	2000	9-3/4"	54- DUR -0825-S		2-7/16"	17.2
8"	2-1/2"	Forged Steel	3000	9-3/4"	54- FSR -0825-S	54- FST -0825-S	2-7/16"	26.7
8"	2-1/2"	GT	2400	9-3/4"		54- GTB -0825-S	2-7/16"	17.2
8"	2-1/2"	Rubber on Iron	670	9-3/4"	54- RIR -0825-S		2-7/16"	21.9
8"	2-1/2"	Urethane on Iron	1800	9-3/4"	54- UIR -0825-S	54- UIT -0825-S	2-7/16"	20.9
8"	2-1/2"	V-Groove Iron	3000	9-3/4"	54- VIR -0825-S	54- VIT -0825-S	2-7/16"	26.5
8"	3"	Cast Iron	2500	9-3/4"	54- CIR -0830-S	54- CIT -0830-S	2-7/16"	23.0
8"	3"	Durastan	2500	9-3/4"	54- DUR -0830-S		2-7/16"	19.0
8"	3"	Forged Steel	3000	9-3/4"	54- FSR -0830-S	54- FST -0830-S	2-7/16"	29.3
8"	3"	Omega	1600	9-3/4"	54- UOR -0830-S	54- UOT -0830-S	2-7/16"	24.5
8"	3"	Rubber on Iron-EHT	1680	9-3/4"	54- RIR -0830-S-EHT	54- RIT -0830-S-EHT	2-7/16"	23.7
8"	3"	Urethane on Iron	2500	9-3/4"	54- UIR -0830-S	54- UIT -0830-S	2-7/16"	27.7
8"	3"	V-Groove Forged	3000	9-3/4"	54- VFT -0830-S	54- VFT -0830-S	2-7/16"	28.0
8"	3"	V-Groove Iron	3000	9-3/4"	54- VIR -0830-S	54- VIT -0830-S	2-7/16"	26.5
8"	3"	Rubber on Iron	840	9-3/4"	54- RIR -0830-S		2-7/16"	23.7
10"	2-1/2"	Cast Iron	2500	11-1/2"	54- CIR -1025-S	54- CIT -1025-S	2-3/4"	27.7
10"	2-1/2"	Durastan	2500	11-1/2"	54- DUR -1025-S		2-3/4"	19.1
10"	2-1/2"	Rubber on Iron	790	11-1/2"	54- RIR -1025-S	54- RIT -1025-S	2-3/4"	22.8
10"	2-1/2"	Urethane on Iron	2370	11-1/2"	54- UIR -1025-S	54- UIT -1025-S	2-3/4"	28.2
10"	3"	Cast Iron	3000	11-1/2"	54- CIR -1030-S	54- CIT -1030-S	2-3/4"	29.9
10"	3"	Durastan	2900	11-1/2"	54- DUR -1030-S		2-3/4"	21.2
10"	3"	Forged Steel	3000	11-1/2"	54- FSR -1030-S	54- FST -1030-S	2-3/4"	42.3
10"	3"	GT	3000	11-1/2"		54- GTB -1030-S	2-3/4"	21.2
10"	3"	Omega	2000	11-1/2"	54- UOR -1030-S	54- UOT -1030-S	2-3/4"	30.4
10"	3"	Rubber on Iron-EHT	2000	11-1/2"	54- RIR -1030-S-EHT	54- RIT -1030-S-EHT	2-3/4"	25.9
10"	3"	Urethane on Iron	3000	11-1/2"	54- UIR -1030-S	54- UIT -1030-S	2-3/4"	31.7
10"	3"	Ultra Thick Poly	3000	11-1/2"	54- URT -1030-S	54- UTT -1030-S	2-3/4"	32.0
10"	3"	V-Groove Iron	3000	11-1/2"	54- VIR -1030-S	54- VIT -1030-S	2-3/4"	42.3
10"	3"	Rubber on Iron	1000	11-1/2"	54- RIR -1030-S	54- RIT -1030-S	2-3/4"	25.9

To order a rigid caster, change the "S" to "R" in the model number. For example: "54-CIR-0630-R". To order a rig only, omit the blue letters. For example: "54-0630-S". Dimensions shown are nominal. If precise dimensions are required, consult your RWM representative. For approximate weight of our rigid casters, deduct 3 pounds.