

54 Series Casters

RWM Caster's 54 Series is even stronger than our popular 53 series. This series is our largest conventional heavy duty kingpin style caster and is proudly Made in U.S.A. If you don't find the right caster for your application, let our engineering team custom design one for you.



54-RIR-0625-S

Features

Swivel Section: Cold formed top plate, yoke and button are all heat treated to prevent brinelling, improve swivel action and increase service life. Both load and thrust bearings are hardened and raceway bearings rotate on hardened raceways. Top plate is forged from 3/8" thick steel plate. All swivel sections are equipped with a lubrication fitting for field maintenance. RWM lubricates all swivel sections prior to shipment.

Capacity: 3000 lbs.

Kingpin: 1" bolt and lock nut for increased swivel section strength

Leg Thickness: 5/16" formed steel welded inside and outside for additional strength

Axle: 3/4" bolt with lock or slotted nut as required

Finish: Zinc plated to protect against corrosion

Wheels: Wheels are available with either 1" I.D. diameter straight roller bearings which rotate on a 1" O.D. hardened and ground spanner bushing or a 3/4" I.D. tapered bearing which rotates on a 3/4" axle. The tapered bearing configuration is highly recommended for high speed and side thrust applications. All wheels are supplied with a lubrication fitting for field maintenance.

Mounting Plate Size: 5-1/4" x 7-1/4" x 3/8"

Bolt Hole Spacing: 3-3/8" x 5-1/4", slotted to 4-1/8" x 6-1/8"

Mounting Bolt Diameter: 1/2"

Options

- CWB** Cam Wheel Brake
- DSL** Demountable Swivel Lock
- HT** High Temperature Lubrication
- LT** Low Temperature Lubrication
- SL** Swivel Lock
- SR** Sealed Swivel Raceway

54 Standard Top Plate

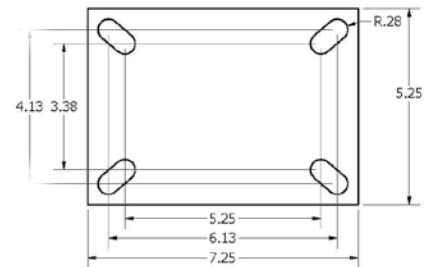

Swivel Cross Section

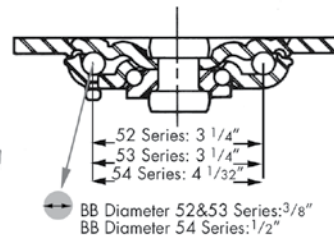

Rivet Cross Section

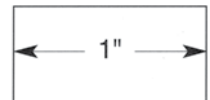

54 Series

Applications

The 54 Series is the perfect solution for:

- ◆ production racks and fixtures
- ◆ live skids and box trucks
- ◆ heavy equipment
- ◆ maintenance carts



UP TO 3,000 POUND CAPACITY

CUSTOM FABRICATION

If you don't find the right caster for your application, let our engineering team create one for you.

We custom design caster, wheel and non-powered material handling solutions to meet your individual needs.

Many of our new product innovations offer major improvements in performance and maximize value to our customers.



SPECIFICATIONS									
Wheel Diameter	Wheel Width	Wheel Type	lbs. Capacity	Overall Height	Swivel Caster Model Number			Swivel Lead	lbs. Approx Weight
					Straight Roller Bearing	Ball Bearing	Tapered Roller Bearing		
4-1/2"	2-1/2"	Cast Iron	1500	6-1/2"	54-CIR-4525-S		54-CIT-4525-S	1-9/16"	18.1
6"	2-1/2"	Cast Iron	1800	7-3/4"	54-CIR-0625-S		54-CIT-0625-S	1-15/16"	19.3
		Durastan	1600		54-DUR-0625-S				15.0
		Forged Steel	3000		54-FSR-0625-S		54-FST-0625-S		23.0
		GT	2300			54-GTB-0625-S			15.0
		Rubber on Iron	540		54-RIR-0625-S				18.0
		Urethane on Iron	1620		54-UIR-0625-S		54-UIT-0625-S		21.2
		V-Groove Iron	2500		54-VIR-0625-S		54-VIT-0625-S		21.4
6"	3"	Cast Iron	3000	7-3/4"	54-CIR-0630-S		54-CIT-0630-S	1-15/16"	20.1
		Durastan	2000		54-DUR-0630-S				16.0
		Rubber on Iron	680		54-RIR-0630-S				17.0
		Urethane on Iron	2000		54-UIR-0630-S		54-UIT-0630-S		22.0
		V-Groove Forged	3000		54-VFR-0630-S		54-VFT-0630-S		24.4
8"	2-1/2"	Cast Iron	2000	9-3/4"	54-CIR-0825-S		54-CIT-0825-S	2-7/16"	23.8
		Durastan	2000		54-DUR-0825-S				17.2
		Forged Steel	3000		54-FSR-0825-S		54-FST-0825-S		26.7
		GT	2400			54-GTB-0825-S			17.2
		Rubber on Iron	670		54-RIR-0825-S				21.9
		Urethane on Iron	1800		54-UIR-0825-S		54-UIT-0825-S		20.9
		V-Groove Iron	3000		54-VIR-0825-S		54-VIT-0825-S		26.5
8"	3"	Cast Iron	2500	9-3/4"	54-CIR-0830-S		54-CIT-0830-S	2-7/16"	23.0
		Durastan	2500		54-DUR-0830-S				19.0
		Forged Steel	3000		54-FSR-0830-S		54-FST-0830-S		29.3
		Omega	1600		54-UOR-0830-S		54-UOT-0830-S		24.5
		Rubber on Iron	840		54-RIR-0830-S				23.7
		Rubber on Iron-EHT	1260		54-RIR-0830-S-EHT		54-RIT-0830-S-EHT		23.7
		Urethane on Iron	2500		54-UIR-0830-S		54-UIT-0830-S		27.7
		V-Groove Forged	3000		54-VFR-0830-S		54-VFT-0830-S		28.0
		V-Groove Iron	3000		54-VIR-0830-S		54-VIT-0830-S		26.5
10"	2-1/2"	Cast Iron	2500	11-1/2"	54-CIR-1025-S		54-CIT-1025-S	2-3/4"	27.7
		Durastan	2500		54-DUR-1025-S				19.1
		Rubber on Iron	790		54-RIR-1025-S		54-RIT-1025-S		22.8
		Urethane on Iron	2370		54-UIR-1025-S		54-UIT-1025-S		28.2
10"	3"	Cast Iron	3000	11-1/2"	54-CIR-1030-S		54-CIT-1030-S	2-3/4"	29.9
		Durastan	2900		54-DUR-1030-S				21.2
		Forged Steel	3000		54-FSR-1030-S		54-FST-1030-S		42.3
		GT	3000			54-GTB-1030-S			21.2
		Omega	2000		54-UOR-1030-S		54-UOT-1030-S		30.4
		Rubber on Iron	1000		54-RIR-1030-S		54-RIT-1030-S		25.9
		Rubber on Iron-EHT	1500		54-RIR-1030-S-EHT		54-RIT-1030-S-EHT		25.9
		Urethane on Iron	3000		54-UIR-1030-S		54-UIT-1030-S		31.7
		Ultra Thick Poly	3000		54-UTR-1030-S		54-UTT-1030-S		32.0
		V-Groove Iron	3000		54-VIR-1030-S		54-VIT-1030-S		42.3

UP TO 3,000 POUND CAPACITY

To order a rigid caster, change the "S" to "R" in the model number. For example: "54-CIR-0630-R". To order a rig only, omit the blue letters. For example: "54-0630-S". Dimensions shown are nominal. If precise dimensions are required, consult your RWM representative. For approximate weight of our rigid casters, deduct 3 pounds.