



1225 Isley Road, Gastonia, NC  
28052  
Phone: [800-634-7704](tel:800-634-7704) Fax:  
800-253-6634  
[www.rwmcasters.com](http://www.rwmcasters.com)

# Economy Inverted Air Cargo Casters

*Light Duty Casters*



This light duty air cargo caster has been optimally designed for air cargo and light duty conveyor applications. It features a heat-treated, hardened raceway for added durability and offers a 300 pound capacity. The light weight phenolic and nylon wheels offer high impact resistance, ease of rollability and resistance to moisture and chemicals. This caster includes a dust cap and thread guards.



26-NYB-0312-S-TG-LD



26-DUB-0312-S-TG-LD

## Top Plates

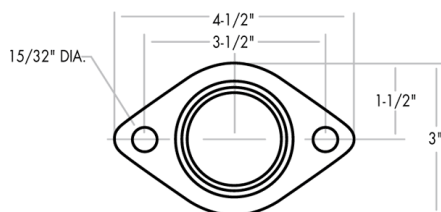

Standard Top Plate for DUB-0312-S-TG-LD

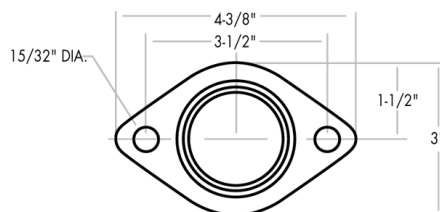

Standard Top Plate for 26-NYB-0312-S-TG-LD

## Features

**Raceway Design:** Hardened

**Dust Shield, Water Guard & Thread Guard:** Prevents wheel and swivel assembly from becoming contaminated

**Capacity:** 300 lb.

**Finish:**









DUB = Zinc plated to protect against corrosion

NYB = Type II Gold zinc plated to protect against corrosion

## Applications

- Airline and Aerospace Industry Applications
- Textile Industry Applications
- Conveyor Applications
- Light Duty Air Cargo Handling

## Specifications

 Wheel Diameter	 Wheel Width	 Wheel Type	DBL	 Axle Diameter	 lbs. Capacity	 Overall Height	 Ball Bearing	 Swivel Lead	 Approx Weight
3"	1-1/4"	Phenolic	1-5/8"	5/16"	300	4"	26- <b>DUB</b> -0312-S-TG-LD	1"	1.00
3"	1-1/4"	Nylon	1-5/8"	3/8"	300	4"	26- <b>NYB</b> -0312-S-TG-LD	1-1/4"	1.38