

# 52 Series Casters

RWM's 52 Series is manufactured from cold formed steel. This series is highly recommended for use in medium heavy duty applications. Log onto our website to download FREE 2D or 3D CAD drawings and models of this caster.



52-FSR-0620-S

## Features

**Swivel Section:** Cold formed top plate, yoke and button are all heat treated to prevent brinelling, improve swivel action and increase service life. Load and thrust bearings are hardened and ground and rotate on hardened raceways. Top plate and legs are 1/4" steel, legs formed for increased strength and continuously welded to yoke. All swivel sections are equipped with a lubrication fitting for field maintenance. RWM lubricates all swivel sections prior to shipment.

**Capacity:** 1400 lbs.

**Kingpin:** 3/4" diameter rivet hydraulically compressed to increase strength of swivel section as compared to staking

**Axle:** 1/2" diameter drilled axle with lubrication fitting provided on 2" casters to improve ease of lubrication

**Finish:** Zinc plated to protect against corrosion

**Mounting Plate Size:** 4-1/2" x 6-1/2" x 1/4"

**Bolt Hole Spacing:** 2-7/16" x 4-15/16", slotted to 3-3/8" x 5-1/4"

**Mounting Bolt Diameter:** 1/2"

## Applications

The 52 Series is the perfect solution for:

- ◆ movable racks
- ◆ conveyor and drag line applications
- ◆ utility trucks
- ◆ corrugated box trucks
- ◆ caster mounted production jigs and fixtures
- ◆ maintenance carts

Rivet Cross Section

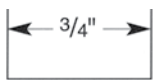

52 Series  
53 Series

SWIVEL CROSS SECTION

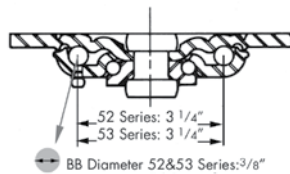

BB Diameter 52&53 Series: 3/8"

### OPTIONAL MOUNTING PLATES

Optional Top Plate Number	Mounting Plate	Bolt Hole Spacing	Bolt Size
43ST 43RT	5" x 5-1/2"	4-1/8" x 4-1/2"	3/8"

## Options

- FIGF** Field Installable Foot Guard
- HT** High Temperature Lubrication
- ICWB** Installable Face Contact Brake (2" wide only)
- KB** Nut and Bolt Kingpin
- LT** Low Temperature Lubrication
- SL** Swivel Lock
- SR** Sealed Swivel Raceway
- TG** Thread Guards
- TPLK** Top Lock Brake
- WB** Side Wheel Brake (roller bearing only)
- WS** Wheel Seals
- WWB** Wrap Around Wheel Brake

52 Series Standard Top Plate

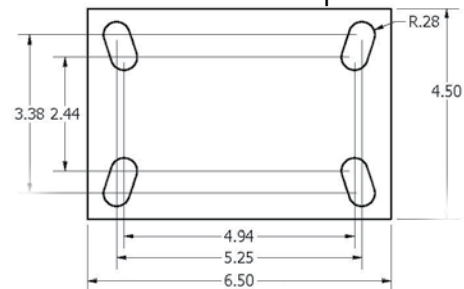

### OPTIONAL OVERALL HEIGHTS

Wheel Diameter	Overall Height
4"	5-1/8"
5"	6-1/2"
6"	7-1/2"
8"	9-1/2"
8"	10-1/8"

To order a rigid caster, change the "S" to "R" in the model number. For example, 52-FSR-0620-R. To order a rig only, omit the blue letters. For example: 52-0620-S. Note: (1.) For weight of Caster with brake add .24 pounds. (2.) For weight of Rigid Caster deduct .7 pounds. Dimensions shown are nominal. If precise dimensions are required, please consult your RWM Representative.

UP TO 1,400 POUND CAPACITY

## SPECIFICATIONS

Wheel Diameter	Wheel Width	Wheel Type	lbs. Capacity	Overall Height	Swivel Caster Model Number			Swivel Lead	lbs. Approx. Weight
					Caged, Straight Roller Bearing	Flanged, Sealed Precision, 1 pc. Ball Bearing	Plain, Oilite, Celcon Bearing		
4"	1-1/2"	Forged Steel	1400	5-3/4"	52-FSR-0415-S		52-FSC-0415-S	1-13/32"	8.8
		Cast Iron	800		52-CIR-0420-S	52-CIB-0420-S	52-CIC-0420-S		8.3
		Durastan	800		52-DUR-0420-S	52-DUB-0420-S	52-DUC-0420-S		6.4
		GT	1050			52-GTB-0420-S			6.4
		High Temp. Nylon	800		52-HNR-0420-S				5.8
		Nylatron HD	1400			52-NYB-0420-S			6.9
		Performance TPR	350		52-RPR-0420-R	52-RPB-0420-R	52-RPC-0420-S		6.5
		Pinnacle	800		52-PNR-0420-S	52-PNB-0420-S	52-PNC-0420-S		6.0
	2"	Polyolefin	500	5-3/4"	52-POR-0420-S	52-POB-0420-S	52-POC-0420-S	1-3/8"	6.0
		Rubber on Aluminum	700			52-RAB-0420-S-EHT			6.5
		Rubber on Iron	350		52-RIR-0420-S		52-RIC-0420-S		8.1
		Urethane on Aluminum	700		52-UAR-0420-S		52-UAC-0420-S		6.6
		Signature	400		52-SWR-0420-S	52-SWB-0420-S	52-SWC-0420-S		6.2
		Solid Urethane	700			52-MUB-0420-S			6.2
		Urethane on Iron	700		52-UIR-0420-S		52-UIC-0420-S		8.2
		Urethane Polypropylene	600		52-UPR-0420-S	52-UPB-0420-S	52-UPC-0420-S		6.5
V-Groove Iron	800	52-VIR-0420-S		52-VIC-0420-S	8.5				
5"	2"	Cast Iron	1000	7-1/4"	52-CIR-0520-S	52-CIB-0520-S	52-CIC-0520-S	1-13/16"	9.6
		Durastan	1000		52-DUR-0520-S	52-DUB-0520-S	52-DUC-0520-S		6.9
		Forged Steel	1400		52-FSR-0520-S		52-FSC-0520-S		10.8
		GT	1200			52-GTB-0520-S			6.9
		High Temp. Nylon	1000		52-HNR-0520-S				6.9
		Nylatron HD	1400			52-NYB-0520-S			7.4
		Performance TPR	375		52-RPR-0520-S	52-RPB-0520-R	52-RPC-0520-S		7.0
		Pinnacle	1000		52-PNR-0520-S	52-PNB-0520-S	52-PNC-0520-S		6.3
	2"	Polyolefin	650	7-1/4"	52-POR-0520-S	52-POB-0520-S	52-POC-0520-S	1-13/16"	6.1
		Rubber on Aluminum	800			52-RAB-0520-S-EHT			7.2
		Rubber on Iron	400		52-RIR-0520-S		52-RIC-0520-S		9.1
		Signature	500		52-SWR-0520-S	52-SWB-0520-S	52-SWC-0520-S		6.5
		Solid Urethane	1000			52-MUB-0520-S			6.5
		Urethane on Aluminum	1050		52-UAR-0520-S		52-UAC-0520-S		7.0
		Urethane on Iron	1050		52-UIR-0520-S		52-UIC-0520-S		9.2
		Urethane Polypropylene	750		52-UPR-0520-S	52-UPB-0520-S	52-UPC-0520-S		7.0
V-Groove Iron	800	52-VIR-0520-S		52-VIC-0520-S	9.9				
6"	2"	Cast Iron	1200	7-3/4"	52-CIR-0620-S	52-CIB-0620-S	52-CIC-0620-S	1-13/16"	11.2
		Durastan	1200		52-DUR-0620-S	52-DUB-0620-S	52-DUC-0620-S		8.0
		Forged Steel	1400		52-FSR-0620-S		52-FSC-0620-S		12.5
		GT	1400			52-GTB-0620-S			8.0
		High Temp. Nylon	1200		52-HNR-0620-S				8.0
		Omega	1000		52-UOR-0620-S	52-UOB-0620-S			10.5
		Performance TPR	525		52-RPR-0620-S	52-RPB-0620-R	52-RPC-0620-S		7.0
		Pinnacle	1200		52-PNR-0620-S	52-PNB-0620-S	52-PNC-0620-S		6.9
	2"	Polyolefin	700	7-3/4"	52-POR-0620-S	52-POB-0620-S	52-POC-0620-S	1-13/16"	8.0
		Rubber on Aluminum	820			52-RAB-0620-S-EHT			9.5
		Rubber on Iron	410		52-RIR-0620-S		52-RIC-0620-S		9.5
		Signature	600		52-SWR-0620-S	52-SWB-0620-S	52-SWC-0620-S		7.2
		Solid Urethane	1200			52-MUB-0620-S			7.2
		Torus	1200			52-UAB-0621-S			6.1
		Urethane on Aluminum	1230		52-UAR-0620-S		52-UAC-0620-S		7.8
		Urethane on Iron	1230		52-UIR-0620-S		52-UIC-0620-S		10.5
Urethane Polypropylene	900	52-UPR-0620-S	52-UPB-0620-S	52-UPC-0620-S	7.0				
V-Groove Iron	1000	52-VIR-0620-S		52-VIC-0620-S	11.2				
6"	2-1/2"	Cast Iron	1400	7-3/4"	52-CIR-0625-S			1-13/16"	15.1
		Durastan	1400		52-DUR-0625-S				10.8
		Forged Steel	1400		52-FSR-0625-S				19.5
		Rubber on Iron	540		52-RIR-0625-S				13.8
		Rubber on Iron-EHT	810		52-RIR-0625-S-EHT				13.8
		Urethane on Iron	1400		52-UIR-0625-S				17.0
		V-Groove Iron	1400		52-VIR-0625-S				17.2
		8"	2"		Cast Iron	1400	9-3/4"		52-CIR-0820-S
Durastan	1400			52-DUR-0820-S	52-DUB-0820-S	52-DUC-0820-S		9.7	
GT	1400				52-GTB-0820-S			9.7	
Omega	1200			52-UOR-0820-S	52-UOB-0820-S			14.1	
Performance TPR	600			52-RPR-0820-S	52-RPB-0820-R	52-RPC-0820-S		9.0	
Pinnacle	1400			52-PNR-0820-S	52-PNB-0820-S	52-PNC-0820-S		7.8	
Polyolefin	800			52-POR-0820-S	52-POB-0820-S	52-POC-0820-S		7.7	
2"	Rubber on Aluminum			1000	9-3/4"			52-RAB-0820-S-EHT	
	Rubber on Iron		500	52-RIR-0820-S			52-RIC-0820-S	12.2	
	Signature		700	52-SWR-0820-S		52-SWB-0820-S	52-SWC-0820-S	8.0	
	Solid Urethane		1400			52-MUB-0820-S		8.0	
	Torus		1400			52-UAB-0821-S		7.3	
	Urethane on Aluminum		1400	52-UAR-0820-S			52-UAC-0820-S	9.3	
	Urethane on Iron		1400	52-UIR-0820-S			52-UIC-0820-S	14.1	
	Urethane Polypropylene		1000	52-UPR-0820-S		52-UPB-0820-S	52-UPC-0820-S	9.0	
V-Groove Iron	1050		52-VIR-0820-S		52-VIC-0820-S	15			
8"	2-1/2"	Cast Iron	1400	9-3/4"	52-CIR-0825-S			2-1/4"	19.7
		Durastan	1400		52-DUR-0825-S				13.1
		Forged Steel	1400		52-FSR-0825-S				29.6
		Rubber on Iron	670		52-RIR-0825-S				17.8
		Rubber on Iron-EHT	1005		52-RIR-0825-S-EHT				17.8
		Urethane on Iron	1400		52-UIR-0825-S				18.8
		V-Groove Iron	1400		52-VIR-0825-S				20.0

UP TO 1,400 POUND CAPACITY