



1225 Isley Road, Gastonia, NC 28052  
Phone: [800-634-7704](tel:800-634-7704) Fax:  
800-253-6634  
[www.rwmcasters.com](http://www.rwmcasters.com)

# S45 Stainless Steel Casters

Medium Heavy Duty Casters



RWM's S45 Stainless Steel Casters come standard with stainless steel roller bearings, sealed bearings, precision ball bearings or celcon bearings, axles, spanners and spacers. Our S45 Series features a cold forged top plate, yoke and button that improves swivel action and increases service life with sealed raceways.

In 6 inch and smaller sizes, this caster features electropolished 304 stainless steel construction, the 8" size is constructed of 202 stainless steel. Stainless steel casters provide a dramatic increase in resistance to corrosion due to environmental or chemical factors. The S45 Series is ideal for wash-down applications such as food processing plants, food service equipment, large volume high temperature bakery and food cooking facilities and many more.

Log in below to download FREE 2D or 3D CAD drawings and models of this caster. Don't see what you want? RWM can custom design a caster for any application!



S45-SWB-0620-S



S45-SWB-0620-R

## Top Plates

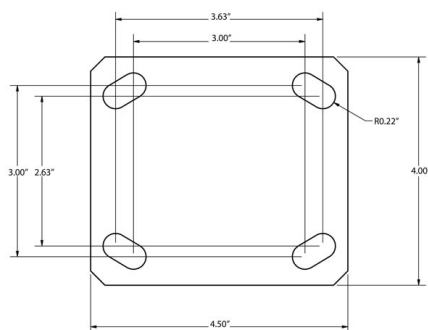

Standard Top Plate

## Features

**Swivel Section:** Cold forged top plate, yoke and button improves swivel action and increases service life. Heavy duty load and thrust bearings are ground and rotate on raceways. Top plate and legs are 1/4" steel, legs formed for increased strength and continuously welded to yoke. All swivel sections are equipped with a lubrication fitting for field maintenance. RWM lubricates all swivel sections prior to shipment. Notched yokes and sealed swivel raceways are standard.

**Capacity:** 900 lbs.

**Kingpin:** 5/8" diameter rivet hydraulically compressed to increase strength of swivel section as compared to staking

**Axle:** 1/2" diameter drilled axle with lubrication fitting provided on casters to improve ease of lubrication where required (not required for ball bearing).

**Mounting Plate Size:** 4" x 4-1/2" x 1/4"

**Bolt Hole Spacing:** 2-5/8" x 3-5/8", slotted to 3"x 3"

**Mounting Bolt Diameter:** 3/8"

**Raceway Seals:** Standard

## Applications

RWM's Stainless Steel Casters feature 304 stainless steel that is highly resistant to conditions that would normally corrode and rust regular zinc plated steel casters. Our Stainless Steel Casters are ideal for wet or damp conditions and harsh environments that may rust or corrode standard zinc casters.

These casters are well suited for rugged duty and are designed for wash-down applications such as food processing plants, food service equipment, large volume high temperature bakery and food cooking facilities, bakery and bread racks, slaughter houses, fisheries, seafood processing plants, stock and maintenance carts, ingredient bins, institutional service carts and equipment, hatcheries, pharmaceutical plants and laboratories.

## Options

**DSL:** Demountable Swivel Lock

**FCNB:** Face Contact Nylon Brake - Will not work with DSL or SL

**FCNTLB:** Face Contact Nylon Total Lock Brake - Will not work with DSL or SL

**HT:** High Temperature Lubrication

**LT:** Low Temperature Lubrication

**SICWB:** Stainless Installable Face Contact Brake - Brake is all stainless except for tread lock spring and plastic pedal.

**SL:** Swivel Lock

**WBT:** Stainless Side Wheel Brake Tread

## Specifications

Wheel Diameter	Wheel Width	Wheel Type	Capacity	Overall Height	Straight Roller Bearing	Ball Bearing	Plain, Oilite, Celcon Bearing	Swivel Lead	Approx Weight
4"	2"	Durastan	800	5-5/8"	S45-DUR-0420-S		S45-DUC-0420-S	1-3/8"	5.2
4"	2"	GT	900	5-5/8"		S45-GTB-0420-S		1-3/8"	5.2
4"	2"	High Temp Nylon	800	5-5/8"	S45-HNR-0420-S			1-3/8"	5.2
4"	2"	Performance TPR	350	5-5/8"	S45-RPR-0420-S	S45-RPB-0420-S	S45-RPC-0420-S	1-3/8"	5.3
4"	2"	Pinnacle	900	5-5/8"	S45-PNR-0420-S		S45-PNC-0420-S	1-3/8"	4.8
4"	2"	Polyolefin	500	5-5/8"	S45-POR-0420-S		S45-POC-0420-S	1-3/8"	4.8
4"	2"	Signature	400	5-5/8"	S45-SWR-0420-S	S45-SWB-0420-S	S45-SWC-0420-S	1-3/8"	5.3
4"	2"	Solid Urethane	500	5-5/8"		S45-MUB-0420-S		1-3/8"	5.2
4"	2"	Urethane Polypropylene	600	5-5/8"	S45-UPR-0420-S		S45-UPC-0420-S	1-3/8"	5.3
5"	2"	Durastan	900	6-1/2"	S45-DUR-0520-S		S45-DUC-0520-S	1-11/16"	5.4
5"	2"	GT	900	6-1/2"		S45-GTB-0520-S		1-11/16"	5.4
5"	2"	High Temp Nylon	900	6-1/2"	S45-HNR-0520-S			1-11/16"	5.4
5"	2"	Performance TPR	375	6-1/2"	S45-RPR-0520-S	S45-RPB-0520-S	S45-RPC-0520-S	1-11/16"	5.3
5"	2"	Pinnacle	900	6-1/2"	S45-PNR-0520-S		S45-PNC-0520-S	1-11/16"	5.0
5"	2"	Polyolefin	650	6-1/2"	S45-POR-0520-S		S45-POC-0520-S	1-11/16"	4.6
5"	2"	Signature	500	6-1/2"	S45-SWR-0520-S	S45-SWB-0520-S	S45-SWC-0520-S	1-11/16"	5.3
5"	2"	Solid Urethane	900	6-1/2"		S45-MUB-0520-S		1-11/16"	5.4
5"	2"	Urethane Polypropylene	750	6-1/2"	S45-UPR-0520-S		S45-UPC-0520-S	1-11/16"	5.3
6"	2"	Durastan	900	7-1/2"	S45-DUR-0620-S		S45-DUC-0620-S	1-3/4"	6.3
6"	2"	GT	900	7-1/2"		S45-GTB-0620-S		1-3/4"	6.3
6"	2"	High Temp Nylon	900	7-1/2"	S45-HNR-0620-S	S45-HNB-0620-S		1-3/4"	6.3
6"	2"	Performance TPR	525	7-1/2"	S45-RPR-0620-S	S45-RPB-0620-S	S45-RPC-0620-S	1-3/4"	5.7
6"	2"	Pinnacle	900	7-1/2"	S45-PNR-0620-S		S45-PNC-0620-S	1-3/4"	5.5
6"	2"	Polyolefin	700	7-1/2"	S45-POR-0620-S		S45-POC-0620-S	1-3/4"	5.0
6"	2"	Signature	600	7-1/2"	S45-SWR-0620-S	S45-SWB-0620-S	S45-SWC-0620-S	1-3/4"	5.3
6"	2"	Solid Urethane	900	7-1/2"		S45-MUB-0620-S		1-3/4"	6.3
6"	2"	Urethane Polypropylene	900	7-1/2"	S45-UPR-0620-S		S45-UPC-0620-S	1-3/4"	5.7
8"	2"	Durastan	900	9-1/2"	S45-DUR-0820-S		S45-DUC-0820-S	2-1/4"	7.7

8"	2"	GT	900	9-1/2"		S45- <b>GTB</b> -0820-S		2-1/4"	7.7
8"	2"	Performance TPR	600	9-1/2"	S45- <b>RPR</b> -0820-S	S45- <b>RPB</b> -0820-S	S45- <b>RPC</b> -0820-S	2-1/4"	7.1
8"	2"	Pinnacle	900	9-1/2"	S45- <b>PNR</b> -0820-S		S45- <b>PNC</b> -0820-S	2-1/4"	6.4
8"	2"	Polyolefin	800	9-1/2"	S45- <b>POR</b> -0820-S		S45- <b>POC</b> -0820-S	2-1/4"	5.8
8"	2"	Signature	700	9-1/2"	S45- <b>SWR</b> -0820-S	S45- <b>SWB</b> -0820-S	S45- <b>SWC</b> -0820-S	2-1/4"	5.3
8"	2"	Solid Urethane	900	9-1/2"		S45- <b>MUB</b> -0820-S	S45- <b>MUC</b> -0820-S	2-1/4"	7.7
8"	2"	Urethane Polypropylene	900	9-1/2"	S45- <b>UPR</b> -0820-S		S45- <b>UPC</b> -0820-S	2-1/4"	7.7

To order a rigid caster, change the "S" to "R" in the model number. For example: "S45-DUR-0420-R". To order a rig only, omit the blue letters. For example: "S45-0420-S". Dimensions shown are nominal. If precise dimensions are required, consult your RWM representative. For approximate weight of our rigid casters, deduct 0.9 pounds per item.