

Digital Panel 23872 72x72mm Dual Channel Time Switch



Benefits

A general purpose timer that offers good functionality along with the flexibility of its mounting options making it an ideal choice for many applications. The key programming feature enables away from site programming and uniform programming of multiple locations. Text based menu system and self explanatory symbols displayed on a large, back-lit dot matrix area to provide two high resolution text lines. Pulse programming allows you to set small bursts (e.g. school bells) in 1 second steps. The 23872 can be extremely quick and easy to program, it can be programmed with supply disconnected and has the ability to program via your computer using Sangamo's optional Easy Vue software and USB link (25195 - not supplied) and backed up or transferred via a programming key (25193 - not supplied). Can be mounted on a panel, surface or DIN rail (95587 Mounting Kit required) making this an adaptable timer for a variety of situations.

Features

- 2 channel
- Daily and weekly program
- 46 memory locations
- Manual override/permanent override
- 10 years battery reserve
- Minimum interval 1 min.
- Switching capacity 16A
- Permanent by date/holiday function
- Automatic sorting of switching times on readout
- Supplied with panel retaining clip
- Unrestricted block programming
- Fully automatic daylight saving time
- Elapsed time and pulse counter
- Pulse function
- Security by PIN-code
- Illuminated display
- Data-key function (with 25193)
- Unlimited program security by E²-PROM
- Programmable by PC

Technical Data

Supply voltage	230 V, 50-60 Hz
Power consumption (real power)	0.5- 1.2 W (depending on the switching status)
Channel (potential-free)	Channel A: Change-over, Channel B: normally open, contact gap <3mm(μ)
Contact material	AgNi
Switching capacity	16A / 250 V ~ at cos = 1 6A with inductive load cos = 0.6
Min. switching power	300 mW (5 V/5 mA)
Max. starting current	30 A
Switching functions	ON, OFF; Pulse,
Pulse length - Pulse function (switching time)	00:01 up to 59.59 mm:ss
Memory Locations	46
Minimum interval	1 min
Time Base	Quartz crystal
Power back-up (at 20°C)	approx. 10 years
Quartz cryst. accuracy (at 20°C)	<= 0.5 sec/day
Permitted ambient temperature	-30°C to +55°C
Enclosure	self-extinguishing thermoplastic
Dimensions	72 x 72mm (to IEC 61554)
Switchboard flush mounting	Retaining clip in 68 x 68mm cutout
Surface mounting	Wall mounting with ternial cover
Type of connection	Screw terminals
Type of protection	IP20 to DIN EN 60529
Class of protection	II when installed according to regulations

Electrical Connections

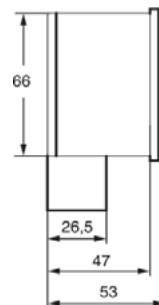
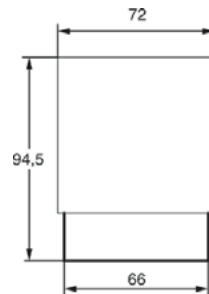
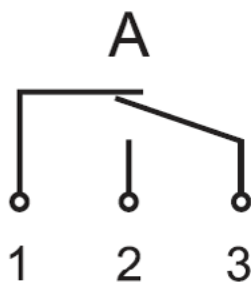

Contact Us: 01475 745131

CUSTOMER CARE POLICY

As part of Sangamo's continuous improvement program, the Company operates a Customer Care Policy. This means that we welcome your comments and complaints, as it can only help us to improve our services to you, our customer.



Sangamo Limited, Industrial Estate, Port Glasgow,
Renfrewshire PA14 5XG

Tel: 01475 745131 Fax: 01475 744567

Email : enquiries@sangamo.co.uk Web: www.sangamo.co.uk