

netatmo  
BY  
STARCK®

3

You are installing your first thermostat



*You can watch this installation on:*  
<http://netatmo.com/video3>

## Warning

# Warning!

- Read carefully these instructions before starting the installation.
- The Netatmo Thermostat must be installed according to applicable standards.
- Before any intervention, make sure power is turned off.

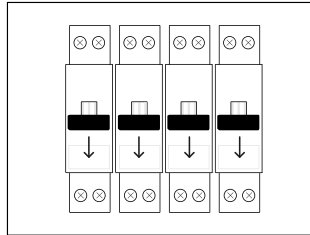
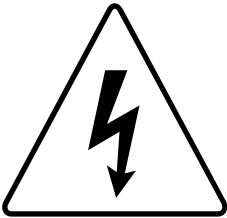

# In the box

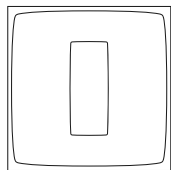

Thermostat

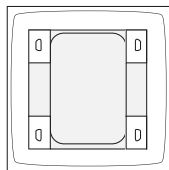

Mobile stand

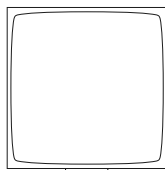

Relay

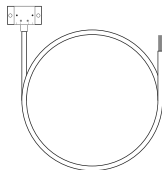

Boiler adapter



Mounting Plate

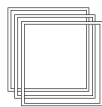

Color Adhesives

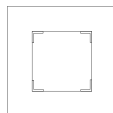

(Trim plate)\*



(Mains adapter)\*



(Tape)\*



(Cover)\*



3 AAA batteries



4 screws  
4 screw anchors



1 USB cable

*\* not used in this setup*

## Identify

Open the boiler's hood using, if necessary, its instructions manual.

Your **relay** will control your boiler when plugged in the corresponding terminals.

Identify the thermostat terminals in the boiler, labeled LS-LR, TA or COM-NO. They may be identifiable thanks to a shunt between the two thermostat terminals.

You have to remove the shunt

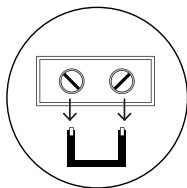

Connect the black and grey wires of the **boiler adapter** in place of the shunt you removed from the thermostat terminals in the boiler.

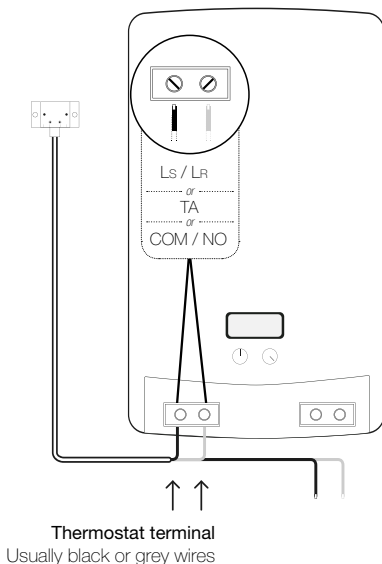

# Electric Power

The **relay** receives 220V power from your boiler.

The power terminals of your boiler are labeled L/N or P/N.

- If your boiler has available power terminals, connect the blue and brown wires of your boiler adapter in those terminals.

- Otherwise, you can connect the blue and brown wires of the boiler adapter in the power terminals from which the boiler itself receives power. The wires of the boiler must remain connected.

Our forum can help you identify the correct terminals :

[forum.netatmo.com](http://forum.netatmo.com)

In doubt, please send a picture of your wiring at [photo@netatmo.com](mailto:photo@netatmo.com), and our support team will help you identify the right terminals.

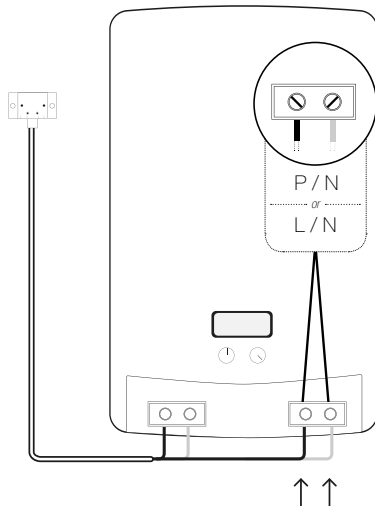

220V Power supply terminals

Blue and brown wires

## Setting the relay

The **boiler adapter** should be placed as far as possible from metallic items (wiring, pipes, electrical grid...).

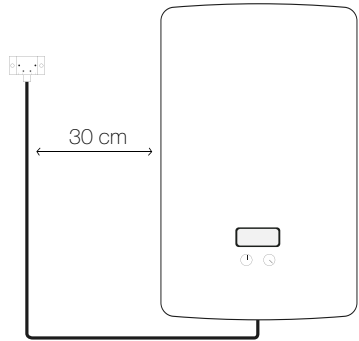

You can fix the **boiler adapter** to the wall either using the double-sided tape or screw it.

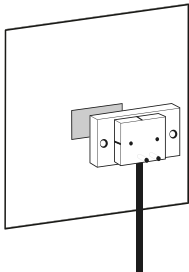

.....  
or  
.....

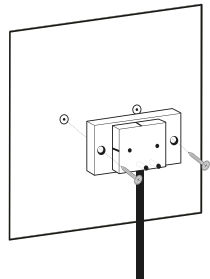

## Testing the relay

- 1 Connect the **relay** into the **boiler adapter**.

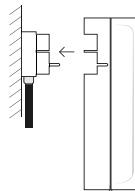

- 2 Switch the power supply back on.

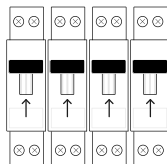

- 3 The **relay** blinks blue.

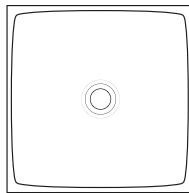

*Note: if the **relay** does not blink after turning the power back on, it is not properly powered. Please check how the blue and brown wires are wired. Do not forget to switch off the power supply before any intervention.*

## Testing the relay

①

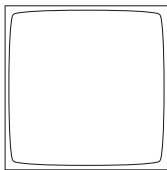

Briefly push the **relay's** button.

②

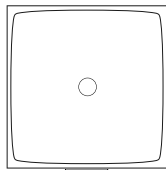

The **relay** lights up in blue and switches the boiler on.

③

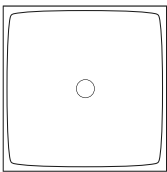

Push again the **relay's** button.

④

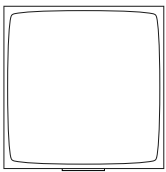

The **relay** turns its light and the boiler off.

*Note: if the boiler doesn't switch on when the blue light is on, the **relay** is incorrectly wired to the boiler. In this case, check where the grey and black wires are connected. In doubt, please read your boiler's instructions manual at the «room thermostat» section.*



# Thermostat

①

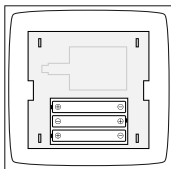

Insert the batteries in the **Thermostat**.

②

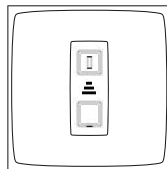

The **Thermostat** displays the start screen and searches for the **relay**.



If the **Thermostat** has found the **relay**, it displays the setpoint and the room temperatures.

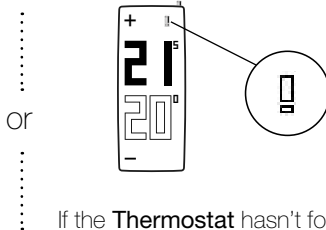

If the **Thermostat** hasn't found the **relay**, it displays the «!» symbol. In this case, move the **relay** closer to the **Thermostat** and wait until the «!» symbol disappears.

# Test

①

Tap a few times the top of the **Thermostat** until the screen shows « MAX ».

The **Thermostat** switches on the boiler.

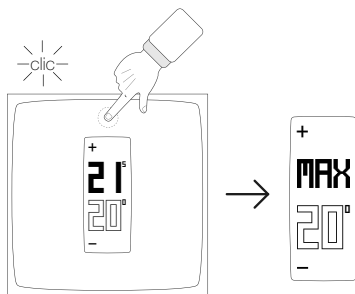

②

Tap the bottom of the **Thermostat** until you reach « OFF ».

The **Thermostat** switches off the boiler.

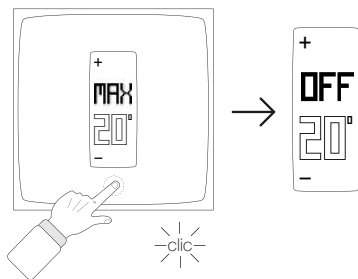

# Customisation

- ① You can choose to customise your **Thermostat** by using one of the **colour adhesives**.

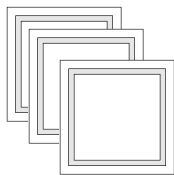

- ② Take off the outer frame of the **adhesive**.

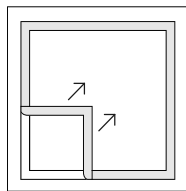

- ③ Stick it on the back of your **Thermostat**.

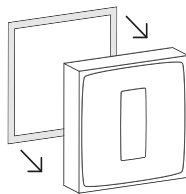

## Location

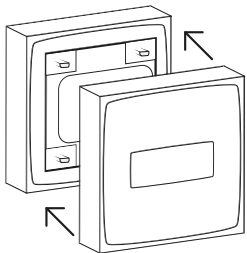

Clip the **Thermostat** on its **mobile stand** and place it on a shelf in the living room.

.....  
Or  
.....

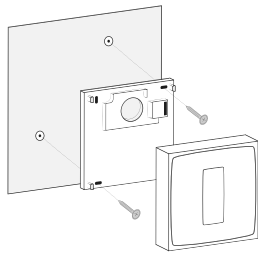

Set the **Thermostat** on the **mounting plate**.

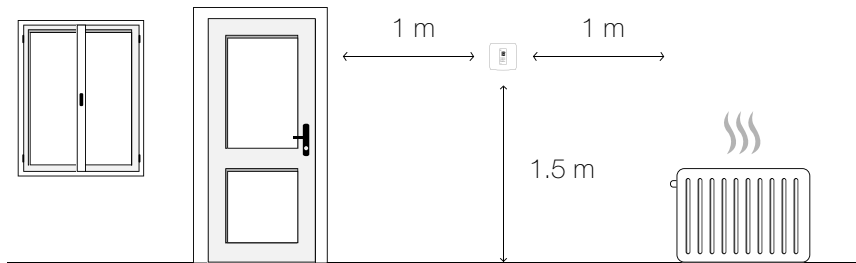

More than 1m from the openings

1.5m high

Away from any cold or heat source

App

To control and program your Thermostat from your smart-phone, tablet or computer, visit:

**<http://thermostat.netatmo.com>**



PC / Mac



Smartphone / Tabletes

# Specifications

## SIZE

Thermostat : 83x83x22 mm

## DESIGN

Designed by Starck.

Translucent minimalist plexiglass cube.

5 interchangeable colors in the box.

## SENSORS AND MEASUREMENTS

Température (measurement):

Ranges from 0°C to 50°C

Accuracy: +- 0.5° C

Température (setpoint):

Ranges from 7°C to 30°C

Increment: 0.5°C

Unit: °C

## E-INK DISPLAY

Energy efficient, longer battery life and optimal readability.

## FREE APP, LIFETIME SUPPORT

No subscription fee.

App available on the App Store and on Google Play.

Free access to your online personal dashboard.

Accessible from multiple devices.

## WIRELESS SPECIFICATIONS

Wi-Fi 802.11 b/g/n compatible (2.4GHz).

Supported security: Open/WEP/WPA/

WPA2-personal (TKIP and AES).

Wireless connection between thermostat and relay:  
radio long range 100m.

## POWER AND BATTERIES

3 AAA batteries.

1 year battery life.

## SETUP AND COMPATIBILITY

Compatible with gas, fuel and wood boilers.

Switching current: max 4 A

Switching voltage: max 250 VAC

Switching power: max 120 W

## COMPATIBLE WITH IPHONE AND IPAD

iPhone 4, iPhone 4s, iPhone 5, iPhone 5c / 5s

iPad mini, iPad mini with Retina display, iPad 2,

iPad (3rd generation), iPad (4th generation),

iPad Air

iPod touch (5th generation)

## COMPATIBLE WITH ANDROID SMARTPHONE

Android 4.0 required



## EU Declaration of Conformity

We, Netatmo, declare that this device is in compliance with the essential requirements and other relevant provisions of Directive 1999/5/EC.

### Safety warnings

This device must be installed according to the applicable norms.

Use only with supplied power plug adaptor and boiler adaptor. This device is for indoor use only. Before inserting the batteries, check that the contacts in the device and on the batteries are clean, and clean them if necessary. Note the polarity (+/-) when inserting the batteries.

Do not throw the batteries into a fire, short-circuit it or dismantle it. Keep children away from batteries. Seek medical attention immediately if a battery is swallowed.

Do not attempt to repair the device yourself; an after-sales service is available.

Any changes or modifications to this unit not expressly approved by the party responsible for compliance could void the user's authority to operate the equipment.

Thermostat and relay insulation: class II devices.

This device is not intended for use by persons (including children) with reduced physical, sensory or mental capabilities, or lack of experience and knowledge, unless they have been given supervision or instruction concerning use of the appliance by a person responsible for their safety. Children should be supervised to ensure that they do not play with the appliance.

### Legal notice

"Made for iPod", "Made for iPhone", "Made for iPad" mean that an electronic accessory has been designed to connect specifically to iPod, iPhone and iPad and has been certified by the developer to meet Apple performance standards. Apple is not responsible for the operation of this device or its compliance with safety and regulatory standards.

Please note that the use of this accessory with iPhone may affect wireless performance.



<http://support.netatmo.com>

