

# FUSES FOR SEMICONDUCTOR PROTECTION

## KNIFE BLADE CONTACT – GERMAN STANDARD



SIBA ultra-rapid knife blade contact fuses type NH are available in many different sizes and four voltage ratings. They follow DIN/VDE - IEC standard and can be fitted in open fuse bases. Usage in fuse bases or switches requires the comparison of the power loss of the fuse with the power acceptance of the base or switch.

All SIBA type NH-fuses are available with either integral blown fuse indicator or a separately fitted trip indicator fuse for microswitch operation.

Class: aR/gR

Sizes: 000 / 00 / 0 / 1 / 2 and 3

Voltage ratings: AC 500 V - 2000 V

Current ratings: 16 A up to 800 A

## Features / Benefits

- ▶ High interrupting rating up to 120 kA
- ▶ Voltage rating AC 500 V - AC 2000 V
- ▶ Compliance with DIN 43620 and DIN 43653 standard
- ▶ Fuses with blown fuse combination indicator
- ▶ Class aR according to IEC 60269-4 and DIN VDE 0636-40 and Class gR according to DIN VDE 0636-40
- ▶ Fuse bases / Switches and Accessories are available



**FUSES FOR SEMICONDUCTOR PROTECTION**  
**KNIFE BLADE CONTACT – GERMAN STANDARD**

**Selection Guide**

Size	Rated Voltage AC	Indicator Type	Part No.	Selector Guide Page	Techn. Data Page
000	500 V	combi indicator	20 000 04	URM 4	URM 23
00	500 V	combi indicator	20 001 04	URM 5	URM 23
0	500 V	combi indicator	20 002 04	URM 6	URM 24
1	500 V	combi indicator	20 003 04	URM 7	URM 25
2	500 V	combi indicator	20 004 04	URM 8	URM 26
3	500 V	combi indicator	20 005 04	URM 9	URM 27
000	690 V	combi indicator	20 477 20	URM 10	URM 28
00	690 V	combi indicator	20 209 20	URM 11	URM 28
1	690 V	combi indicator	20 211 20	URM 12	URM 29
2	690 V	combi indicator	20 212 20	URM 13	URM 30
3	690 V	combi indicator	20 213 20	URM 14	URM 31
00	500 V	signal indicator	20 007 04	URM 15	URM 23
1	500 V	signal indicator	20 009 04	URM 16	URM 25
2	500 V	signal indicator	20 010 04	URM 17	URM 26
3	500 V	signal indicator	20 011 04	URM 18	URM 27
0	1000 V	combi indicator	20 384 04	URM 19	URM 32
3	660 V	combi indicator	20 373 04	URM 20	URM 33
3	1000 V	topindicator	20 407 04	URM 21	URM 34
3	2000 V	topindicator	20 404 04	URM 22	URM 35



**FUSES FOR SEMICONDUCTOR PROTECTION**  
**KNIFE BLADE CONTACT – GERMAN STANDARD**

**Fuse base**

Size	Rated Voltage AC	with external microswitch	Part No.	Techn. Data Page		
00	500/690 V	–	21 001 01	URM 36		
00	500/690 V	–	21 001 10	URM 36		
1	500/690 V	–	21 003 01	URM 37		
2	500/690 V	–	21 004 01	URM 37		
3	500/690 V	–	21 005 01	URM 37		
00	500 V	yes	21 007 01	URM 38		
1	500 V	yes	21 009 01	URM 38		
2	500 V	yes	21 010 01	URM 38		
3	500 V	yes	21 011 01	URM 38		
0	1000 V		21 384 01	URM 39		



**FUSES FOR SEMICONDUCTOR PROTECTION**  
**KNIFE BLADE CONTACT – GERMAN STANDARD**

Size  
**000**

Rated voltage  
**AC 500 V**

**combi indicator**

Standard  
**DIN 43620**

Rated current	Part No.	UL Rec.	Class	Weight (kg/100)	Pack
6 A	20 000 04		gR	11.0	3
10 A	20 000 04		gR	11.0	3
16 A	20 000 04		gR	11.0	3
20 A	20 000 04		gR	11.0	3
25 A	20 000 04		gR	11.0	3
32 A	20 000 04		gR	11.0	3
40 A	20 000 04		gR	11.0	3
50 A	20 000 04		gR	11.0	3
63 A	20 000 04		gR	11.0	3
80 A	20 000 04		gR	11.0	3

- A<sub>max</sub>** 2.13" (54 mm)
- B** 0.60" (15 mm)
- C** 1.85" (47 mm)
- D** 0.80" (20.5 mm)
- E** 1.60" (40.5 mm)
- F** 0.24" (6 mm)
- G** 1.38" (35 mm)
- H** 2.05" (52 mm)
- I** 0.28" (7 mm)
- L** 3.07" (78 mm)

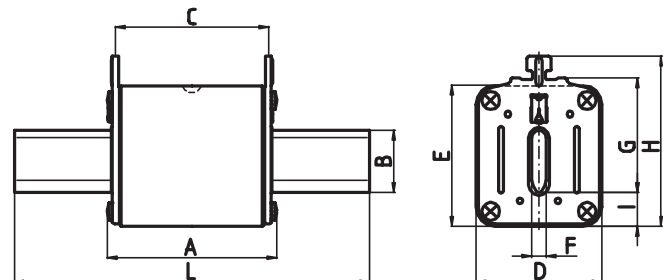

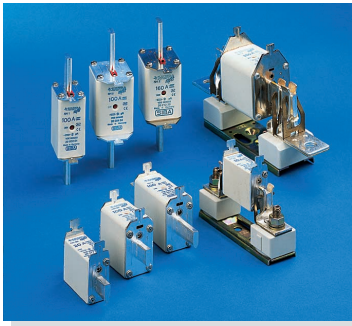

**FUSES FOR SEMICONDUCTOR PROTECTION**  
**KNIFE BLADE CONTACT – GERMAN STANDARD**

<b>Size</b> <b>00</b>	<b>Rated voltage</b> <b>AC 500 V</b>	<b>combi indicator</b>	<b>Standard</b> <b>DIN 43620</b>
--------------------------	---	------------------------	-------------------------------------

Rated current	Part No.	UL Rec.	Class	Weight (kg/100)	Pack
100 A	20 001 04		gR	15.4	3
125 A	20 001 04		aR	15.4	3
160 A	20 001 04		aR	15.4	3

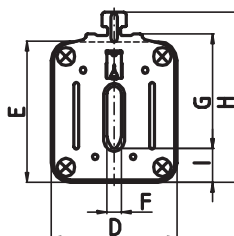
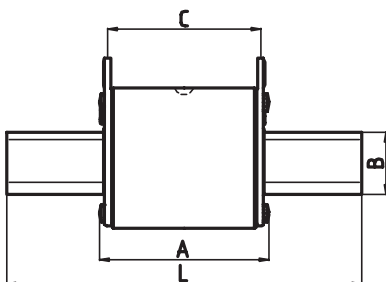

<b>A<sub>max</sub></b>	<b>2.13" (54 mm)</b>
<b>B</b>	<b>0.60" (15 mm)</b>
<b>C</b>	<b>1.85" (47 mm)</b>
<b>D</b>	<b>1.16" (29.5 mm)</b>
<b>E</b>	<b>1.80" (46 mm)</b>
<b>F</b>	<b>0.24" (6 mm)</b>
<b>G</b>	<b>1.38" (35 mm)</b>
<b>H</b>	<b>2.28" (58 mm)</b>
<b>I</b>	<b>0.50" (13 mm)</b>
<b>L</b>	<b>3.07" (78 mm)</b>



**FUSES FOR SEMICONDUCTOR PROTECTION**  
**KNIFE BLADE CONTACT – GERMAN STANDARD**

Size **0**      Rated voltage **AC 500 V**      **combi indicator**      Standard **DIN 43620**

Rated current	Part No.	UL Rec.	Class	Weight (kg/100)	Pack
16 A	20 002 04		gR	24	3
20 A	20 002 04		gR	24	3
25 A	20 002 04		gR	24	3
32 A	20 002 04		gR	24	3
40 A	20 002 04		gR	24	3
50 A	20 002 04		gR	24	3
63 A	20 002 04		gR	24	3
80 A	20 002 04		gR	24	3
100 A	20 002 04		gR	24	3
125 A	20 002 04		aR	24	3
160 A	20 002 04		aR	24	3

- A<sub>max</sub> 2.80" (71.5 mm)
- B 0.60" (15 mm)
- C 2.56" (65 mm)
- D 1.16" (29.5 mm)
- E 1.80" (46 mm)
- F 0.24" (6 mm)
- G 1.38" (35 mm)
- H 2.28" (58 mm)
- I 0.50" (13 mm)
- L 4.92" (125 mm)

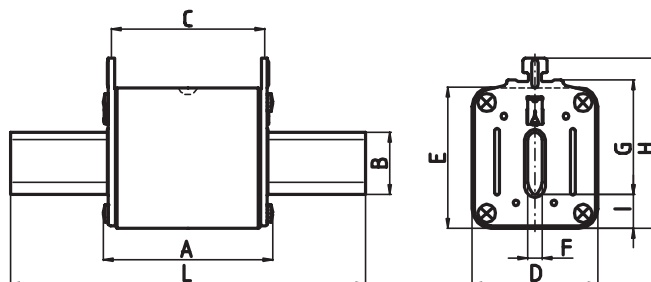

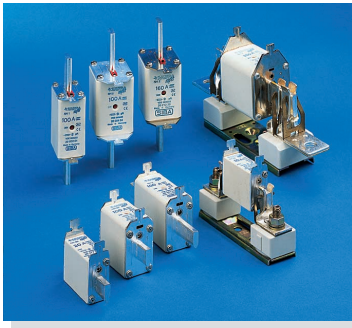

**FUSES FOR SEMICONDUCTOR PROTECTION**  
**KNIFE BLADE CONTACT – GERMAN STANDARD**

**Size 1**      **Rated voltage AC 500 V**      **combi indicator**      **Standard DIN 43620/1**

Rated current	Part No.	UL Rec.	Class	Weight (kg/100)	Pack
63 A	20 003 04		gR	27	3
80 A	20 003 04		gR	27	3
100 A	20 003 04		gR	27	3
125 A	20 003 04		aR	27	3
160 A	20 003 04		aR	27	3
200 A	20 003 04		aR	37	3
250 A	20 003 04		aR	37	3
315 A	20 003 04		aR	37	3

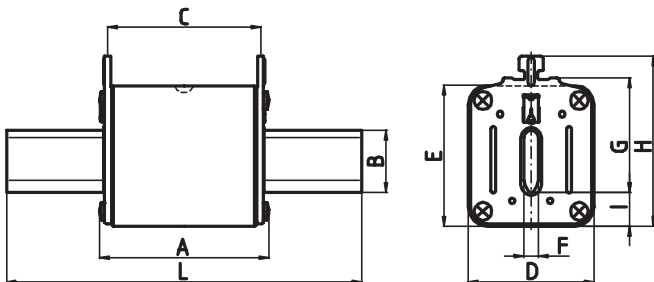

	20 003 04 ≤ 160 A	20 003 04 ≥ 200 A
A <sub>max</sub>	2.95" (75 mm)	A <sub>max</sub> 2.95" (75 mm)
B	0.80" (20 mm)	B 0.80" (20 mm)
C	2.56" (65 mm)	C 2.56" (65 mm)
D	1.16" (29.5 mm)	D 1.65" (42 mm)
E	1.80" (46 mm)	E 2.03" (51.5 mm)
F	0.24" (6 mm)	F 0.24" (6 mm)
G	1.57" (40 mm)	G 1.57" (40 mm)
H	2.28" (58 mm)	H 2.52" (64 mm)
I	0.30" (8 mm)	I 0.55" (14 mm)
L	5.30" (135 mm)	L 5.30" (135 mm)

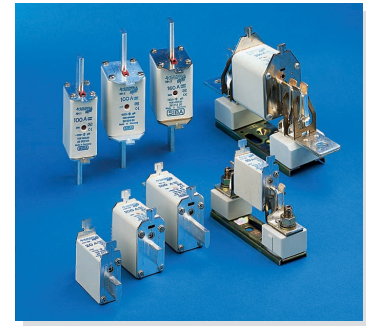

**FUSES FOR SEMICONDUCTOR PROTECTION**  
KNIFE BLADE CONTACT – GERMAN STANDARD

Size **2**      Rated voltage **AC 500 V**      Standard **DIN 43620/1**  
combi indicator

Rated current	Part No.	UL Rec.	Class	Weight (kg/100)	Pack
32 A	20 004 04		gR	37	3
40 A	20 004 04		gR	37	3
50 A	20 004 04		gR	37	3
63 A	20 004 04		gR	37	3
80 A	20 004 04		gR	37	3
100 A	20 004 04		gR	37	3
125 A	20 004 04		aR	37	3
160 A	20 004 04		aR	37	3
200 A	20 004 04		aR	37	3
250 A	20 004 04		aR	37	3
315 A	20 004 04		aR	65	3
355 A	20 004 04		aR	65	3
400 A	20 004 04		aR	65	3

20 004 04 ≤ 250 A		20 004 04 ≥ 315 A	
A <sub>max</sub>	2.95" (75 mm)	A <sub>max</sub>	2.95" (75 mm)
B	0.80" (20 mm)	B	1.02" (26 mm)
C	2.56" (65 mm)	C	2.56" (65 mm)
D	1.65" (42 mm)	D	2.10" (53 mm)
E	2.03" (51.5 mm)	E	2.32" (59 mm)
F	0.24" (6 mm)	F	0.24" (6 mm)
G	1.90" (48 mm)	G	1.90" (48 mm)
H	2.83" (72 mm)	H	2.83" (72 mm)
I	0.55" (14 mm)	I	0.55" (14 mm)
L	5.90" (150 mm)	L	5.90" (150 mm)

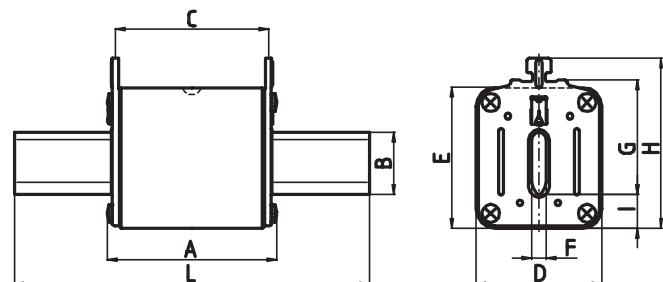





**FUSES FOR SEMICONDUCTOR PROTECTION**  
**KNIFE BLADE CONTACT – GERMAN STANDARD**

**Size 3**      **Rated voltage AC 500 V**      **combi indicator**      **Standard DIN 43620/1**

Rated current	Part No.	UL Rec.	Class	Weight (kg/100)	Pack
160 A	20 005 04		aR	65	3
200 A	20 005 04		aR	65	3
224 A	20 005 04		aR	65	3
250 A	20 005 04		aR	65	3
315 A	20 005 04		aR	65	3
400 A	20 005 04		aR	65	3
500 A	20 005 04		aR	88	3
630 A	20 005 04		aR	88	3

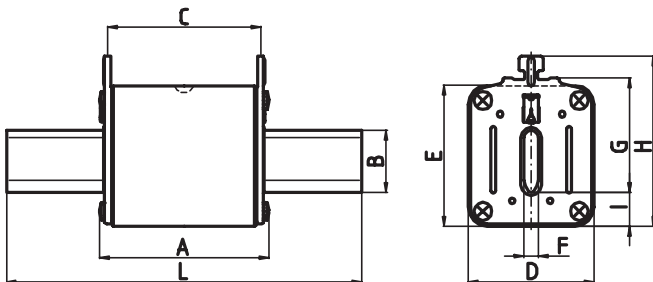

	20 005 04 ≤ 400 A	20 005 04 ≥ 425 A
A <sub>max</sub>	2.95" (75 mm)	2.95" (75 mm)
B	1.02" (26 mm)	1.26" (32 mm)
C	2.56" (65 mm)	2.56" (65 mm)
D	2.10" (53 mm)	2.56" (65 mm)
E	2.32" (59 mm)	2.90" (73.5 mm)
F	0.24" (6 mm)	0.24" (6 mm)
G	2.36" (60 mm)	2.36" (60 mm)
H	3.27" (83 mm)	3.40" (86 mm)
I	0.55" (14 mm)	0.67" (17 mm)
L	5.90" (150 mm)	5.90" (150 mm)



**FUSES FOR SEMICONDUCTOR PROTECTION**  
KNIFE BLADE CONTACT – GERMAN STANDARD

Size  
**000**

Rated voltage  
**AC 690 V**

**combi indicator**

Standard  
**DIN 43620/1**

Rated current	Part No.	UL Rec.	Class	Weight (kg/100)	Pack
10 A	20 477 20		gR	11	3
16 A	20 477 20		gR	11	3
20 A	20 477 20		gR	11	3
25 A	20 477 20		gR	11	3
32 A	20 477 20		gR	11	3
40 A	20 477 20		gR	11	3
50 A	20 477 20		gR	11	3

- A<sub>max</sub> 2.13" (54 mm)
- B 0.60" (15 mm)
- C 1.85" (47 mm)
- D 0.80" (20.5 mm)
- E 1.60" (40.5 mm)
- F 0.24" (6 mm)
- G 1.38" (35 mm)
- H 2.05" (52 mm)
- I 0.28" (7 mm)
- L 3.07" (78 mm)

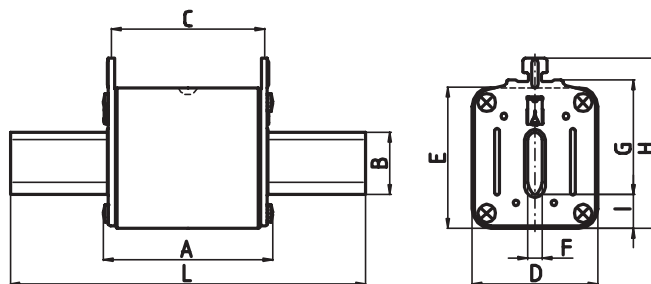

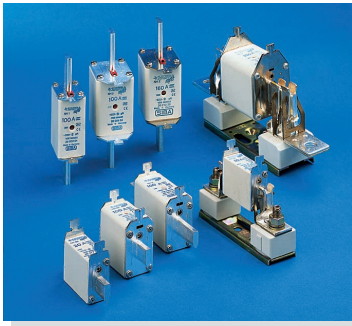

**FUSES FOR SEMICONDUCTOR PROTECTION**  
**KNIFE BLADE CONTACT – GERMAN STANDARD**

<b>Size</b> <b>00</b>	<b>Rated voltage</b> <b>AC 690 V</b>	<b>combi indicator</b>	<b>Standard</b> <b>DIN 43620/1</b>
--------------------------	---	------------------------	---------------------------------------

Rated current	Part No.	UL Rec.	Class	Weight (kg/100)	Pack
63 A	20 209 20		gR	15.4	3
80 A	20 209 20		gR	15.4	3
100 A	20 209 20		gR	15.4	3
125 A	20 209 20		aR	15.4	3
160 A	20 209 20		aR	15.4	3

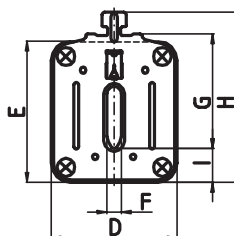
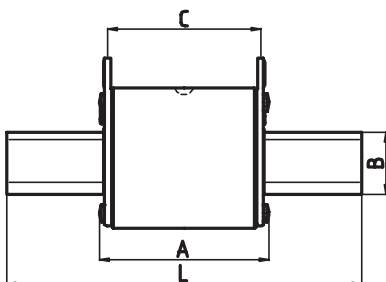

<b>A<sub>max</sub></b>	<b>2.13" (54 mm)</b>
<b>B</b>	<b>0.60" (15 mm)</b>
<b>C</b>	<b>1.85" (47 mm)</b>
<b>D</b>	<b>1.16" (29.5 mm)</b>
<b>E</b>	<b>1.80" (46 mm)</b>
<b>F</b>	<b>0.24" (6 mm)</b>
<b>G</b>	<b>1.38" (35 mm)</b>
<b>H</b>	<b>2.28" (58 mm)</b>
<b>I</b>	<b>0.50" (13 mm)</b>
<b>L</b>	<b>3.07" (78 mm)</b>



**FUSES FOR SEMICONDUCTOR PROTECTION**  
**KNIFE BLADE CONTACT – GERMAN STANDARD**

Size  
**1**

Rated voltage  
**AC 690 V**

**combi indicator**

Standard  
**DIN 43620/1**

Rated current	Part No.	UL Rec.	Class	Weight (kg/100)	Pack
16 A	20 211 20		gR	37	3
20 A	20 211 20		gR	37	3
25 A	20 211 20		gR	37	3
32 A	20 211 20		gR	37	3
40 A	20 211 20		gR	37	3
50 A	20 211 20		gR	37	3
63 A	20 211 20		gR	37	3
80 A	20 211 20		gR	37	3
100 A	20 211 20		gR	37	3
125 A	20 211 20		aR	37	3
160 A	20 211 20		aR	37	3
200 A	20 211 20		aR	37	3
250 A	20 211 20		aR	37	3
315 A	20 211 20		aR	37	3

- A<sub>max</sub> 2.95" (75 mm)
- B 0.80" (20 mm)
- C 2.56" (65 mm)
- D 1.65" (42 mm)
- E 2.03" (51.5 mm)
- F 0.24" (6 mm)
- G 1.57" (40 mm)
- H 2.52" (64 mm)
- I 0.55" (14 mm)
- L 5.30" (135 mm)

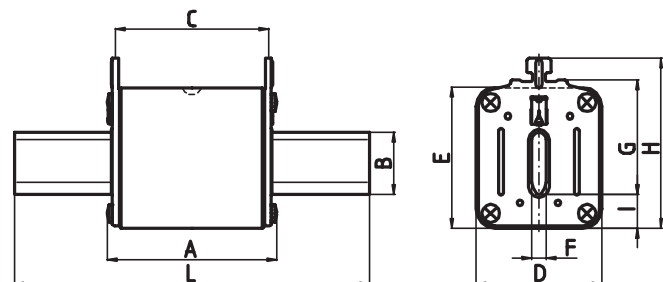

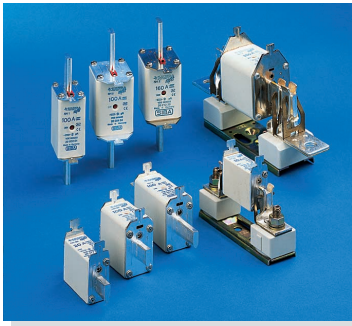

**FUSES FOR SEMICONDUCTOR PROTECTION**  
**KNIFE BLADE CONTACT – GERMAN STANDARD**

<b>Size</b> <b>2</b>	<b>Rated voltage</b> <b>AC 690 V</b>	<b>combi indicator</b>	<b>Standard</b> <b>DIN 43620/1</b>
-------------------------	---	------------------------	---------------------------------------

Rated current	Part No.	UL Rec.	Class	Weight (kg/100)	Pack
160 A	20 212 20		aR	37	3
200 A	20 212 20		aR	37	3
250 A	20 212 20		aR	37	3
315 A	20 212 20		aR	65	3
350 A	20 212 20		aR	65	3
400 A	20 212 20		aR	65	3
450 A	20 212 20		aR	65	3

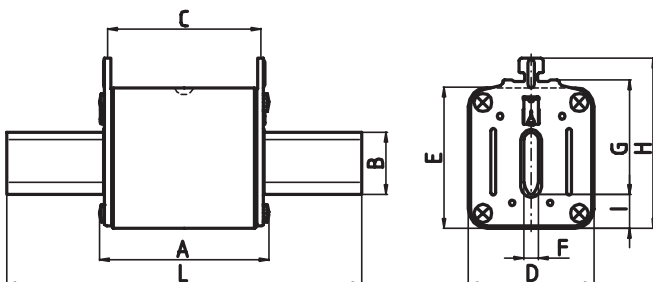

	<b>20 212 20</b> <b>≤ 250 A</b>	<b>20 212 20</b> <b>≥ 315 A</b>
<b>A<sub>max</sub></b>	2.95" (75 mm)	2.95" (75 mm)
<b>B</b>	0.80" (20 mm)	1.02" (26 mm)
<b>C</b>	2.56" (65 mm)	2.56" (65 mm)
<b>D</b>	1.65" (42 mm)	2.10" (53 mm)
<b>E</b>	2.03" (51.5 mm)	2.32" (59 mm)
<b>F</b>	0.24" (6 mm)	0.24" (6 mm)
<b>G</b>	1.90" (48 mm)	1.90" (48 mm)
<b>H</b>	2.83" (72 mm)	2.83" (72 mm)
<b>I</b>	0.55" (14 mm)	0.55" (14 mm)
<b>L</b>	5.90" (150 mm)	5.90" (150 mm)

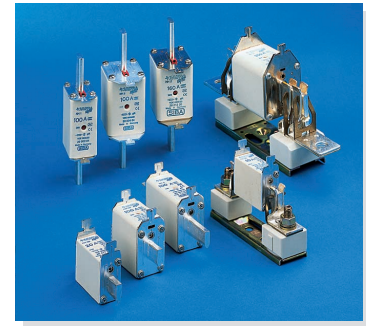

**FUSES FOR SEMICONDUCTOR PROTECTION**  
**KNIFE BLADE CONTACT – GERMAN STANDARD**

Size  
**3**

Rated voltage  
**AC 690 V**

**combi indicator**

Standard  
**DIN 43620/1**

Rated current	Part No.	UL Rec.	Class	Weight (kg/100)	Pack
315 A	20 213 20		aR	65	3
355 A	20 213 20		aR	65	3
400 A	20 213 20		aR	65	3
450 A	20 213 20		aR	88	3
500 A	20 213 20		aR	88	3
550 A	20 213 20		aR	88	3
630 A	20 213 20		aR	88	3
710 A	20 213 20		aR	88	3

**20 213 20**  
**≤ 400 A**

**20 213 20**  
**≥ 450 A**

<b>A<sub>max</sub></b>	<b>2.95"</b> (75 mm)
<b>B</b>	<b>1.02"</b> (26 mm)
<b>C</b>	<b>2.56"</b> (65 mm)
<b>D</b>	<b>2.10"</b> (53 mm)
<b>E</b>	<b>2.32"</b> (59 mm)
<b>F</b>	<b>0.24"</b> (6 mm)
<b>G</b>	<b>2.36"</b> (60 mm)
<b>H</b>	<b>3.27"</b> (83 mm)
<b>I</b>	<b>0.55"</b> (14 mm)
<b>L</b>	<b>5.90"</b> (150 mm)

<b>A<sub>max</sub></b>	<b>2.95"</b> (75 mm)
<b>B</b>	<b>1.26"</b> (32 mm)
<b>C</b>	<b>2.56"</b> (65 mm)
<b>D</b>	<b>2.56"</b> (65 mm)
<b>E</b>	<b>2.90"</b> (73.5 mm)
<b>F</b>	<b>0.24"</b> (6 mm)
<b>G</b>	<b>2.36"</b> (60 mm)
<b>H</b>	<b>3.40"</b> (86 mm)
<b>I</b>	<b>0.67"</b> (17 mm)
<b>L</b>	<b>5.90"</b> (150 mm)

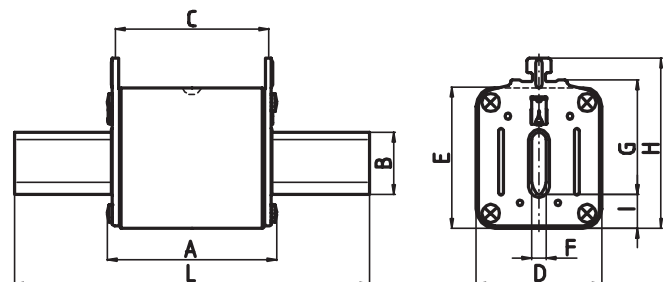



**FUSES FOR SEMICONDUCTOR PROTECTION**  
**KNIFE BLADE CONTACT – GERMAN STANDARD**

<b>Size</b> <b>00</b>	<b>Rated voltage</b> <b>AC 500 V</b>	<b>signal indicator</b>	<b>Standard</b> <b>DIN 43620</b>
--------------------------	---	-------------------------	-------------------------------------

Rated current	Part No.	UL Rec.	Class	Weight (kg/100)	Pack
16 A	20 007 04		gR	19	3
20 A	20 007 04		gR	19	3
25 A	20 007 04		gR	19	3
32 A	20 007 04		gR	19	3
40 A	20 007 04		gR	19	3
50 A	20 007 04		gR	19	3
63 A	20 007 04		gR	19	3
80 A	20 007 04		gR	19	3
100 A	20 007 04		gR	19	3
125 A	20 007 04		aR	19	3
160 A	20 007 04		aR	19	3

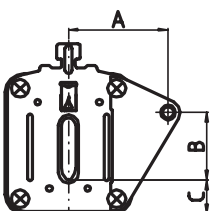

<b>A</b>	<b>0.90" (23 mm)</b>
<b>B</b>	<b>0.67" (17 mm)</b>
<b>C</b>	<b>0.50" (13 mm)</b>

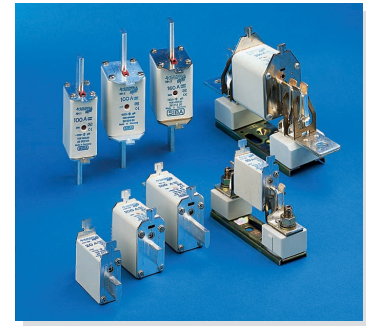

**FUSES FOR SEMICONDUCTOR PROTECTION**  
**KNIFE BLADE CONTACT – GERMAN STANDARD**

Size  
**1**

Rated voltage  
**AC 500 V**

signal indicator

Standard  
**DIN 43620/1**

Rated current	Part No.	UL Rec.	Class	Weight (kg/100)	Pack
63 A	20 009 04		gR	40	3
80 A	20 009 04		gR	40	3
100 A	20 009 04		gR	40	3
125 A	20 009 04		aR	40	3
160 A	20 009 04		aR	40	3
200 A	20 009 04		aR	40	3
250 A	20 009 04		aR	40	3
315 A	20 009 04		aR	40	3

- A** 1.20" (30.5 mm)
- B** 0.94" (24 mm)
- C** 0.55" (14 mm)

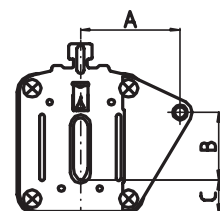



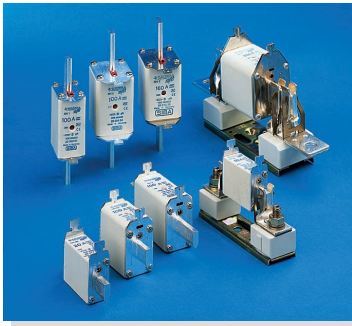

**FUSES FOR SEMICONDUCTOR PROTECTION**  
**KNIFE BLADE CONTACT – GERMAN STANDARD**

<b>Size</b> <b>2</b>	<b>Rated voltage</b> <b>AC 500 V</b>	<b>signal indicator</b>	<b>Standard</b> <b>DIN 43620/1</b>
-------------------------	---	-------------------------	---------------------------------------

Rated current	Part No.	UL Rec.	Class	Weight (kg/100)	Pack
32 A	20 010 04	✓	gR	70	3
40 A	20 010 04	✓	gR	70	3
50 A	20 010 04	✓	gR	70	3
63 A	20 010 04	✓	gR	70	3
80 A	20 010 04	✓	gR	70	3
100 A	20 010 04	✓	gR	70	3
125 A	20 010 04	✓	aR	70	3
160 A	20 010 04	✓	aR	70	3
200 A	20 010 04	✓	aR	70	3
250 A	20 010 04	✓	aR	70	3
355 A	20 010 04	✓	aR	70	3
315 A	20 010 04	✓	aR	70	3
400 A	20 010 04	✓	aR	70	3

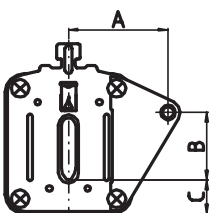

<b>A</b>	<b>1.65" (42 mm)</b>
<b>B</b>	<b>1.10" (28 mm)</b>
<b>C</b>	<b>0.55" (14 mm)</b>



**FUSES FOR SEMICONDUCTOR PROTECTION**  
**KNIFE BLADE CONTACT – GERMAN STANDARD**

Size  
**3**

Rated voltage  
**AC 500 V**

signal indicator

Standard  
**DIN 43620/1**

Rated current	Part No.	UL Rec.	Class	Weight (kg/100)	Pack
160 A	20 011 04		aR	90	3
200 A	20 011 04		aR	90	3
224 A	20 011 04		aR	90	3
250 A	20 011 04		aR	90	3
400 A	20 011 04		aR	90	3
500 A	20 011 04		aR	90	3
630 A	20 011 04		aR	90	3

- A** 1.73" (44 mm)
- B** 1.52" (38.5 mm)
- C** 0.67" (17 mm)

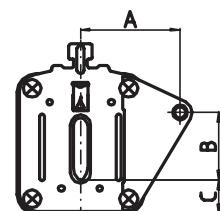

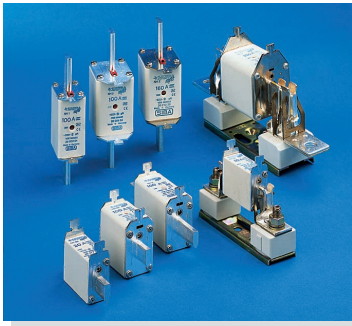

**FUSES FOR SEMICONDUCTOR PROTECTION**  
**KNIFE BLADE CONTACT – GERMAN STANDARD**

<b>Size</b> <b>0</b>	<b>Rated voltage</b> <b>AC 1000 V</b>	<b>combi indicator</b>	<b>Standard</b> <b>DIN 43620/1</b>
-------------------------	--	------------------------	---------------------------------------

Rated current	Part No.	UL Rec.	Class	Weight (kg/100)	Pack
16 A	20 384 04	✓	gR	24	6
20 A	20 384 04	✓	gR	24	6
25 A	20 384 04	✓	gR	24	6
32 A	20 384 04	✓	gR	24	6
40 A	20 384 04	✓	gR	24	6
50 A	20 384 04	✓	gR	24	6
63 A	20 384 04	✓	aR	24	6
80 A	20 384 04	✓	aR	24	6
100 A	20 384 04	✓	aR	24	6
125 A	20 384 04	✓	aR	24	6
160 A	20 384 04	✓	aR	24	6

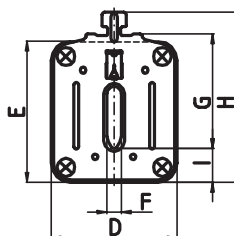
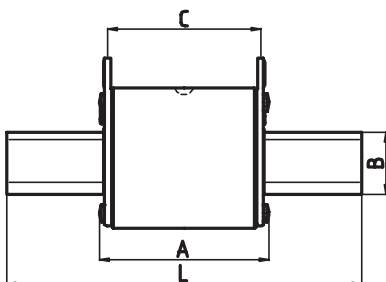

<b>A<sub>max</sub></b>	<b>2.80"</b> (71.5 mm)
<b>B</b>	<b>0.60"</b> (15 mm)
<b>C</b>	<b>2.56"</b> (65 mm)
<b>D</b>	<b>1.16"</b> (29.5 mm)
<b>E</b>	<b>1.80"</b> (46 mm)
<b>F</b>	<b>0.24"</b> (6 mm)
<b>G</b>	<b>1.38"</b> (35 mm)
<b>H</b>	<b>2.28"</b> (58 mm)
<b>I</b>	<b>0.50"</b> (13 mm)
<b>L</b>	<b>4.92"</b> (125 mm)

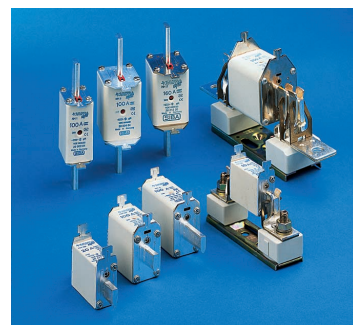

**FUSES FOR SEMICONDUCTOR PROTECTION**  
KNIFE BLADE CONTACT – GERMAN STANDARD

Size  
**3**

Rated voltage  
**AC 660 V**

**combi indicator**

Rated current	Part No.	UL Rec.	Class	Weight (kg/100)	Pack
150 A	20 373 04		gR	83	6
200 A	20 373 04		gR	83	6
250 A	20 373 04		gR	83	6
300 A	20 373 04		gR	83	6
350 A	20 373 04		gR	83	6
400 A	20 373 04		gR	83	6
500 A	20 373 04		gR	83	6

- A<sub>max</sub> 2.95" (75 mm)
- B 1.26" (32 mm)
- C 2.56" (65 mm)
- D 2.56" (65 mm)
- E 2.90" (73.5 mm)
- F 0.24" (6 mm)
- G 2.36" (60 mm)
- H 3.40" (86 mm)
- I 0.67" (17 mm)
- J 0.43" (11 mm)
- K 4.20" (107 mm)
- L 5.47" (139 mm)

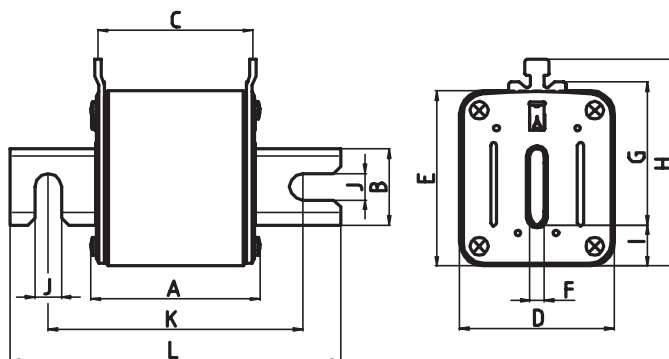

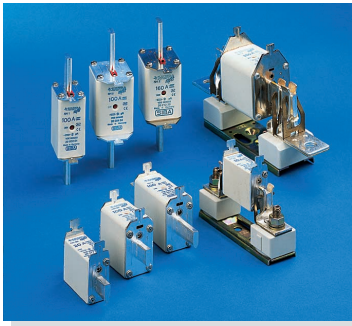

**FUSES FOR SEMICONDUCTOR PROTECTION**  
**KNIFE BLADE CONTACT – GERMAN STANDARD**

**Size 3**      **Rated voltage AC 1000 V**      **topindicator**

Rated current	Part No.	UL Rec.	Class	Weight (kg/100)	Pack
100 A	20 407 04		aR	110	1
125 A	20 407 04		aR	110	1
160 A	20 407 04		aR	110	1
200 A	20 407 04		aR	110	1
250 A	20 407 04		aR	110	1
315 A	20 407 04		aR	110	1
355 A	20 407 04		aR	110	1
400 A	20 407 04		aR	110	1
450 A	20 407 04		aR	110	1
500 A	20 407 04		aR	110	1

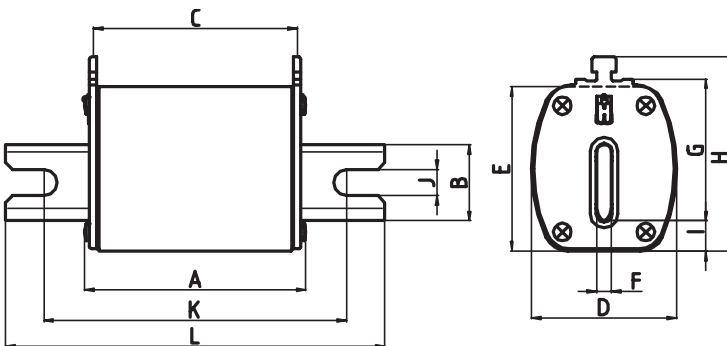

<b>A<sub>max</sub></b>	<b>3.74" (95 mm)</b>
<b>B</b>	<b>1.26" (32 mm)</b>
<b>C</b>	<b>3.35" (85 mm)</b>
<b>D</b>	<b>2.40" (61 mm)</b>
<b>E</b>	<b>2.72" (69 mm)</b>
<b>F</b>	<b>0.24" (6 mm)</b>
<b>G</b>	<b>2.36" (60 mm)</b>
<b>H</b>	<b>3.20" (81.5 mm)</b>
<b>I</b>	<b>0.50" (13 mm)</b>
<b>J</b>	<b>0.43" (11 mm)</b>
<b>K</b>	<b>5.00" (127 mm)</b>
<b>L</b>	<b>6.30" (160 mm)</b>



**FUSES FOR SEMICONDUCTOR PROTECTION**  
**KNIFE BLADE CONTACT – GERMAN STANDARD**

Size  
**3**

Rated voltage  
**AC 2000 V**

**topindicator**

Rated current	Part No.	UL Rec.	Class	Weight (kg/100)	Pack
200 A	20 404 04		aR	170	1
224 A	20 404 04		aR	170	1
250 A	20 404 04		aR	170	1
300 A	20 404 04		aR	170	1
315 A	20 404 04		aR	170	1
355 A	20 404 04		aR	170	1
400 A	20 404 04		aR	170	1
450 A	20 404 04		aR	170	1

- A<sub>max</sub> 7.10" (180 mm)
- B 1.26" (32 mm)
- C 6.50" (165 mm)
- D 2.40" (61 mm)
- E 2.72" (69 mm)
- F 0.24" (6 mm)
- G 2.36" (60 mm)
- H 3.20" (81.5 mm)
- I 0.50" (13 mm)
- J 0.43" (11 mm)
- K 8.20" (208 mm)
- L 9.45" (240 mm)

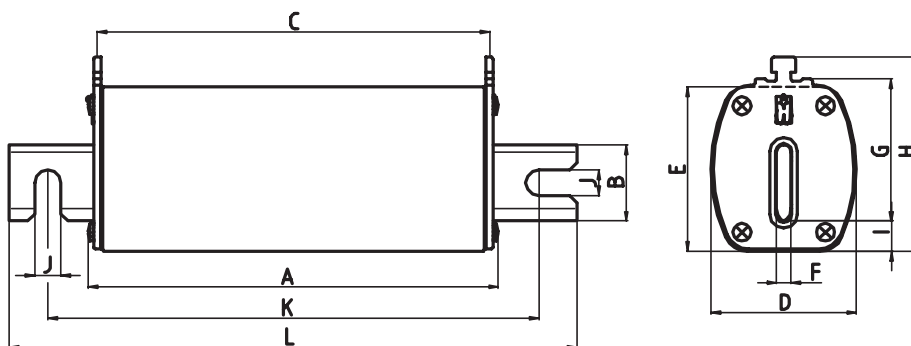

Size <b>000/00</b>	Rated voltage <b>AC 500 V</b>	Operating class <b>≤ 100 A gR / &gt; 100 A aR</b>	Rated breaking capacity <b>120 kA</b>
-----------------------	----------------------------------	--	--

Rated current	Part No. with combi indicator	Part No. with signal indicator	Power loss W	Pre-arcing I <sup>2</sup> t-value A <sup>2</sup> t	Total I <sup>2</sup> t-value @ 500 V A <sup>2</sup> t
16 A	20 000 04	20 007 04	4.8	10	140
20 A	20 000 04	20 007 04	5.7	17	185
25 A	20 000 04	20 007 04	6.7	20	305
32 A	20 000 04	20 007 04	8.1	67	460
35 A	20 000 04	20 007 04	9	82	650
40 A	20 000 04	20 007 04	10	90	800
50 A	20 000 04	20 007 04	12	190	1,400
63 A	20 000 04	20 007 04	14	330	2,600
80 A	20 000 04	20 007 04	19	510	4,200
100 A	20 001 04	20 007 04	21	920	7,600
125 A	20 001 04	20 007 04	25	1,660	12,300
160 A	20 001 04	20 007 04	30	2,800	19,500

Cut-off-characteristics

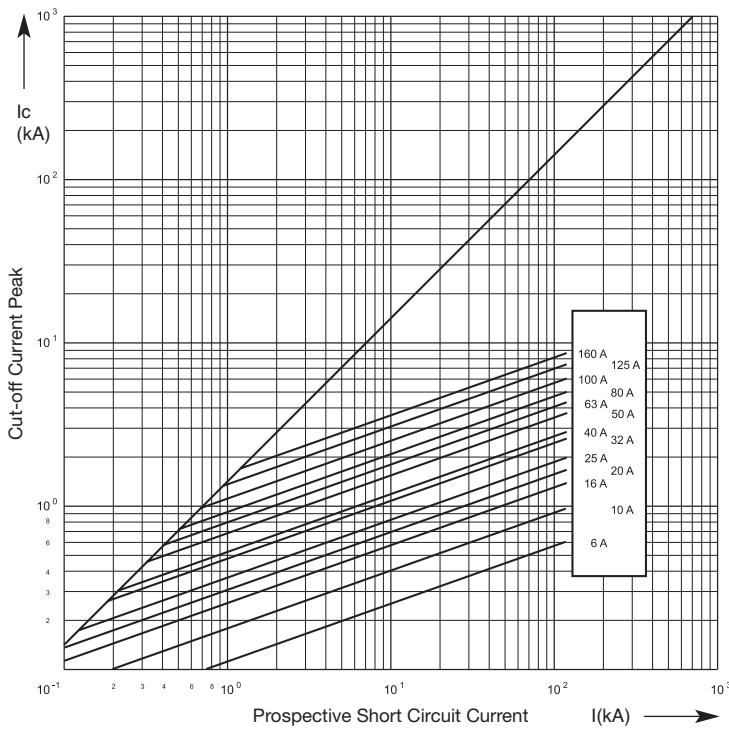

Time / Current Characteristics

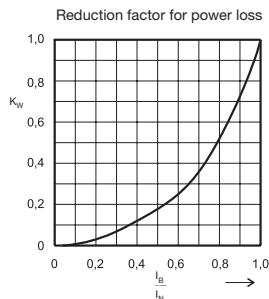
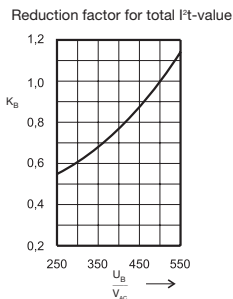
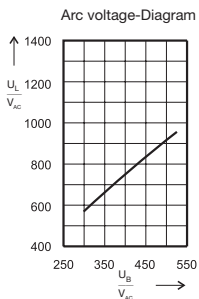
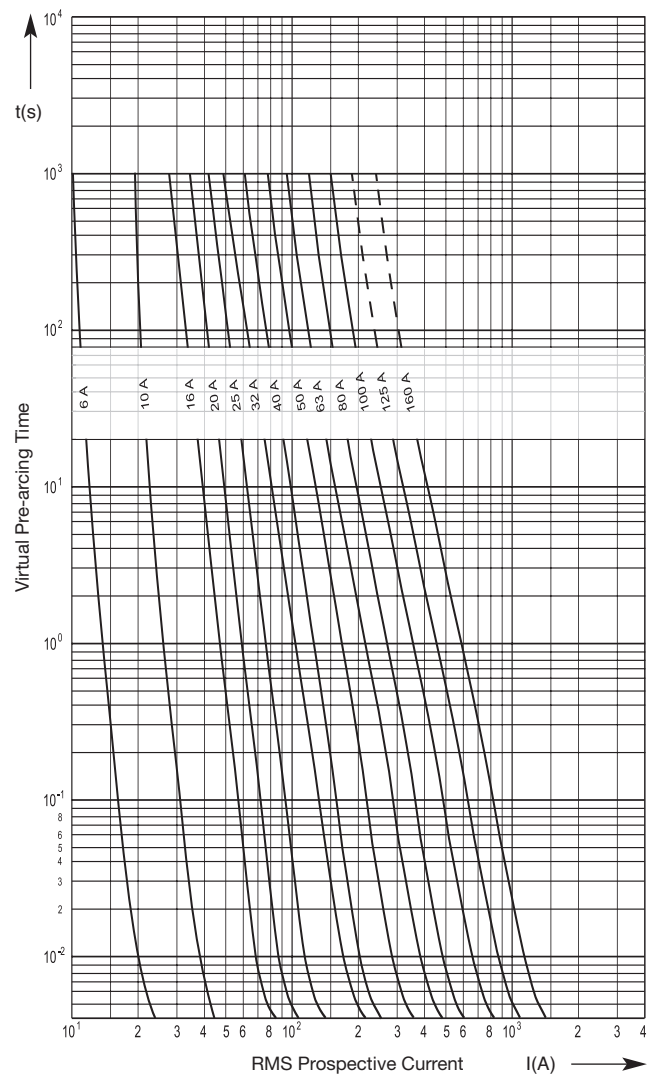

Size <b>0</b>	Rated voltage <b>AC 500 V</b>	Operating class <b>≤ 100 A gR / &gt; 100 A aR</b>	Rated breaking capacity <b>120 kA</b>
------------------	----------------------------------	--	--

Rated current	Part No. with combi indicator	Power loss W	Pre-arcing I <sup>2</sup> t-value A <sup>2</sup> t	Total I <sup>2</sup> t-value @ 500 V A <sup>2</sup> t
16 A	20 002 04	6.1	10	140
20 A	20 002 04	7.2	17	185
25 A	20 002 04	8.6	20	305
32 A	20 002 04	10	67	460
35 A	20 002 04	11	82	650
40 A	20 002 04	12	90	800
50 A	20 002 04	15	190	1,400
63 A	20 002 04	18	330	2,600
80 A	20 002 04	21	510	4,200
100 A	20 002 04	25	920	7,600
125 A	20 002 04	30	1,660	12,300
160 A	20 002 04	36	2,800	19,500

Cut-off-characteristics

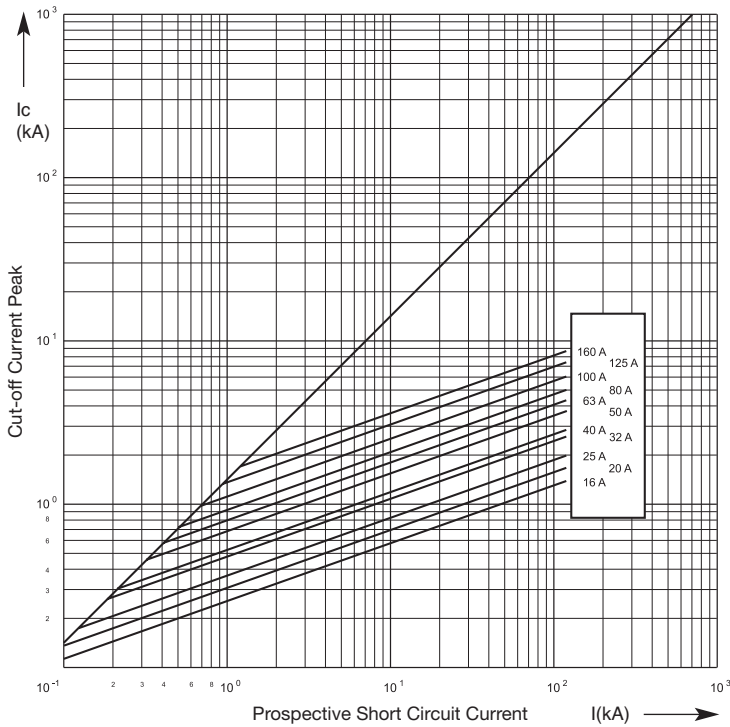

Time / Current Characteristics

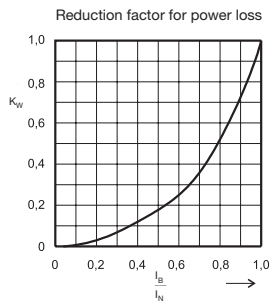
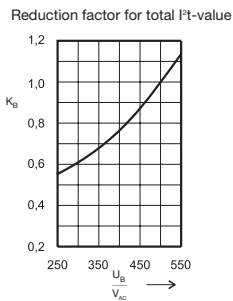
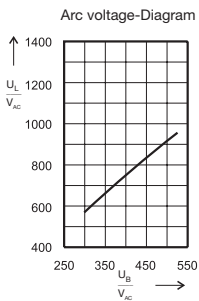
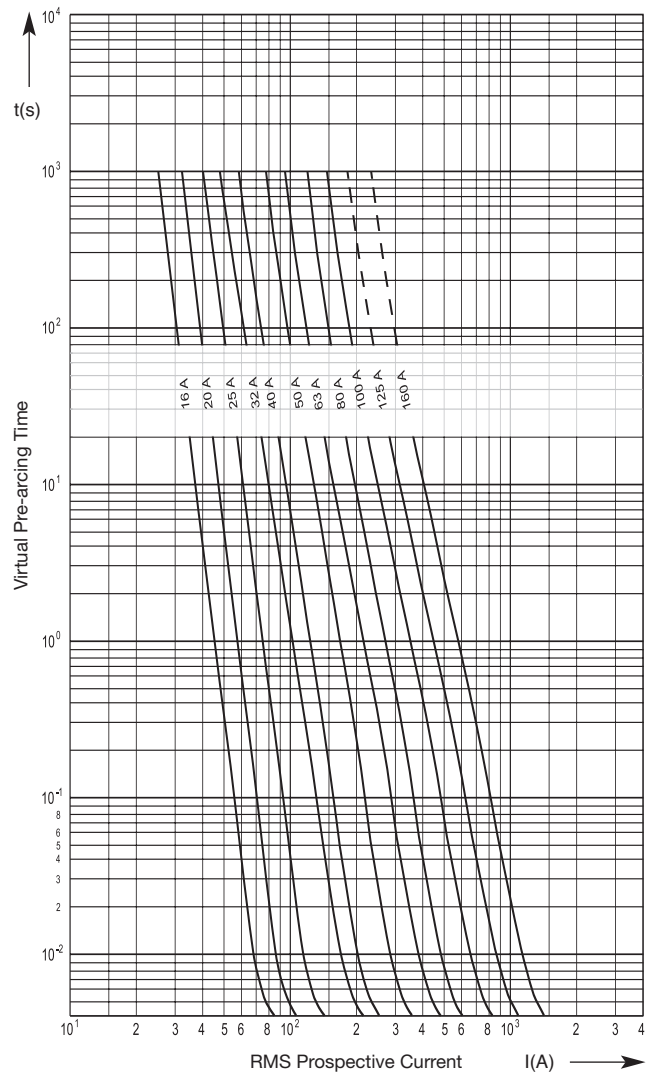



<b>Size</b> <b>1</b>	<b>Rated voltage</b> <b>AC 500 V</b>	<b>Operating class</b> <b>gR</b>	<b>Rated breaking capacity</b> <b>120 kA</b>
-------------------------	---	-------------------------------------	---

Rated current	Part No. with combi indicator	Part No. with signal indicator	Power loss W	Pre-arcing I <sup>2</sup> t-value A <sup>2</sup> t	Total I <sup>2</sup> t-value @ 500 V A <sup>2</sup> t
63 A	20 003 04	20 009 04	18	330	2,600
80 A	20 003 04	20 009 04	22	510	4,200
100 A	20 003 04	20 009 04	27	920	7,600
125 A	20 003 04	20 009 04	33	4,100	12,300
160 A	20 003 04	20 009 04	40	1,660	19,500
200 A	20 003 04	20 009 04	40	2,400	37,000
224 A	20 003 04	20 009 04	53	5,800	42,000
250 A	20 003 04	20 009 04	62	9,600	55,000
315 A	20 003 04	20 009 04	79	14,000	90,000

Cut-off-characteristics

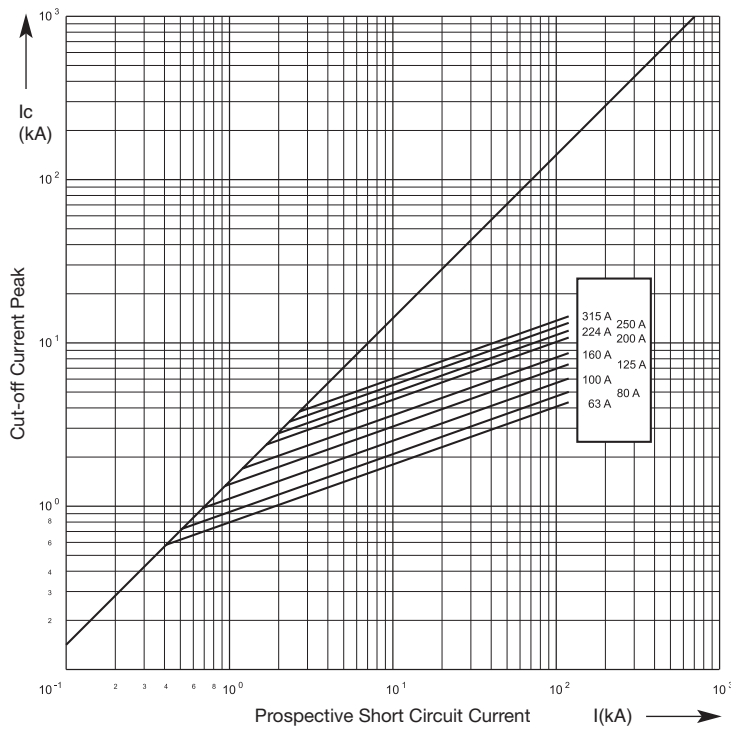

Time / Current Characteristics

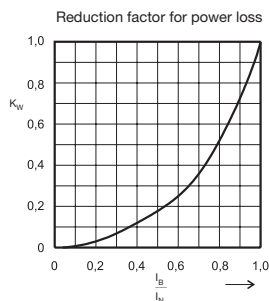
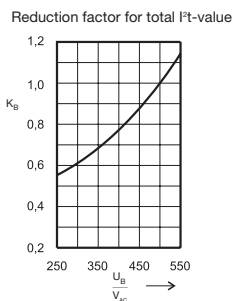
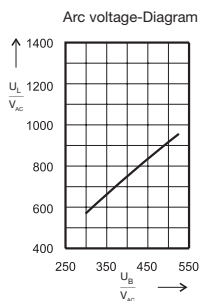
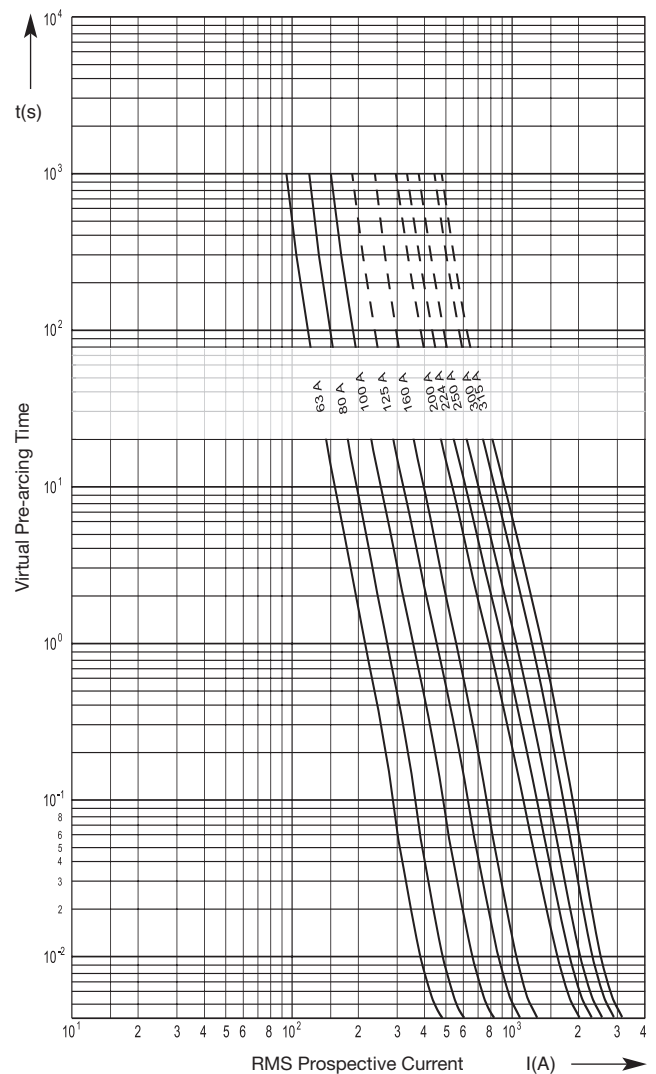

<b>Size</b> <b>2</b>	<b>Rated voltage</b> <b>AC 500 V</b>	<b>Operating class</b> <b>≤ 100 A gR / &gt; 100 A aR</b>	<b>Rated breaking capacity</b> <b>120 kA</b>
-------------------------	---	---	---

Rated current	Part No. with combi indicator	Part No. with signal indicator	Power loss W	Pre-arcing I²t-value A²t	Total I²t-value @ 500 V A²t
100 A	20 004 04	20 010 04	23	920	7,600
125 A	20 004 04	20 010 04	29	1,660	12,300
160 A	20 004 04	20 010 04	40	2,400	19,500
200 A	20 004 04	20 010 04	40	5,800	37,000
224 A	20 004 04	20 010 04	44	7,600	39,000
250 A	20 004 04	20 010 04	51	9,600	51,000
315 A	20 004 04	20 010 04	69	14,000	84,000
355 A	20 004 04	20 010 04	81	20,000	125,000
400 A	20 004 04	20 010 04	94	27,000	155,000

Cut-off-characteristics

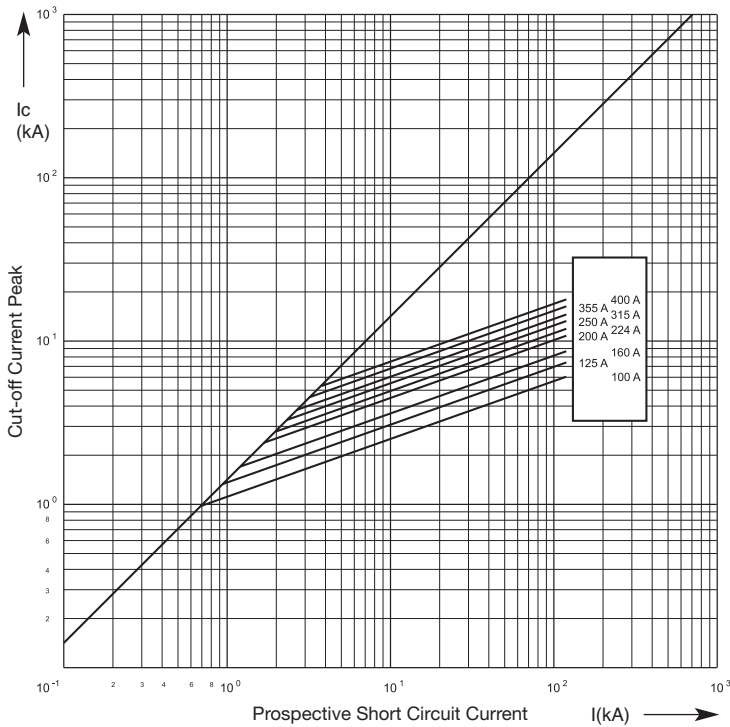

Time / Current Characteristics

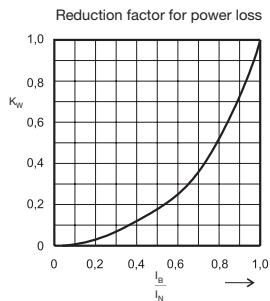
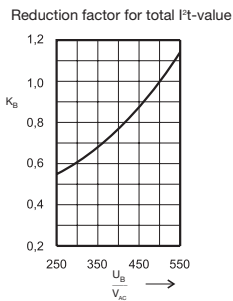
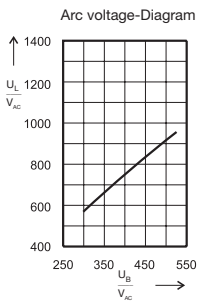
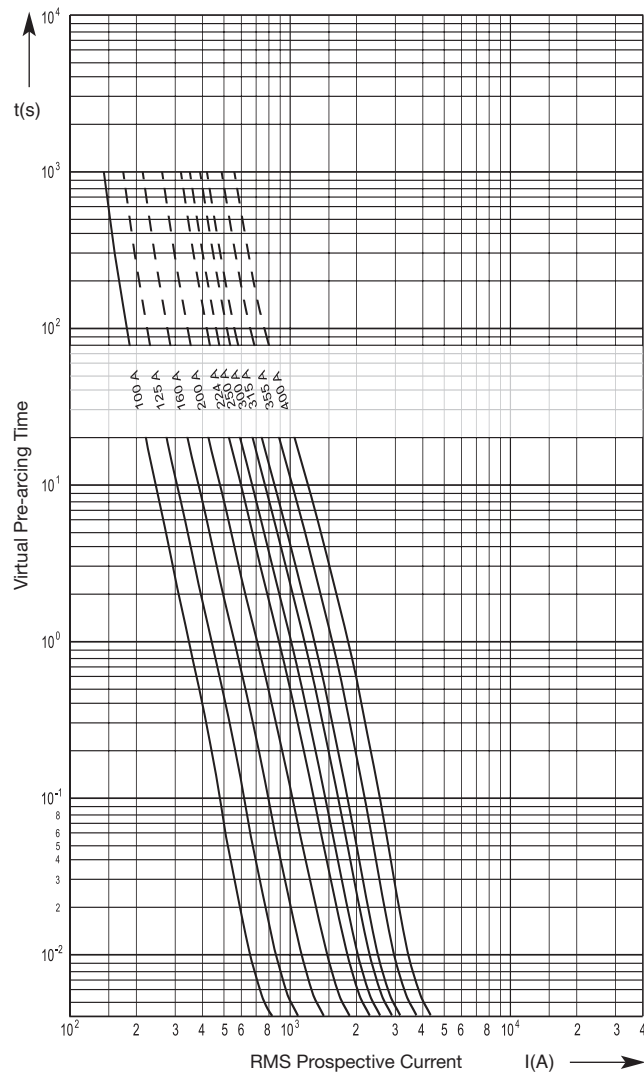

<b>Size</b> <b>3</b>	<b>Rated voltage</b> <b>AC 500 V</b>	<b>Operating class</b> <b>aR</b>	<b>Rated breaking capacity</b> <b>120 kA</b>
-------------------------	---	-------------------------------------	---

Rated current	Part No. with combi indicator	Part No. with signal indicator	Power loss W	Pre-arcing I <sup>2</sup> t-value A <sup>2</sup> t	Total I <sup>2</sup> t-value @ 500 V A <sup>2</sup> t
160 A	20 005 04	20 011 04	48	2,400	19,500
200 A	20 005 04	20 011 04	56	5,800	37,000
224 A	20 005 04	20 011 04	61	7,600	39,000
250 A	20 005 04	20 011 04	65	9,600	51,000
315 A	20 005 04	20 011 04	76	14,000	84,000
355 A	20 005 04	20 011 04	83	20,000	125,000
400 A	20 005 04	20 011 04	85	27,000	155,000
450 A	20 005 04	20 011 04	90	38,000	190,000
500 A	20 005 04	20 011 04	98	47,000	240,000
550 A	20 005 04	20 011 04	110	57,000	300,000
630 A	20 005 04	20 011 04	122	80,000	420,000

Cut-off-characteristics

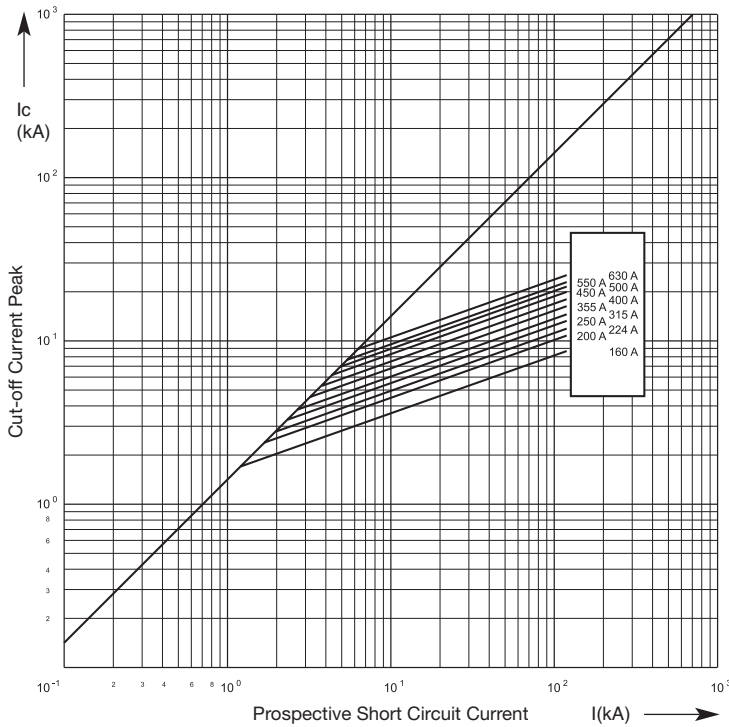

Time / Current Characteristics

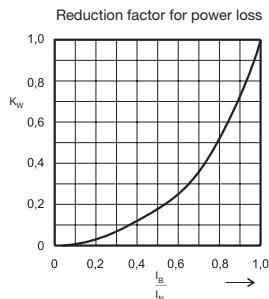
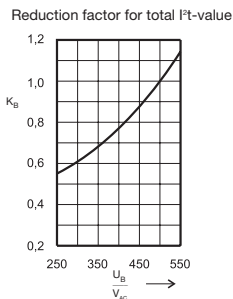
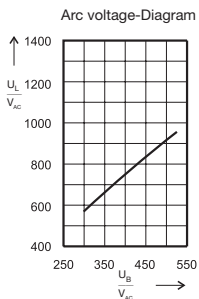
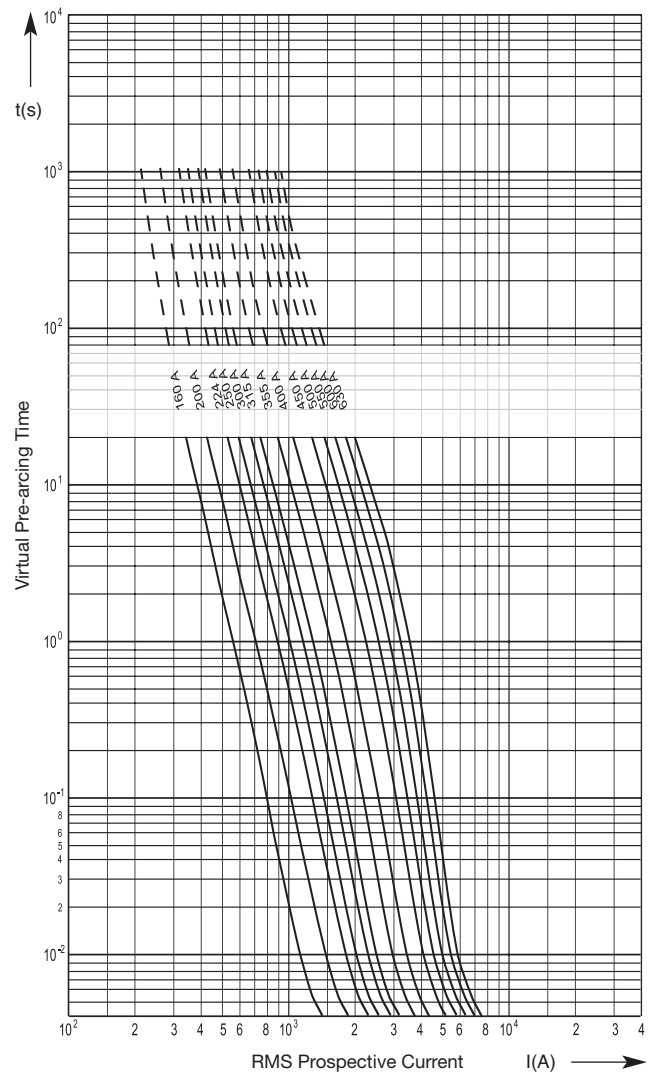

Size <b>000/00</b>	Rated voltage <b>AC 690 V</b>	Operating class <b>≤ 100 A gR / &gt; 100 A aR</b>	Rated breaking capacity <b>100 kA</b>
-----------------------	----------------------------------	--	--

Rated current	Part No. with combi indicator	Power loss W	Pre-arcing I <sup>2</sup> t-value A <sup>2</sup> t	Total I <sup>2</sup> t-value @ 690 V A <sup>2</sup> t
10 A	20 477 20	2.5	2.5	18
16 A	20 477 20	4.1	5.5	40
20 A	20 477 20	5.5	12	91
25 A	20 477 20	6	16	110
32 A	20 477 20	7.1	35	250
40 A	20 477 20	9.2	61	450
50 A	20 477 20	12	110	820
63 A	20 477 20	14	190	1,400
80 A	20 209 20	17	350	2,600
100 A	20 209 20	21	610	4,500
125 A	20 209 20	25	1,200	9,100
160 A	20 209 20	32	2,100	15,000

Cut-off-characteristics

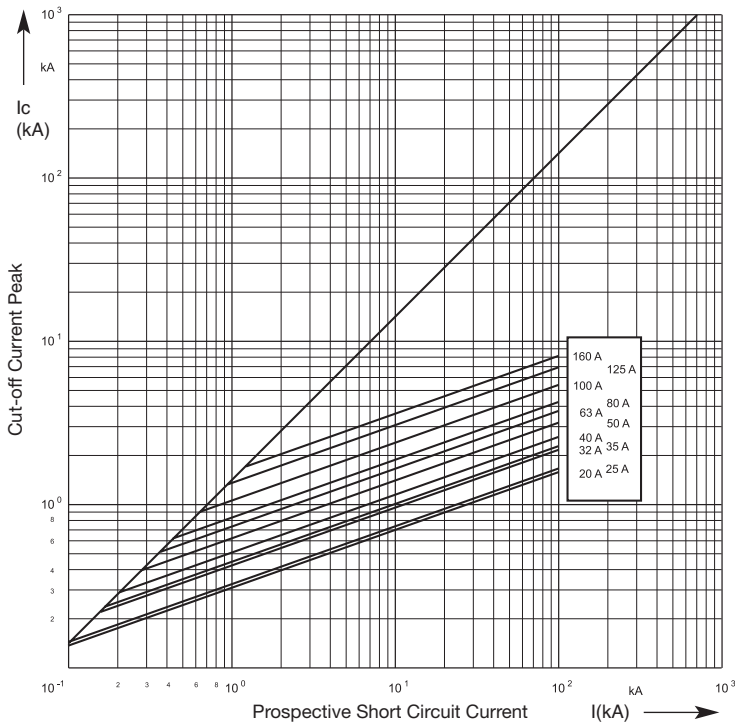

Time / Current Characteristics

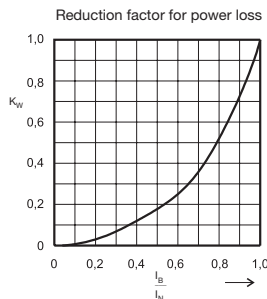
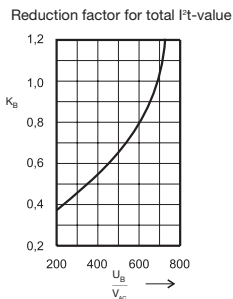
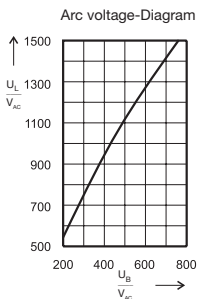
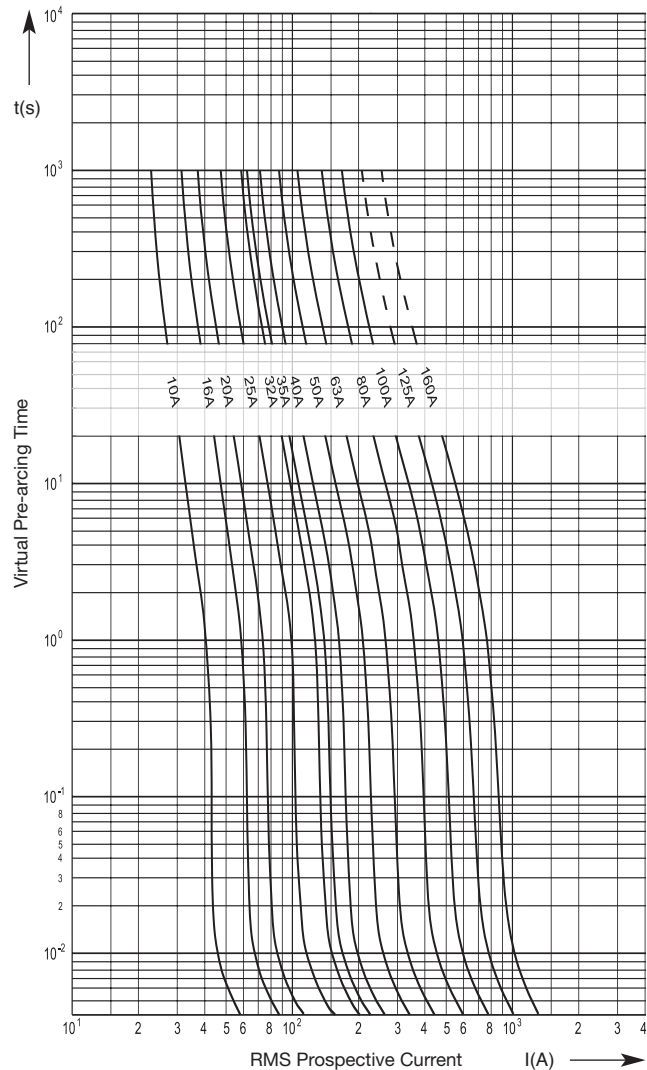

<b>Size</b> <b>1</b>	<b>Rated voltage</b> <b>AC 690 V</b>	<b>Operating class</b> <b>≤ 100 A gR / &gt; 100 A aR</b>	<b>Rated breaking capacity</b> <b>100 kA</b>
-------------------------	---	---	---

Rated current	Part No. with combi indicator	Power loss W	Pre-arcing I <sup>2</sup> t-value A <sup>2</sup> t	Total I <sup>2</sup> t-value @ 690 V A <sup>2</sup> t
40 A	20 211 20	8	80	570
50 A	20 211 20	11	140	1,000
63 A	20 211 20	14	250	1,800
80 A	20 211 20	20	470	3,400
100 A	20 211 20	24	650	4,700
125 A	20 211 20	31	1,050	7,600
160 A	20 211 20	42	1,900	14,000
200 A	20 211 20	52	2,800	21,000
250 A	20 211 20	71	5,000	36,000
315 A	20 211 20	88	11,000	76,000

Cut-off-characteristics

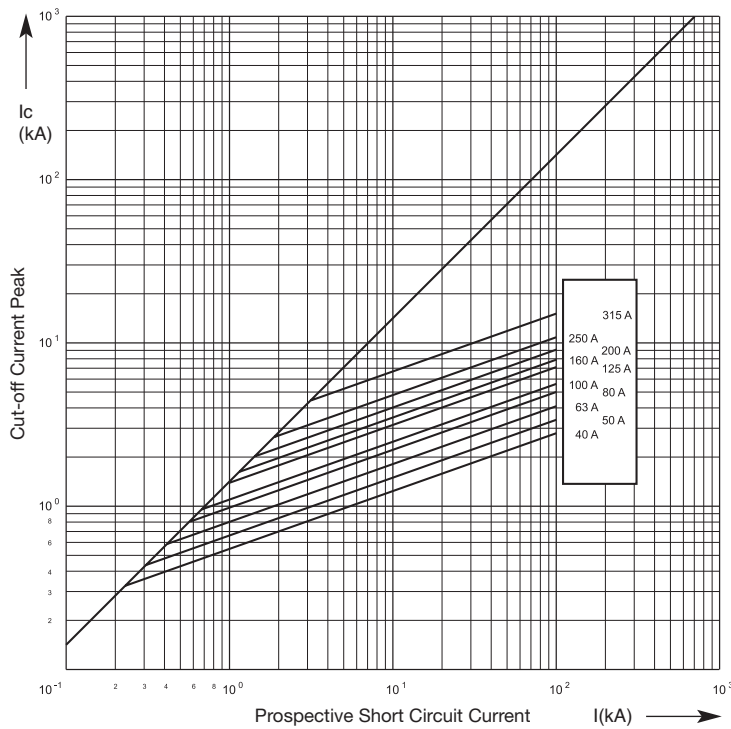

Time / Current Characteristics

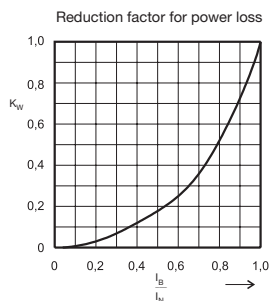
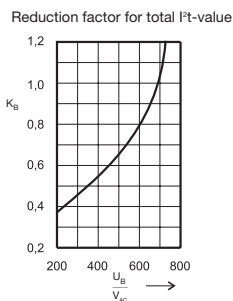
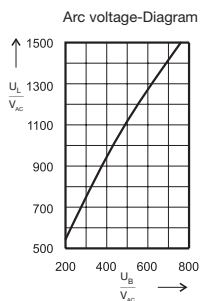
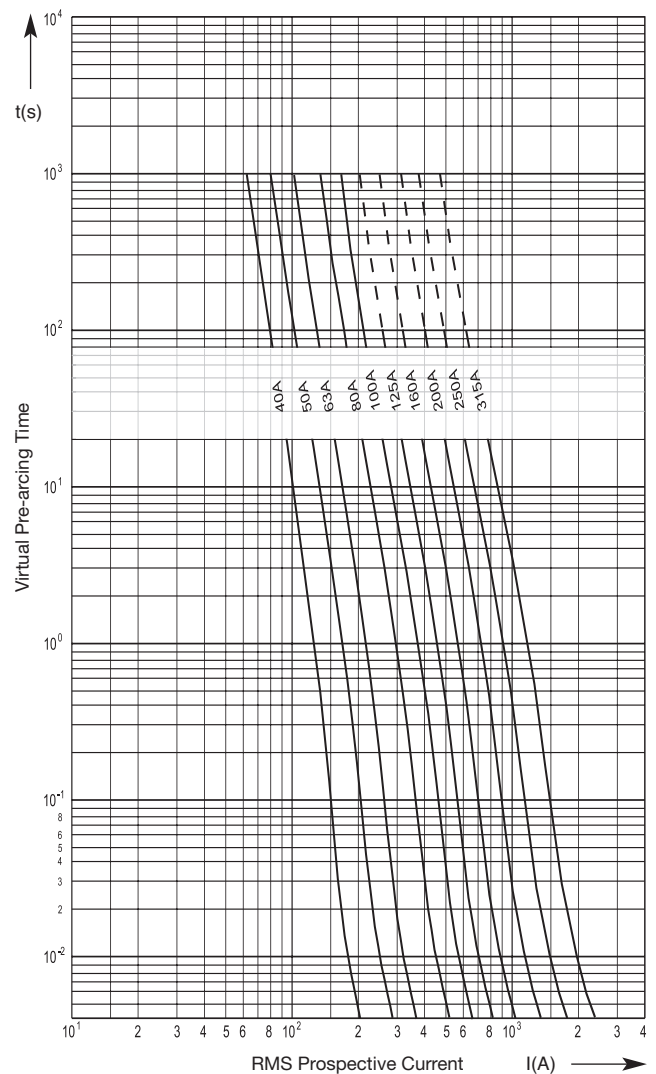

<b>Size</b> <b>2</b>	<b>Rated voltage</b> <b>AC 690 V</b>	<b>Operating class</b> <b>aR</b>	<b>Rated breaking capacity</b> <b>100 kA</b>
-------------------------	---	-------------------------------------	---

Rated current	Part No. with combi indicator	Power loss W	Pre-arcing I <sup>2</sup> t-value A <sup>2</sup> t	Total I <sup>2</sup> t-value @ 690 V A <sup>2</sup> t
160 A	20 212 20	42	1,900	14,000
200 A	20 212 20	52	2,800	21,000
250 A	20 212 20	71	5,000	36,000
315 A	20 212 20	79	11,000	76,000
350 A	20 212 20	85	14,000	100,000
400 A	20 212 20	95	20,000	145,000
450 A	20 212 20	100	30,000	220,000

Cut-off-characteristics

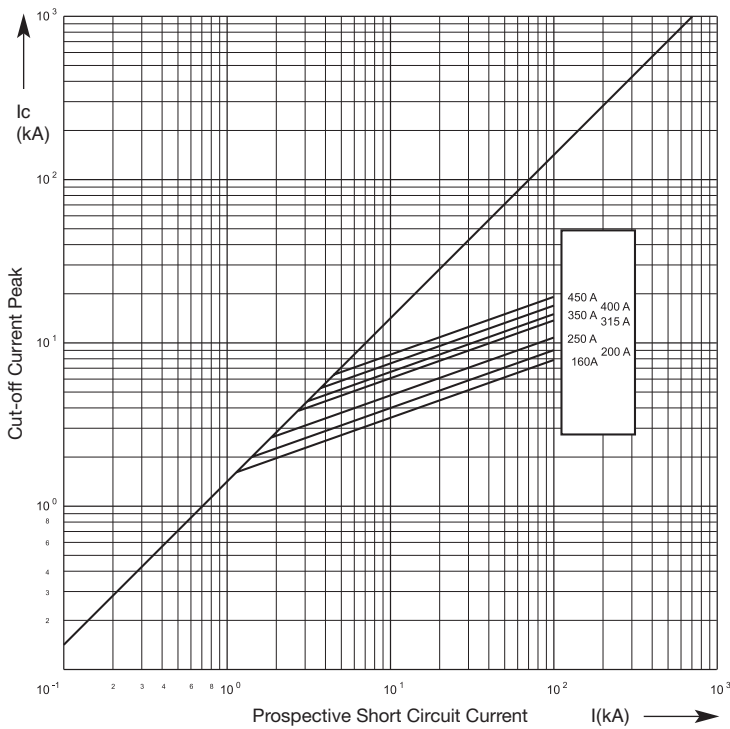

Time / Current Characteristics

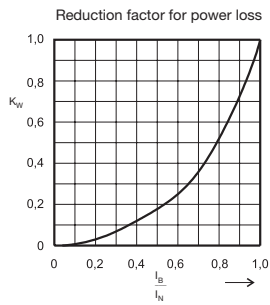
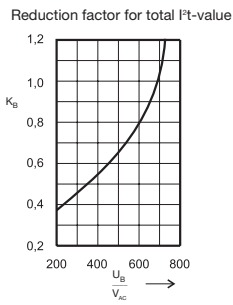
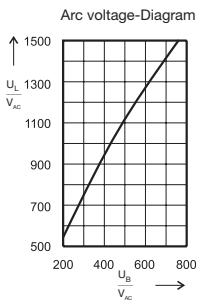
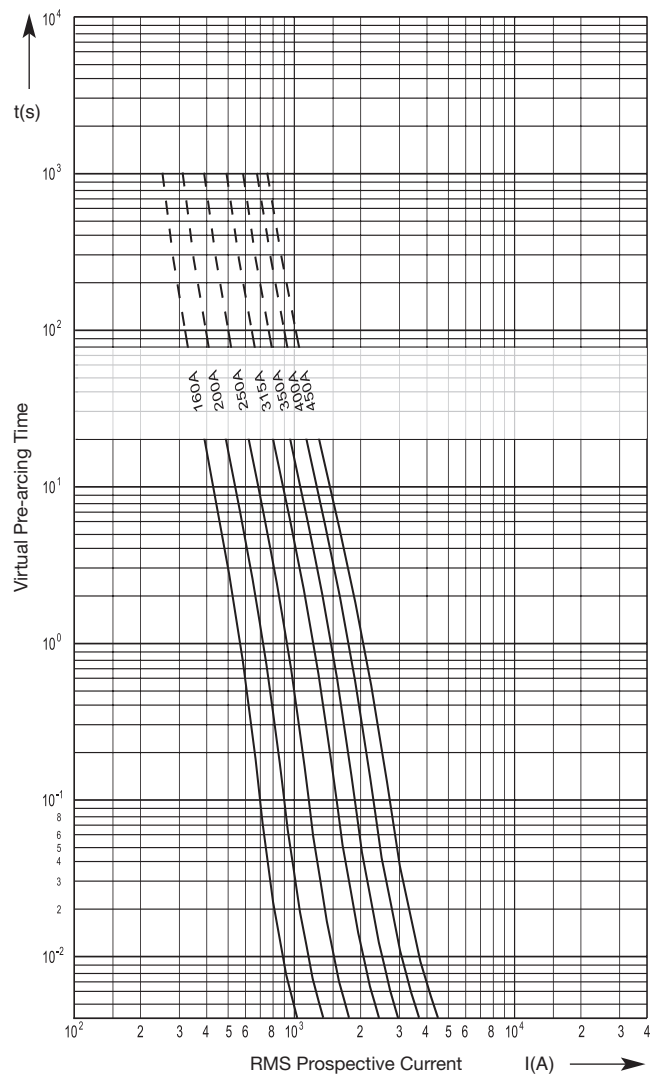

<b>Size</b> <b>3</b>	<b>Rated voltage</b> <b>AC 690 V</b>	<b>Operating class</b> <b>aR</b>	<b>Rated breaking capacity</b> <b>100 kA</b>
-------------------------	---	-------------------------------------	---

Rated current	Part No. with combi indicator	Power loss W	Pre-arcing I <sup>2</sup> t-value A <sup>2</sup> t	Total I <sup>2</sup> t-value @ 690 V A <sup>2</sup> t
315 A	20 213 20	79.0	11,000	76,000
355 A	20 213 20	85.0	14,000	100,000
400 A	20 213 20	95.0	20,000	150,000
450 A	20 213 20	95.0	30,000	220,000
500 A	20 213 20	100.0	42,000	300,000
550 A	20 213 20	110.0	55,000	400,000
630 A	20 213 20	130.0	67,000	490,000
710 A	20 213 20	150.0	84,000	610,000

Cut-off-characteristics

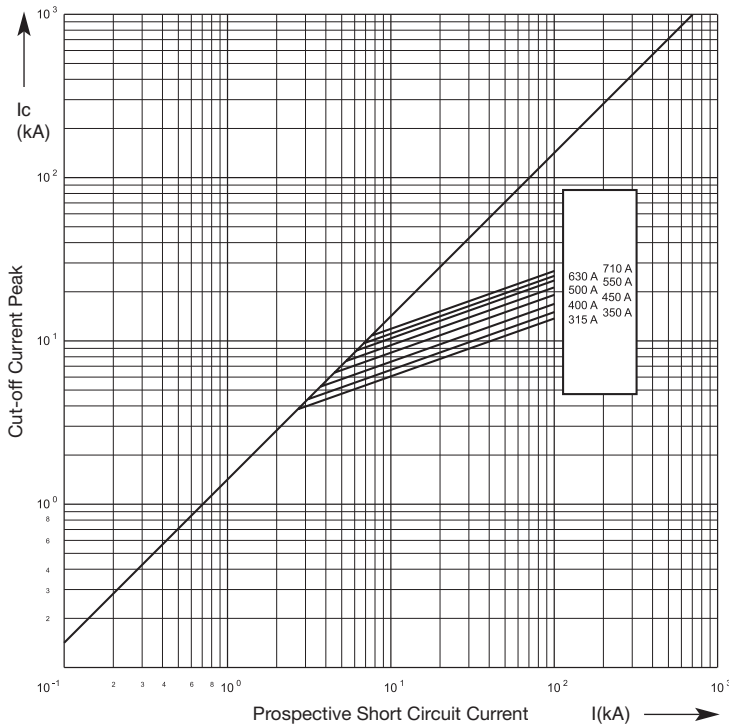

Time / Current Characteristics

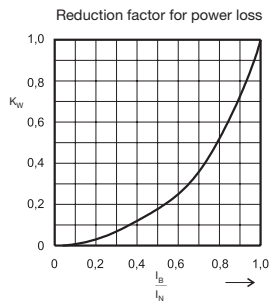
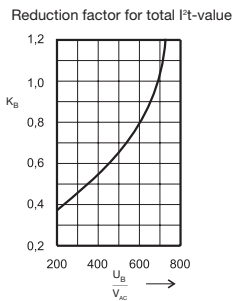
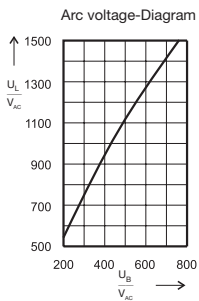
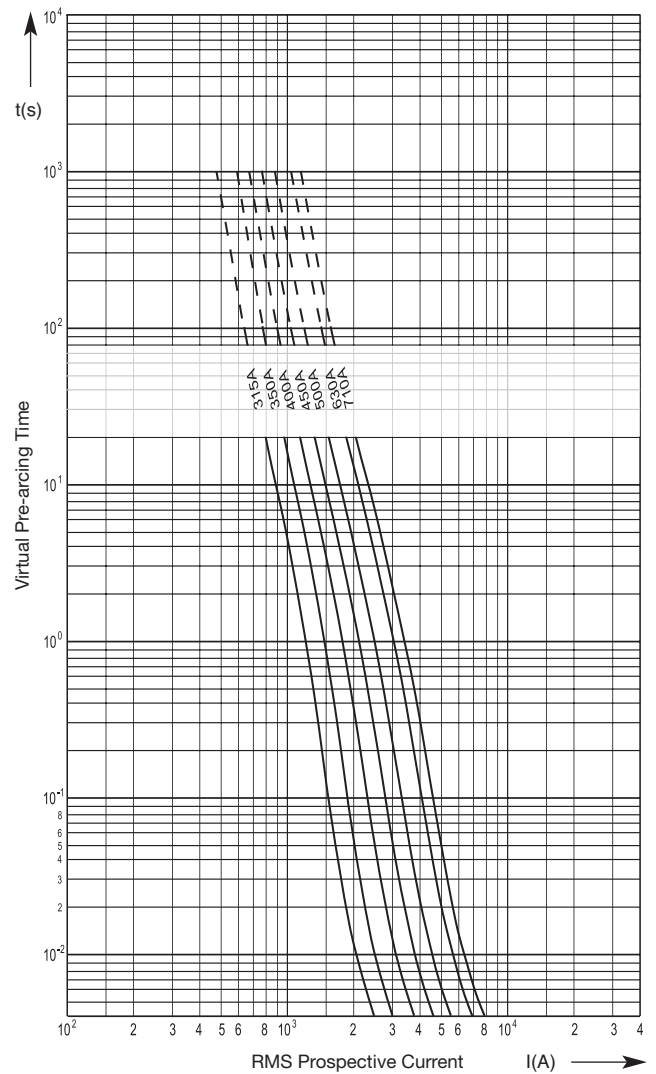

Size <b>0</b>	Rated voltage <b>AC 1000 V</b>	Operating class <b>≤ 50 A gR / &gt; 50 A aR</b>	Rated breaking capacity <b>100 kA</b>
------------------	-----------------------------------	--	--

Rated current	Part No. with combi indicator	Power loss W	Pre-arcing I <sup>2</sup> t-value A <sup>2</sup> t	Total I <sup>2</sup> t-value @ 1000 V A <sup>2</sup> t
16 A	20 384 04	6.8	10	50
20 A	20 384 04	8	17	100
25 A	20 384 04	9	29	180
32 A	20 384 04	12	52	340
40 A	20 384 04	14	120	600
50 A	20 384 04	19	210	1,100
63 A	20 384 04	21	320	1,700
80 A	20 384 04	23	700	3,300
100 A	20 384 04	27	1,100	6,500
125 A	20 384 04	32	2,300	14,000
160 A	20 384 04	42	4,500	20,000

Cut-off-characteristics

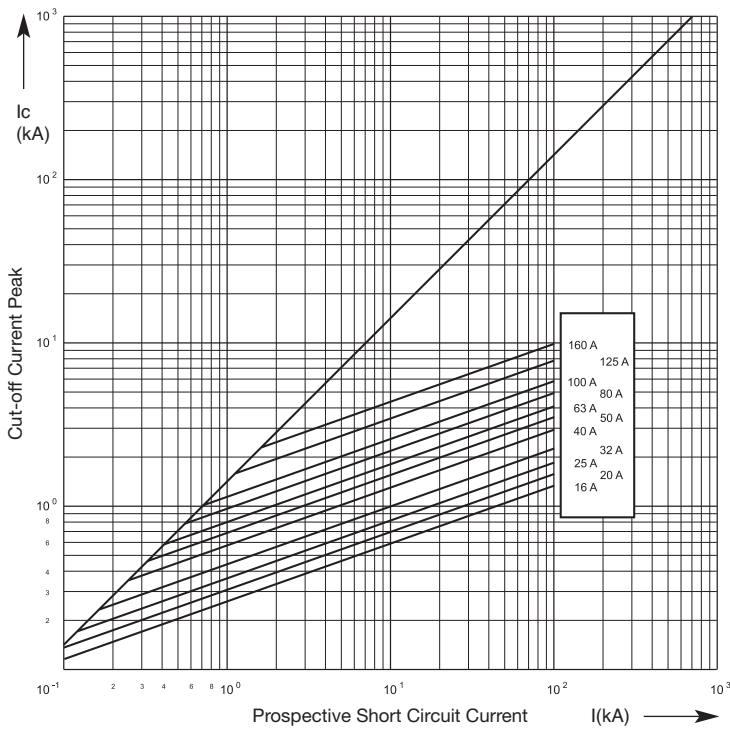

Time / Current Characteristics

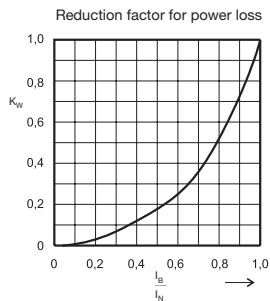
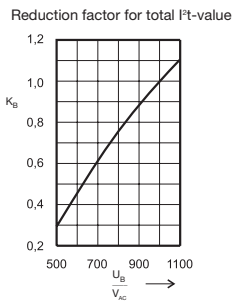
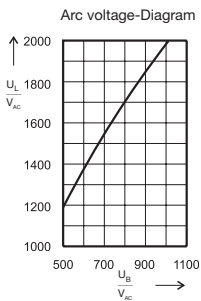
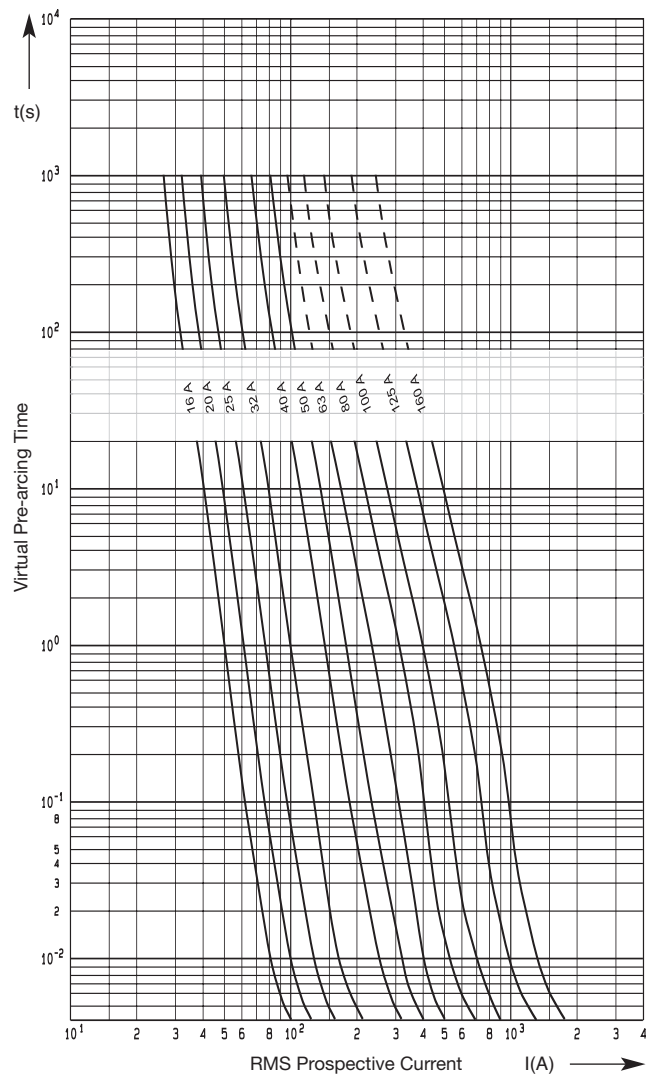



<b>Size</b> <b>3</b>	<b>Rated voltage</b> <b>AC 660 V</b>	<b>Operating class</b> <b>gR</b>	<b>Rated breaking capacity</b> <b>120 kA</b>
-------------------------	---	-------------------------------------	---

Rated current	Part No. with combi indicator	Power loss W	Pre-arcing I <sup>2</sup> t-value A <sup>2</sup> t	Total I <sup>2</sup> t-value @ 660 V A <sup>2</sup> t
150 A	20 373 04	35	2,100	20,000
200 A	20 373 04	56	3,800	36,000
250 A	20 373 04	69	6,700	65,000
300 A	20 373 04	78	10,000	102,000
350 A	20 373 04	84	14,000	145,000
400 A	20 373 04	97	19,000	185,000
500 A	20 373 04	114	27,000	280,000

Cut-off-characteristics

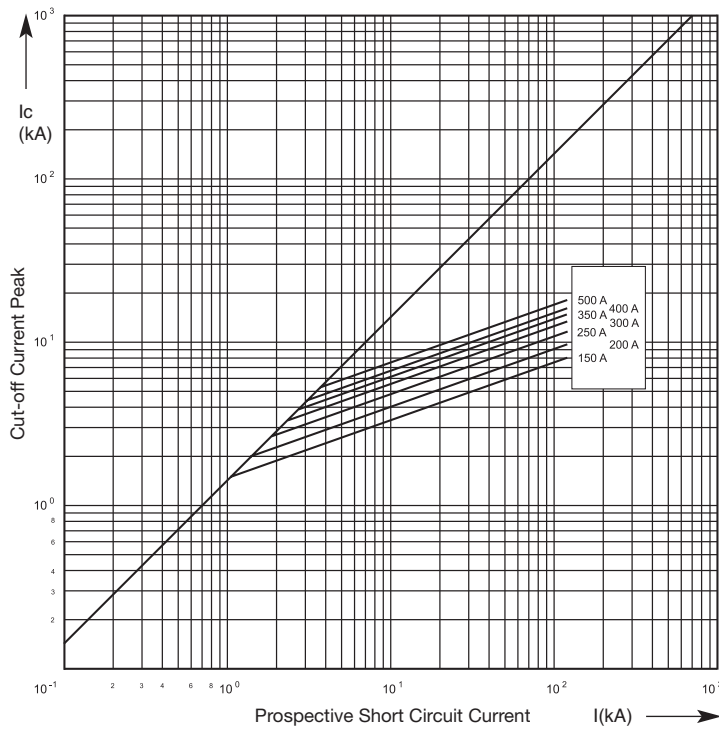

Time / Current Characteristics

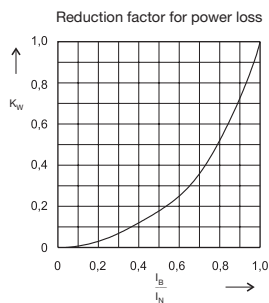
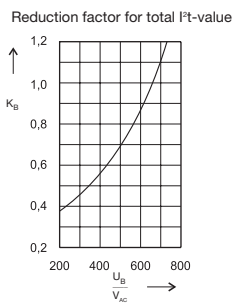
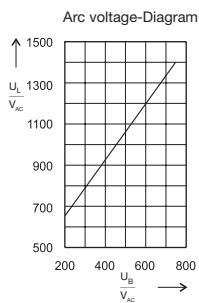
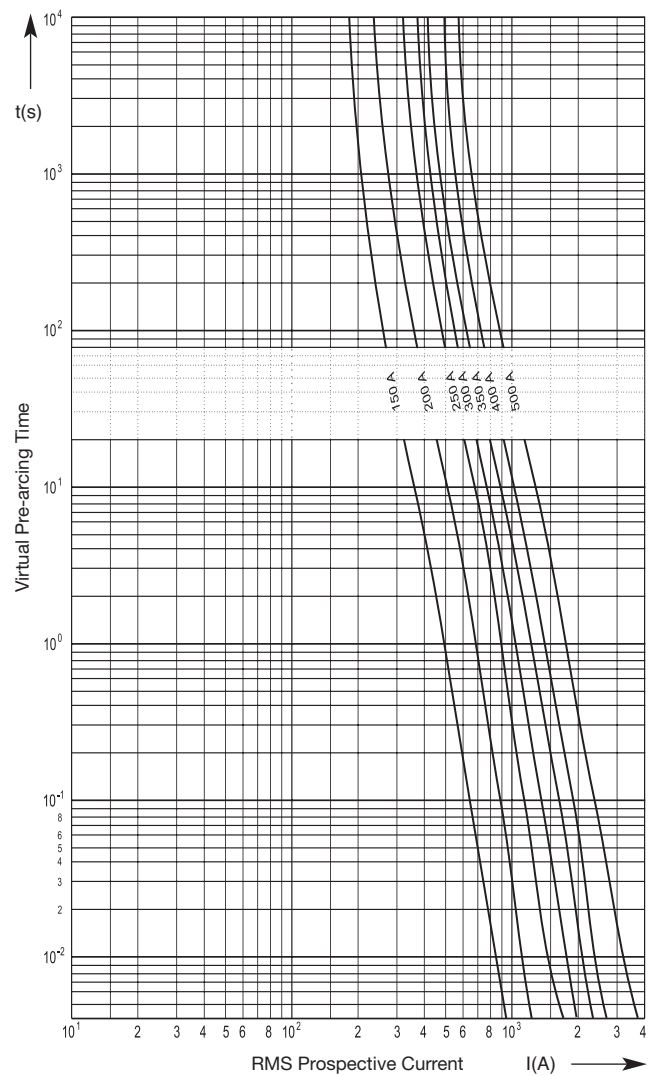

Size <b>3</b>	Rated voltage <b>AC 1000 V</b>	Operating class <b>aR</b>	Rated breaking capacity <b>100 kA</b>
------------------	-----------------------------------	------------------------------	--

Rated current	Part No. with Topindicator	Power loss W	Pre-arcing I <sup>2</sup> t-value A <sup>2</sup> t	Total I <sup>2</sup> t-value @ 1000 V A <sup>2</sup> t
100 A	20 407 04	28	2,100	5,800
125 A	20 407 04	34	2,900	8,900
160 A	20 407 04	36	4,100	12,800
200 A	20 407 04	41	5,600	18,000
250 A	20 407 04	49	10,000	31,000
315 A	20 407 04	73	34,000	97,000
355 A	20 407 04	77	51,000	152,000
400 A	20 407 04	79	60,000	180,000
450 A	20 407 04	82	74,000	220,000
500 A	20 407 04	87	125,000	370,000

Cut-off-characteristics

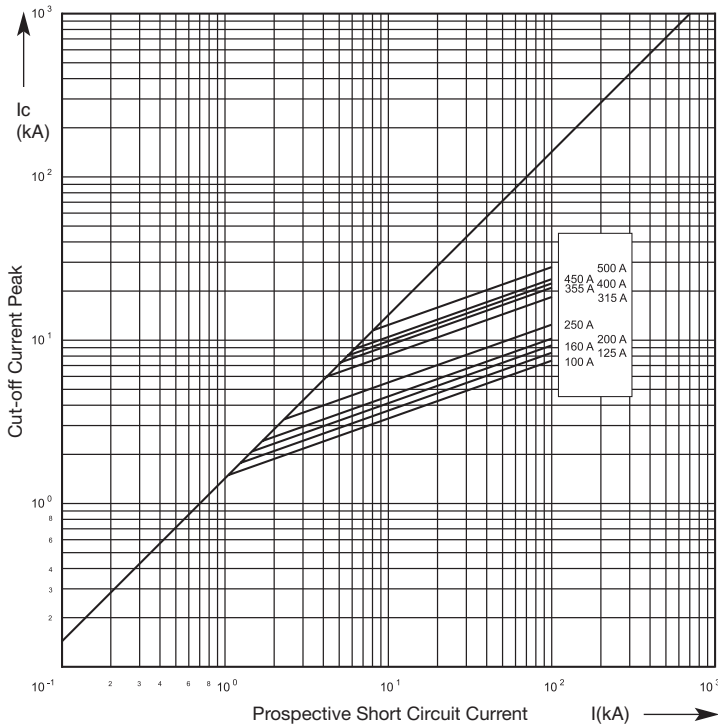

Time / Current Characteristics

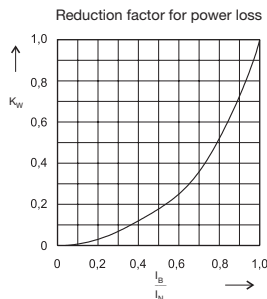
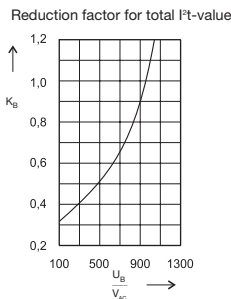
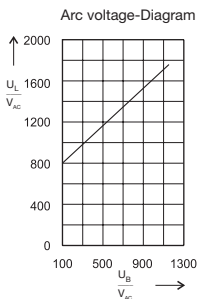
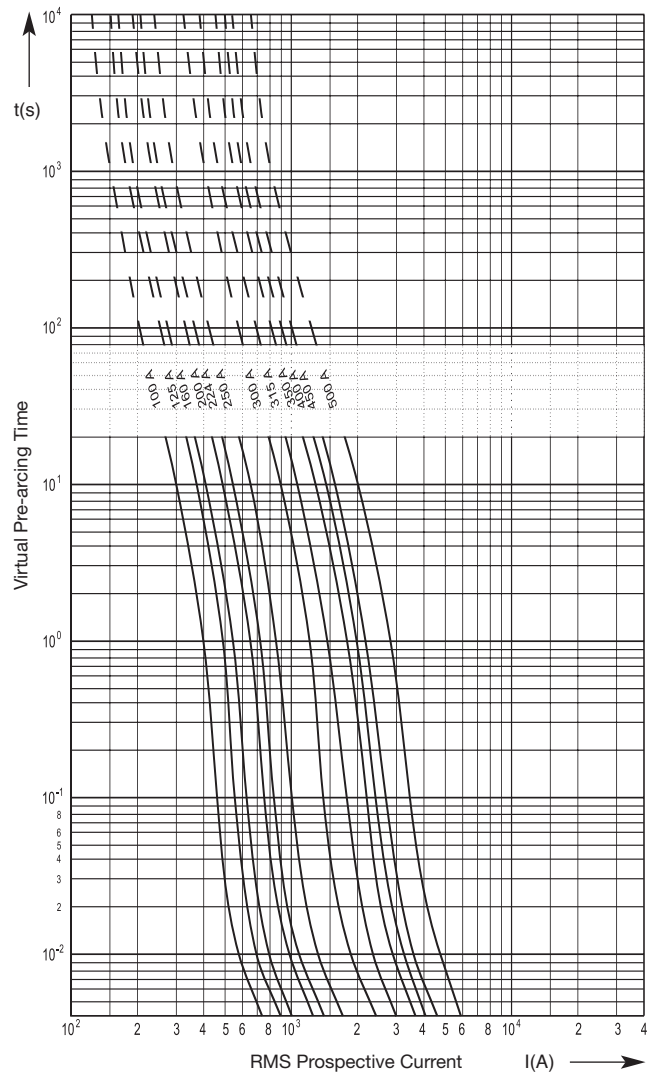

<b>Size</b> <b>3</b>	<b>Rated voltage</b> <b>AC 2000 V</b>	<b>Operating class</b> <b>aR</b>	<b>Rated breaking capacity</b> <b>100 kA</b>
-------------------------	--	-------------------------------------	---

Rated current	Part No. with Topindicator	Power loss W	Pre-arcing I <sup>2</sup> t-value A <sup>2</sup> t	Total I <sup>2</sup> t-value @ 2000 V A <sup>2</sup> t
200 A	20 404 04	78	21,000	60,000
224 A	20 404 04	85	27,000	77,000
250 A	20 404 04	103	33,000	95,000
300 A	20 404 04	115	53,000	151,000
315 A	20 404 04	121	62,000	172,000
355 A	20 404 04	135	97,000	280,000
400 A	20 404 04	145	130,000	410,000
450 A	20 404 04	153	159,000	520,000

Cut-off-characteristics

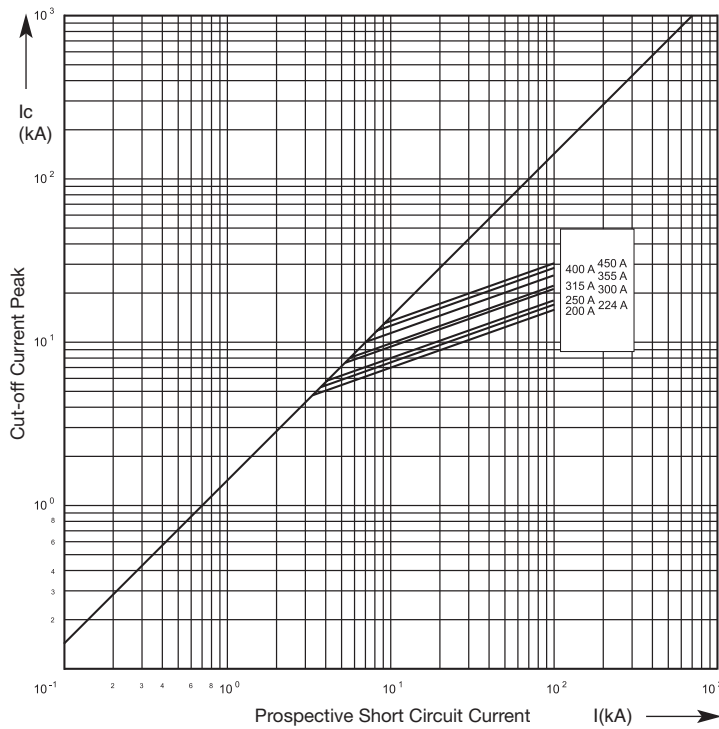

Time / Current Characteristics

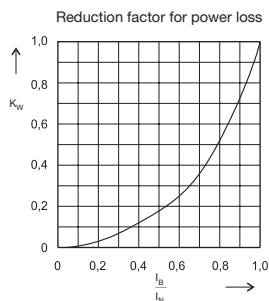
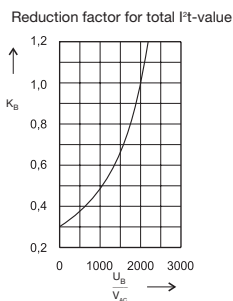
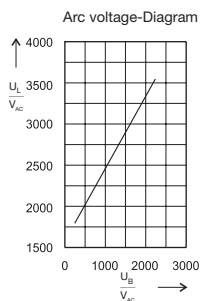
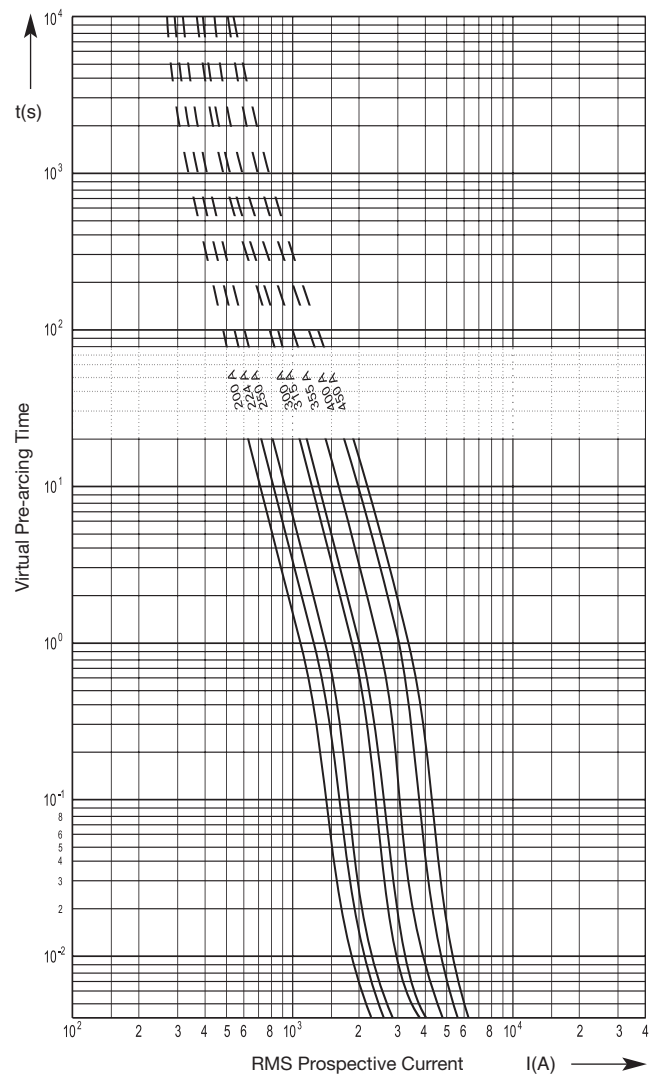

<b>Fuse Base</b>	<b>Size</b>	<b>Rated voltage</b>	<b>Standard</b>
	<b>00</b>	<b>AC 500/690 V</b>	<b>DIN 43620</b>

**Part No.**  
**21 001 01**

<b>A</b>	<b>3.94" (100 mm)</b>
<b>B</b>	<b>0.80" (20 mm)</b>
<b>C</b>	<b>1.26" (32 mm)</b>
<b>D</b>	<b>3.90" (99 mm)</b>
<b>E</b>	<b>1.32" (33.5 mm)</b>
<b>F</b>	<b>1.14" (29 mm)</b>
<b>G</b>	<b>2.32" (59 mm)</b>
<b>H</b>	<b>3.40" (86 mm)</b>
<b>I</b>	<b>2.24" (57 mm)</b>
<b>J</b>	<b>4.72" (120 mm)</b>
<b>L</b>	<b>5.30" (135 mm)</b>
<b>M</b>	<b>M 8</b>
<b>N</b>	<b>0.98" (25 mm)</b>
<b>O</b>	<b>0.30" (7.5 mm)</b>

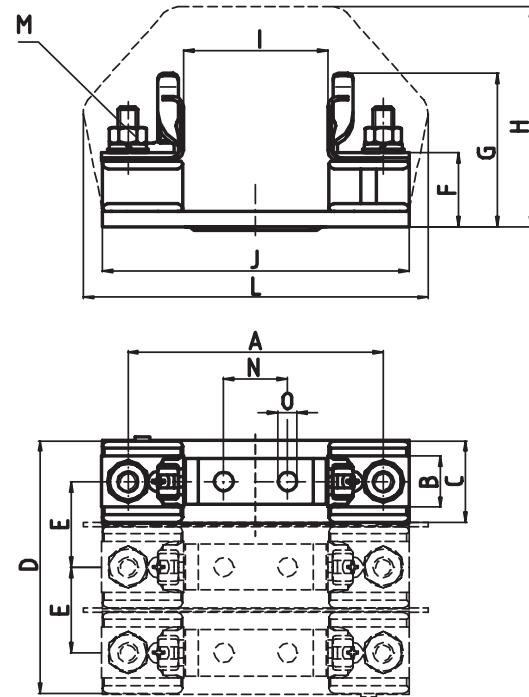

**Part No.**  
**21 001 10**

<b>A</b>	<b>3.94" (100 mm)</b>
<b>B</b>	<b>0.80" (20 mm)</b>
<b>C</b>	<b>1.18" (30 mm)</b>
<b>D</b>	<b>3.66" (93 mm)</b>
<b>E</b>	<b>1.24" (31.5 mm)</b>
<b>F</b>	<b>0.94" (24 mm)</b>
<b>G</b>	<b>2.20" (56 mm)</b>
<b>H</b>	<b>3.15" (80 mm)</b>
<b>I</b>	<b>2.24" (57 mm)</b>
<b>J</b>	<b>4.72" (120 mm)</b>
<b>K</b>	<b>0.34" (8.7 mm)</b>
<b>L</b>	<b>5.30" (135 mm)</b>
<b>M</b>	<b>M 8</b>
<b>N</b>	<b>0.98" (25 mm)</b>
<b>O</b>	<b>0.30" (7.5 mm)</b>
<b>P</b>	<b>0.60" (15.5 mm)</b>

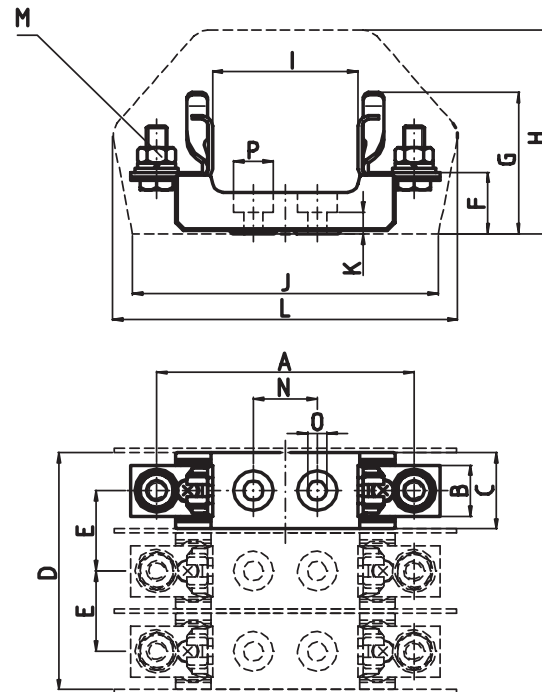

**Fuse Base**      Sizes **1,2 and 3**      Rated voltage **AC 500/690 V**      Standard **DIN 43620**

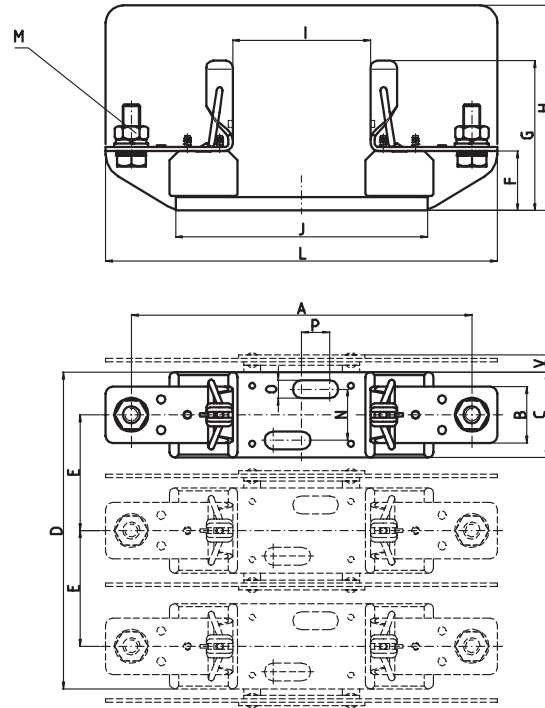

	<b>Size 1</b> Power acceptance <b>32 W</b> Part No. 21 003 01	<b>Size 2</b> Power acceptance <b>45 W</b> Part No. 21 004 01	<b>Size 3</b> Power acceptance <b>60 W</b> Part No. 21 005 01
<b>A</b>	<b>6.90"</b> (175 mm)	<b>7.87"</b> (200 mm)	<b>8.27"</b> (210 mm)
<b>B</b>	<b>1.30"</b> (33 mm)	<b>1.30"</b> (33 mm)	<b>1.30"</b> (33 mm)
<b>C</b>	<b>1.97"</b> (50 mm)	<b>1.97"</b> (50 mm)	<b>2.17"</b> (55 mm)
<b>D</b>	<b>7.00"</b> (178 mm)	<b>7.32"</b> (186 mm)	<b>8.86"</b> (225 mm)
<b>E</b>	<b>2.52"</b> (64 mm)	<b>2.68"</b> (68 mm)	<b>3.35"</b> (85 mm)
<b>F</b>	<b>1.38"</b> (35 mm)	<b>1.38"</b> (35 mm)	<b>1.38"</b> (35 mm)
<b>G</b>	<b>3.30"</b> (84 mm)	<b>3.58"</b> (91 mm)	<b>3.78"</b> (96 mm)
<b>H</b>	<b>4.20"</b> (107 mm)	<b>4.72"</b> (120 mm)	<b>5.00"</b> (127 mm)
<b>I</b>	<b>3.15"</b> (80 mm)	<b>3.15"</b> (80 mm)	<b>3.15"</b> (80 mm)
<b>J</b>	<b>5.83"</b> (148 mm)	<b>5.83"</b> (148 mm)	<b>5.83"</b> (148 mm)
<b>L</b>	<b>7.78"</b> (200 mm)	<b>9.06"</b> (230 mm)	<b>9.84"</b> (250 mm)
<b>M</b>	<b>M 10</b>	<b>M 10</b>	<b>M 10</b>
<b>N</b>	<b>1.18"</b> (30 mm)	<b>1.18"</b> (30 mm)	<b>1.18"</b> (30 mm)
<b>O</b>	<b>0.40"</b> (10 mm)	<b>0.40"</b> (10 mm)	<b>0.40"</b> (10 mm)
<b>P</b>	<b>0.65"</b> (16.5 mm)	<b>0.65"</b> (16.5 mm)	<b>0.65"</b> (16.5 mm)
<b>V</b>	<b>0.40"</b> (10 mm)	<b>0.40"</b> (10 mm)	<b>0.40"</b> (10 mm)

**Fuse Base**                      **Sizes**                      **Rated voltage**  
**00,1,2 and 3**                      **AC 500 V**

Size	Part No.	B	H
<b>00</b>	21 007 01	<b>1.34"</b> (34 mm)	<b>3.15"</b> (80 mm)
<b>1</b>	21 009 01	<b>1.65"</b> (42 mm)	<b>4.33"</b> (110 mm)
<b>2</b>	21 010 01	<b>2.05"</b> (52 mm)	<b>4.72"</b> (120 mm)
<b>3</b>	21 011 01	<b>2.17"</b> (55 mm)	<b>5.00"</b> (127 mm)

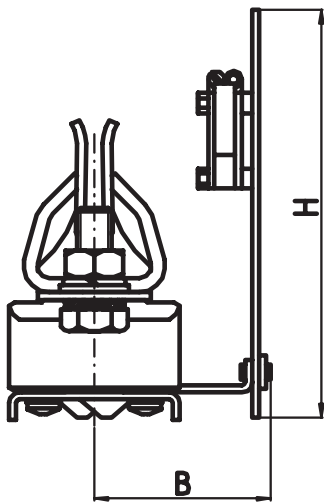

**Fuse Base**      **Sizes**      **Rated voltage**  
**0**      **AC 1000 V**

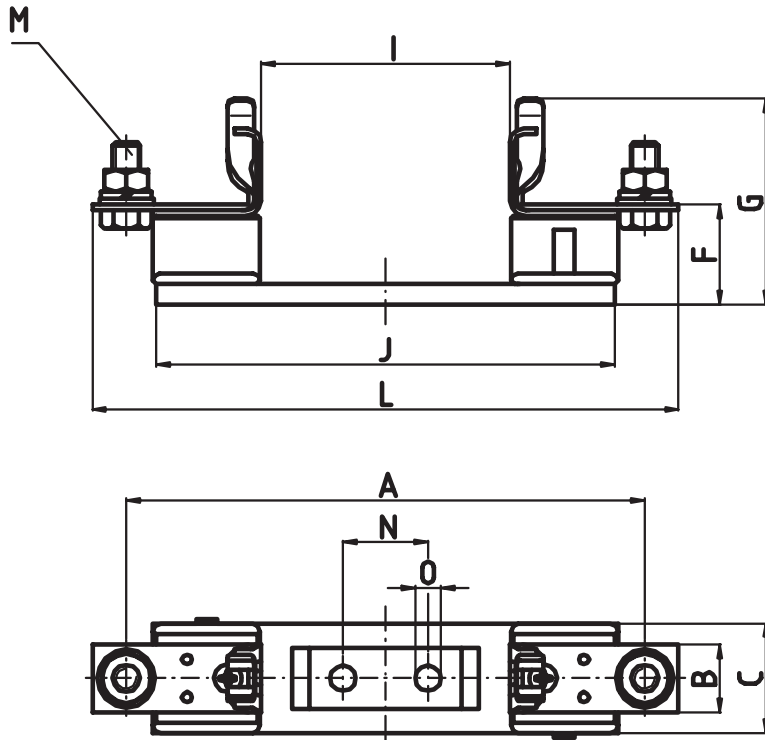

**Part No.**  
**21 384 01**

<b>A</b>	<b>5.98" (152 mm)</b>
<b>B</b>	<b>0.80" (20 mm)</b>
<b>C</b>	<b>1.26" (32 mm)</b>
<b>F</b>	<b>1.14" (29 mm)</b>
<b>G</b>	<b>2.32" (59 mm)</b>
<b>I</b>	<b>2.87" (73 mm)</b>
<b>J</b>	<b>5.28" (134 mm)</b>
<b>L</b>	<b>6.80" (173 mm)</b>
<b>M</b>	<b>M 8</b>
<b>N</b>	<b>0.98" (25 mm)</b>
<b>O</b>	<b>0.30" (7.5 mm)</b>

