

HEAT-SINK ALUMINIUM ENCLOSURE

HY SERIES

NEW size added and selectable
in **56 sizes**.



Excellent Cooling Performance

The waved surface on the fins increases cooling performance.

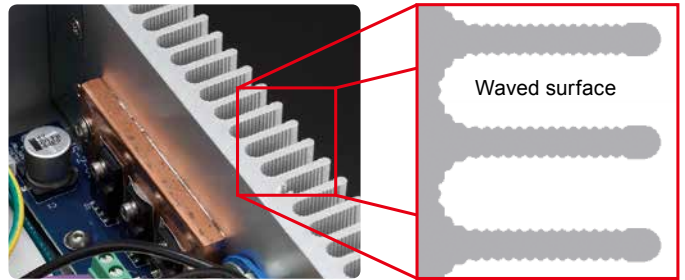

Added new length version

New 330mm length added .

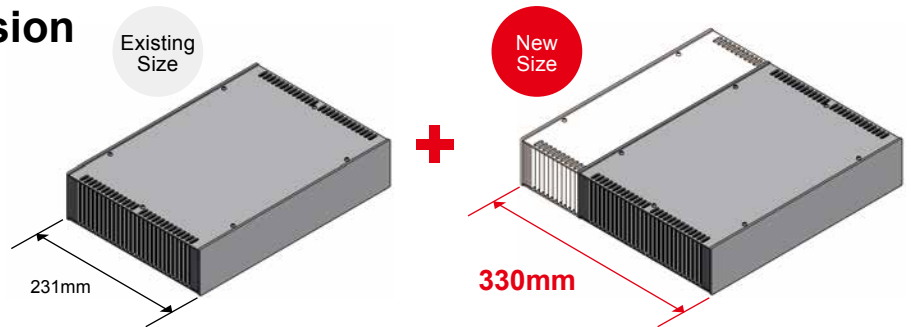

Added new height version

1U (H 44mm) and 4U (H177mm) added.
Selectable in 7 height versions.



New rack-mount enclosure with carrying handles HYRH series

Carrying handles enables the unit to be moved around easily.

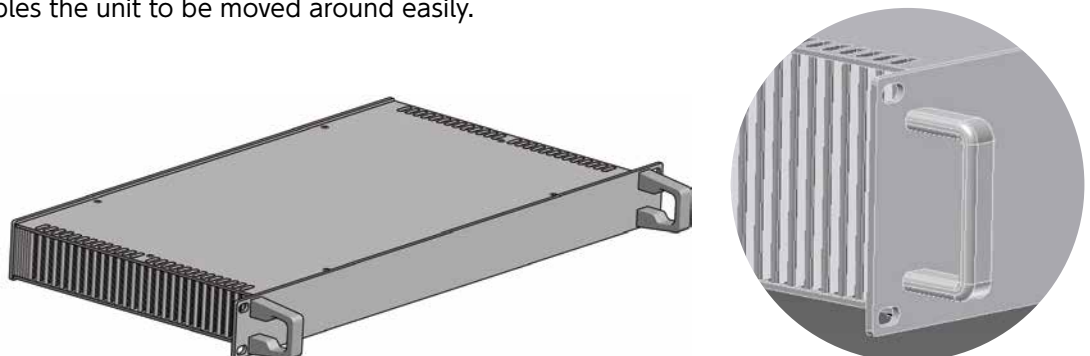

Linear Power Supply

Product by UpTone Audio (USA)



- Considered in many countries as the premier DC power supply for use in high-end audiophile music systems, the JS-2 is an entirely unique design incorporating a choke-filter, shielded R-core transformer, ultra-low noise regulation, and a special Kelvin-sense voltage/current feedback loop for one of the outputs.
- Offering two outputs with independently adjustable output voltage settings (5/7/9/12V), it is capable of providing a continuous current of up to 5 amps at 5V and 7.4 amps at 12V.
- Dual-primary transformer and reversible fuse block power input module allow for worldwide use.

Industrial Fanless Computer

Product by Techno Veins (Japan)



- Compact HDD recorder equipped with a slim DVD-R/RW, 3.5HDD and MPEG-2 encoder with on-board TV tuner installed on the HY99-23-23SS model.
- Fanless unit utilizing a heat pipe cooling system connected to heat-sink side plates and DC/AC adapter. This enables the system to be more compact and operate with minimal noise as compared to a CPU fan cooler system.

HYRH SERIES

HEAT-SINK RACK MOUNTING ENCLOSURE WITH HANDLE

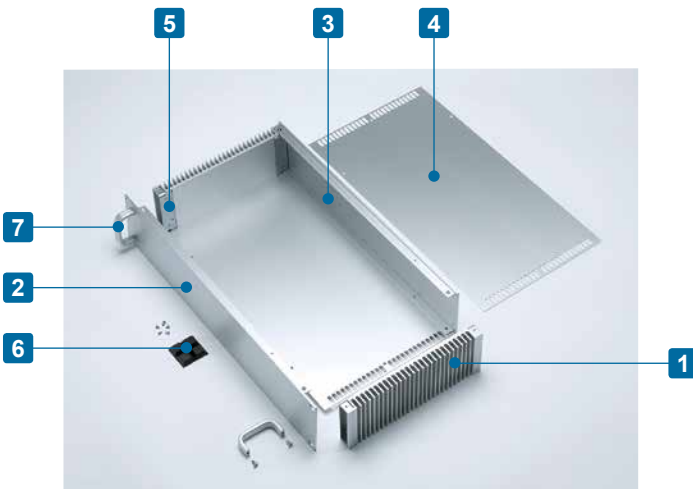

- Equipped with handy rack mount / pull out handles.
- Available in 8 sizes, and 2 different colors.
- Excellent cooling performance with the heat-sink side plates.
- Tough and robust enclosure from using aluminium extrusion parts.
- Simple and easy to assemble construction.

Components

No.	Part name	Pcs	Material	Color / Finish
1	Heat-sink side plate	2	Aluminium extrusion	Silver · Black anodized
2	Front panel	1	Aluminium extrusion	Silver · Black anodized / Hairline finish
3	Rear panel	1	Aluminium extrusion	Silver · Black anodized / Hairline finish
4	Top · Bottom cover	2	Aluminium t2.0	Silver · Black anodized / Hairline finish
5	Corner support	4	Steel t1.6	Trivalent chromate
6	Rubber feet	4	Polyurethane	Black
7	Handle	2	Aluminium extrusion	Silver · Black anodized
-	Screw	1 set	Steel M3	Nickel plated · Black trivalent chromate

Accessories (Optional parts)



Mounting plate
HYC series
See page HY-10



L mounting bracket
HYCL series
See page HY-10



Torx screw for top / bottom cover
MR3-5Z series
See page HY-9



Dimension (outside view)

■ DXF / DWG / PDF drawings available on our website.

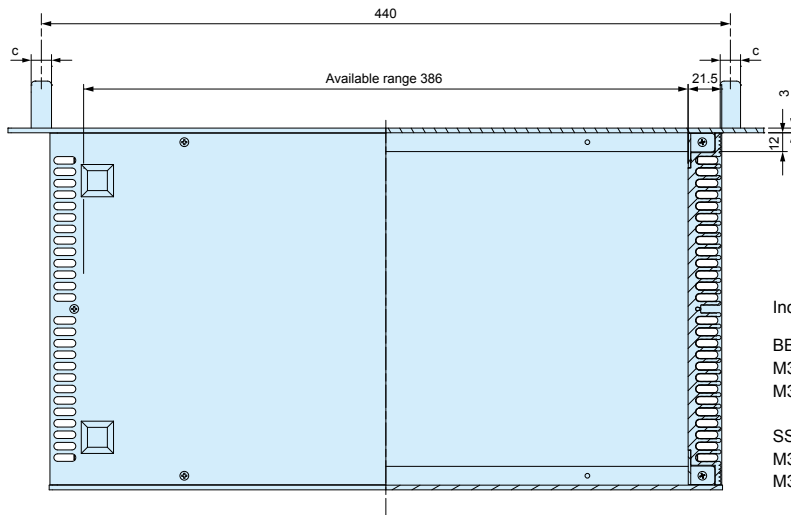
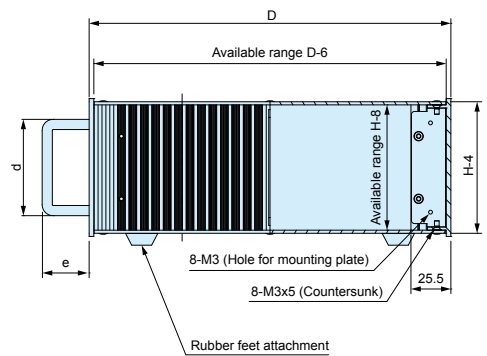
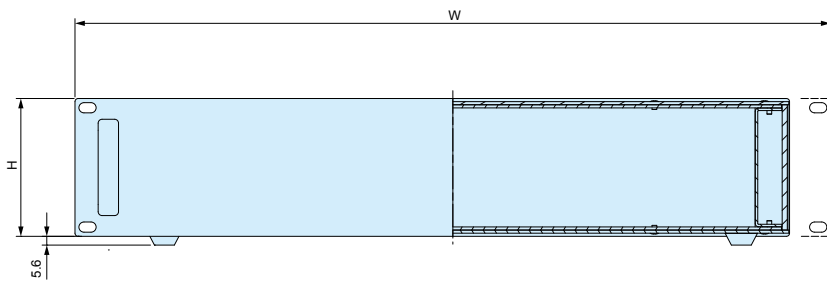

Included Screw

BB Color type

M3x6 countersunk screw, black trivalent chromate x16

M3x5 slotted raised countersunk screw, black trivalent chromate x12

SS Color type

M3x6 countersunk screw, nickel plated x16

M3x5 slotted raised countersunk screw, nickel plated x12

Part number		W	H	D	c	d	e	Standard	Weight (kg)
● Silver	● Black								
HYRH 44-43-23SS	HYRH 44-43-23BB	482.6	44	231	12	41.0	40	EIA	2.0
HYRH 44-43-33SS	HYRH 44-43-33BB	482.6	44	330	12	41.0	40	EIA	2.6
HYRH 88-43-23SS	HYRH 88-43-23BB	482.6	88	231	13	61.5	30	EIA	2.8
HYRH 88-43-33SS	HYRH 88-43-33BB	482.6	88	330	13	61.5	30	EIA	3.7
HYRH133-43-23SS	HYRH133-43-23BB	482.6	133	231	13	106.5	30	EIA	3.6
HYRH133-43-33SS	HYRH133-43-33BB	482.6	133	330	13	106.5	30	EIA	4.8
HYRH177-43-23SS	HYRH177-43-23BB	482.6	177	231	13	126.5	30	EIA	4.6
HYRH177-43-33SS	HYRH177-43-33BB	482.6	177	330	13	126.5	30	EIA	5.9

HY series dimension (outside view)

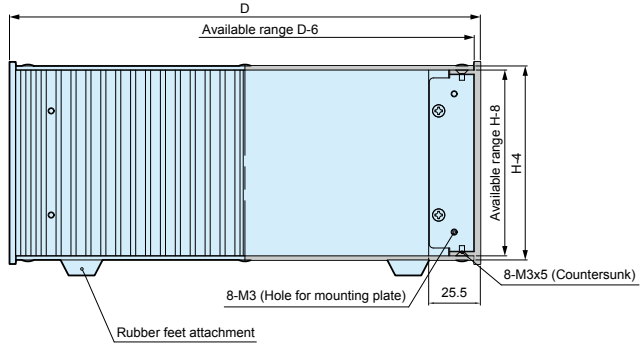
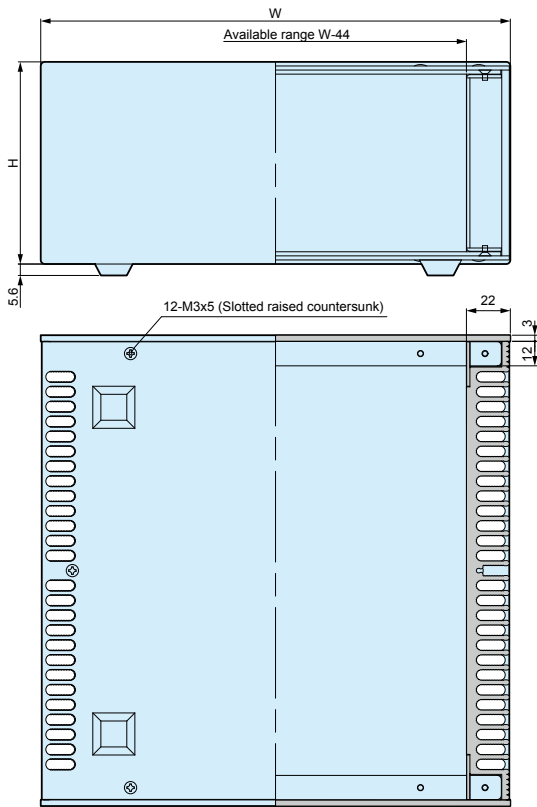

Included Screw

BB Color type

M3x6 countersunk screw, black trivalent chromate x16

M3x5 slotted raised countersunk screw, black trivalent chromate x12

SS Color type

M3x6 countersunk screw, nickel plated x16

M3x5 slotted raised countersunk screw, nickel plated x12

Components Drawing

Top Cover · Bottom Cover (HY · HYR · HYRH series)

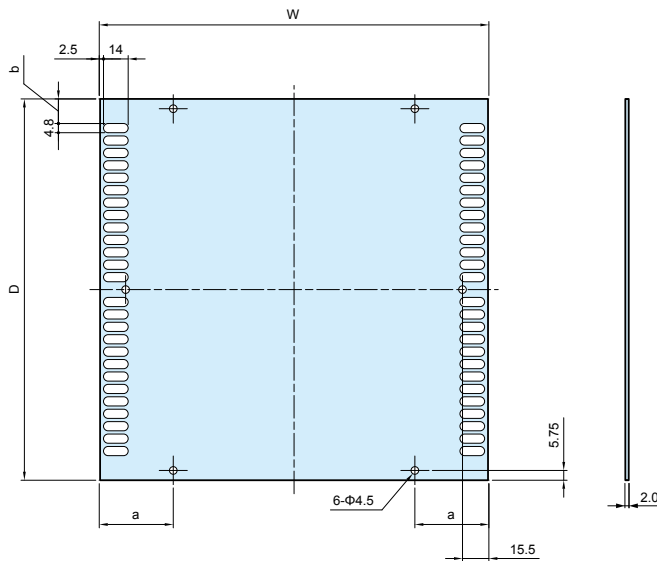

Product Information

Color code	Material	Color / Finish
SS Type	Aluminium t2.0	Silver anodized / Hairline finish
BB Type	Aluminium t2.0	Black anodized / Hairline finish

Enclosure width & length	W	D	a	b
230×230	229	224.5	45.7	14.95
230×330	229	323.5	45.7	15.1
280×230	279	224.5	55.8	14.95
280×330	279	323.5	55.8	15.1
330×230	329	224.5	65.8	14.95
330×330	329	323.5	65.8	15.1
430×230	429	224.5	85.8	14.95
430×330	429	323.5	85.8	15.1

Panel (HY series front / rear panel, HYR · HYRH series rear panel)

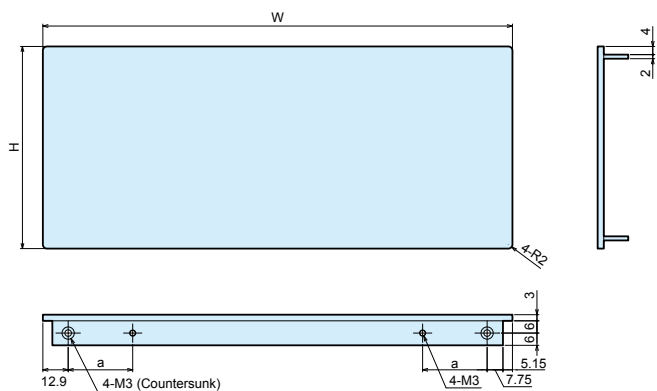

Product Information

Color code	Material	Color / Finish
SS Type	Aluminium extrusion	Silver anodized / Hairline finish
BB Type	Aluminium extrusion	Black anodized / Hairline finish

Enclosure width	W	a	H(44)	H(70)	H(88)	H(99)	H(132.5)	H(149)	H(177)
230	230	33.3	44	70	88	99	132.5	149	177
280	280	43.4	44	70	88	99	132.5	149	177
330	330	53.4	44	70	88	99	132.5	149	177
430	430	73.4	44	70	88	99	132.5	149	177

HYR Front Panel

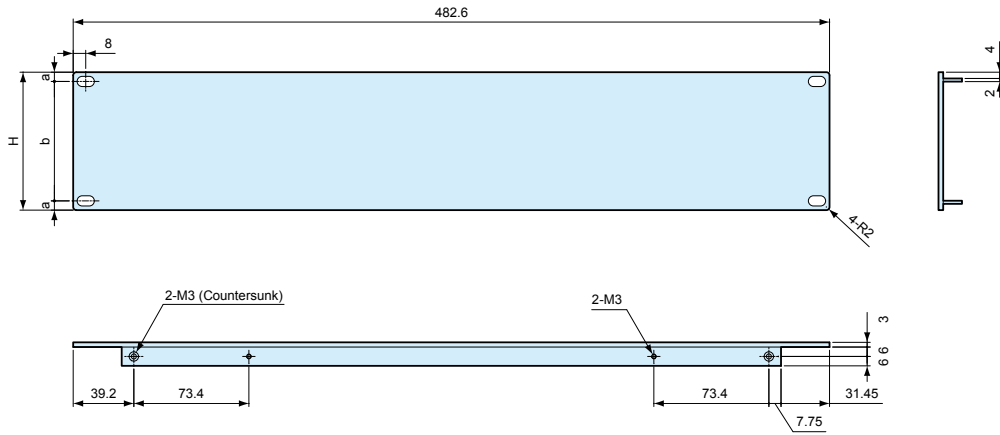

HYRH Front Panel

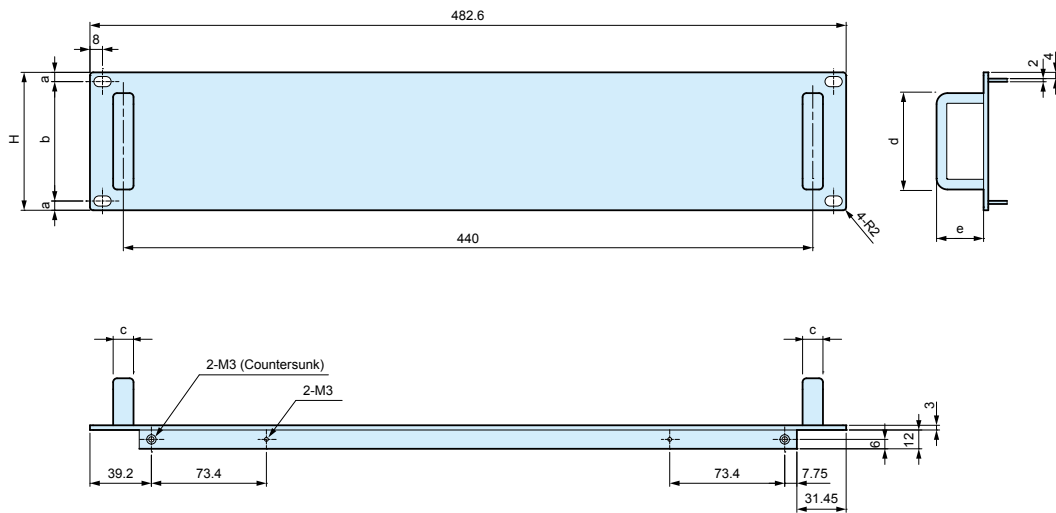

Product Information

Color code	Material	Color / Finish
SS Type	Aluminium extrusion	Silver anodized / Hairline finish
BB Type	Aluminium extrusion	Black anodized / Hairline finish

Part number	H	a	b	c	d	e
HYR/HYRH 44-43-23□	44	6.1	31.8	12	41	40
HYR/HYRH 44-43-33□	44	6.1	31.8	12	41	40
HYR/HYRH 88-43-23□	88	5.9	76.2	13	61.5	30
HYR/HYRH 88-43-33□	88	5.9	76.2	13	61.5	30
HYR/HYRH133-43-23□	132.5	37.7	57.1	13	106.5	30
HYR/HYRH133-43-33□	132.5	37.7	57.1	13	106.5	30
HYR/HYRH177-43-23□	177	37.7	101.6	13	126.5	30
HYR/HYRH177-43-33□	177	37.7	101.6	13	126.5	30

Heat-sink side plate

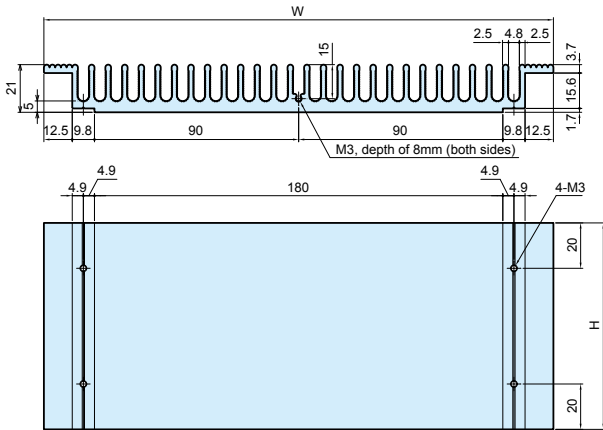

Product Information

Color code	Material	Color / Finish
SS Type	Aluminium extrusion	Silver anodized
BB Type	Aluminium extrusion	Black anodized

Enclosure width and height	W	H	Thermal resistance (°C/W)
230× 44	224.6	36	2.41
330× 44	323.6	36	1.89
230× 70	224.6	62	1.49
330× 70	323.6	62	1.36
230× 88	224.6	80	1.49
330× 88	323.6	80	1.17
230× 99	224.6	91	1.38
330× 99	323.6	91	1.08
230×132.5	224.6	124.5	1.14
330×132.5	323.6	124.5	0.89
230×149	224.6	141	1.06
330×149	323.6	141	0.83
230×177	224.6	169	0.95
330×177	323.6	169	0.74

■ Thermal resistance calculation is based on the fins being perpendicular to the ground, and at the point where the temperature rises to 60°C.

Corner Support

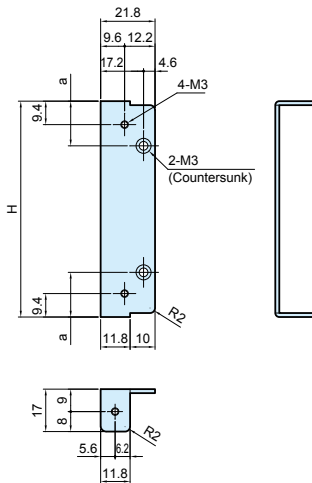

Product Information

Part name	Material	Finish
Corner support	Steel t1.6	Trivalent chromate

Enclosure height	H	a
44	31.8	10.9
70	57.8	17.9
88	75.8	17.9
99	86.8	17.9
132.5	120.3	17.9
149	136.8	17.9
177	164.8	17.9

Rubber Feet

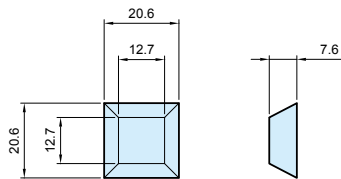

Product Information

Part name	Material	Color
Rubber feet (Part number: SJ-P5023)	Polyurethane	Black

Accessories (Optional parts)

MR SERIES Slotted raised countersunk hexalobular (torx) screw



- For use with top/bottom cover
- Recommended for aesthetic purposes, or for tampering resistance.
- Requires the use of a specialized screwdriver

Part number · Dimensions

Part number	M	L	Torx head number	Material	Color / Finish	Pack of
MR3-5ZS	3	5	T10	Steel	Nickel plated	20
MR3-5ZB	3	5	T10	Steel	Black trivalent chromate	20

HYC SERIES

EXCLUSIVE MOUNTING PLATE FOR HY · HYR · HYRH



■ Mounting plate and L bracket set.

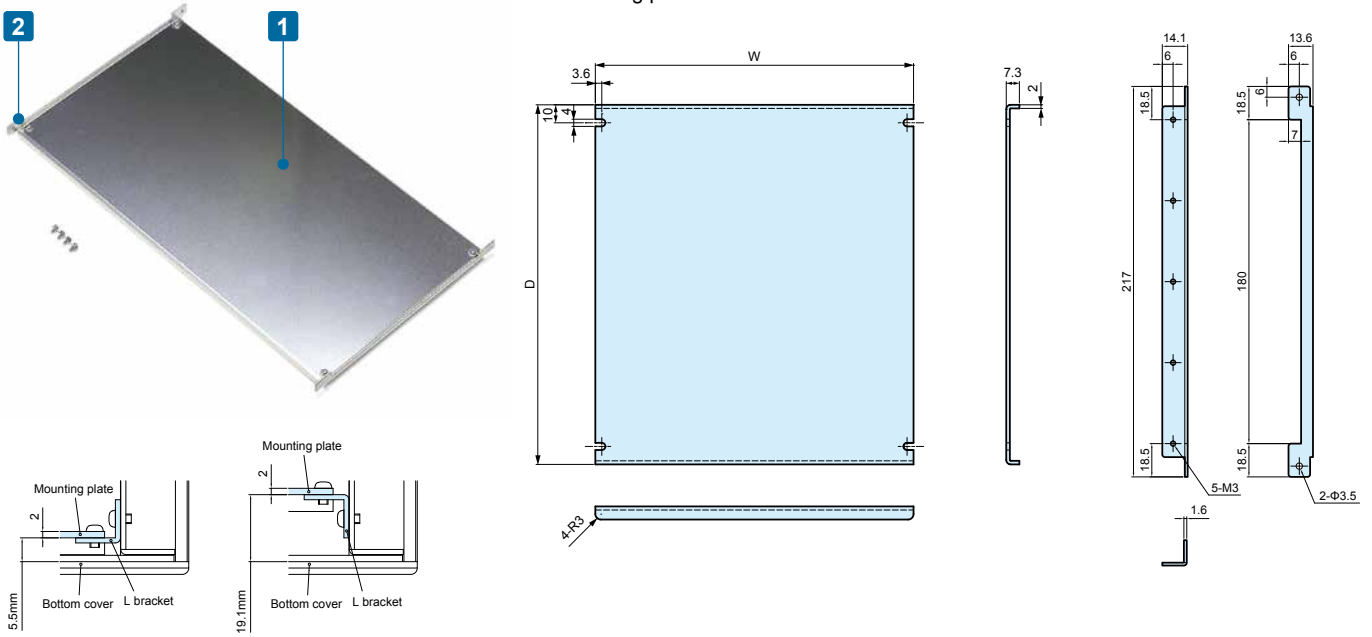

Components

No.	Part name	Pcs	Material	Color / Finish
1	Mounting plate	1	Aluminium t2.0	Unfinished
2	L bracket	2	Steel t1.6	Tivalent chromate
-	Screw	1 set	Steel M3	Tivalent chromate

Part number · Dimensions

Part number	W	D	Case size	Weight (g)
HYC23-23	177	200	230×230	300
HYC23-28	227	200	230×280	350
HYC23-33	277	200	230×330	410
HYC23-43	377	200	230×430	520
HYC33-23	177	299	330×230	450
NEW HYC33-28	227	299	330×280	550
NEW HYC33-33	277	299	330×330	710
NEW HYC33-43	377	299	330×430	800



Clinching stud customization service available.

HYCL SERIES

L MOUNTING BRACKET



- Simple L bracket and screw set.
- Use with your original mounting plate or PCB.

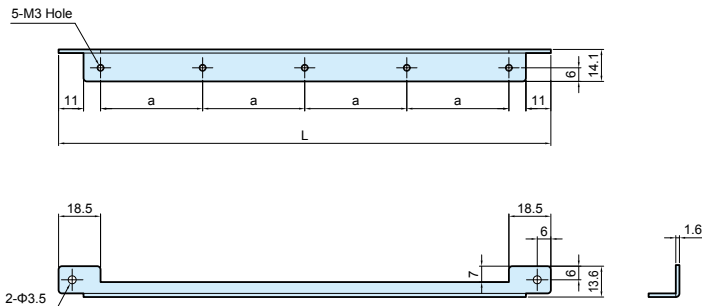

Components

No.	Part name	Material	Color / Finish
1	L bracket	Steel t1.6	Tivalent chromate
2	Screw	Steel M3	Tivalent chromate

Part number · Dimensions

Part number	L	a	b	Pack of
HYCL-23	217	45	5	2
NEW HYCL-33	316	46.5	7	2

TC SERIES

ALUMINIUM COVERED FEET



- Elegant aluminium look and feel.
- Suitable for Audio equipment use.
- Anti-slip elastomeric form pads on the base of the feet.

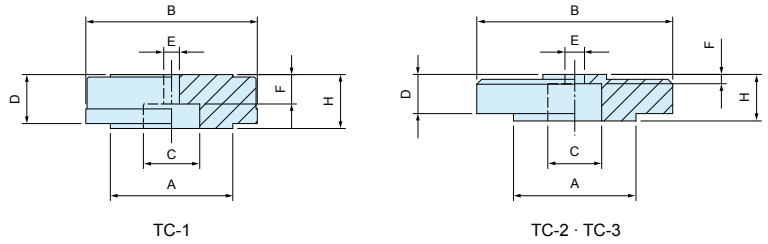

Part number · Dimensions

Part number		A	B	C	D	E	F	H	Material	Pack of
● Silver	● Gold									
TC-1S	TC-1G	25	35	11.5	9.7	3.4	5.6	11.5	ABS (UL94HB) / Aluminium / EVA	4
TC-2S	TC-2G	25	40	11	10.2	4.1	2.1	12	ABS (UL94HB) / Aluminium / EVA	4
TC-3S	TC-3G	25	45	11.7	12	4.2	7.5	15	ABS (UL94HB) / Aluminium / EVA	4

RS SERIES

SILVER · GOLD PLATED FEET



■ DXF / DWG / PDF drawings available on our website.

- Silver/Gold hot-stamped finish.
- Suitable for Audio equipment use.
- Anti-slip elastomeric form pads on the base of the feet.

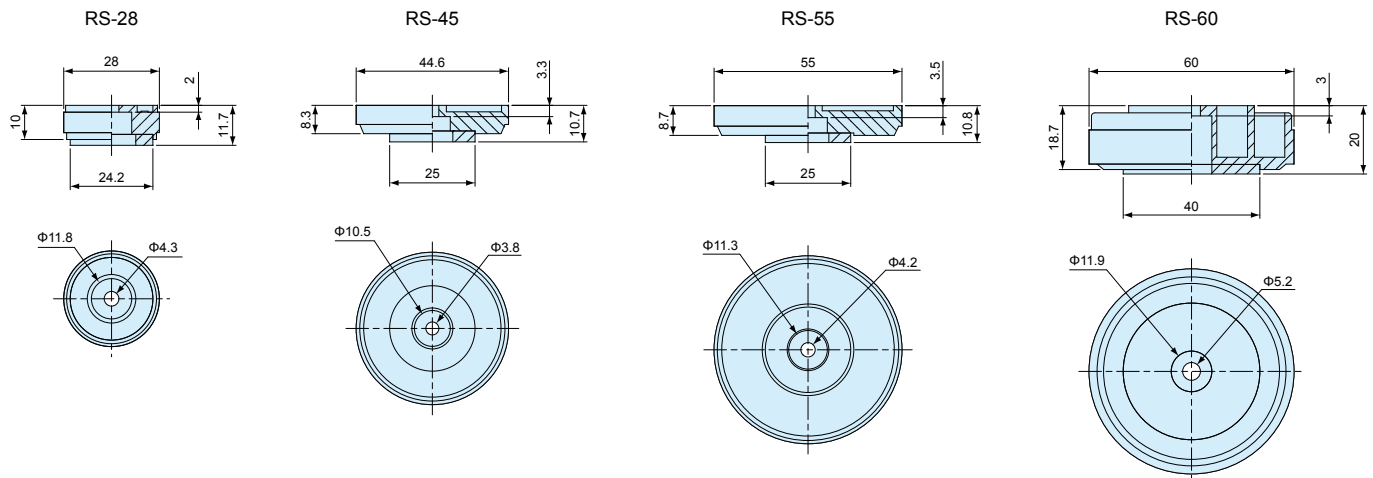

Part number · Dimensions

Part number		Material	Pack of
● Silver	● Gold		
RS-28S	RS-28G	ABS (UL94HB) / Polyester / EVA	4
RS-45S	RS-45G	ABS (UL94HB) / Polyester / EVA	4
RS-55S	RS-55G	ABS (UL94HB) / Polyester / EVA	4
RS-60S	RS-60G	ABS (UL94HB) / Polyester / EVA	4