

# SMT POWER INDUCTORS

## SLBS TYPE

CONFIGURATIONS & DIMENSIONS

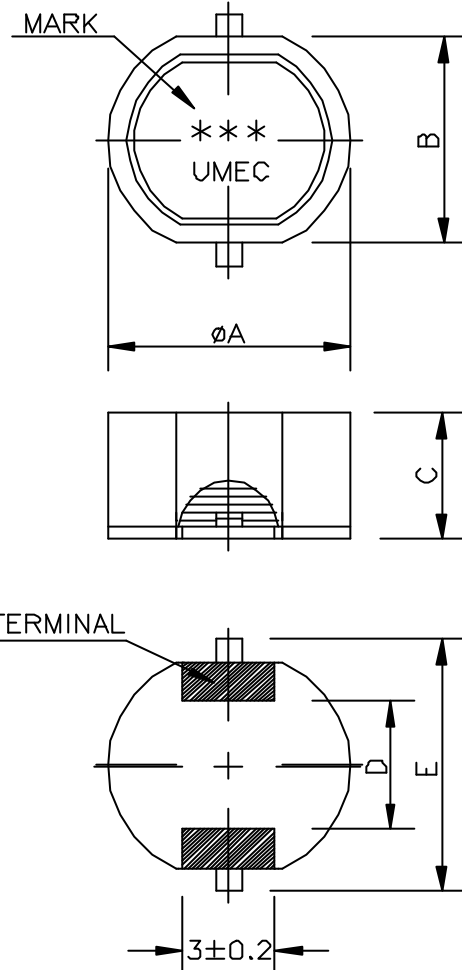

UNIT:mm

PART NAME	A	B	C	D	E
SLBS8-***	$7.8 \pm 0.3$	$7.0 \pm 0.3$	$5.7 \begin{smallmatrix} +0.4 \\ -0.3 \end{smallmatrix}$	$3.7 \pm 0.3$	$10.5^{+0}$
SLBS10-***	$10.0 \pm 0.35$	$9.0 \pm 0.35$	$5.7 \begin{smallmatrix} +0.4 \\ -0.3 \end{smallmatrix}$	$5.6 \pm 0.3$	$12.5^{+0}$
SLBS13-***	$12.6 \pm 0.4$	$11.6 \pm 0.4$	$5.7 \begin{smallmatrix} +0.4 \\ -0.3 \end{smallmatrix}$	$8.2 \pm 0.3$	$15.0^{+0}$

These are high power SMT inductors and superior to high saturation.

Tape and Reel package.

Operation Temperature :  $-30^{\circ}\text{C} \sim +100^{\circ}\text{C}$

(Contain Heating Coil) Over  $100\text{M}\ddot{\text{U}}$  at  $100\text{VD.C.}$  between coil and core.

No dielectric breakdown at  $100\text{VD.C.}$  for 1 minute between coil and core.



**UMEC Europe**  
**Universal Microelectronics**

UMEC elektronische Komponenten GmbH  
Kreuzenstraße 80 • D-74076 Heilbronn  
Tel. 07131/76170 • Fax 07131/761720

Internet: <http://www.umec-europe.com>  
<http://www.umec-web.com>

e-mail: [info@umec.de](mailto:info@umec.de)

# SMT POWER INDUCTORS

## ELECTRICAL SPECIFICATION @25°C:

UMEC PART NUMBER	MARK	INDUCTANCE(μH)	D.C.R(Ω) MAX.	RATING CURRENT(A)
<b>SLBS8 TYPE</b>				
SLBS8-100	100	10+20%/-15%	0.045	1.60
SLBS8-120	120	12+20%/-15%	0.054	1.50
SLBS8-150	150	15+20%/-15%	0.065	1.40
SLBS8-180	180	18+20%/-15%	0.075	1.30
SLBS8-220	220	22+20%/-15%	0.094	1.10
SLBS8-270	270	27+20%/-15%	0.11	1.00
SLBS8-330	330	33+20%/-15%	0.12	0.92
SLBS8-390	390	39+20%/-15%	0.15	0.84
SLBS8-470	470	47+20%/-15%	0.17	0.76
SLBS8-560	560	56+20%/-15%	0.20	0.68
SLBS8-680	680	68+20%/-15%	0.24	0.63
SLBS8-820	820	82+20%/-15%	0.28	0.58
SLBS8-101	101	100+20%/-15%	0.33	0.50
SLBS8-121	121	120+20%/-15%	0.39	0.46
SLBS8-151	151	150+20%/-15%	0.48	0.40
SLBS8-181	181	180+20%/-15%	0.63	0.38
SLBS8-221	221	220+20%/-15%	0.71	0.36
<b>SLBS10 TYPE</b>				
SLBS10-100	100	10+20%/-15%	0.034	2.40
SLBS10-120	120	12+20%/-15%	0.042	2.30
SLBS10-150	150	15+20%/-15%	0.048	2.10
SLBS10-180	180	18+20%/-15%	0.052	1.90
SLBS10-220	220	22+20%/-15%	0.058	1.70
SLBS10-270	270	27+20%/-15%	0.074	1.60
SLBS10-330	330	33+20%/-15%	0.081	1.40
SLBS10-390	390	39+20%/-15%	0.10	1.30
SLBS10-470	470	47+20%/-15%	0.11	1.20
SLBS10-560	560	56+20%/-15%	0.15	1.10
SLBS10-680	680	68+20%/-15%	0.18	0.97
SLBS10-820	820	82+20%/-15%	0.20	0.88
SLBS10-101	101	100+20%/-15%	0.26	0.80
SLBS10-121	121	120+20%/-15%	0.30	0.73
SLBS10-151	151	150+20%/-15%	0.36	0.65
SLBS10-181	181	180+20%/-15%	0.45	0.60
SLBS10-221	221	220+20%/-15%	0.51	0.54
SLBS10-271	271	270+20%/-15%	0.63	0.49
SLBS10-331	331	330+20%/-15%	0.75	0.44
SLBS10-391	391	390+20%/-15%	0.89	0.37
SLBS10-471	471	470+20%/-15%	1.16	0.37

\*INDUCTANCE & RATING CURRENT @1KHz,1V

\*The inductance can't drop 20% when loading rating current.

(hp 4284A Precision LCR METER & hp 42841A BIAS CURRENT SOURCE )

\*D.C.Resistance

(hp 34401A MULTIMETER)

DATA SHEET 04-30 JAN./98

2 OF 3



**UMEC Europe**  
**Universal Microelectronics**

UMEC elektronische Komponenten GmbH  
Kreuzenstraße 80 • D-74076 Heilbronn  
Tel. 07131/76170 • Fax 07131/761720

Internet: <http://www.umec-europe.com>

<http://www.umec-web.com>

e-mail: [info@umec.de](mailto:info@umec.de)

# SMT POWER INDUCTORS

## ELECTRICAL SPECIFICATION @25°C:

UMEC PART NUMBER	MARK	INDUCTANCE(uH)	D.C.R(Ω) MAX.	RATING CURRENT(A)
SLBS13 TYPE				
SLBS13-100	100	10+20%/-15%	0.039	2.50
SLBS13-120	120	12+20%/-15%	0.042	2.40
SLBS13-150	150	15+20%/-15%	0.051	2.30
SLBS13-180	180	18+20%/-15%	0.054	2.20
SLBS13-220	220	22+20%/-15%	0.062	2.10
SLBS13-270	270	27+20%/-15%	0.066	2.00
SLBS13-330	330	33+20%/-15%	0.073	1.90
SLBS13-390	390	39+20%/-15%	0.083	1.80
SLBS13-470	470	47+20%/-15%	0.11	1.60
SLBS13-560	560	56+20%/-15%	0.12	1.40
SLBS13-680	680	68+20%/-15%	0.14	1.30
SLBS13-820	820	82+20%/-15%	0.17	1.20
SLBS13-101	101	100+20%/-15%	0.20	1.10
SLBS13-121	121	120+20%/-15%	0.25	0.97
SLBS13-151	151	150+20%/-15%	0.30	0.86
SLBS13-181	181	180+20%/-15%	0.36	0.84
SLBS13-221	221	220+20%/-15%	0.43	0.72
SLBS13-271	271	270+20%/-15%	0.53	0.65
SLBS13-331	331	330+20%/-15%	0.59	0.61
SLBS13-391	391	390+20%/-15%	0.72	0.58
SLBS13-471	471	470+20%/-15%	0.81	0.50
SLBS13-561	561	560+20%/-15%	0.98	0.48
SLBS13-681	681	680+20%/-15%	1.16	0.43
SLBS13-821	821	820+20%/-15%	1.42	0.38
SLBS13-102	102	1000+20%/-15%	1.90	0.35
SLBS13-122	122	1200+20%/-15%	2.15	0.32
SLBS13-152	152	1500+20%/-15%	2.42	0.30

\*INDUCTANCE & RATING CURRENT @1KHz,1V

\*The inductance can't drop 20% when loading rating current.  
(hp 4284A Precision LCR METER & hp 42841A BIAS CURRENT SOURCE )

\*D.C.Resistance  
(hp 34401A MULTIMETER)

DATA SHEET 04-30 JAN./98  
3 OF 3



**UMEC Europe**  
**Universal Microelectronics**

UMEC elektronische Komponenten GmbH  
Kreuzenstraße 80 • D-74076 Heilbronn  
Tel. 07131/76170 • Fax 07131/761720

Internet: <http://www.umec-europe.com>  
<http://www.umec-web.com>

e-mail: [info@umec.de](mailto:info@umec.de)