

PIEZO BUZZER

(DRIVE CIRCUIT BUILT-IN TYPE)



APPLICATIONS

- Data processing equipments
(i.e.,keyboards,disk drives,circuit boards,
malfunction alarms)
- Electronic instruments
- Medical equipments
- Automatic control devices
- Cash registers

SOUND PRESSURE LEVEL
OSCILLATING FREQUENCY
OPERATING VOLTAGE
CURRENT CONSUMPTION
CASE MATERIAL
-tone
LEAD PIN MATERIAL
LEAD WIRE
OPERATING TEMP. RANGE
STORAGE TEMP. RANGE
WEIGHT

USE27C0	USE27C1	USE27C2
97dB min. /30cm/DC 9V	83dB min. /30cm/DC 9V	87dB min. /30cm/DC9V
3.5 ± 0.5KHz	2.5 ± 0.5KHz	3.5 ± 0.5KHz
DC 3 to 20V	DC 3 to 30V	DC 3 to 30V
8mA max. /DC 9V	8mA max. /DC 9V	8mA max. /DC 9V
ABS (UL 94HB)	PC (UL 94V-2)	PC (UL 94V-2)
Continuous Tone	Continuous Tone	Continuous Tone
	Phosphor Bronze	Phosphor Bronze
UL 1095 AWG28		
100mm±5mm		
-20°C to+60°C	-20°C to+70°C	-20°C to+70°C
-30°C to+70°C	-40°C to+85°C	-40°C to+85°C
7.3gms	5.4 gms	6.0 gms

Dimensions (Unit: mm ± 0.5)

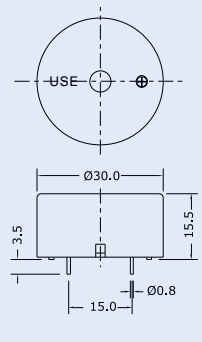
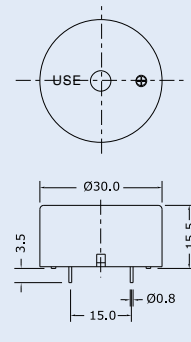
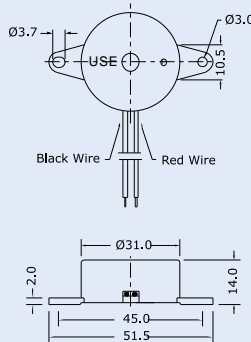

Sound Pressure Level & Current Consumption vs. Input Voltage

