



**APPLICATIONS**

- Musical toys
- Home appliances  
(microwaves, ovens, refrigerators, etc.)
- Communication equipments
- Computer peripherals and office equipments
- Instruments,etc.

**SOUND PRESSURE LEVEL**

**CAPACITANCE**

**ALLOWABLE INPUT VOLTAGE**

**CURRENT CONSUMPTION**

**CASE MATERIAL**

**LEAD PIN MATERIAL**

**OPERATING TEMP. RANGE**

**STORAGE TEMP. RANGE**

**WEIGHT**

**USE23220**

80dB min. at 2.0KHz/9Vp-p  
Square Wave/10cm  
70dB min. at 2.0KHz/1Vrms  
Sine Wave/10cm

25,000pF ± 30% at 120Hz

30Vp-p max

3mA max.at 2.0KHz/9Vp-p  
Square Wave

PBT (UL 94V-0)

Phosphor Bronze

-20°C to+70°C

-40°C to+85°C

3.2 gms

**USE23220SP**

97dB min. at 2.0KHz & 2.5KHz  
/24Vp-p Square Ware/10cm

25,000pF±30% at 120Hz

30Vp-p max

12mA max. at 2.0KHz & 2.5KHz  
/24Vp-p Square Ware

PBT (UL 94V-0)

Phosphor Bronze

-20°C to+70°C

-40°C to+85°C

4.0 gms

**USE23240**

85dB min. at 3.5KHz/9Vp-p  
Square Wave/10cm  
75dB min. at 3.5KHz/1Vrms  
Sine Wave/10cm

12,000pF ± 30% at 120Hz

30Vp-p max

4mA max.at 3.5KHz/9Vp-p  
Square Wave

PBT (UL 94V-0)

Phosphor Bronze

-20°C to+70°C

-40°C to+85°C

3.4 gms

Dimensions (Unit: mm ± 0.5)

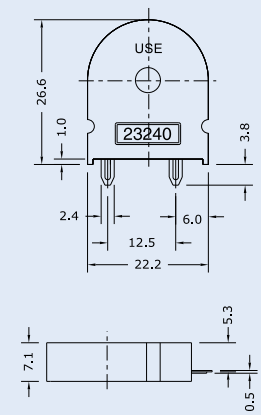
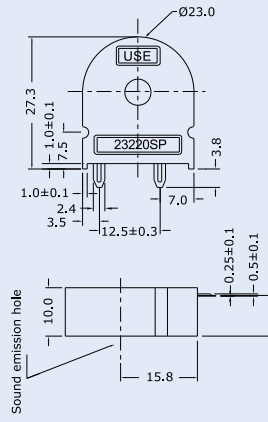
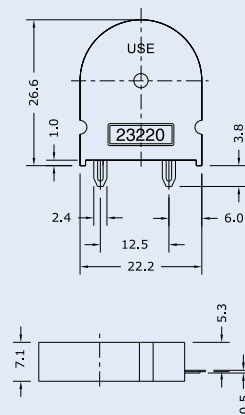

Sound Pressure Level vs. Frequency

