

**PCB connector for SMD**  
**804-A-111-SMD**  
 Push-In connection

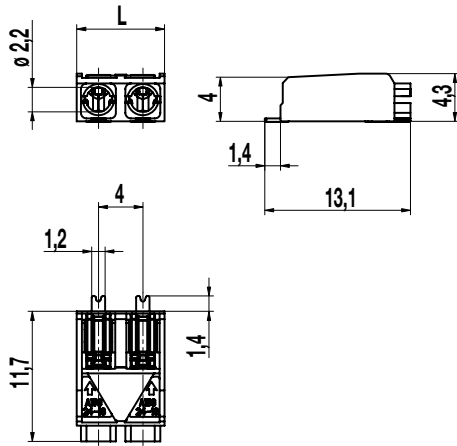

**PCB Layout (Recommendation)**

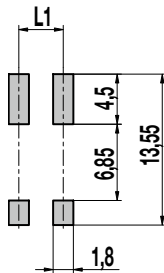

L1 = (No. of poles - 1) x pitch  
 Solder paste thickness: 0,15 - 0,2 mm

**Part Numbers**

No. of poles	804-A-111-SMD	Length	PU
1		3,80 mm	
2		7,80 mm	
3		11,80 mm	

**General Information**

Pitch	4 mm
No. of poles	1 - 3
Areas of application	Lighting technology, devices

**Technical Data**

Clamping Range	<i>solid / flexible / AWG</i> 0,2 - 0,75mm <sup>2</sup> / 0,2 - 0,75mm <sup>2</sup> / 24 - 18 AWG [1]		
Rated Cross Section	0,75 mm <sup>2</sup>		
Wire Stripping Length	6,5 mm ± 0,5 mm		
Overvoltage Category	III	III	II
Pollution Severity Level	3	2	2
Rated Voltage	32 V	125 V	160 V
Rated Impulse Voltage	1,5 kV	1,5 kV	1,5 kV
Rated Current	9 A (0,75 mm <sup>2</sup> )		
Soldering process	Reflow solder		

**Material**

Moulding	PA HT, light grey, V-0
Comparative Tracking Index	CTI ≥ 600
Insulating Group	I
Temperature Range	-40°C up to 130°C; reflow solder temperature (Peak) max. 260°C (3 - 5 s)
Terminal body	Tin plated copper alloy
Spring	Tin plated copper alloy

**Approvals**



**Part Numbers: Tape-on-Reel**

No. of poles	804-A-111-SMD	Tape Width	Tape Height	PU
1	10.813.401.A00	24,0 mm	5,1 mm	1500
2	10.813.402.A00	24,0 mm	5,1 mm	1000
3	10.813.403.A00	24,0 mm	5,1 mm	750

[1] Use of flexible conductors only with tinned ends