

PCB connector for SMD
803-A-111-SMD
 Push-In connection

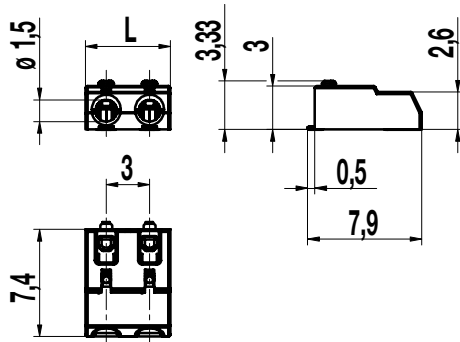

PCB Layout (Recommendation)

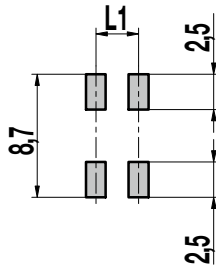

L1 = (No. of poles - 1) x pitch
 Solder paste thickness: 0,15 - 0,2 mm

Part Numbers

No. of poles	803-A-111-SMD	Length	PU
1		2,90 mm	
2		5,90 mm	
3		8,90 mm	

General Information

Pitch	3 mm
No. of poles	1 - 3
Areas of application	Lighting technology, devices

Technical Data

Clamping Range	<i>solid / flexible / AWG</i>		
	0,14 - 0,34mm ² / 0,14 - 0,34mm ² / 26 - 22 AWG [1]		
Rated Cross Section	0,2 mm ²		
Wire Stripping Length	5 mm ± 0,5 mm		
Overvoltage Category	III	III	II
Pollution Severity Level	3	2	2
Rated Voltage	32 V	125 V	160 V
Rated Impulse Voltage	1,5 kV	1,5 kV	1,5 kV
Rated Current	4 A (AWG 22) 3 A (AWG 24) 2,5 A (AWG 26)		
Soldering process	Reflow solder		

Material

Moulding	PA HT, natural, V-0
Comparative Tracking Index	CTI ≥ 600
Insulating Group	I
Temperature Range	-40°C up to 105°C; reflow solder temperature (Peak) max. 260°C (max. 10 s)
Terminal body	Tin plated copper alloy
Spring	Tin plated copper alloy

Approvals



Part Numbers: Tape-on-Reel

No. of poles	803-A-111-SMD	Tape Width	Tape Height	PU
1	10.813.301.A00	16 mm	4,1 mm	2200
2	10.813.302.A00	16 mm	4,1 mm	1400
3	10.813.303.A00	16 mm	4,1 mm	1400

[1] Use of flexible conductors only with tinned ends