

PORTABLE WORKLIGHT



Model 30-WL *Rustproof Vandal-Resistant Portable Luminaire 42 Watts Fluorescent*

Versatile worklight designed for task and small area lighting offers 42 Watts of energy efficient fluorescent illumination. **Rustproof.** Engineered with materials offering high resistance to corrosion and impact. Can be supported by the integral heavy-duty magnet, or overhead by safety chain through integral eye hook. **Polycarbonate** Lens and Housing assures rough service dependability. 0°F minimum starting temperature.

Specifications

Lens:	Injection molded of UV-stabilized polycarbonate in an average .125" thickness. Smooth exterior surface for ease of cleaning; clear prismatic interior for optimal lumen output; and rounded corners for increased impact strength and safety.
Base Plate:	Rustproof .063" 5052 H-32 tempered marine-grade aluminum.
Housing:	Injection molded UV-stabilized reinforced polycarbonate in Safety Yellow.
Gasket:	Closed-cell neoprene rubber in .125" thickness creates a tight seal against contaminants.
Socket:	Four-pin type with leads insulated for 105°C.
Lamp:	High efficiency PLT lamp offers up to ten times longer life and 70% energy savings over incandescent.
Ballast:	Electronic. Minimum of 0°F starting temperature.
Hardware:	Two stainless steel 8-32 phillips truss head screws attach lens to base plate. Water-resist Switch. Three-quarter inch center diameter <u>Eyebolt</u> for safety chain (not included).
Magnet:	Large heavy-duty for mounting on steel. Pull strength rated for 90 lbs.
Cord:	Six-foot 18 AWG SJTOW cord with three-prong NEMA 5-15 plug. Liquid tight fitting exceeds NEMA 6 specifications for moisture-secure operation. Operates on 120V AC.



Model Number 30-WL-42-PLT

Dimensions

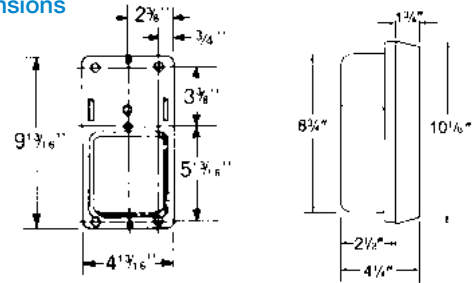

Fluorescent Lamp Performance

	42 Watt PLT
Input Watts	42W
Lumen Output	3,200
Lamp Life (Hours)	10,000
Min. Starting Temp	0°F

Specifications Subject to Change Without Notice

LENS, HOUSING, AND ALUMINUM BASE PLATE
CARRY LIFETIME GUARANTEE.



ETL-US and ETL-C Listed

All polycarbonate components meet Underwriters Laboratories 746C tests for polymeric material and carry a flammability rating of 94HB or better on lenses and the superior 94-5V rating on housings.

Luminaire Type _____
 Catalog Number _____
 Job Name _____
 Approval _____

Ordering Information

Fill In Block For Complete Catalog Number

Model

30-WL-42-PLT

WF Harris Lighting

Innovative Lighting Designs Since 1970

P.O. Box 5023, Monroe, NC 28111-5023, USA
 (704) 283-7477 (OPERATOR ASSIST) • (704) 283-6880 (FAX)
 (800) 842-9345 (TOLL FREE)

e-mail: customerservice@wfarris.com
 www.wfharrislighting.com

Printed in USA

Form 1546

9/15

"A Live Operator Company Standing Ready to Serve Your Lighting Needs"