



CN1049 SINGLE POLE

INTERCONNECT SOLUTIONS

Custom
interconnect
company servicing
high-cost-of-failure
end markets
and customers

MARKETS WE SERVE

Medical
Military/Aerospace
Test & Measurement
Data Infrastructure
Marine Oil & Gas
Rail Mass Transit
Broadcast
Semiconductor



A BROAD RANGE OF RF, SIGNAL, POWER, AND FIBER PRODUCTS

WHY WINCHESTER?

- ◆ Global Footprint - World-class Manufacturing Facilities
- ◆ Unparalleled Engineering Expertise
- ◆ World-class Prototype and Test Lab
- ◆ Personalized One-on-One Design & Development Support
- ◆ High Level of Customer Intimacy
- ◆ Customer Service Excellence
- ◆ Global Supply Chain
- ◆ Quality Assurance
- ◆ Custom Solutions Help Reduce Costs without Compromising Quality

CERTIFICATIONS

AS 7003 - SAE Aerospace Standard for Electronics
AS 9100 - Aerospace Quality Management System
ISO 9001 - Quality Management Systems
ISO 14001 - Environmental Management System
ISO 13485 - Medical Device Quality Management System
OHSAS 18001 - Occupational Health and Safety



All cable and wire harness assemblies are built and inspected to IPC/WHMA-A-620B Class 3 Standards

Quality Systems comply with FDA 21 CFR Part 820

Product Visuals.....	4
Overview.....	5
Specifications.....	6
Applications & Information.....	7
Inline Plug Female Connector Drawings.....	8
Inline Plug Male Connector Drawings.....	10
Contact Drawings.....	12
Panel Mount Female Connectors.....	14
Panel Mount Male Connectors.....	15
Part Numbering Diagrams.....	16
Cross Reference Part Numbers.....	18
Contact Us.....	23

While the information presented within our catalog is believed to be accurate and reliable, all data presented is subject to change without notice. Winchester Electronics Corporation disclaims responsibility for any damages resulting from any incompleteness or inaccuracies in the information presented. Please consult with a factory representative for specific information on the latest design options and specifications.

CN1049 SINGLE POLE INTERCONNECT SOLUTIONS PRODUCT VISUALS



Crimp and Bus Bar Contacts



Panel Mount Plugs and Receptacles shown with Contacts



Inline Plug & Receptacles shown with Contacts

CONNECTOR ASSEMBLY ATTRIBUTES

- ◆ Designed for up to 1,000 Volts (AC or DC) and up to 1,135 amps of continuous power.
- ◆ Silver-Plated, high conductive Copper Alloy contacts.
- ◆ Available in 8 colors for easy phase identification compliant to international code standards.
- ◆ Compatible with Type P Drilling Cables and accommodates cable sizes from 313 MCM to 777 MCM.
- ◆ Protected Male and Female contact “dead front” for increased safety.
- ◆ Temperature rating: -40°C to 125°C.
- ◆ Environmental rating: NEMA 3.
- ◆ Designed to UL, CSA & CE certification.
- ◆ Contacts feature locking drive pin for secure mating.
- ◆ Intermateable and interchangeable with most competitor brands.
- ◆ Our global engineering team is available to assist with your technical requirements.

CONNECTOR MATERIALS

- ◆ Receptacle Shell: Epoxy Powder Coated Aluminum Alloy.
- ◆ Contacts: Silver-Plated Copper Alloy.
- ◆ Contact front protection: Delrin™.
- ◆ Contact retention band: Heat-Treated Beryllium Copper.
- ◆ Insulators: Synthetic Resilient Rubber.
- ◆ Hardware: Stainless Steel and Aluminum.

CONNECTOR HARDWARE CONFIGURATIONS

- ◆ In-line Plug or Receptacles with Coupler.
- ◆ Panel Mount Plug or Receptacle.

CONTACT CONFIGURATIONS

- ◆ Crimp: Female or Male.
- ◆ Solder: Female or Male.
- ◆ 2-Hole Bus Bar: Female or Male.
- ◆ 1-Hole Bus Bar: Female or Male.

CN1049 SINGLE POLE INTERCONNECT SOLUTIONS SPECIFICATIONS



AMPACITY RATING - 40°C AMBIENT		
Cable Size	90°C	125°C
313 MCM	513 Amps	636 Amps
444 MCM	642 Amps	796 Amps
535 MCM	724 Amps	898 Amps
646 MCM	814 Amps	1009 Amps
777 MCM	916 Amps	1135 Amps

ELECTRICAL RATINGS	
Max Voltage	1000 V (AC/DC)
Amperage	Up to 1135 Amps Continuous
	1300 Amps Intermittent

MATERIAL SPECIFICATIONS	
Insulator	Synthetic Resilient Rubber
Receptacle Shell	Epoxy Powder Coated Aluminum Alloy
Cable Clamp Hardware	Stainless Steel
Dust Cap	Synthetic Resilient Rubber
Contact	Silver-Plated High Conductivity Copper Alloy

ENVIRONMENTAL SPECIFICATIONS	
Operating Temperature Range	-40°C to +125°C
Rating	NEMA 3

INLINE COUPLER	
Requirement	For Mating Male and Female Inline Plugs
Mechanical Features	Snap Action Locking Clip, 3-Hole Safety Pin, Lanyard
Phase Identification	Available in 10 Colors

SOCKET CONTACT	
Material	Copper
Max Temperature	180°C (Continuous)

CN1049 SINGLE POLE INTERCONNECT SOLUTIONS APPLICATIONS AND INFORMATION



UNARMORED

SINGLE CONDUCTOR TYPE P DRILLING CABLE SPECIFICATIONS

Size (AWG/KCMIL)	Conductor	Strands	Nominal OD (Inches)	Nominal OD (MM)
313.1	1.0	779.0	0.99	25.20
444.4	1.0	1119.0	1.14	29.00
535.3	1.0	1332.0	1.26	32.00
646.4	1.0	1591.0	1.35	34.30
777.7	1.0	1952.0	1.46	37.10

INTERNATIONAL PHASE COLOR CODING

Continent or Country	Phase 1	Phase 2	Phase 3	Ground	Neutral
Europe	Brown	Black	Gray	Green	Blue
UK	Red	Yellow	Blue	Green	Black
USA	Black	Red	Blue	Green	White
Australia	Red	White	Blue	Green	Black

Applications

The CN1049 Single Pole connector assemblies are suitable for use with Type P drilling cables (single conductor) per IEEE 45. These cables are used for power distribution circuits rated for up to 2000 volts and are used in the marine, oil and gas industries. Applications for the CN1049 Single Pole series include top drives, generators, transformers, cement pumps, mud pumps, and more.

CN1049 SINGLE POLE INTERCONNECT SOLUTIONS INLINE PLUG FEMALE CONNECTORS



INLINE PLUG FEMALE ASSEMBLY

	CN1049 Hardware	Female Plug	Cable Size	Color		Complete Assembly
	CN1049	FP	313 MCM	Black	BK	CN1049-FP-31-BK
				Blue	BL	CN1049-FP-31-BL
				Brown	BN	CN1049-FP-31-BN
				Red	RD	CN1049-FP-31-RD
				White	WH	CN1049-FP-31-WH
				Gray	GY	CN1049-FP-31-GY
				Orange	OR	CN1049-FP-31-OR
				Yellow	YW	CN1049-FP-31-YW
				Green	GN	CN-1049-FP-31-GN
				Purple	PR	CN-1049-FP-31-PR
	CN1049	FP	444 MCM	Black	BK	CN1049-FP-44-BK
				Blue	BL	CN1049-FP-44-BL
				Brown	BN	CN1049-FP-44-BN
				Red	RD	CN1049-FP-44-RD
				White	WH	CN1049-FP-44-WH
				Gray	GY	CN1049-FP-44-GY
				Orange	OR	CN1049-FP-44-OR
				Yellow	YW	CN1049-FP-44-YW
				Green	GN	CN-1049-FP-44-GN
				Purple	PR	CN-1049-FP-44-PR
	CN1049	FP	535 MCM	Black	BK	CN1049-FP-53-BK
				Blue	BL	CN1049-FP-53-BL
				Brown	BN	CN1049-FP-53-BN
				Red	RD	CN1049-FP-53-RD
				White	WH	CN1049-FP-53-WH
				Gray	GY	CN1049-FP-53-GY
				Orange	OR	CN1049-FP-53-OR
				Yellow	YW	CN1049-FP-53-YW
				Green	GN	CN-1049-FP-53-GN
				Purple	PR	CN-1049-FP-53-PR

CN1049 SINGLE POLE INTERCONNECT SOLUTIONS

INLINE PLUG FEMALE CONNECTORS



INLINE PLUG FEMALE ASSEMBLY

	CN1049 Hardware	Female Plug	Cable Size	Color		Complete Assembly
	CN1049	FP	646 MCM	Black	BK	CN1049-FP-64-BK
				Blue	BL	CN1049-FP-64-BL
				Brown	BN	CN1049-FP-64-BN
				Red	RD	CN1049-FP-64-RD
				White	WH	CN1049-FP-64-WH
				Gray	GY	CN1049-FP-64-GY
				Orange	OR	CN1049-FP-64-OR
				Yellow	YW	CN1049-FP-64-YW
				Green	GN	CN-1049-FP-64-GN
				Purple	PR	CN-1049-FP-64-PR
	CN1049	FP	777 MCM	Black	BK	CN1049-FP-77-BK
				Blue	BL	CN1049-FP-77-BL
				Brown	BN	CN1049-FP-77-BN
				Red	RD	CN1049-FP-77-RD
				White	WH	CN1049-FP-77-WH
				Gray	GY	CN1049-FP-77-GY
				Orange	OR	CN1049-FP-77-OR
				Yellow	YW	CN1049-FP-77-YW
				Green	GN	CN-1049-FP-77-GN
				Purple	PR	CN-1049-FP-77-PR

CN1049 SINGLE POLE INTERCONNECT SOLUTIONS INLINE PLUG MALE CONNECTORS



INLINE PLUG MALE ASSEMBLY

	CN1049 Hardware	Male Plug	Cable Size	Color		Complete Assembly
	CN1049	MP	313 MCM	Black	BK	CN1049-MP-31-BK
				Blue	BL	CN1049-MP-31-BL
				Brown	BN	CN1049-MP-31-BN
				Red	RD	CN1049-MP-31-RD
				White	WH	CN1049-MP-31-WH
				Gray	GY	CN1049-MP-31-GY
				Orange	OR	CN1049-MP-31-OR
				Yellow	YW	CN1049-MP-31-YW
				Green	GN	CN-1049-MP-31-GN
				Purple	PR	CN-1049-MP-31-PR
	CN1049	MP	444 MCM	Black	BK	CN1049-MP-44-BK
				Blue	BL	CN1049-MP-44-BL
				Brown	BN	CN1049-MP-44-BN
				Red	RD	CN1049-MP-44-RD
				White	WH	CN1049-MP-44-WH
				Gray	GY	CN1049-MP-44-GY
				Orange	OR	CN1049-MP-44-OR
				Yellow	YW	CN1049-MP-44-YW
				Green	GN	CN-1049-MP-44-GN
				Purple	PR	CN-1049-MP-44-PR
	CN1049	MP	535 MCM	Black	BK	CN1049-MP-53-BK
				Blue	BL	CN1049-MP-53-BL
				Brown	BN	CN1049-MP-53-BN
				Red	RD	CN1049-MP-53-RD
				White	WH	CN1049-MP-53-WH
				Gray	GY	CN1049-MP-53-GY
				Orange	OR	CN1049-MP-53-OR
				Yellow	YW	CN1049-MP-53-YW
				Green	GN	CN-1049-MP-53-GN
				Purple	PR	CN-1049-MP-53-PR

CN1049 SINGLE POLE INTERCONNECT SOLUTIONS INLINE PLUG MALE CONNECTORS



INLINE PLUG MALE ASSEMBLY

	CN1049 Hardware	Male Plug	Cable Size	Color		Complete Assembly
	CN1049	MP	646 MCM	Black	BK	CN1049-MP-64-BK
				Blue	BL	CN1049-MP-64-BL
				Brown	BN	CN1049-MP-64-BN
				Red	RD	CN1049-MP-64-RD
				White	WH	CN1049-MP-64-WH
				Gray	GY	CN1049-MP-64-GY
				Orange	OR	CN1049-MP-64-OR
				Yellow	YW	CN1049-MP-64-YW
				Green	GN	CN-1049-MP-64-GN
				Purple	PR	CN-1049-MP-64-PR
	CN1049	MP	777 MCM	Black	BK	CN1049-MP-77-BK
				Blue	BL	CN1049-MP-77-BL
				Brown	BN	CN1049-MP-77-BN
				Red	RD	CN1049-MP-77-RD
				White	WH	CN1049-MP-77-WH
				Gray	GY	CN1049-MP-77-GY
				Orange	OR	CN1049-MP-77-OR
				Yellow	YW	CN1049-MP-77-YW
				Green	GN	CN-1049-MP-77-GN
				Purple	PR	CN-1049-MP-77-PR

CN1049 SINGLE POLE INTERCONNECT SOLUTIONS CONTACT DRAWINGS



FEMALE 2-HOLE BUS BAR

CN1049 Contact	Female Contact	Crimp Barrel Size	2-Hole Bus Bar	Contact		
	CN201	108	2	Crimp Barrel Size 313 MCM	4131	CN201108-4131-2
				Crimp Barrel Size 444 MCM	4144	CN201108-4144-2
				Crimp Barrel Size 535 MCM	4153	CN201108-4153-2
				Crimp Barrel Size 646 MCM	4164	CN201108-4164-2
				Crimp Barrel Size 777 MCM	4177	CN201108-4177-2

FEMALE 1-HOLE BUS BAR

CN1049 Contact	Female Contact	Crimp Barrel Size	1-Hole Bus Bar	Contact		
	CN201	108	1	Crimp Barrel Size 313 MCM	4131	CN201108-4131-1
				Crimp Barrel Size 444 MCM	4144	CN201108-4144-1
				Crimp Barrel Size 535 MCM	4153	CN201108-4153-1
				Crimp Barrel Size 646 MCM	4164	CN201108-4164-1
				Crimp Barrel Size 777 MCM	4177	CN201108-4177-1

MALE 2-HOLE BUS BAR

CN1049 Contact	Male Contact	Crimp Barrel Size	2-Hole Bus Bar	Contact		
	CN201	099	2	Crimp Barrel Size 313 MCM	4031	CN201099-4031-2
				Crimp Barrel Size 444 MCM	4044	CN201099-4044-2
				Crimp Barrel Size 535 MCM	4053	CN201099-4053-2
				Crimp Barrel Size 646 MCM	4064	CN201099-4064-2
				Crimp Barrel Size 777 MCM	4077	CN201099-4077-2

MALE 1-HOLE BUS BAR

CN1049 Contact	Male Contact	Crimp Barrel Size	1-Hole Bus Bar	Contact		
	CN201	099	1	Crimp Barrel Size 313 MCM	4031	CN201099-4031-1
				Crimp Barrel Size 444 MCM	4044	CN201099-4044-1
				Crimp Barrel Size 535 MCM	4053	CN201099-4053-1
				Crimp Barrel Size 646 MCM	4064	CN201099-4064-1
				Crimp Barrel Size 777 MCM	4077	CN201099-4077-1

CN1049 SINGLE POLE INTERCONNECT SOLUTIONS CONTACT DRAWINGS



FEMALE CRIMP CONTACT

CN1049 Contact	Female Crimp Contact	Crimp Barrel Size		Contact	
	CN201	103	Crimp Barrel Size 313 MCM	4131	CN201103-4131
			Crimp Barrel Size 444 MCM	4144	CN201103-4144
			Crimp Barrel Size 535 MCM	4153	CN201103-4153
			Crimp Barrel Size 646 MCM	4164	CN201103-4164
			Crimp Barrel Size 777 MCM	4177	CN201103-4177

MALE CRIMP CONTACT

CN1049 Contact	Male Crimp Contact	Crimp Barrel Size		Contact	
	CN201	107	Crimp Barrel Size 313 MCM	4031	CN201107-4031
			Crimp Barrel Size 444 MCM	4044	CN201107-4044
			Crimp Barrel Size 535 MCM	4053	CN201107-4053
			Crimp Barrel Size 646 MCM	4064	CN201107-4064
			Crimp Barrel Size 777 MCM	4077	CN201107-4077

CN1049 SINGLE POLE INTERCONNECT SOLUTIONS

PANEL MOUNT FEMALE CONNECTORS



PANEL MOUNT RECEPTACLE, FEMALE 2-HOLE BUS BAR

	CN1049 Hardware	Panel Mount Female	2-Hole Bus Bar	Color		Complete Assembly
	CN1049	PMF	2	Black	BK	CN1049-PMF2-BK
				Blue	BL	CN1049-PMF2-BL
				Brown	BN	CN1049-PMF2-BN
				Red	RD	CN1049-PMF2-RD
				White	WH	CN1049-PMF2-WH
				Gray	GY	CN1049-PMF2-GY
				Orange	OR	CN1049-PMF2-OR
				Yellow	YW	CN1049-PMF2-YW
				Green	GN	CN-1049-PMF2-GN
				Purple	PR	CN-1049-PMF2-PR

PANEL MOUNT RECEPTACLE, FEMALE 1-HOLE BUS BAR

	CN1049 Hardware	Panel Mount Female	1-Hole Bus Bar	Color		Complete Assembly
	CN1049	PMF	1	Black	BK	CN1049-PMF1-BK
				Blue	BL	CN1049-PMF1-BL
				Brown	BN	CN1049-PMF1-BN
				Red	RD	CN1049-PMF1-RD
				White	WH	CN1049-PMF1-WH
				Gray	GY	CN1049-PMF1-GY
				Orange	OR	CN1049-PMF1-OR
				Yellow	YW	CN1049-PMF1-YW
				Green	GN	CN-1049-PMF1-GN
				Purple	PR	CN-1049-PMF1-PR

CN1049 SINGLE POLE INTERCONNECT SOLUTIONS PANEL MOUNT MALE CONNECTORS



PANEL MOUNT RECEPTACLE, MALE 2-HOLE BUS BAR

Image	CN1049 Hardware	Panel Mount Male	2-Hole Bus Bar	Color		Complete Assembly
				Color	Code	
	CN1049	PMM	2	Black	BK	CN1049-PMM2-BK
				Blue	BL	CN1049-PMM2-BL
				Brown	BN	CN1049-PMM2-BN
				Red	RD	CN1049-PMM2-RD
				White	WH	CN1049-PMM2-WH
				Gray	GY	CN1049-PMM2-GY
				Orange	OR	CN1049-PMM2-OR
				Yellow	YW	CN1049-PMM2-YW
				Green	GN	CN-1049-PMM2-GN
				Purple	PR	CN-1049-PMM2-PR

PANEL MOUNT RECEPTACLE, MALE 1-HOLE BUS BAR

Image	CN1049 Hardware	Panel Mount Male	1-Hole Bus Bar	Color		Complete Assembly
				Color	Code	
	CN1049	PMM	1	Black	BK	CN1049-PMM1-BK
				Blue	BL	CN1049-PMM1-BL
				Brown	BN	CN1049-PMM1-BN
				Red	RD	CN1049-PMM1-RD
				White	WH	CN1049-PMM1-WH
				Gray	GY	CN1049-PMM1-GY
				Orange	OR	CN1049-PMM1-OR
				Yellow	YW	CN1049-PMM1-YW
				Green	GN	CN-1049-PMM1-GN
				Purple	PR	CN-1049-PMM1-PR

CN1049 SINGLE POLE INTERCONNECT SOLUTIONS PART NUMBERING DIAGRAMS

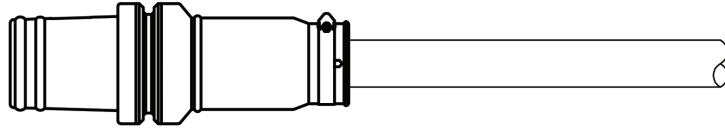

nnnnnnn - nn - nn - nn

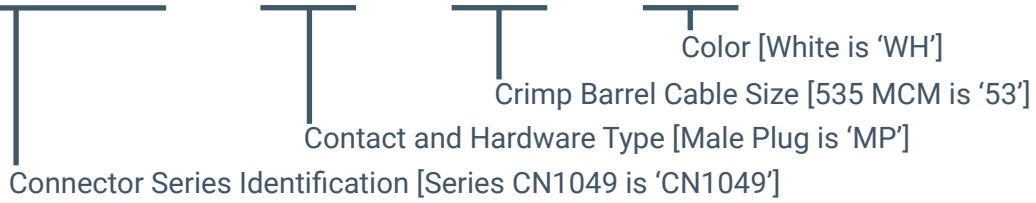

EXAMPLE PART NUMBER

CN1049-MP-53-WH

CONNECTOR HARDWARE SERIES PART NUMBERS

Connector Series Identification	CN1049
Female Plug with Cover, Lanyard, and Crimp Socket Contact	FP
Male Plug with Cover and Lanyard, and Crimp Pin Contact	MP
Female Panel Mount Receptacle, Coupler, Dust Cover, Lanyard and 2-Hole Socket Bus Bar	PMF2
Female Panel Mount Receptacle, Coupler, Dust Cover, Lanyard and 1-Hole Socket Bus Bar	PMF1
Male Panel Mount Male Receptacle, Coupler, Dust Cover, Lanyard and 2-Hole Pin Bus Bar	PMM2
Male Panel Mount Male Receptacle, Coupler, Dust Cover, Lanyard and 1-Hole Pin Bus Bar	PMM1
Black	BK
Yellow	YW
Red	RD
Orange	OR
Green	GN
White	WH
Blue	BL
Brown	BN
Purple	PR
Gray	GY

CABLE SIZE PART NUMBERS

313 MCM	31
444 MCM	44
535 MCM	53
646 MCM	64
777 MCM	77

Notes: 1. Typical cable used is Type P drilling cable per IEEE 45 but is not provided with connector assembly. 2. Custom cable assembly is available upon request. 3. Each connector assembly includes a dust cover. 4. Inline couplers are sold separately.

CN1049 SINGLE POLE INTERCONNECT SOLUTIONS

PART NUMBERING DIAGRAMS

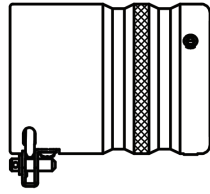

nnnnnnn - nn - nn



EXAMPLE PART NUMBER CN1049-CA-WH

INLINE COUPLER PART NUMBER TABLE	
Inline Coupler, Black	CN1049-CA-BK
Inline Coupler, Yellow	CN1049-CA-YW
Inline Coupler, Orange	CN1049-CA-OR
Inline Coupler, Red	CN1049-CA-RD
Inline Coupler, Green	CN1049-CA-GN
Inline Coupler, White	CN1049-CA-WH
Inline Coupler, Blue	CN1049-CA-BL
Inline Coupler, Brown	CN1049-CA-BN
Inline Coupler, Purple	CN1049-CA-PR
Inline Coupler, Gray	CN1049-CA-GY

Notes: 1. Inline Couplers are required for mating and securing a Male Plug and a Female Plug together. 2. Inline Couplers must be purchased separately.

CN1049 SINGLE POLE INTERCONNECT SOLUTIONS

CROSS REFERENCE PART NUMBERS



CROSS REFERENCE GUIDE

Roughneck E1049 Series	RigPower RMP II Series	Leviton Rhino-Hide 49 Series	Winchester CN1049 Single Pole Series	Description
E1049-31	RMP-CMP-3M-BK	49M31-E	CN1049-MP-31-BK	Inline Male Plug, 313 MCM, Black
E1049-32	RMP-CMP-3M-Y	49M31-Y	CN1049-MP-31-YW	Inline Male Plug, 313 MCM, Yellow
E1049-33	RMP-CMP-3M-R	49M31-R	CN1049-MP-31-RD	Inline Male Plug, 313 MCM, Red
E1049-34	RMP-CMP-3M-OR	49M31-O	CN1049-MP-31-OR	Inline Male Plug, 313 MCM, Orange
E1049-35	RMP-CMP-3M-G	49M31-G	CN1049-MP-31-GN	Inline Male Plug, 313 MCM, Green
E1049-36	RMP-CMP-3M-W	49M31-W	CN1049-MP-31-WH	Inline Male Plug, 313 MCM, White
E1049-37	RMP-CMP-3M-BL	49M31-B	CN1049-MP-31-BL	Inline Male Plug, 313 MCM, Blue
E1049-38	RMP-CMP-3M-BR	49M31-H	CN1049-MP-31-BN	Inline Male Plug, 313 MCM, Brown
E1049-39	RMP-CMP-3M-P	-	CN1049-MP-31-PR	Inline Male Plug, 313 MCM, Purple
E1049-40	RMP-CMP-3M-GY	49M31-GY	CN1049-MP-31-GY	Inline Male Plug, 313 MCM, Gray
E1049-80	RMP-CMP-3F-BK	49F31-E	CN1049-FP-31-BK	Inline Female Plug, 313 MCM, Black
E1049-81	RMP-CMP-3F-Y	49F31-Y	CN1049-FP-31-YW	Inline Female Plug, 313 MCM, Yellow
E1049-82	RMP-CMP-3F-R	49F31-R	CN1049-FP-31-RD	Inline Female Plug, 313 MCM, Red
E1049-83	RMP-CMP-3F-OR	49F31-O	CN1049-FP-31-OR	Inline Female Plug, 313 MCM, Orange
E1049-84	RMP-CMP-3F-G	49F31-G	CN1049-FP-31-GN	Inline Female Plug, 313 MCM, Green
E1049-85	RMP-CMP-3F-W	49F31-W	CN1049-FP-31-WH	Inline Female Plug, 313 MCM, White
E1049-86	RMP-CMP-3F-BL	49F31-B	CN1049-FP-31-BL	Inline Female Plug, 313 MCM, Blue
E1049-87	RMP-CMP-3F-BR	49F31-H	CN1049-FP-31-BN	Inline Female Plug, 313 MCM, Brown
E1049-88	RMP-CMP-3F-P	-	CN1049-FP-31-PR	Inline Female Plug, 313 MCM, Purple
E1049-89	RMP-CMP-3F-GY	-	CN1049-FP-31-GY	Inline Female Plug, 313 MCM, Gray
E1049-201	RMP-CMP-4M-BK	49M44-E	CN1049-MP-44-BK	Inline Male Plug, 444 MCM, Black
E1049-202	RMP-CMP-4M-Y	49M44-Y	CN1049-MP-44-YW	Inline Male Plug, 444 MCM, Yellow
E1049-203	RMP-CMP-4M-R	49M44-R	CN1049-MP-44-RD	Inline Male Plug, 444 MCM, Red
E1049-204	RMP-CMP-4M-OR	49M44-O	CN1049-MP-44-OR	Inline Male Plug, 444 MCM, Orange
E1049-205	RMP-CMP-4M-G	49M44-G	CN1049-MP-44-GN	Inline Male Plug, 444 MCM, Green
E1049-206	RMP-CMP-4M-W	49M44-W	CN1049-MP-44-WH	Inline Male Plug, 444 MCM, White
E1049-207	RMP-CMP-4M-BL	49M44-B	CN1049-MP-44-BL	Inline Male Plug, 444 MCM, Blue
E1049-208	RMP-CMP-4M-BR	49M44-H	CN1049-MP-44-BN	Inline Male Plug, 444 MCM, Brown
E1049-209	RMP-CMP-4M-P	49M44-P	CN1049-MP-44-PR	Inline Male Plug, 444 MCM, Purple
E1049-210	RMP-CMP-4M-GY	49M44-GY	CN1049-MP-44-GY	Inline Male Plug, 444 MCM, Gray
E1049-250	RMP-CMP-4F-BK	49F44-E	CN1049-FP-44-BK	Inline Female Plug, 444 MCM, Black
E1049-251	RMP-CMP-4F-Y	49F44-Y	CN1049-FP-44-YW	Inline Female Plug, 444 MCM, Yellow
E1049-252	RMP-CMP-4F-R	49F44-R	CN1049-FP-44-RD	Inline Female Plug, 444 MCM, Red
E1049-253	RMP-CMP-4F-OR	49F44-O	CN1049-FP-44-OR	Inline Female Plug, 444 MCM, Orange
E1049-254	RMP-CMP-4F-G	49F44-G	CN1049-FP-44-GN	Inline Female Plug, 444 MCM, Green
E1049-255	RMP-CMP-4F-W	49F44-W	CN1049-FP-44-WH	Inline Female Plug, 444 MCM, White
E1049-256	RMP-CMP-4F-BL	49F44-B	CN1049-FP-44-BL	Inline Female Plug, 444 MCM, Blue
E1049-257	RMP-CMP-4F-BR	49F44-H	CN1049-FP-44-BN	Inline Female Plug, 444 MCM, Brown

CN1049 SINGLE POLE INTERCONNECT SOLUTIONS

CROSS REFERENCE PART NUMBERS



CROSS REFERENCE GUIDE

Roughneck E1049 Series	RigPower RMP II Series	Leviton Rhino-Hide 49 Series	Winchester CN1049 Single Pole Series	Description
E1049-258	RMP-CMP-4F-P	-	CN1049-FP-44-PR	Inline Female Plug, 444 MCM, Purple
E1049-259	RMP-CMP-4F-GY	49F44-GY	CN1049-FP-44-GY	Inline Female Plug, 444 MCM, Gray
E1049-1	RMP-CMP-5M-BK	49M53-E	CN1049-MP-53-BK	Inline Male Plug, 535 MCM, Black
E1049-2	RMP-CMP-5M-Y	49M53-Y	CN1049-MP-53-YW	Inline Male Plug, 535 MCM, Yellow
E1049-3	RMP-CMP-5M-R	49M53-R	CN1049-MP-53-RD	Inline Male Plug, 535 MCM, Red
E1049-4	RMP-CMP-5M-OR	49M53-O	CN1049-MP-53-OR	Inline Male Plug, 535 MCM, Orange
E1049-5	RMP-CMP-5M-G	49M53-G	CN1049-MP-53-GN	Inline Male Plug, 535 MCM, Green
E1049-6	RMP-CMP-5M-W	49M53-W	CN1049-MP-53-WH	Inline Male Plug, 535 MCM, White
E1049-7	RMP-CMP-5M-BL	49M53-B	CN1049-MP-53-BL	Inline Male Plug, 535 MCM, Blue
E1049-8	RMP-CMP-5M-BR	49M53-H	CN1049-MP-53-BN	Inline Male Plug, 535 MCM, Brown
E1049-9	RMP-CMP-5M-P	49M53-P	CN1049-MP-53-PR	Inline Male Plug, 535 MCM, Purple
E1049-10	RMP-CMP-5M-GY	-	CN1049-MP-53-GY	Inline Male Plug, 535 MCM, Gray
E1049-50	RMP-CMP-5F-BK	49F53-E	CN1049-FP-53-BK	Inline Female Plug, 535 MCM, Black
E1049-51	RMP-CMP-5F-Y	49F53-Y	CN1049-FP-53-YW	Inline Female Plug, 535 MCM, Yellow
E1049-52	RMP-CMP-5F-R	49F53-R	CN1049-FP-53-RD	Inline Female Plug, 535 MCM, Red
E1049-53	RMP-CMP-5F-OR	49F53-O	CN1049-FP-53-OR	Inline Female Plug, 535 MCM, Orange
E1049-54	RMP-CMP-5F-G	49F53-G	CN1049-FP-53-GN	Inline Female Plug, 535 MCM, Green
E1049-55	RMP-CMP-5F-W	49F53-W	CN1049-FP-53-WH	Inline Female Plug, 535 MCM, White
E1049-56	RMP-CMP-5F-BL	49F53-B	CN1049-FP-53-BL	Inline female plug, 535 MCM, Blue
E1049-57	RMP-CMP-5F-BR	49F53-H	CN1049-FP-53-BN	Inline Female Plug, 535 MCM, Brown
E1049-58	RMP-CMP-5F-P	49F53-P	CN1049-FP-53-PR	Inline Female Plug, 535 MCM, Purple
E1049-59	RMP-CMP-5F-GY	49F53-GY	CN1049-FP-53-GY	Inline Female Plug, 535 MCM, Gray
E1049-11	RMP-CMP-6M-BK	49M64-E	CN1049-MP-64-BK	Inline Male Plug, 646 MCM, Black
E1049-12	RMP-CMP-6M-Y	49M64-Y	CN1049-MP-64-YW	Inline Male Plug, 646 MCM, Yellow
E1049-13	RMP-CMP-6M-R	49M64-R	CN1049-MP-64-RD	Inline Male Plug, 646 MCM, Red
E1049-14	RMP-CMP-6M-OR	49M64-O	CN1049-MP-64-OR	Inline Male Plug, 646 MCM, Orange
E1049-15	RMP-CMP-6M-G	49M64-G	CN1049-MP-64-GN	Inline Male Plug, 646 MCM, Green
E1049-16	RMP-CMP-6M-W	49M64-W	CN1049-MP-64-WH	Inline Male Plug, 646 MCM, White
E1049-17	RMP-CMP-6M-BL	49M64-B	CN1049-MP-64-BL	Inline Male Plug, 646 MCM, Blue
E1049-18	RMP-CMP-6M-BR	49M64-H	CN1049-MP-64-BN	Inline Male Plug, 646 MCM, Brown
E1049-19	RMP-CMP-6M-P	-	CN1049-MP-64-PR	Inline Male Plug, 646 MCM, Purple
E1049-20	RMP-CMP-6M-GY	49M64-GY	CN1049-MP-64-GY	Inline Male Plug, 646 MCM, Gray
E1049-60	RMP-CMP-6F-BK	49F64-E	CN1049-FP-64-BK	Inline Female Plug, 646 MCM, Black
E1049-61	RMP-CMP-6F-Y	49F64-Y	CN1049-FP-64-YW	Inline Female Plug, 646 MCM, Yellow
E1049-62	RMP-CMP-6F-R	49F64-R	CN1049-FP-64-RD	Inline Female Plug, 646 MCM, Red
E1049-63	RMP-CMP-6F-OR	49F64-O	CN1049-FP-64-OR	Inline Female Plug, 646 MCM, Orange
E1049-64	RMP-CMP-6F-G	49F64-G	CN1049-FP-64-GN	Inline Female Plug, 646 MCM, Green
E1049-65	RMP-CMP-6F-W	49F64-W	CN1049-FP-64-WH	Inline Female Plug, 646 MCM, White

CN1049 SINGLE POLE INTERCONNECT SOLUTIONS

CROSS REFERENCE PART NUMBERS



CROSS REFERENCE GUIDE

Roughneck E1049 Series	RigPower RMP II Series	Leviton Rhino-Hide 49 Series	Winchester CN1049 Single Pole Series	Description
E1049-66	RMP-CMP-6F-BL	49F64-B	CN1049-FP-64-BL	Inline Female Plug, 646 MCM, Blue
E1049-67	RMP-CMP-6F-BR	49F64-H	CN1049-FP-64-BN	Inline Female Plug, 646 MCM, Brown
E1049-68	RMP-CMP-6F-P	49F64-P	CN1049-FP-64-PR	Inline Female Plug, 646 MCM, Purple
E1049-69	RMP-CMP-5F-GY	49F64-G	CN1049-FP-64-GY	Inline Female Plug, 646 MCM, Gray
E1049-21	RMP-CMP-7M-BK	49M77-E	CN1049-MP-77-BK	Inline Male Plug, 777 MCM, Black
E1049-22	RMP-CMP-7M-Y	49M77-Y	CN1049-MP-77-YW	Inline Male Plug, 777 MCM, Yellow
E1049-23	RMP-CMP-7M-R	49M77-R	CN1049-MP-77-RD	Inline Male Plug, 777 MCM, Red
E1049-24	RMP-CMP-7M-OR	49M77-O	CN1049-MP-77-OR	Inline Male Plug, 777 MCM, Orange
E1049-25	RMP-CMP-7M-G	49M77-G	CN1049-MP-77-GN	Inline Male Plug, 777 MCM, Green
E1049-26	RMP-CMP-7M-W	49M77-W	CN1049-MP-77-WH	Inline Male Plug, 777 MCM, White
E1049-27	RMP-CMP-7M-BL	49M77-B	CN1049-MP-77-BL	Inline Male Plug, 777 MCM, Blue
E1049-28	RMP-CMP-7M-BR	49M77-H	CN1049-MP-77-BN	Inline Male Plug, 777 MCM, Brown
E1049-29	RMP-CMP-7M-P	-	CN1049-MP-77-PR	Inline Male Plug, 777 MCM, Purple
E1049-30	RMP-CMP-7M-GY	49M77-GY	CN1049-MP-77-GY	Inline Male Plug, 777 MCM, Gray
E1049-70	RMP-CMP-7F-BK	49F77-E	CN1049-FP-77-BK	Inline Female Plug, 777 MCM, Black
E1049-71	RMP-CMP-7F-Y	49F77-Y	CN1049-FP-77-YW	Inline Female Plug, 777 MCM, Yellow
E1049-72	RMP-CMP-7F-R	49F77-R	CN1049-FP-77-RD	Inline Female Plug, 777 MCM, Red
E1049-73	RMP-CMP-7F-OR	49F77-O	CN1049-FP-77-OR	Inline Female Plug, 777 MCM, Orange
E1049-74	RMP-CMP-7F-G	49F77-G	CN1049-FP-77-GN	Inline Female Plug, 777 MCM, Green
E1049-75	RMP-CMP-7F-W	49F77-W	CN1049-FP-77-WH	Inline Female Plug, 777 MCM, White
E1049-76	RMP-CMP-7F-BL	49F77-B	CN1049-FP-77-BL	Inline Female Plug, 777 MCM, Blue
E1049-77	RMP-CMP-7F-BR	49F77-H	CN1049-FP-77-BN	Inline Female Plug, 777 MCM, Brown
E1049-78	RMP-CMP-7F-P	49F77-P	CN1049-FP-77-PR	Inline Female Plug, 777 MCM, Purple
E1049-79	RMP-CMP-7F-GY	49F77-GY	CN1049-FP-77-GY	Inline Female Plug, 777 MCM, Gray
E1049-1833X-BK	RMP-PMR-2F-BK	49FR2-CE	CN1049-PMF2-BK	Panel Mount Receptacle, Female 2-Hole Bus Bar, Black
E1049-1834X-Y	RMP-PMR-2F-Y	49FR2-CY	CN1049-PMF2-YW	Panel Mount Receptacle, Female 2-Hole Bus Bar, Yellow
E1049-1835X-R	RMP-PMR-2F-R	49FR2-CR	CN1049-PMF2-RD	Panel Mount Receptacle, Female 2-Hole Bus Bar, Red
E1049-1836X-OR	RMP-PMR-2F-OR	49FR2-CO	CN1049-PMF2-OR	Panel Mount Receptacle, Female 2-Hole Bus Bar, Orange
E1049-1837X-G	RMP-PMR-2F-G	49FR2-CG	CN1049-PMF2-GN	Panel Mount Receptacle, Female 2-Hole Bus Bar, Green
E1049-1838X-W	RMP-PMR-2F-W	49FR2-CW	CN1049-PMF2-WH	Panel Mount Receptacle, Female 2-Hole Bus Bar, White
E1049-1839X-BL	RMP-PMR-2F-BL	49FR2-CB	CN1049-PMF2-BL	Panel Mount Receptacle, Female 2-Hole Bus Bar, Blue
E1049-1840X-BR	RMP-PMR-2F-BR	49FR2-CH	CN1049-PMF2-BN	Panel Mount Receptacle, Female 2-Hole Bus Bar, Brown
E1049-1822X-PR	RMP-PMR-2F-P	49FR2-CP	CN1049-PMF2-PR	Panel Mount Receptacle, Female 2-Hole Bus Bar, Purple
E1049-1823X-GY	RMP-PMR-2F-GY	49FR2-CGY	CN1049-PMF2-GY	Panel Mount Receptacle, Female 2-Hole Bus Bar, Gray
E1049-1825X-BK	RMP-PMR-1F-BK	49FR1-CE	CN1049-PMF1-BK	Panel Mount Receptacle, Female 1-Hole Bus Bar, Black
E1049-1826X-Y	RMP-PMR-1F-Y	49FR1-CY	CN1049-PMF1-YW	Panel Mount Receptacle, Female 1-Hole Bus Bar, Yellow
E1049-1827X-R	RMP-PMR-1F-R	49FR1-CR	CN1049-PMF1-RD	Panel Mount Receptacle, Female 1-Hole Bus Bar, Red
E1049-1828X-OR	RMP-PMR-1F-OR	49FR1-CO	CN1049-PMF1-OR	Panel Mount Receptacle, Female 1-Hole Bus Bar, Orange

CN1049 SINGLE POLE INTERCONNECT SOLUTIONS

CROSS REFERENCE PART NUMBERS



CROSS REFERENCE GUIDE

Roughneck E1049 Series	RigPower RMP II Series	Leviton Rhino-Hide 49 Series	Winchester CN1049 Single Pole Series	Description
E1049-1829X-G	RMP-PMR-1F-G	49FR1-CG	CN1049-PMF1-GN	Panel Mount Receptacle, Female 1-Hole Bus Bar, Green
E1049-1830X-W	RMP-PMR-1F-W	49FR1-CW	CN1049-PMF1-WH	Panel Mount Receptacle, Female 1-Hole Bus Bar, White
E1049-1831X-BL	RMP-PMR-1F-BL	49FR1-CB	CN1049-PMF1-BL	Panel Mount Receptacle, Female 1-Hole Bus Bar, Blue
E1049-1832X-BN	RMP-PMR-1F-BR	49FR1-CH	CN1049-PMF1-BN	Panel Mount Receptacle, Female 1-Hole Bus Bar, Brown
E1049-1820X-PR	RMP-PMR-1F-P	49FR1-CP	CN1049-PMF1-PR	Panel Mount Receptacle, Female 1-Hole Bus Bar, Purple
E1049-1821X-GY	RMP-PMR-1F-GY	49FR1-CGY	CN1049-PMF1-GY	Panel Mount Receptacle, Female 1-Hole Bus Bar, Gray
E1049-1808X-BK	RMP-PMR-2M-BK	49MR2-CE	CN1049-PMM2-BK	Panel Mount Receptacle, Male 2-Hole Bus Bar, Black
E1049-1809X-Y	RMP-PMR-2M-Y	49MR2-CY	CN1049-PMM2-YW	Panel Mount Receptacle, Male 2-Hole Bus Bar, Yellow
E1049-1810X-R	RMP-PMR-2M-R	49MR2-CR	CN1049-PMM2-RD	Panel Mount Receptacle, Male 2-Hole Bus Bar, Red
E1049-1811X-OR	RMP-PMR-2M-OR	49MR2-CO	CN1049-PMM2-OR	Panel Mount Receptacle, Male 2-Hole Bus Bar, Orange
E1049-1812X-G	RMP-PMR-2M-G	49MR2-CG	CN1049-PMM2-GN	Panel Mount Receptacle, Male 2-Hole Bus Bar, Green
E1049-1813X-W	RMP-PMR-2M-W	49MR2-CW	CN1049-PMM2-WH	Panel Mount Receptacle, Male 2-Hole Bus Bar, White
E1049-1814X-BL	RMP-PMR-2M-BL	49MR2-CB	CN1049-PMM2-BL	Panel Mount Receptacle, Male 2-Hole Bus Bar, Blue
E1049-1815X-BR	RMP-PMR-2M-BR	49MR2-CH	CN1049-PMM2-BN	Panel Mount Receptacle, Male 2-Hole Bus Bar, Brown
E1049-1818X-PR	RMP-PMR-2M-P	49MR2-CP	CN1049-PMM2-PR	Panel Mount Receptacle, Male 2-Hole Bus Bar, Purple
E1049-1819X-GY	RMP-PMR-2M-GY	49MR2-CGY	CN1049-PMM2-GY	Panel Mount Receptacle, Male 2-Hole Bus Bar, Gray
E1049-1800X-BK	RMP-PMR-1M-BK	49MR1-CE	CN1049-PMM1-BK	Panel Mount Receptacle, Male 1-Hole Bus Bar, Black
E1049-1801X-Y	RMP-PMR-1M-Y	49MR1-CY	CN1049-PMM1-Y	Panel Mount Receptacle, Male 1-Hole Bus Bar, Yellow
E1049-1802X-R	RMP-PMR-1M-R	49MR1-CR	CN1049-PMM1-R	Panel Mount Receptacle, Male 1-Hole Bus Bar, Red
E1049-1803X-OR	RMP-PMR-1M-OR	49MR1-CO	CN1049-PMM1-OR	Panel Mount Receptacle, Male 1-Hole Bus Bar, Orange
E1049-1804X-G	RMP-PMR-1M-G	49MR1-CG	CN1049-PMM1-GN	Panel Mount Receptacle, Male 1-Hole Bus Bar, Green
E1049-1805X-W	RMP-PMR-1M-W	49MR1-CW	CN1049-PMM1-WH	Panel Mount Receptacle, Male 1-Hole Bus Bar, White
E1049-1806X-BL	RMP-PMR-1M-BL	49MR1-CB	CN1049-PMM1-BL	Panel Mount Receptacle, Male 1-Hole Bus Bar, Blue
E1049-1807X-BR	RMP-PMR-1M-BR	49MR1-CH	CN1049-PMM1-BN	Panel Mount Receptacle, Male 1-Hole Bus Bar, Brown
E1049-1816X-PR	RMP-PMR-1M-P	49MR1-CP	CN1049-PMM1-PR	Panel Mount Receptacle, Male 1-Hole Bus Bar, Purple
E1049-1817X-GY	RMP-PMR-1M-GY	49MR1-CGY	CN1049-PMM1-GY	Panel Mount Receptacle, Male 1-Hole Bus Bar, Gray
-	RMP-CMR-BK	-	CN1049-CA-BK	Inline Coupler, Black
-	RMP-CMR-Y	-	CN1049-CA-YW	Inline Coupler, Yellow
-	RMP-CMR-R	-	CN1049-CA-RD	Inline Coupler, Red
-	RMP-CMR-G	-	CN1049-CA-GN	Inline Coupler, Green
-	RMP-CMR-GY	-	CN1049-CA-WH	Inline Coupler, White
-	RMP-CMR-BL	-	CN1049-CA-BL	Inline Coupler, Blue
-	RMP-CMR-BR	-	CN1049-CA-BN	Inline Coupler, Brown
-	RMP-CMR-P	-	CN1049-CA-PR	Inline Coupler, Purple
-	RMP-CMR-GY	-	CN1049-CA-GY	Inline Coupler, Gray
-	-	-	CN201108-4131-2	2-Hole Female Bus Bar, Crimp Barrel Size 313 MCM
-	-	-	CN201108-4144-2	2-Hole Female Bus Bar, Crimp Barrel Size 444 MCM
-	-	-	CN201108-4153-2	2-Hole Female Bus Bar, Crimp Barrel Size 535 MCM
-	-	-	CN201108-4164-2	2-Hole Female Bus Bar, Crimp Barrel Size 646 MCM

CN1049 SINGLE POLE INTERCONNECT SOLUTIONS

CROSS REFERENCE PART NUMBERS



CROSS REFERENCE GUIDE

Roughneck E1049 Series	RigPower RMP II Series	Leviton Rhino-Hide 49 Series	Winchester CN1049 Single Pole Series	Description
-	-	-	CN201108-4177-2	2-Hole Female Bus Bar, Crimp Barrel Size 777 MCM
-	-	-	CN201108-4131-1	1-Hole Female Bus Bar, Crimp Barrel Size 313 MCM
-	-	-	CN201108-4144-1	1-Hole Female Bus Bar, Crimp Barrel Size 444 MCM
-	-	-	CN201108-4153-1	1-Hole Female Bus Bar, Crimp Barrel Size 535 MCM
-	-	-	CN201108-4164-1	1-Hole Female Bus Bar, Crimp Barrel Size 646 MCM
-	-	-	CN201108-4177-1	1-Hole Female Bus Bar, Crimp Barrel Size 777 MCM
-	-	-	CN201099-4031-2	2-Hole Male Bus Bar, Crimp Barrel Size 313 MCM
-	-	-	CN201099-4044-2	2-Hole Male Bus Bar, Crimp Barrel Size 444 MCM
-	-	-	CN201099-4053-2	2-Hole Male Bus Bar, Crimp Barrel Size 535 MCM
-	-	-	CN201099-4064-1	1-Hole Male Bus Bar, Crimp Barrel Size 646 MCM
-	-	-	CN201099-4077-2	2-Hole Male Bus Bar, Crimp Barrel Size 777 MCM
-	-	-	CN201099-4031-1	1-Hole Male Bus Bar, Crimp Barrel Size 313 MCM
-	-	-	CN201099-4044-1	1-Hole Male Bus Bar, Crimp Barrel Size 444 MCM
-	-	-	CN201099-4053-1	1-Hole Male Bus Bar, Crimp Barrel Size 535 MCM
-	-	-	CN201099-4064-1	2-Hole Male Bus Bar, Crimp Barrel Size 646 MCM
-	-	-	CN201099-4077-1	1-Hole Male Bus Bar, Crimp Barrel Size 777 MCM
-	-	49F31-C	CN201103-4131	Female Contact, Crimp Barrel Size 313 MCM
-	-	49F44-C	CN201103-4144	Female Contact, Crimp Barrel Size 444 MCM
-	-	49F53-C	CN201103-4153	Female Contact, Crimp Barrel Size 535 MCM
-	-	49F64-C	CN201103-4164	Female Contact, Crimp Barrel Size 646 MCM
-	-	49F77-C	CN201103-4177	Female Contact, Crimp Barrel Size 777 MCM
-	-	49M31-C	CN201107-4031	Male Contact, Crimp Barrel Size 313 MCM
-	-	49M44-C	CN201107-4044	Male Contact, Crimp Barrel Size 444 MCM
-	-	49M53-C	CN201107-4053	Male Contact, Crimp Barrel Size 535 MCM
-	-	49M64-C	CN201107-4064	Male Contact, Crimp Barrel Size 646 MCM
-	-	49M77-C	CN201107-4077	Male Contact, Crimp Barrel Size 777 MCM



Marine oil Gas Interconnect Inquiries:
SOURCE TECHNOLOGY



Houston, Texas

- ◆ Overmold custom cable assemblies & measurement while drilling solutions
- ◆ Pressure transducers, draw works encoders, drill line hookload sensors and wired interconnect shafts
- ◆ ATEX and IECEx certified
- ◆ 16,000 Sq. Ft.

281.894.5890 Phone

Interconnect Inquiries:
CLEMENTS NATIONAL COMPANY



Broadview, Illinois

- ◆ Electrical Power, Control and Signal Circular Connectors
- ◆ Custom Cables, Control Panels and Other Interconnect Solutions
- ◆ ISO 9001:2008, ATEX, ICECEX, Intertek Certified
- ◆ 54,000 Sq. Ft.

708.594.5890 Phone



CONTACT INFORMATION

NORTH AMERICA - United States

Winchester Electronics Middlebury
Division of Winchester Electronics
199 Park Road Extension - Suite 104
Middlebury, Connecticut 06762
203.741.5400 Phone
203.741.5500 Fax

Winchester Electronics Franklin
Division of Winchester Electronics
101 Constitution Boulevard - Suite B
Franklin, Massachusetts 02038
508.541.3404 Phone
203.741.5500 Fax

Winchester Electronics Spartanburg
Division of Winchester Electronics
2525 Chesnee Highway
Spartanburg, South Carolina 29307
864.804.5300 Phone
864.804.5301 Fax

Clements National Company
Division of Winchester Electronics
2150 Parkes Drive
Broadview, Illinois 60155
708.594.5890 Phone
708.594.2481 Fax

SRC Haverhill
Division of Winchester Electronics
5590 Skylane Boulevard
Santa Rosa, California 95403
707.573.1900 Phone
707.573.1999 Fax

TRU Corporation
Division of Winchester Electronics
245 Lynnfield Street
Peabody, Massachusetts 01960
978.532.0775 Phone
978.531.6993 Fax

Source Technology
Division of Winchester Electronics
11255 Amira Drive
Houston, Texas 77065
281.894.6171 Phone
281.807.4546 Fax

SRI Hermetics
Division of Winchester Electronics
3950 Dow Road
Melbourne, Florida 32934-9289
321.254.4067 Phone
321.752.9221 Fax

NORTH AMERICA - Mexico

Winchester Electronics Nogales
Carretera Int'l Km. 7.5A
Parque Industrial El Cid
Nogales, Sonora, Mexico
203.741.5570 Phone
203.741.5500 Fax

ASIA - China

Winchester Electronics (Suzhou) Co., LTD
No. 18 QunXing First Street
SIP, Suzhou, P.R. China, 215006
86.512.6252.9838 Phone
86.512.6762.9638 Fax

ASIA - Malaysia

Winchester Electronics (M) SDN. BHD
No. 1651, Lorong Perusahaan Maju 8
Prai Industrial Estate Phase IV
13600 Prai, Penang, Malaysia
6.04.5083535 Phone
6.04.5080810 Fax

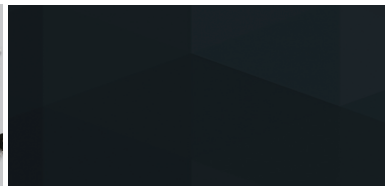

Please contact Customer Service at **1.203.741.5400** or visit us online at **www.winchesterelectronics.com** for information about our full line of product offerings.

BRANDS

