

1

2

3

4

5

6

7

Male

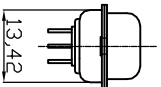
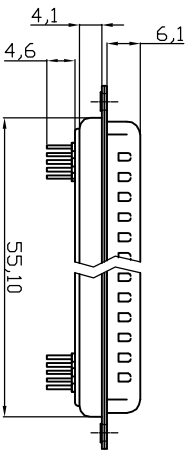
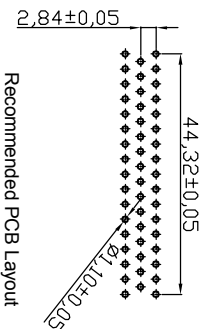
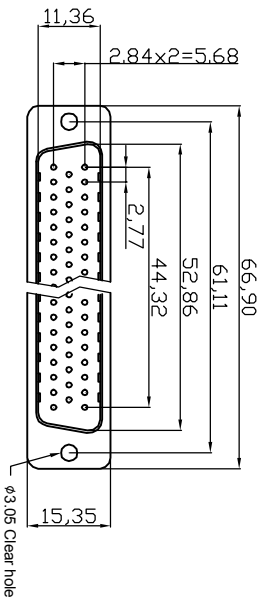
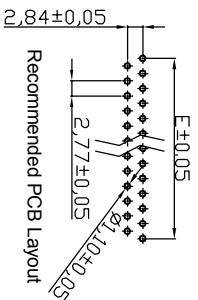
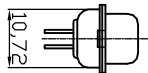
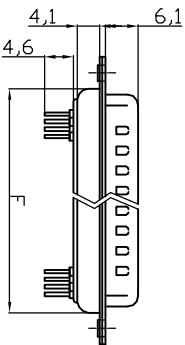
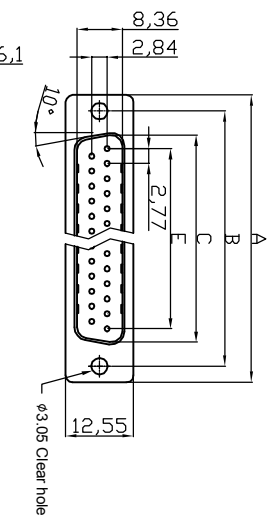

50 Positions

Dimensions		A	B	C	E	F
Positions	09	30.81	24.99	16.92	11.08	19.20
	15	39.20	33.30	25.25	19.39	27.70
	25	53.04	47.04	38.96	33.24	41.10
	37	69.40	63.50	55.42	49.86	57.30

RoHS compliant

Unit:mm

Scale	Free	⑤	⑤	⑤	⑤	⑤
TOLERANCE		Add the contact plating 15u"Au	01.09.2017	Winnie	Date	Name
X.	±0.38	④ Add the detail contact plating	23.12.2016	Winnie	Drawn	Lucas
X.X	±0.25	③ Update the dimension	27.02.2015	Winnie	Approved	01.09.2017
X.XX	±0.13	② Update the operating temperature&UL No.	04.08.2014	Winnie		
DIM	TOL	① Update	24.10.2012	Winnie		
X.°	±3°	① Drawn	15.08.2012	Lucas		
X.X°	±1.0°	① Id.		Modification		
Angle	TOL					

NOTES:

MATERIAL

1. Insulator Material: Glass-filled thermoplastic PBT, UL94V-0
2. Contact Material: Brass or Phosphor Bronze
3. Shell : Steel, 100 μ" Tin Over 50μ" min Copper
4. Clinch Nut : Brass,Nickel Plated
- ⑤ 5 Contact plating : Gold flash full gold &selective 15u"Au ELECTRICAL

1. Current Rating : 3AMP
2. Voltage Rating : 250V AC/rms 60Hz
3. Contact Resistance: 20mΩ
4. Insulation Resistance: 1000MΩ min at 500 VDC.
5. Withstand Voltage: 1000V AC/rms 60Hz for 1 minute ENVIRONMENTAL

- ② 1. Temperature Range: -20°C~+105°C
- ② UL No. E198287
- ⑤ Order Code:

A-Dx xx PP/Z-X

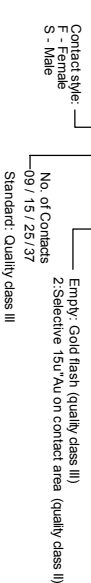

Customer-No.

ASSMANN WSW-No.

A-DX XX PP/Z-X

Drawing-No.

ASS 4885 CO rev05

Replace

Sheet 1/2

1

2

3

4

5

6

7

H

G

F

E

D

C

B

A

1

2

3

4

5

6

7

Female

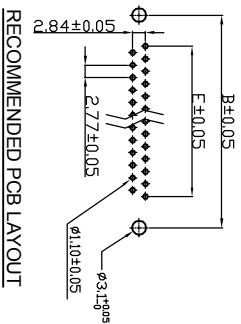
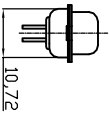
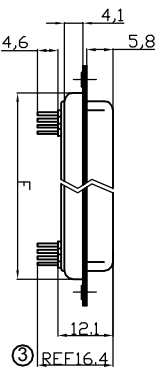
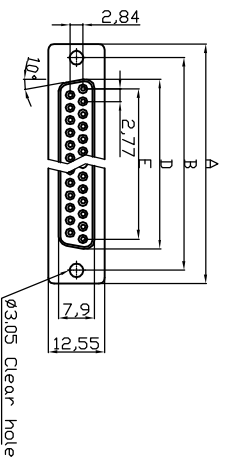

- NOTES:**
- MATERIAL**
1. Insulator Material: Glass-filled thermoplastic PBT, UL 94V-0, Gray
 2. Contact Material: Copper alloy
 3. Shell: Steel, 100 μ" Tin Over 50μ" min Copper
 4. Clinch Nut: Brass, Nickel Plated
 5. Contact plating: Gold flash full gold
- ELECTRICAL**
1. Current Rating : 3AMP
 2. Voltage Rating : 250V AC/rms 60Hz
 3. Contact Resistance: 20mΩ Max at 1 AMP DC
 4. Insulation Resistance: 1000MΩ at 500 VDC
 5. Withstand Voltage: 1000V AC/rms 60Hz for 1 minute
 6. OPERATING TEMPERATURE: -20°C+105°C

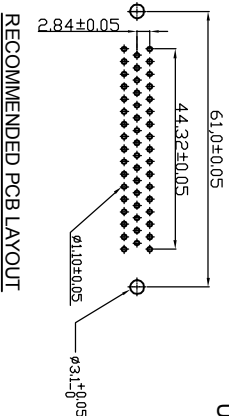
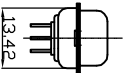
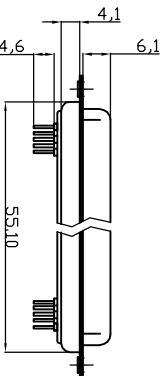
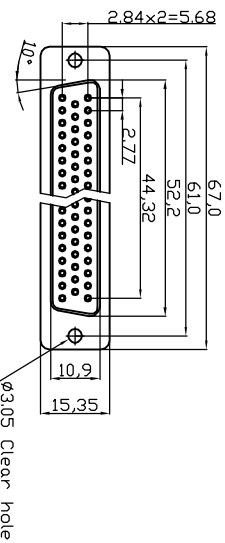

Dimensions

Positions	A±0.15	B±0.10	D±0.13	E±0.08	F±0.10
09	30.81	24.99	16.33	11.08	19.20
15	39.20	33.30	24.70	19.39	27.70
25	53.05	47.04	38.40	33.24	41.10
37	69.40	63.50	54.80	49.86	57.30

50 POSITIONS

RoHS compliant

Unit: mm

Scale	Free	⑤ Add the contact plating 15u" Au	01.09.2017	Winnie
TOLERANCE		④ Add the clinch nut & plating	23.12.2016	Winnie
X.	±0.38	③ Update the dimension.	27.02.2016	Winnie
X.X	±0.25	② Update the operating temperature & UL No	04.08.2014	Winnie
X.XX	±0.13	① Update	24.10.2012	Winnie
DIM	TOL	①		
X.°	±3°	① Drawn	15.08.2012	Lucas
X.X°	±1.0°	①		
Angle	TOL	Id:	Date	Name
		Modification		

Customer-No.

ASSMANN WSW-No.

A-DX XX PP/Z-X

Drawing-No.

ASS 4885 CO

rev05

Replace

Sheet 2/2

1

2

3

4

5

6

7

H

G

F

E

D

C

B

A