

Coaxial Low Pass Filters

DC to 6700 MHz

NEW!
VLF-SERIES



CASE STYLE: FF704

Maximum Ratings

Operating Temperature	-55°C to 100°C
Storage Temperature	-55°C to 100°C
DC Current Input to Output	0.5A max. at 25°C

Features

- low cost
- small size
- 7 sections
- temperature stable

Applications

- harmonic rejection
- transmitters/receivers
- lab use

Outline Drawing

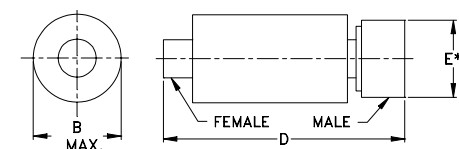

B—OVERALL BODY DIMENSION
* ACROSS FLATS

Outline Dimensions (inch/mm)

B	D	E	wt.
.461	1.42	.312	grams
11.71	36.07	7.92	10

Low Pass Filter Electrical Specifications (T_{AMB}=25°C)

MODEL NO.	PASSBAND (MHz) (loss < 1 dB) Max.	f _{co} , MHz Nom. (loss 3 dB) Typ.	STOP BAND (MHz) (loss, dB)			VSWR (:1)		POWER INPUT (W) Max. at 25°C	NO. OF SECTIONS	PRICE \$ Qty. (1-9)
			f 20 Min.	40 Typ.	fr 20 Typ.	Stopband Typ.	Passband Typ.			
NEW! VLF-225	DC-225	350	440	510-2500	5500	20	1.2	8.5*	7	20.95
NEW! VLF-320	DC-320	460	550	640-2500	5300	20	1.2	8.5*	7	20.95
NEW! VLF-400	DC-400	560	650	680-3000	5500	20	1.2	8.5*	7	20.95
NEW! VLF-490	DC-490	650	780	880-2500	6000	20	1.2	8.5*	7	20.95
NEW! VLF-530	DC-530	700	820	945-3000	6000	20	1.2	8.5*	7	20.95
NEW! VLF-575	DC-575	770	900	1050-3200	5500	20	1.2	8.5*	7	20.95
NEW! VLF-630	DC-630	830	970	1020-3500	6000	20	1.2	8.5*	7	20.95
			STOP BAND (MHz) (loss, dB)							
			f 20 Min.	30 Typ.	fr 20 Typ.					
VLF-800	DC-800	1060	1225	1500-4000	5100	20	1.2	10*	7	19.95
VLF-1000	DC-1000	1300	1550	1900-5000	5500	20	1.3	10*	7	19.95
VLF-1200	DC-1200	1530	1800	2000-5000	6200	20	1.2	10*	7	19.95
VLF-1700	DC-1700	2050	2375	2500-6500	7000	20	1.2	10*	7	19.95
VLF-2250	DC-2250	2575	2850	2950-5000	7200	20	1.2	10*	7	19.95
VLF-5000	DC-5000	5580	6600	6800-11000	18000	20	1.2	9**	7	19.95
VLF-6000	DC-6000	6800	8300	8500-12000	18000	20	1.3	9**	7	19.95
VLF-6700	DC-6700	7600	8900	9500-12000	18000	20	1.3	9**	7	19.95

* Passband rating, derate linearly to 3.5W at 100°C ambient

** Passband rating, derate linearly to 3W at 100°C ambient

typical frequency response

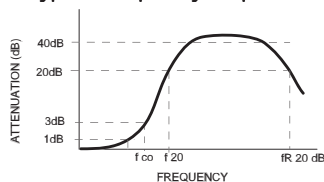

schematic

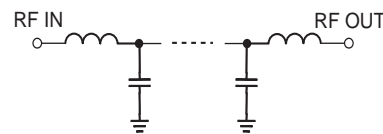

Typical Performance Charts

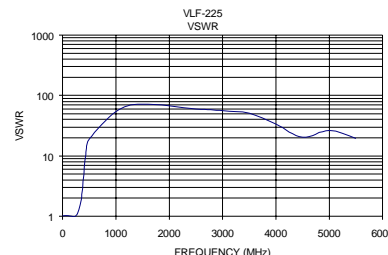
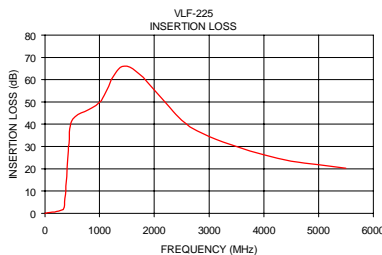

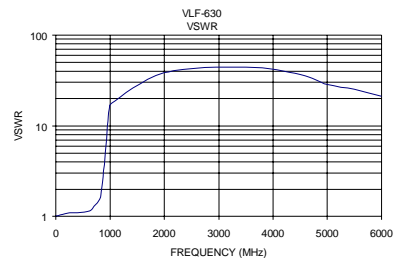
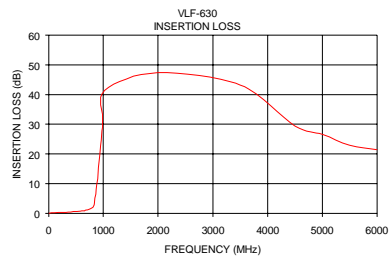
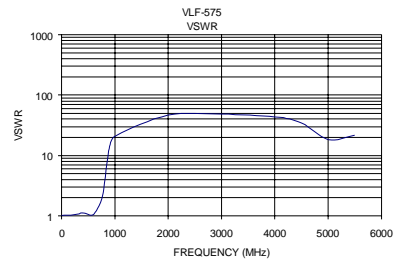
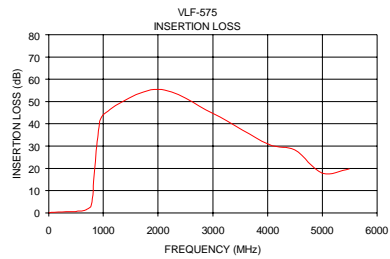
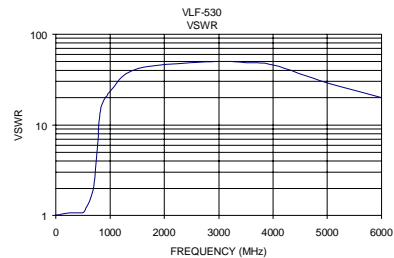
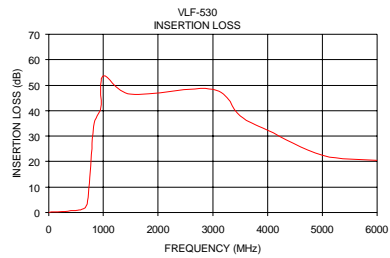
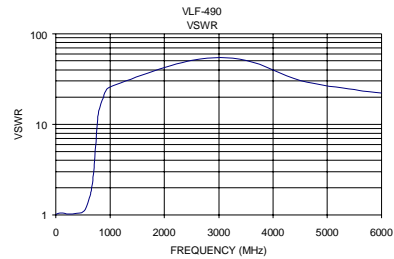
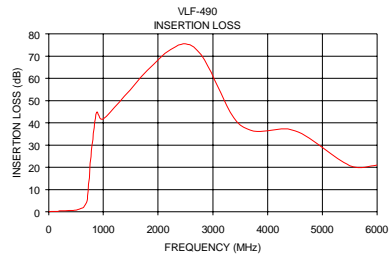
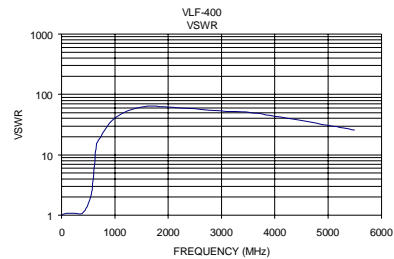
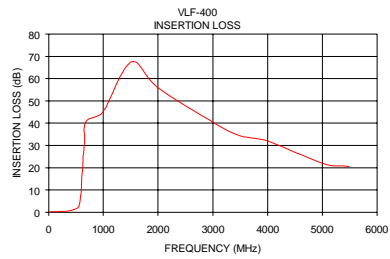
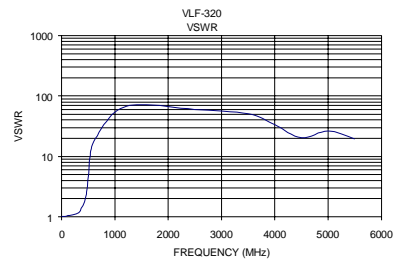
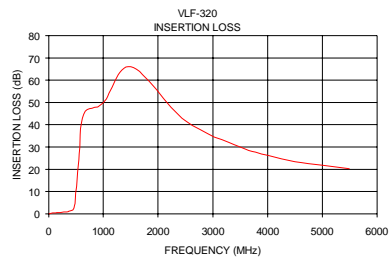

VLF-SERIES

