

# Sta-Kon® Terminals



RD, RE, RF stock thickness: .04  
RG stock thickness: .05\*

## Nylon Insulated Ring

| Cat. No. | Pkg. Qty. | Wire Range | Max. Ins. | Bolt Hole | Wt./Lbs. Per 1000 | Dimensions |     |     |      |
|----------|-----------|------------|-----------|-----------|-------------------|------------|-----|-----|------|
|          |           |            |           |           |                   | A          | B   | C   | M    |
| RD167    | 200       | 8          | .340      | #8        | 12                | 1.48       | .42 | .28 | 1.29 |
| RD8-10   | 25        | 8          | .340      | #10       | 12                | 1.48       | .42 | .28 | 1.29 |
| RD367    | 200       | 8          | .340      | #10       | 12                | 1.48       | .42 | .28 | 1.29 |
| RD8-14   | 25        | 8          | .340      | 1/4"      | 12                | 1.54       | .46 | .36 | 1.32 |
| RD717    | 200       | 8          | .340      | 1/4"      | 12                | 1.54       | .46 | .36 | 1.32 |
| RD8-516  | 25        | 8          | .340      | 5/16"     | 12                | 1.63       | .57 | .36 | 1.35 |
| RD727    | 200       | 8          | .340      | 5/16"     | 12                | 1.63       | .57 | .36 | 1.35 |
| RD8-38   | 25        | 8          | .340      | 3/8"      | 12                | 1.63       | .57 | .36 | 1.35 |
| RD737    | 200       | 8          | .340      | 3/8"      | 12                | 1.63       | .57 | .36 | 1.35 |
| RD8-12   | 25        | 8          | .310      | 1/2"      | 12                | 1.79       | .82 | .55 | 1.39 |
| RD757*   | 200       | 8          | .310      | 1/2"      | 12                | 1.79       | .82 | .55 | 1.39 |
| RD10161  | 200       | 8AN        | .270      | #8        | 12                | 1.40       | .41 | .24 | 1.20 |
| RD10361  | 200       | 8AN        | .270      | #10       | 12                | 1.40       | .41 | .24 | 1.20 |
| RD10711  | 200       | 8AN        | .270      | 1/4"      | 12                | 1.45       | .45 | .34 | 1.22 |
| RD10721  | 200       | 8AN        | .270      | 5/16"     | 12                | 1.53       | .56 | .34 | 1.25 |
| RD10731  | 200       | 8AN        | .270      | 3/8"      | 12                | 1.53       | .56 | .34 | 1.25 |
| RE6-10   | 20        | 6          | .420      | #10       | 16                | 1.65       | .49 | .28 | 1.40 |
| RE267    | 200       | 6          | .420      | #10       | 16                | 1.65       | .49 | .28 | 1.40 |
| RE6-14   | 20        | 6          | .420      | 1/4"      | 16                | 1.65       | .49 | .28 | 1.40 |
| RE717    | 200       | 6          | .420      | 1/4"      | 16                | 1.65       | .49 | .28 | 1.40 |
| RE6-516  | 20        | 6          | .420      | 5/16"     | 16                | 1.76       | .61 | .34 | 1.47 |
| RE727    | 200       | 6          | .420      | 5/16"     | 16                | 1.76       | .61 | .34 | 1.47 |
| RE6-38   | 20        | 6          | .420      | 3/8"      | 16                | 1.76       | .61 | .34 | 1.47 |
| RE737    | 200       | 6          | .420      | 3/8"      | 16                | 1.76       | .61 | .34 | 1.47 |
| RE6-12   | 20        | 6          | .395      | 1/2"      | 16                | 1.83       | .82 | .55 | 1.43 |
| RE757*   | 200       | 6          | .395      | 1/2"      | 16                | 1.83       | .82 | .55 | 1.43 |
| RE10261  | 200       | 6AN        | .315      | #10       | 16                | 1.55       | .49 | .24 | 1.31 |
| RE10711  | 200       | 6AN        | .315      | 1/4"      | 16                | 1.55       | .49 | .27 | 1.31 |
| RE10721  | 200       | 6AN        | .315      | 5/16"     | 16                | 1.70       | .60 | .34 | 1.40 |
| RE10731  | 200       | 6AN        | .315      | 3/8"      | 16                | 1.70       | .60 | .34 | 1.40 |
| RF4-10   | 15        | 4          | .510      | #10       | 21                | 1.76       | .56 | .36 | 1.49 |
| RF267    | 200       | 4          | .510      | #10       | 21                | 1.76       | .56 | .36 | 1.49 |
| RF4-14   | 15        | 4          | .510      | 1/4"      | 21                | 1.76       | .56 | .36 | 1.49 |
| RF717    | 200       | 4          | .510      | 1/4"      | 21                | 1.76       | .56 | .36 | 1.49 |
| RF4-516  | 15        | 4          | .510      | 5/16"     | 21                | 1.84       | .62 | .35 | 1.53 |
| RF727    | 200       | 4          | .510      | 5/16"     | 21                | 1.84       | .62 | .35 | 1.53 |
| RF4-38   | 15        | 4          | .510      | 3/8"      | 23                | 1.84       | .62 | .35 | 1.53 |
| RF737    | 200       | 4          | .510      | 3/8"      | 23                | 1.84       | .62 | .35 | 1.53 |
| RF757*   | 200       | 4          | .500      | 1/2"      | 23                | 1.90       | .82 | .55 | 1.49 |
| RF10261  | 200       | 4AN        | .380      | #10       | 26                | 1.78       | .55 | .30 | 1.51 |
| RF10711  | 200       | 4AN        | .380      | 1/4"      | 26                | 1.78       | .55 | .30 | 1.51 |
| RF10721  | 200       | 4AN        | .380      | 5/16"     | 26                | 1.80       | .62 | .34 | 1.49 |
| RF10731  | 200       | 4AN        | .380      | 3/8"      | 26                | 1.80       | .62 | .34 | 1.49 |
| RG2-10   | 10        | 2          | .588      | #10       | 42                | 2.15       | .69 | .40 | 1.83 |
| RG267    | 100       | 2          | .588      | #10       | 42                | 2.15       | .69 | .40 | 1.83 |
| RG2-14   | 10        | 2          | .588      | 1/4"      | 42                | 2.15       | .69 | .40 | 1.83 |
| RG717    | 100       | 2          | .588      | 1/4"      | 42                | 2.15       | .69 | .40 | 1.83 |
| RG2-516  | 10        | 2          | .588      | 5/16"     | 42                | 2.15       | .69 | .40 | 1.83 |
| RG727    | 100       | 2          | .588      | 5/16"     | 42                | 2.15       | .69 | .40 | 1.83 |
| RG2-38   | 10        | 2          | .588      | 3/8"      | 42                | 2.15       | .69 | .40 | 1.83 |
| RG737    | 100       | 2          | .588      | 3/8"      | 42                | 2.15       | .69 | .40 | 1.83 |
| RG2-12   | 10        | 2          | .588      | 1/2"      | 42                | 2.35       | .80 | .49 | 1.93 |
| RG757    | 100       | 2          | .588      | 1/2"      | 42                | 2.35       | .80 | .49 | 1.93 |
| RG9711   | 100       | 1AN        | .453      | 1/4"      | 48                | 2.07       | .69 | .40 | 1.74 |
| RG9731   | 100       | 1AN        | .453      | 3/8"      | 48                | 2.07       | .69 | .40 | 1.74 |
| RG9751   | 100       | 1AN        | .453      | 1/2"      | 48                | 2.26       | .80 | .49 | 1.84 |

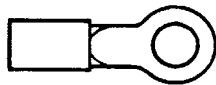

\*Braze Seam, Lolly-Pop Style Tongue.

AN – Aircraft Wire. U.L. Listed E9809. Installing tools: TBM6/TBM6S, ERG-2007, (RD & RE Except Braze Seam)

Note: Not available on Mylar Tape.

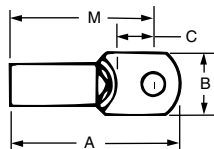

**Thomas & Betts**