

All material is aluminum alloy with a black, anodized finish unless otherwise noted.

**Slimmest, Plug-In for TO-220**

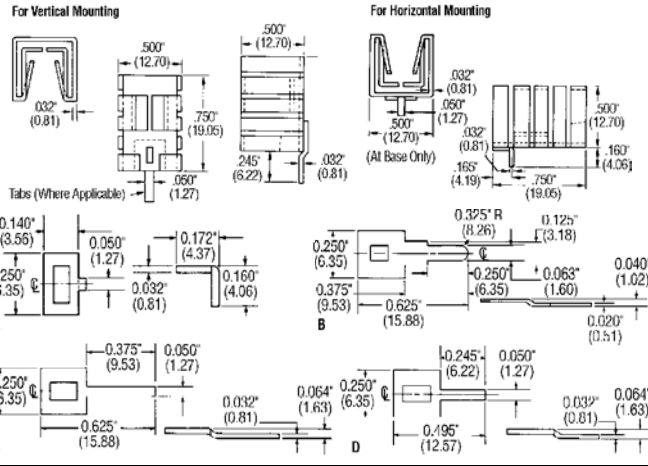

Stock No.	Mfr.'s Type	Tabs	EACH			
			1-99	100-499	500-999	1000-Up
619-0360	576802B00000	None	.74	.49	.37	.30
619-0361	576802B03100	Fig. A	1.07	.71	.54	.43
619-0362	576802B03700	Fig. B	1.13	.75	.57	.45
619-0363	576802B03900	Fig. C	.95	.63	.47	.38
619-0364	576802B04000	Fig. D	1.03	.68	.51	.41

**Vertical Mount for TO-220**

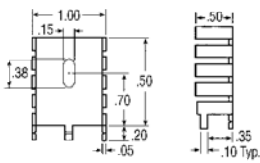

Stock No.	Mfr.'s Type	Tabs	EACH			
			1-99	100-499	500-999	1000-Up
619-0160	563002B00000		.81	.51	.38	.30
619-0161	563002D00000		.97	.77	.70	.60

**Heavy Duty, Extruded for TO-218 and TO-220**

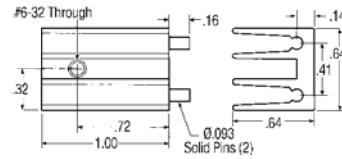

Stock No.	Mfr.'s Type	Tabs	EACH			
			1-99	100-499	500-999	1000-Up
619-6072	581002B02500		2.67	1.79	1.34	1.07

**Trim, Low-Profile for TO-202**

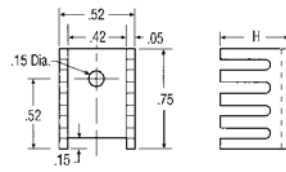

Stock No.	Mfr.'s Type	Dim. (In.)	EACH			
			H	1-99	100-499	500-999
619-6036	577304B00000	0.375	.55	.37	.28	.22
619-6038	577404B00000	0.500	.56	.37	.28	.22

**Economy, Low Profile for TO-126 and TO-127**

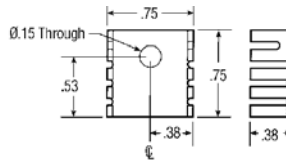

Stock No.	Mfr.'s Type	Dim. (In.)	EACH			
			H	1-99	100-499	500-999
619-0230	507302B00000		.42	.28	.21	.17

**Extrusion with Solderable Pins for TO-218 and TO-220**

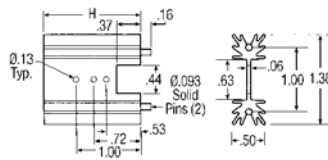

Stock No.	Mfr.'s Type	Dim. (In.)	EACH				
			H	1-24	25-99	100-499	500-Up
619-0376	531002B02500*	1.00	.96	.89	.82	.76	
619-0377	531102B02500*	1.50	1.02	.95	.87	.80	
619-0370	531002C02500†	1.00	1.66	1.42	1.02	.84	
619-0375	531102C02500†	1.50	1.80	1.54	1.11	.91	

\*Black Anodized. †Gold Chromate Finish.

**Soldered or Twisted Tabs for Vertical Mounting for TO-220**

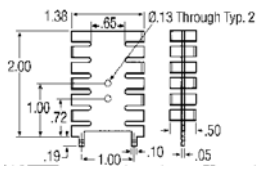

Stock No.	Mfr.'s Type	Tabs	EACH			
			1-24	25-99	100-499	500-Up
619-0130	563202B00000		.58	.51	.44	.37

**Small, Wave-Solderable for TO-220**

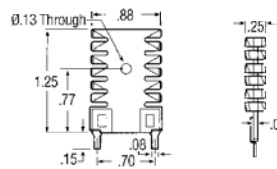

Stock No.	Mfr.'s Type	Tabs	EACH			
			1-99	100-499	500-999	1000-Up
619-6062	592502B03400		1.28	.85	.64	.51

**Wave-Solderable, Twisted Fin for TO-220**

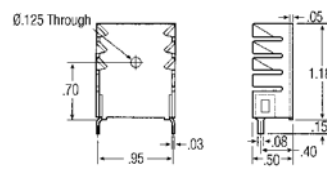

Stock No.	Mfr.'s Type	Tabs	EACH			
			1-99	100-499	500-999	1000-Up
619-6064	593002B03400		.75	.66	.56	.48