

THIS IS A C.A.D. GENERATED DRAWING
DO NOT MAKE MANUAL REVISIONS TO MASTER.

TOLERANCE UNLESS OTHERWISE SPECIFIED IN MM:	ANGLE	3°
0	± 0.50	
0.0	± 0.38	
0.00	± 0.25	
0.000	± 0.10	

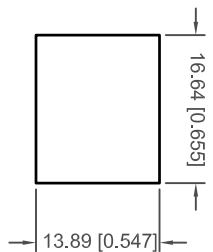

RECOMMENDED
PANEL CUTOUT DIMENSION

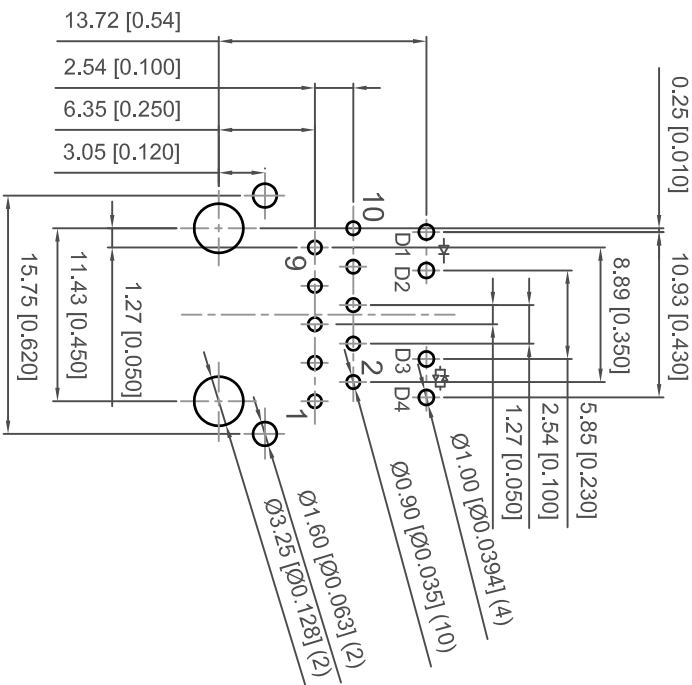
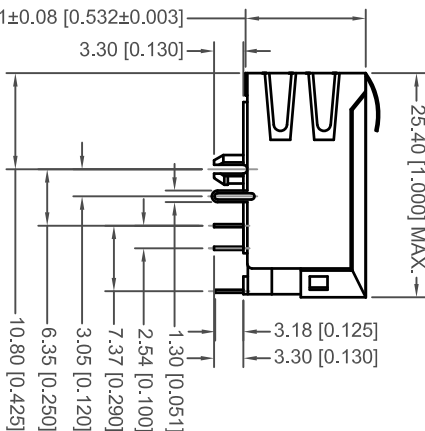
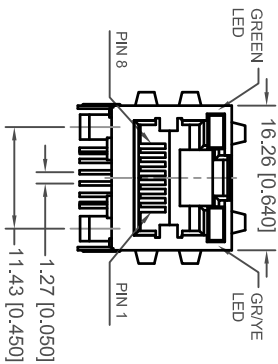
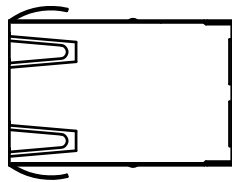

RECOMMENDED P.C.B. LAYOUT
TOLERANCE: ±0.05[±0.002]

NOTES:
1. MATERIALS:
HOUSING: NYLON POLYESTER WITH GLASS FIBER, UL94 V-0, COLOR: BLACK
CONTACTS: 0.35MM PHOSPHOR BRONZE PLATED WITH GOLD PLATING AND TIN IN SOLDER AREA

PART NO	GOLD PLATING THICKNESS
A60-112-235N414	GOLD FLASH PLATING
A60-113-235N414	15 MICRO INCHES OF GOLD
A60-114-235N414	30 MICRO INCHES OF GOLD

- SHIELD: 0.25MM COPPER ALLOY WITH NICKEL PLATING
2. OPERATING TEMPERATURE: 0°C TO +70°C
3. MATE WITH MODULAR PLUG CONFORMING TO FCC PART 68, SUBPART F.
4. DIMENSION: MM [INCHES]



THIS SERIES FULLY CONFORMS TO THE
EUROPEAN UNION DIRECTIVES 2002/95/EC
AND 2002/96/EC FOR RoHS COMPLIANCY.

**RJ45 MAGNETIC JACK WITH LED, 10P, 8C
SHIELDED, 10/100/1000 Mbps FILTER**

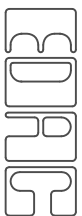

EDAC INC
TORONTO, ONTARIO
CANADA

YOUR CONNECTION TO QUALITY & SERVICE

THESE DRAWINGS AND SPECIFICATIONS
ARE THE PROPERTY OF EDAC INC. AND
SHALL NOT BE REPRODUCED OR COPIED
OR USED AS THE BASIS FOR THE
MANUFACTURE OR SALE OF APPARATUS
WITHOUT WRITTEN PERMISSION.

ACAD REFERENCE NO.: A60-113-235N414

DRAWN: R.STA.MONICA DATE: NOV.19/2010

CHECKED: DATE:

PART NUMBER

SEE NOTE

SHEET 1 OF 2

DRAWING NUMBER

A60-112-235N414

ISSUE

1

ELECTRICAL CIRCUIT:

CONNECTOR SOLDER SIDE

RJ45 CONTACT SIDE

TOLERANCE UNLESS OTHERWISE SPECIFIED IN MM:	ANGLE	3°
0	± 0.50	
0.0	± 0.38	
0.00	± 0.25	
0.000	± 0.10	

THIS IS A C.A.D. GENERATED DRAWING
DO NOT MAKE MANUAL REVISIONS TO MASTER.

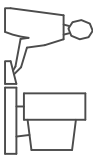

ISSUE NUMBER
ORIGINAL

1

TEST NOTES:(25±5°C)

1. TR:(100KHz,0.1V); 100%
PINS:(P1,P2):(J1,J2)=1:1±3%:(P3,P4):(J3,J6)=1:1±3%
PINS:(P7,P8):(J4,J5)=1:1±3%:(P9,P10):(J7,J8)=1:1±3%
2. LX:(100KHz,100mV,8mA, DC Bias) 100%
PINS:(P1,P2):(P3,P4),(P7,P8),(P9,P10)=350uH MINIMUM
3. DCR: 100%
PINS:(P1,P2),(P3,P4),(P7,P8),(P9,P10)= 1.0 MAXIMUM
PINS:(J1,J2),(J3,J6),(J4,J5),(J7,J8)=1.0 MAXIMUM
4. HIPOT: 100%
PINS:(P1,P2)TO(J1,J2),(P3,P4)TO(J3,J6)=1500VAC FOR 2 SECONDS
PINS:(P7,P8)TO(J4,J5),(P9,P10)TO(J7,J8)=1500VAC FOR 2 SECONDS
5. INSERTION LOSS:
-1dB MAXIMUM AT 1MHZ TO 100MHZ;
6. RETURN LOSS:
-20dB MINIMUM AT 1MHZ TO30MHZ;
-15dB MINIMUM AT 30MHZ TO 60MHZ
-10dB MINIMUM AT 60MHZ TO 80MHZ
7. CROSS TALK:
-30dB MINIMUM AT 1MHZ TO 100MHZ
8. COMMON TO COMMON MODE REJECTION:
-30dB MINIMUM AT 1MHZ TO 100MHZ

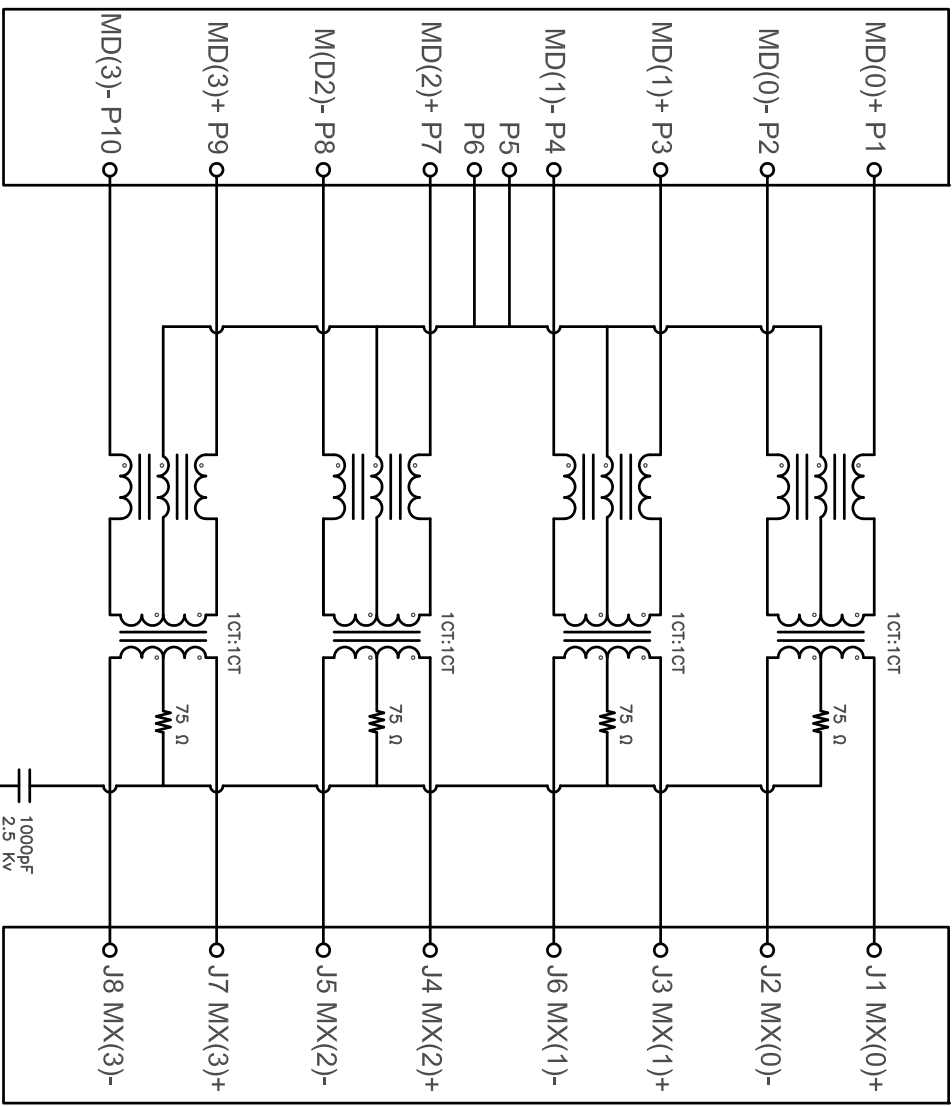

LED CIRCUIT:

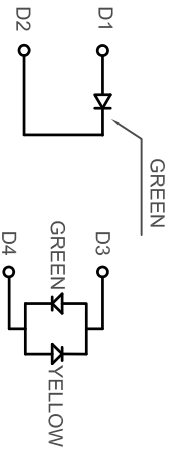

**RJ45 MAGNETIC JACK WITH LED, 10P, 8C
SHIELDED, 10/100/1000 Mbps FILTER**

Color	Lens Color	Vf(v) @20mA		Iv(mcd) @10mA		Viewing angle
		Min	Max	Min	Typ	
Yellow	Yellow Diffused	1.7	2.8	3.0	6.0	116
Green	Green Diffused	1.7	2.8	3.5	6.0	116

ACAD REFERENCE NO.: A60-113-235N414

DRAWN: R.STA.MONICA DATE: NOV.19/2010

CHECKED: DATE:

PART NUMBER

SEE NOTE

DRAWING NUMBER

A60-112-235N414

SHEET 2 OF 2

ISSUE

1



THIS SERIES FULLY CONFORMS TO THE
EUROPEAN UNION DIRECTIVES 2002/95/EC
AND 2002/96/EC FOR ROHS COMPLIANCY.

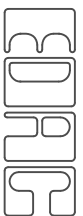

EDAC INC
TORONTO, ONTARIO
CANADA
YOUR CONNECTION TO QUALITY & SERVICE

THESE DRAWINGS AND SPECIFICATIONS
ARE THE PROPERTY OF EDAC INC. AND
SHALL NOT BE REPRODUCED OR COPIED
OR USED AS THE BASIS FOR THE
MANUFACTURE OR SALE OF APPARATUS
WITHOUT WRITTEN PERMISSION.