

4S1 & 4SS-Series

Sub-Miniature & **Sealed** Sub-Miniature Slide Switches

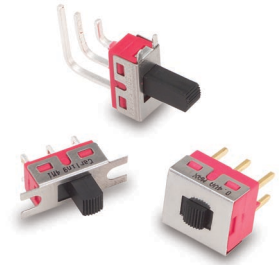

4M1-Series

Miniature Slide Switch

Specifications

Contact Rating refer to ordering scheme
 Electrical Life 30,000 make & break cycles at full load
 Contact Resistance. 10 mΩ max. initial @ 2-4 VDC
 100mA for both silver & gold plated contacts.
 Insulation Resistance 1000 MΩ min.
 Dielectric Strength 1500 Volts RMS @ sea level
 Operating Temperature . . . -30°C to +85°C
 Solder Heat Resistance. . . MIL-STD-202, Method 210
 Actuator Travel 25°

Materials

Case Diallyl phthalate (DAP) (UL 94V-0)
 Slide Handle. Nylon
 Housing. Stainless Steel
 Terminal Seal Epoxy

4S1-Series Ordering Scheme



1 SERIES 4S1 Sub-Miniature Slide Switch			
2 POLES FSP single pole			
3 CIRCUIT			
Switching Position:			
1	2-1	OPEN	2-3
3	ON	NONE	ON
	ON	OFF	ON
4 TERMINATION			
M2 PCB			
M6 PC Mount, 90° horizontal			

5 CONTACT		
	<i>Material</i>	<i>Terminal Plating</i>
G	silver ¹	gold over silver ³
K	gold ²	tin-lead ⁴
P	silver ¹	tin-lead ⁴
Q	silver ¹	silver ¹
R	gold ²	gold ²
Rating		
	3A @ 125VAC or 28VDC; 1.5A @ 250VAC	
	0.4VA max. @ 20V max (AC/DC)	
	3A @ 125VAC or 28VDC; 1.5A @ 250VAC	
	3A @ 125VAC or 28VDC; 1.5A @ 250VAC	
	0.4VA max. @ 20V max (AC/DC)	
NOTE:		
Tin-lead option available with PC type terminations only.		
1	Moveable contact & terminals: copper alloy, silver plate	
2	Moveable contact & terminals: copper alloy with gold plate over nickel plate	
3	Terminals: silver plate with outer layer in gold plating	

6 EPOXY SEAL	
E	epoxy seal

7 PACKAGING	
Switches are bulk packed, unless T/R is specified at the end of the part number.	
T/R tape reel - 500 pieces per reel	

4SS-Series Ordering Scheme



1 SERIES 4SS Sealed Sub-Miniature Slide Switch			
2 POLES FSP single pole			
3 CIRCUIT			
Switching Position:			
	2-1	OPEN	2-3
1	ON	NONE	ON
3	ON	OFF	ON
4 TERMINATION			
Termination options for switches with brick color actuators			
M2 PCB			
M6 PC Mount, 90° horizontal			
M7 PC Mount, 90° vertical			
Termination options for switches with white color actuators			
L6 Surface Mount, 90° flat			
S6 Surface Mount, 90° horizontal			
S7 Surface Mount, 90° vertical			

5 CONTACT			
	Material	Terminal Plating	Rating
G	silver ¹	gold over silver	3A@125VAC or 28VDC; 1.5A @ 250VAC
K	gold ²	tin-lead ⁴	0.4VA max. @20V max (AC/DC)
P	silver ¹	tin-lead	3A@125VAC or 28VDC; 1.5A @ 250VAC
R	gold ²	gold ²	0.4VA max. @20V max (AC/DC)
NOTE:			
Tin-lead option available with PC type terminations only.			
1 Moveable contact & terminals: copper alloy, silver plate			
2 Moveable contact & terminals: copper alloy with gold plate over nickel plate			
3 Terminals: silver plate with outer layer in gold plating			
4 Outer terminals: copper alloy with tin-lead over nickel plate			

6 EPOXY SEAL	
E	epoxy seal

7 PACKAGING	
Switches are bulk packed, unless T/R is specified at the end of the part number.	
T/R tape reel - 500 pieces per reel	

4M1-Series Ordering Scheme

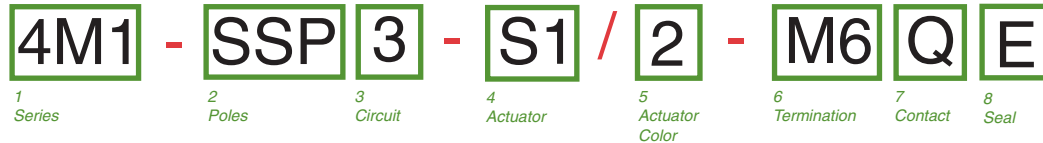

1 SERIES 4M1 Miniature Slide Switch			
2 POLES SSP single pole SDP double pole			
3 CIRCUIT			
Switching Position			
	2-1, 5-4	OPEN	2-3, 5-6
1	ON	NONE	ON
3	ON	OFF	ON
4 ACTUATOR			
S1	.201 [5.10] high		
S2	.285 [7.25] high		
S3	.370 [9.40] high		
S4	.140 [3.55] high		
S5	.053 [1.35] high (for DPDT only)		
S6	.482 [12.25] high		
S7	.311 [7.90] high		
T1	.201 [5.10] high (for DPDT only)		
5 ACTUATOR COLOR¹			
1 white	3 red	5 yellow	7 blue
2 black	4 orange	6 green	8 brown
9 gray			
1 White, black & red are standard. Other colors available for quantities of 5K or more.			

6 TERMINATION		M5-3 Wire Wrap [10.80]
M1 Solder Lug		M5-4 Wire Wrap [26.97]
M2 PCB		M6 PC Mount, 90° horizontal
M3 Quick Connect		M7 PC Mount, 90° vertical
M5-1 Wire Wrap .750 [19.05]		VS2 PC Mount, U bracket, .620 mounting x .460 high
M5-2 Wire Wrap [24.48]		

7 CONTACT				
	Material	Terminal Plating	Rating	Approvals
G	silver ¹	gold over silver ²	5A@125VAC or 28VDC; 2A @ 250VAC	UL, CSA
K	gold ²	tin-lead ⁴	0.4VA max. @20V max (AC/DC)	
P	silver ¹	tin-lead ⁴	5A@125VAC or 28VDC; 2A @ 250VAC	UL, CSA
Q	silver ¹	silver ¹	5A@125VAC or 28VDC; 2A @ 250VAC	UL, CSA
R	gold ²	gold ²	0.4VA max. @20V max (AC/DC)	
NOTE:				
Tin-lead option available with PC type terminations only.				
1 Moveable contact & terminals: copper alloy, silver plate				
2 Moveable contact & terminals: copper alloy with gold plate over nickel plate				
3 Terminals: silver plate with outer layer in gold plating				
4 Outer terminals: copper alloy with tin-lead over nickel plate				

8 EPOXY SEAL	
E	epoxy seal

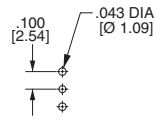
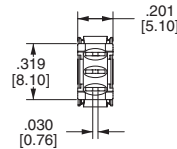
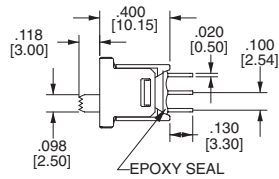
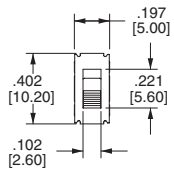
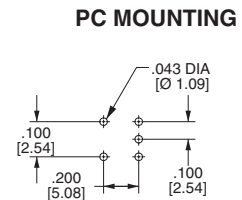
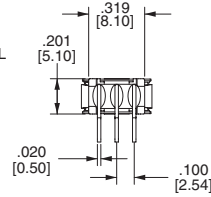
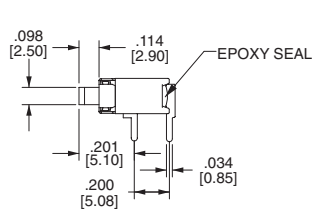
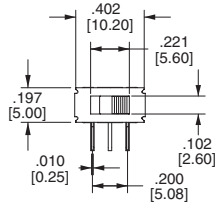
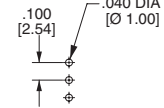
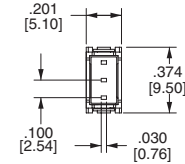
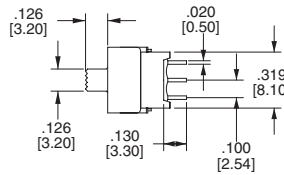
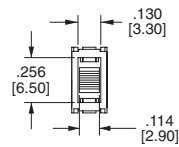
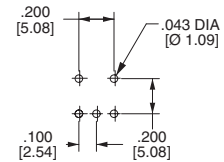
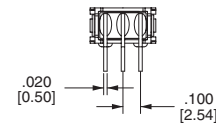
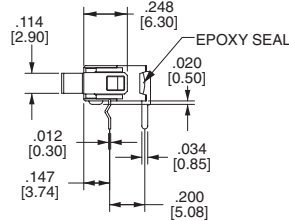
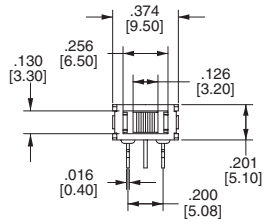
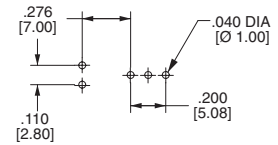
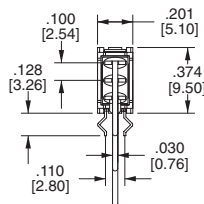
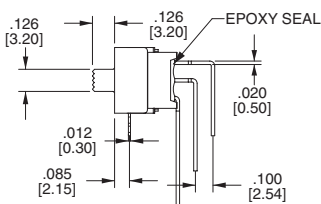
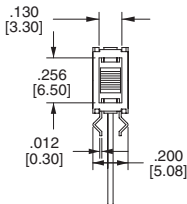
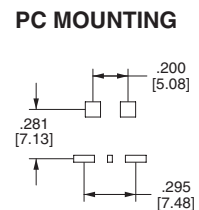
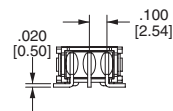
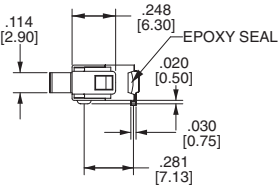
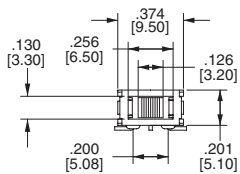
4S-Series Dimensional Specifications: in. [mm]
4S1-Series
TERMINATION
PC MOUNTING
M2

M6

4SS-Series
TERMINATION
PC MOUNTING
M2

M6

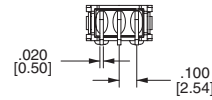
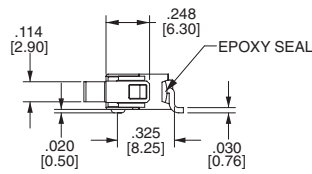
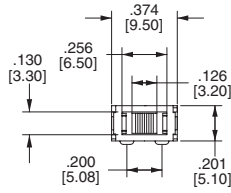
M7

L6

4SS-Series Dimensional Specifications: in. [mm]

TERMINATION

S6



PC MOUNTING

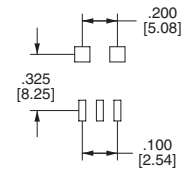

S7

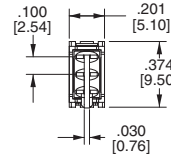
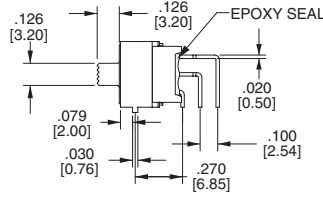
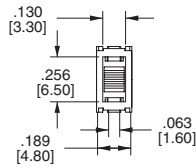

PC MOUNTING

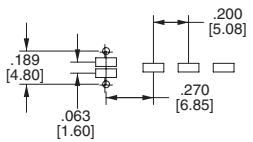

REEL TAPING

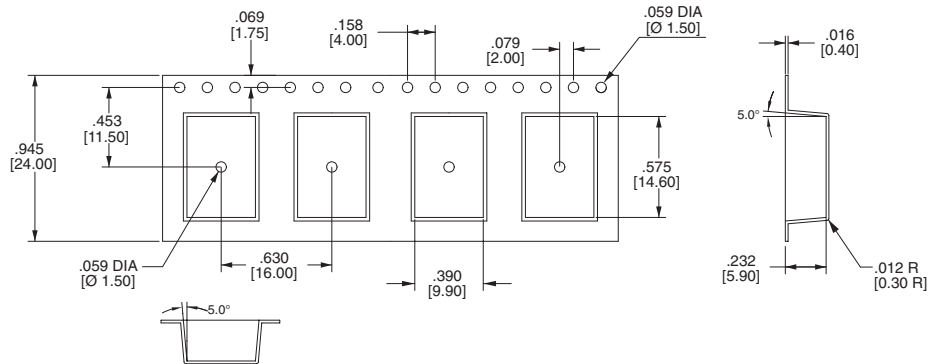

FOR S6, L6 ONLY

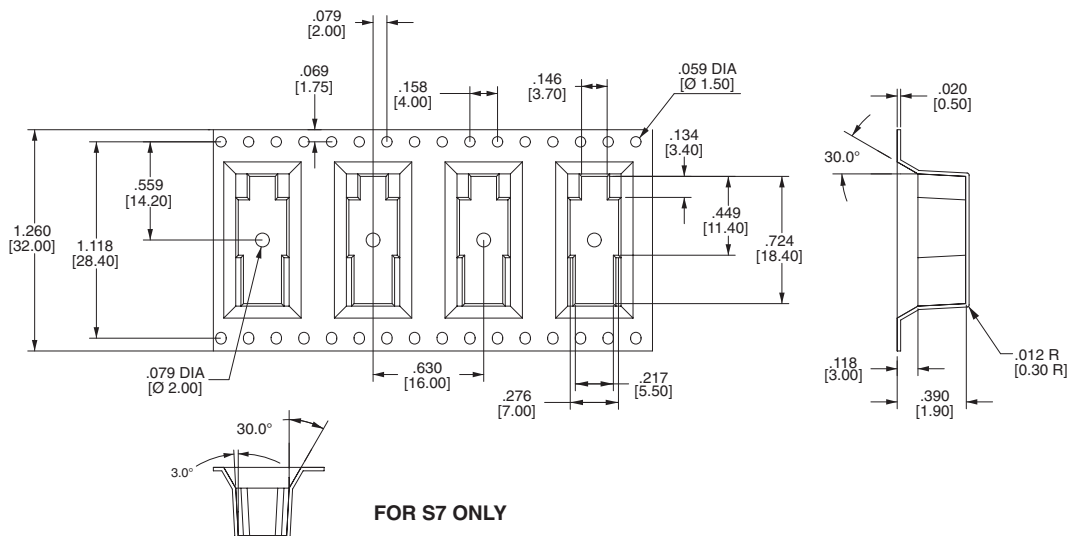

FOR S7 ONLY

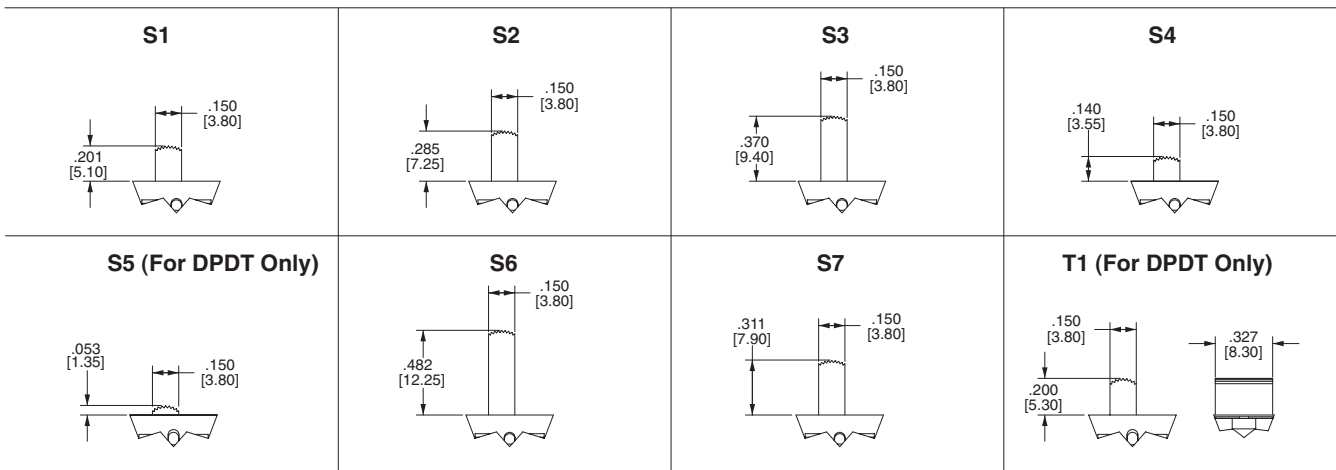
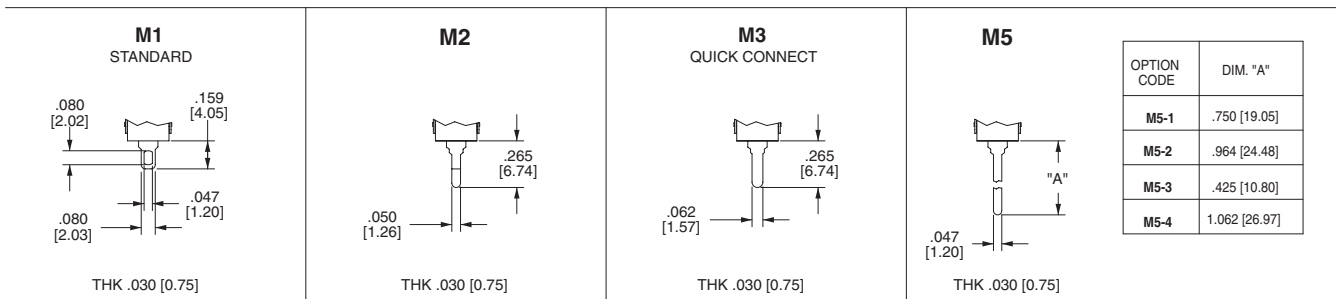
4M1-Series Dimensional Specifications: in. [mm]
ACTUATOR

TERMINATION

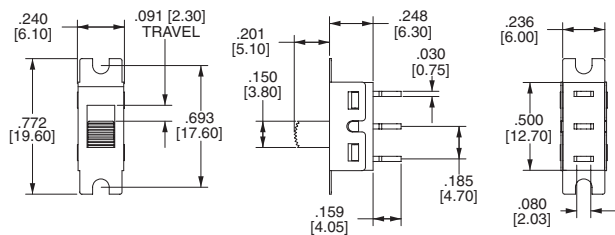
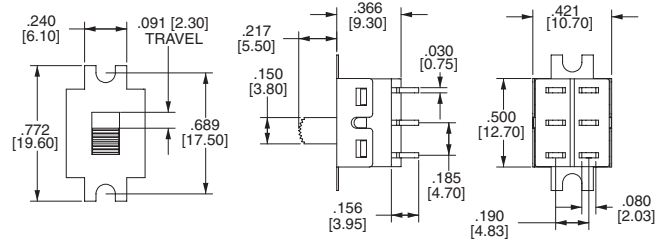
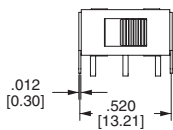
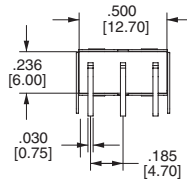
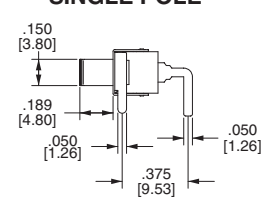
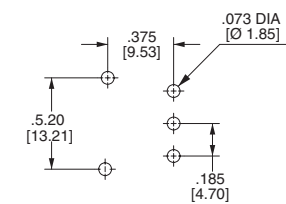
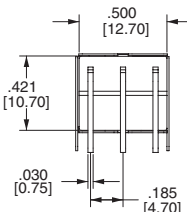
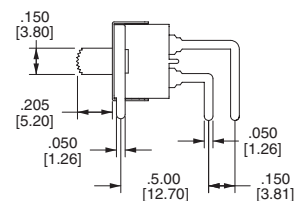
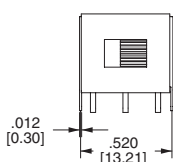
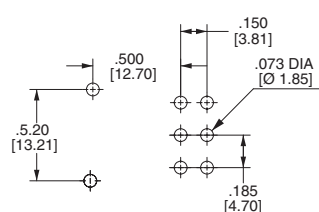
OPTION CODE	DIM. "A"
M5-1	.750 [19.05]
M5-2	.964 [24.48]
M5-3	.425 [10.80]
M5-4	1.062 [26.97]

SINGLE POLE

DOUBLE POLE

M6

SINGLE POLE

PC MOUNTING

DOUBLE POLE

PC MOUNTING

4M1-Series Dimensional Specifications: in. [mm]

TERMINATION

M7

SINGLE POLE

PC MOUNTING

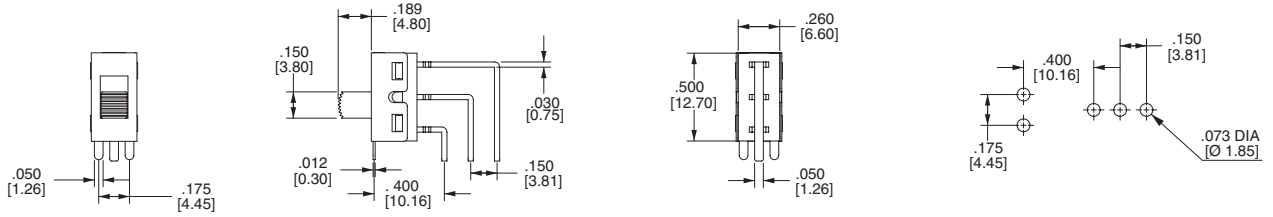

DOUBLE POLE

PC MOUNTING

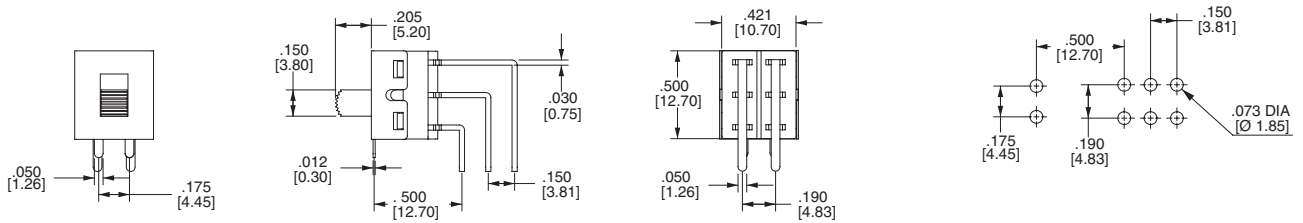

VS2

SINGLE POLE

PC MOUNTING

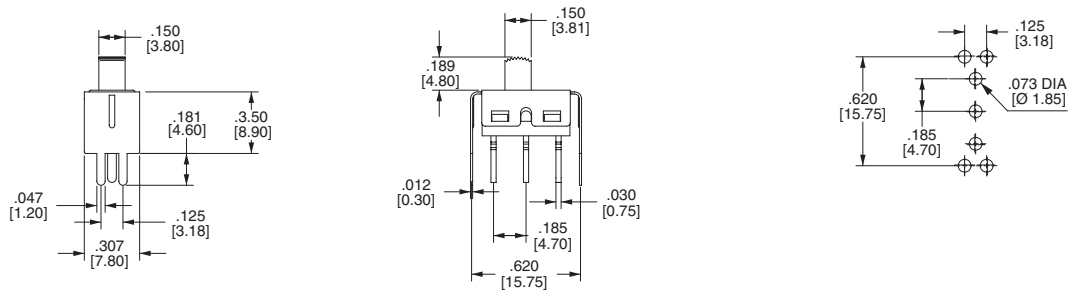

DOUBLE POLE

PC MOUNTING

