

Specification Status: Released

Electrical Rating

Voltage: 14 Vdc MAX
Current: 100 A MAX

Terminal Material:

Brass H65
Thickness: 0.8mm
Tin plating thickness: 5µm

Insulating Material:

Light Blue color PBT Meets
UL94V-0 Requirements

Marking:

XX - Manufacturer's Mark
14VDC - Voltage Rating
BD280-1130-15 - Part ID

□□□□ - Lot Number

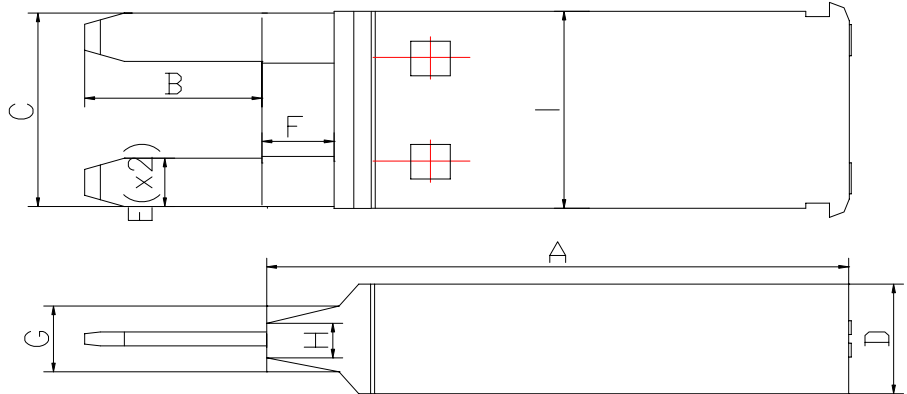

TABLE I. DIMENSIONS:

	A		B		C		D		E(x2)		F	
	MIN	MAX	MIN	MAX	MIN	MAX	MIN	MAX	MIN	MAX	MIN	MAX
mm:	29.5	30.1	8.7	9.3	10.75	11.25	6.05	6.65	2.55	3.05	3.3	3.9
in*:	(1.173)	(1.185)	(0.343)	(0.366)	(0.423)	(0.443)	(0.238)	(0.262)	(0.1)	(0.12)	(0.13)	(0.154)

G		H		I	
MIN	MAX	MIN	MAX	MIN	MAX
3.4	4	1.7	2.3	10.9	11.5
(0.134)	(0.157)	(0.067)	(0.091)	(0.429)	(0.453)

*Rounded off approximation

TABLE II: PERFORMANCE RATINGS:

INITIAL RESISTANCE VALUES		TIME TO TRIP AT 60AMPS	TRIP CURRENT AT Rmin	R1max ONE-HOUR POST-TRIP RESISTANCE	HOLD CURRENT AT R1max	TRIPPED-STATE POWER DISSIPATION
OHMS AT 25°C MIN	OHMS AT 25°C MAX	SECONDS AT 25°C MAX	AMPS AT 25°C MAX	OHMS AT 25°C MAX	AMPS AT 25°C MIN	WATTS AT 20°C, 14V TYP
0.0050	0.0070	8.0	20.0	0.010	12.0	4.5

Reference Documents:

PS300, PS400 & SAE-J2685

Precedence:

This specification takes precedence over documents referenced herein.

Effectivity:

Reference documents shall be the issue in effect on the date of invitation or bid.

CAUTION:

Operation beyond the rated voltage or current may result in rupture, electrical arcing or flame.

Materials Information

ROHS Compliant

ELV Compliant

Pb-Free



SUPERSEDED
NOT the LATEST REVISION