

24

2410 08

USB and IEEE 1394 connectors



USB 2.0 chassis plug type A, angular version, for printed circuit boards

24

2410 08

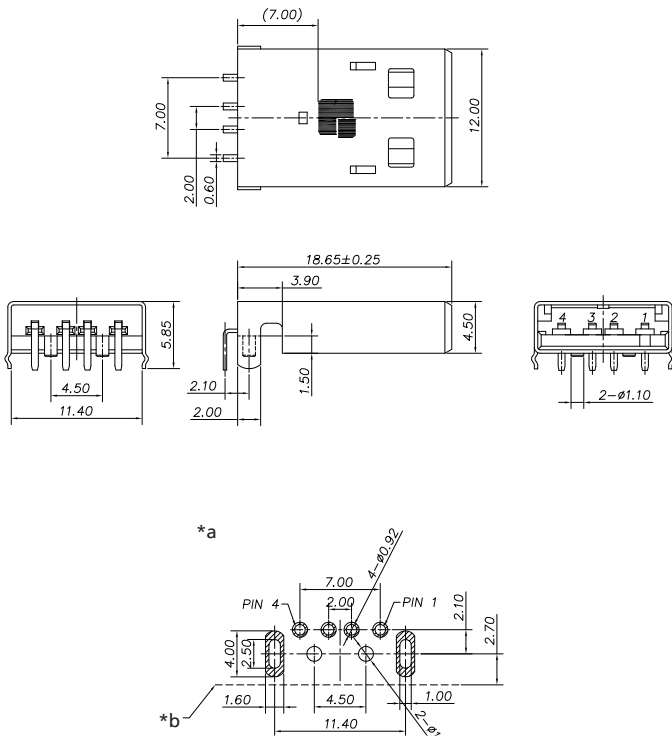

- *a printed circuit board layout, components side view
- *b printed circuit board edge

Environmental conditions

Temperature range -55 °C/+105 °C

Materials

Insulating body PBT GF, V-0 according to UL94
 Contact spring Cu alloy, pre-nickel and gold-plated, tin-plated in solder area
 Housing steel, tin-plated

Mechanical data

Mating cycles 1500
 Insertion force ≤ 35 N
 Withdrawal force ≥ 18,6 N

Electrical data (at T_{amb} 20 °C)

Contact resistance ≤ 30 mΩ
 Rated current 1 A
 Rated voltage 30 V AC
 Rated impulse voltage 500 V/60 s
 Insulation resistance ≥ 500 MΩ

Associated products

Counterparts
 ☞ 2410 01 ☞ 2410 02 ☞ 2410 03
 ☞ 2410 05 ☞ 2410 06 ☞ 2410 09
 ☞ 2420 01 ☞ 2420 02 ☞ 4512

24

2410 08

Designation	Pole Number	PU (Pieces)	MDQ (Pieces)
2410 08	4	100	500

Packaging:
in a tray