

**Product Facts**

- Designed for large cables and leads
- Ideally suited for power generation and distribution
- Accepts a wide range of stranded copper wires (6 AWG to 1000 MCM [13-507 mm<sup>2</sup>]— for terminals and up to 1500 MCM [760 mm<sup>2</sup>] for splices)
- Available in a variety of terminal and splice styles
- High-quality, seamless tubular copper for maximum conductivity
- Listed by Underwriters Laboratories, Inc.  
File No. E12388,  Spec. 486
- Certified by the Canadian Standards Association  
File No. LR7189 

**Technical Documents:****Instruction Sheets**

408-1565  
408-1602  
408-1606  
408-2464  
408-2953

The AMPOWER product line is available in a variety of terminal and splice styles to suit your design requirements.

AMPOWER terminals and splices are ideally suited for power generation and dis-

tribution. This makes electrical equipment subject to continuous operation, such as generators, motors and welders, a perfect application for AMPOWER products. In addition, other applications include interconnections of power sup-

plies to computers and peripheral equipment.

©2001 by Tyco Electronics Corporation.  
All rights reserved.

AMP, AMP FAX, AMPOWER, DYNA-CRIMP, and TYCO are trademarks.

Dimensions are in inches and millimeters unless otherwise specified. Values in brackets are metric equivalents.

Dimensions are shown for reference purposes only. Specifications subject to change.

Technical Support  
USA: 1-800-522-6752  
Canada: 1-905-475-6222  
Mexico: 01-800-733-8926

[www.tycoelectronics.com](http://www.tycoelectronics.com)

### Table of Contents

Product Facts, Technical Documents .....	1
Performance Requirements .....	3
Features .....	4
Terminals .....	5-9
Splices .....	9-11
Special Terminals .....	12
Tooling .....	13-14
Part Number Index .....	15
Support Services .....	16

### Crimp Method

Our compression crimping method of terminating electrical wire is an exact science. The application technique is totally mechanical and therefore completely controllable. For this reason it is also uniform from first to last crimp. Variables common to other methods such as melting temperature, flux composition, entrapped gases, heat deformation of conductors, oxidation and the like are eliminated. The termination resulting from this method offers excellent tensile strength and high conductivity.

AMPOWER terminals and splices are made of high quality seamless tubular copper for excellent conductivity. Our special tin plating process inhibits corrosion, and provides trou-

ble-free service. A special die stamping process converts the copper tube into a double thickness rectangular tongue with a short strong transfer section. These factors combine with the formulated AMPOWER terminal crimp to produce excellent conductivity and excellent strength.

**Before Crimping**

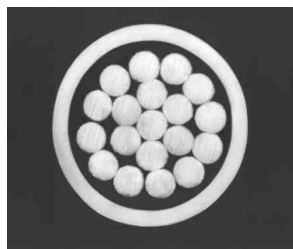

### Specified Packaging

Wire Size	No. of Terminals Per Package
6 and 4 AWG	100
2 AWG and 1/0 thru 4/0 AWG	50
250-1500 MCM	25

### Stud Size Dimensions<sup>1</sup>

Stud Size	Stud Dia.	Stud Hole Dia.
10	.190 4.83	.197 5.00
1/4 M6	.250 6.35	.265 6.73
5/6 M8	.312 7.92	.328 8.33
3/8	.375 9.53	.390 9.91
7/16	.437 11.1	.453 11.51
1/2 M12	.500 12.7	.515 13.08
5/8 M16	.625 15.88	.656 16.66
3/4	.750 19.05	.781 19.84
7/8 M22	.875 22.23	.906 23.01
1	1.000 25.4	1.031 26.19
1 1/8	1.125 28.58	1.156 29.36
1 1/4	1.250 31.75	1.281 32.54

<sup>1</sup>Use as an aid for the selection of proper terminal size.

**After Crimping**

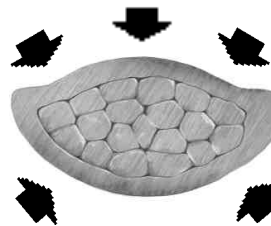

### Performance Requirements

#### Per MIL-T-7028

##### Chart 1 Electrical

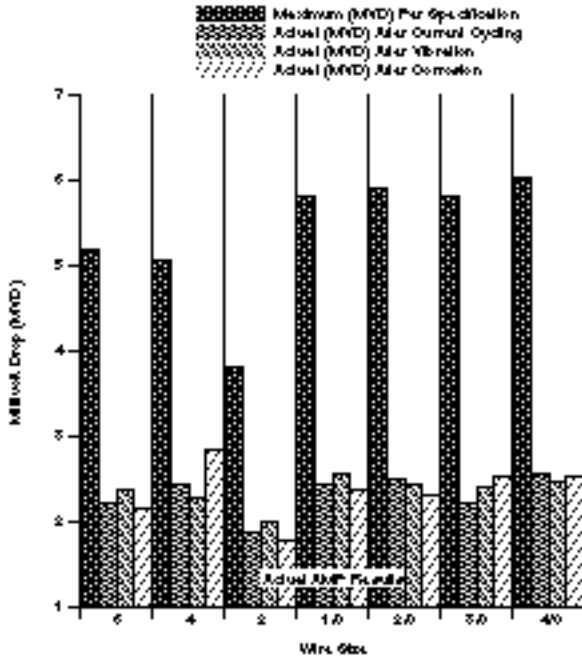

##### Chart 2 Mechanical

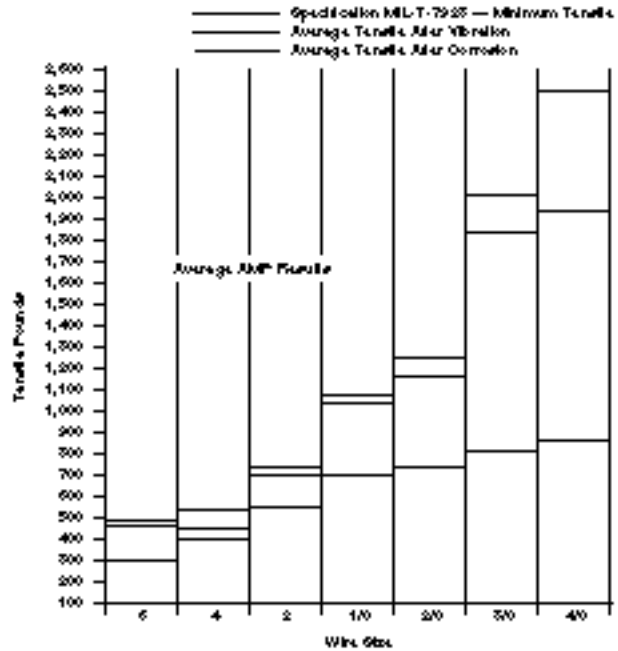

#### Per U.L. 486

##### Chart 3 Temperature Rise

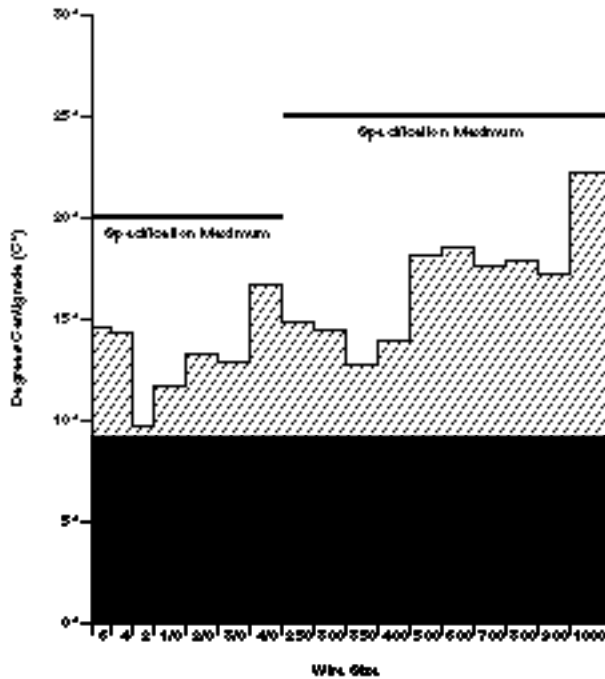

##### Chart 4 Tensile in Pounds

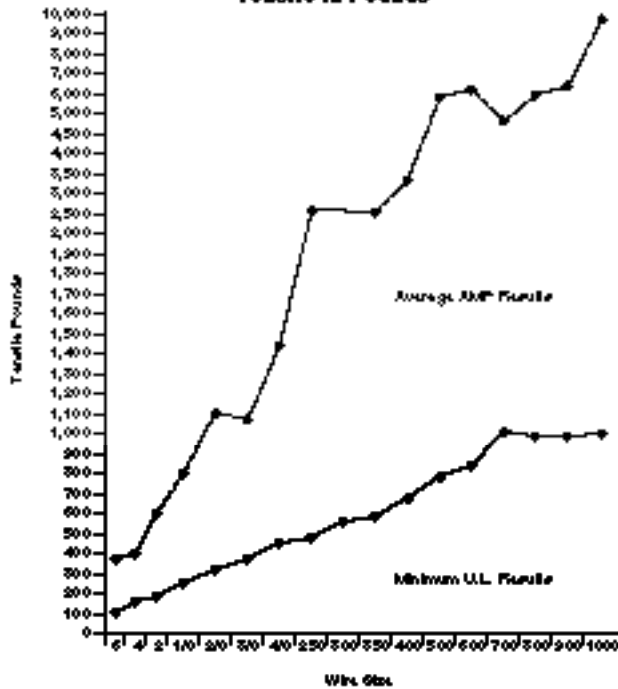

### Features

#### 1. Versatility

Stranded wires, crimped with the DYNA-CRIMP tool, become almost a homogeneous mass with the AMPOWER terminal or splice barrel.

Long barrel terminals and splices are offered for applications where space limitations and accessibility make it difficult to locate the proper crimp area.

Complementing this versatility is the stud hole style available with AMPOWER terminals. They are supplied with one, two or without stud holes for special requirements, or they can be ordered with extra long tongues at a slightly higher cost.

#### 2. Strength

AMPOWER terminals have formidable strength and resistance to vibration suitable for their intended use.

This strength comes from the double-thick tongue and short transfer section of the barrel, and is achieved without sacrificing any current carrying capacity. In addition, great tensile strength is imparted to the AMPOWER terminals and splices by means of AMP's formulated "C" crimp-tensile strength approaches the strength of the conductors.

#### 3. Economy

An important part of all AMP products is low installed cost. This is a result of the tool and terminal team, the elimination of clutter found in other methods, plus the speed and ease of application. And AMP's matching tooling creates the correct crimp. As a result, you save money every time an AMPOWER product is installed.

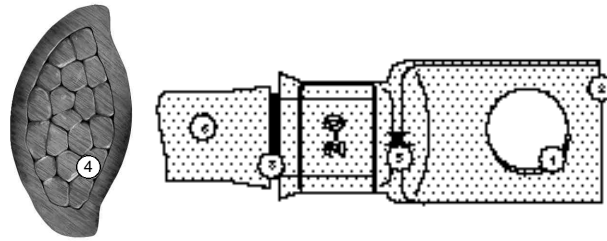

**Terminals  
With Two Stud Holes**  
See pages 5-9



**Long Barrel Terminal  
Without Stud Hole**  
See pages 5-9



**Standard Terminals  
With One Stud Hole**  
See pages 5-9



**Parallel Splice**  
See page 11



**Standard Terminals  
Without Stud Hole**  
See pages 5-9

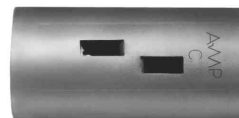

**Butt Splice**  
See page 10



**Long Barrel Terminal  
With Stud Hole**  
See pages 5-9



**Long Barrel  
Butt Splice**  
See page 8

#### 4. Conductivity, Corrosion Resistance and Temperature Rise

The center of the AMP termination method is the exactly controlled "C" crimp that forms the terminal or splice barrel into an almost homogeneous unit. As a result, conductivity is maximized and tensile strength approaches that of the wire. Proper compression crimping brings the terminal into intimate contact with the conductor, producing excellent resistance to corrosion. Tests of temperature rise above ambient also confirm the excellent performance of AMPOWER terminals and splices.

#### 5. Positive Inspection

Standard AMPOWER terminals and splices are supplied with inspection slots in the barrel, allowing the tool operator or inspector to determine at a glance whether the conductors have been fully and properly inserted into the barrel. This can be done either before or after crimping. Wire stops prevent over insertion of conductors, and bell mouth construction makes it easy to insert conductors into the barrel.

#### 6. Broad Wire Size Range

Covering wire sizes from 6 AWG to 1000 MCM [13 to 507 mm<sup>2</sup>] — for terminals and up to 1500 [760 mm<sup>2</sup>] for splices. AMPOWER terminals and splices provide reliability and low cost installation for power equipment using large cable sizes.

**Note:** See page 12 for Special Terminals.

### Terminals

#### Base Material:

 Annealed Copper  
(ASTM B-188)<sup>2</sup>

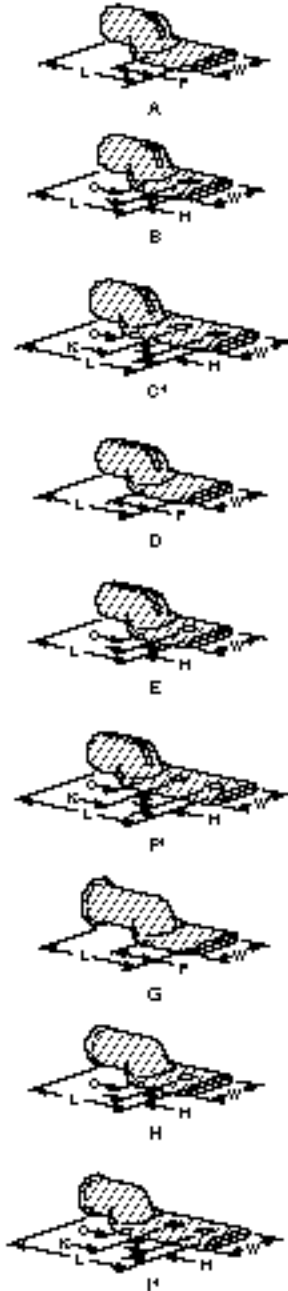
 Electrodeposited Tin Plate  
(MIL-T-10727)

Wire Size	Wire Range	Barrel I.D. Min.	Tongue Thickness Max.	Style	Stud Size	Dimensions						Part Number			
						L Max.	H Max.	C Min.	K	F Min.	W Max.				
6 AWG <sup>2</sup> 13-15 mm <sup>2</sup>	20,800- 33,100 CM	.219 5.56	.08 2.03	A	—	1.41 35.81	—	—	—	.74 18.80	.69 17.53	328140			
				B	10	1.41 35.81	.32 8.13	.42 10.67	—	—	.69 17.53	328141			
				B	1/4 M6	1.41 35.81	.32 8.13	.42 10.67	—	—	.69 17.53	328142			
				B	5/16 M8	1.41 35.81	.32 8.13	.42 10.67	—	—	.69 17.53	328143			
				B	3/8	1.41 35.81	.32 8.13	.42 10.67	—	—	.69 17.53	328144			
				B	1/2 M12	1.43 36.32	.38 9.65	.43 10.92	—	—	.77 19.56	328158			
4 AWG <sup>2</sup> 21 mm <sup>2</sup>	33,100- 52,600 CM	.275 6.99	.08 2.03	A	—	1.41 35.81	—	—	—	.74 18.80	.69 17.53	328160			
				B	1/4 M6	1.41 35.81	.32 8.13	.42 10.67	—	—	.69 17.53	328162			
				B	5/16 M8	1.41 35.81	.32 8.13	.42 10.67	—	—	.69 17.53	328163			
				B	3/8	1.41 35.81	.32 8.13	.42 10.67	—	—	.69 17.53	328164			
				B	1/2 M12	1.46 37.08	.40 10.16	.43 10.92	—	—	.77 19.56	328178			
				2 AWG 34-35 mm <sup>2</sup>	52,600- 83,700 CM	.362 9.19	.09 2.29	A	—	1.62 41.15	—	—	—	.82 20.83	.71 18.03
B	1/4 M6	1.62 41.15	.34 8.64					.50 12.70	—	—	.71 18.03	325201			
B	5/16 M8	1.62 41.15	.34 8.64					.50 12.70	—	—	.71 18.03	325202			
B	3/8	1.62 41.15	.34 8.64					.50 12.70	—	—	.71 18.03	325203			
A	—	2.62 66.55	—					—	—	1.83 46.48	.71 18.03	325207			
B	1/2 M12	1.70 43.18	.41 10.41					.50 12.70	—	—	.78 19.81	325250			
1/0 AWG 50-60 mm <sup>2</sup>	83,700- 119,500 CM	.458 11.63	.10 2.54	C	3/8	2.63 66.80	.34 8.64	.50 12.70	1.00 25.40	—	.71 18.03	326799			
				A	—	1.97 50.04	—	—	—	1.03 26.16	.87 22.10	325300			
				A	—	3.05 77.47	—	—	—	2.03 51.56	.87 22.10	325308			
				G	—	4.24 107.70	—	—	—	2.83 71.88	.87 22.10	325318			
				B	1/4 M6	1.97 50.04	.42 10.67	.62 15.75	—	—	.87 22.10	325301			
				B	5/16 M8	1.97 50.04	.42 10.67	.62 15.75	—	—	.87 22.10	325302			
3/8	50.04	10.67	15.75	—	—	.87 22.10	325303								
							B	7/16	1.97 50.04	.42 10.67	.62 15.75	—	—	.87 22.10	325304
							C	5/16 M8	2.94 74.68	.42 10.67	.62 15.75	—	1.00 25.40	.87 22.10	328169
							B	1/2 M12	1.97 50.04	.42 10.67	.62 15.75	—	—	.87 22.10	325305
							C	3/8	2.98 75.69	.42 10.67	.62 15.75	1.00 25.40	—	.87 22.10	326800
							I	1/2 M12	4.27 108.46	.42 10.67	.62 15.75	1.75 44.45	—	.87 22.10	53680-2

<sup>1</sup> Per NEMA specification.

<sup>2</sup> Terminals for wire sizes 6 AWG and 4 AWG are manufactured from annealed copper per ASTM B-152.

### Terminals (Continued)

#### Base Material:

Annealed Copper  
(ASTM B-188)

Electrodeposited Tin Plate  
(MIL-T-10727)



A



B



C



D



E



F



G



H



I

Wire Size	Wire Range	Barrel I.D. Min.	Tongue Thickness Max.	Style	Stud Size	Dimensions						Part Number		
						L Max.	H Max.	C Min.	K	F Min.	W Max.			
2/0 AWG 67-70 mm <sup>2</sup>	119,500- 150,500 CM	.513	13.03			B	1/4 M6	2.11 53.59	.47 11.94	.62 15.75	—	—	.97 24.64	325401
						B	5/16 M8	2.11 53.59	.47 11.94	.62 15.75	—	—	.97 24.64	325402
						C	5/16 M8	3.02 76.71	.42 10.67	.88 22.35	.687 17.45	—	.97 24.64	50990
						C	5/16 M8	2.50 63.50	.32 8.13	.50 12.70	.687 17.45	—	.97 24.64	55992-1
						B	3/8 —	2.11 53.59	.47 11.94	.62 15.75	—	—	.97 24.64	325403
						B	1/2 M12	2.11 53.59	.47 11.94	.62 15.75	—	—	.97 24.64	325405
						A	—	3.86 98.04	—	—	—	2.83 71.88	.97 24.64	325406
						C	3/8 —	3.12 79.25	.47 11.94	.62 15.75	1.00 25.40	—	.97 24.64	326801
						H	3/8 —	2.72 69.09	.47 11.94	.62 15.75	—	—	.97 24.64	325410
						G	—	4.44 112.78	—	—	—	2.88 73.15	.97 24.64	325411-1
						I	1/2 M12	4.47 113.54	.47 11.94	.62 15.75	1.75 44.45	—	.97 24.64	53681-2
						3/0 AWG 80-95 mm <sup>2</sup>	150,500- 190,000 CM	.576	14.63			B	5/16 M8	2.26 57.40
B	3/8 —	2.26 57.40	.52 13.21	.62 15.75	—							—	1.08 27.43	325503
B	1/2 M12	2.26 57.40	.52 13.21	.62 15.75	—							—	1.08 27.43	325505
A	—	4.02 102.11	—	—	—							2.89 73.41	1.08 27.43	325508
G	—	4.66 118.36	—	—	—							2.94 74.68	1.08 27.43	325514
C	5/16 M8	3.27 83.05	.52 13.21	.62 15.75	1.00 25.40							—	1.08 27.43	325516
I	1/2 M12	4.69 119.13	.52 13.21	.62 15.75	1.75 44.45							—	1.08 27.43	53682-2
C	3/8 —	3.27 83.05	.52 13.21	.62 15.75	1.00 25.40							—	1.08 27.43	326802
A	—	2.45 62.23	—	—	—							1.19 30.23	1.19 30.23	325600
B	5/16 M8	2.45 62.23	.59 14.99	.62 15.75	—							—	1.19 30.23	325602
B	3/8 —	2.45 62.23	.59 14.99	.62 15.75	—							—	1.19 30.23	325603
B	3/8 —	2.45 62.23	.59 14.99	.62 15.75	—							—	1.19 30.23	325603-2**
4/0 AWG 100-125 mm <sup>2</sup>	190,000- 231,000 CM	.648	16.46			B	1/2 M12	2.45 62.23	.59 14.99	.62 15.75	—	—	1.19 30.23	325605
						C	3/8 —	3.46 87.88	.59 14.99	.62 15.75	1.00 25.40	—	1.19 30.23	326803
						A	—	4.21 106.93	—	—	—	2.95 74.93	1.19 30.23	325610
						A	—	3.46 87.88	—	—	—	2.20 55.88	1.19 30.23	325611
						G	—	4.94 125.48	—	—	—	2.95 74.93	1.19 30.23	325614
						C	1/2 M12	4.21 106.93	.59 14.99	.62 15.75	1.75 44.45	—	1.19 30.23	327284
						I	1/2 M12	4.94 125.48	.59 14.99	.62 15.75	1.75 44.45	—	1.19 30.23	53683-2

\*\* No sight hole.  
† Per NEMA specification.

### Terminals (Continued)

#### Base Material:

Annealed Copper  
(ASTM B-188)

Electrodeposited Tin Plate  
(MIL-T-10727)



A



B

 C<sup>4</sup>

D

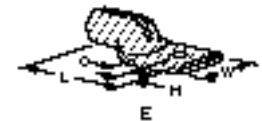

E

 F<sup>4</sup>

G



H



I

Wire Size	Wire Range	Barrel I.D. Min.	Tongue Thickness Max.	Style	Stud Size	Dimensions						Part Number	
						L Max.	H Max.	C Min.	K	F Min.	W Max.		
250 MCM 127 mm <sup>2</sup>	231-275 MCM	.690	17.53	.15 3.81	B	5/16 M8	2.58 65.53	.63 16.00	.62 15.75	—	—	1.28 32.51	325702
					B	3/8	2.58 65.53	.63 16.00	.62 15.75	—	—	1.28 32.51	325703
					B	1/2 M12	2.58 65.53	.63 16.00	.62 15.75	—	—	1.28 32.51	325705
					B	5/8	2.70 68.57	.63 16.00	.75 19.05	—	—	1.28 32.51	325707
					A	—	2.89 73.41	—	—	—	1.54 39.12	1.28 32.51	325708
					A	—	4.84 122.94	—	—	—	3.49 88.65	1.28 32.51	325712
					A	—	4.84 122.94	—	—	—	3.49 88.65	1.28 32.51	1-325712-3*
					A	—	3.59 91.19	—	—	—	2.29 58.17	1.28 32.51	325716
					G	—	5.63 143.	—	—	—	3.54 89.92	1.28 32.51	325719
					C	3/8	3.59 91.19	.63 16.00	.62 15.75	1.00 25.40	—	1.28 32.51	326804
					C	1/2 M12	4.34 110.24	.63 16.00	.62 15.75	1.75 44.45	—	1.28 32.51	327285
					300 MCM 152 mm <sup>2</sup>	275-325 MCM	.758	19.25	.16 4.06	C	5/16 M8	3.58 90.93	.63 16.00
B	5/16 M8	2.69 68.33	.63 16.00	.62 15.75						—	—	1.40 35.56	325802
B	3/8	2.69 68.33	.63 16.00	.62 15.75						—	—	1.40 35.56	325803
B	3/8	2.69 68.33	.63 16.00	.62 15.75						—	—	1.40 35.56	325803-1**
B	1/2 M12	2.69 68.33	.63 16.00	.62 15.75						—	—	1.40 35.56	325805
B	1/2 M12	2.69 68.33	.63 16.00	.62 15.75						—	—	1.40 35.56	325805-1**
A	—	2.82 71.63	—	—						—	1.37 34.80	1.40 35.56	2-325806-2*
B	5/8	2.82 71.63	.63 16.00	.75 19.05						—	—	1.40 35.56	325807
C	3/8	3.70 93.98	.63 16.00	.62 15.75						1.00 25.40	—	1.40 35.56	326805
C	3/8	3.70 93.98	.63 16.00	.62 15.75						1.00 25.40	—	1.40 35.56	326805-1**
C	1/2 M12	4.43 112.52	.63 16.00	.62 15.75						1.75 44.45	—	1.40 35.56	327286
B	3/8	2.42 61.47	.41 10.41	.62 15.75						—	—	1.40 35.56	325814
C	3/8	4.51 114.55	.63 16.00	.62 15.75	1.00 25.4	—	1.40 35.56	55993-1					
A	—	5.15 130.81	—	—	—	3.70 93.98	1.40 35.56	325816					
G	—	6.01 152.65	—	—	—	3.70 93.98	1.40 35.56	325821					
I	1/2 M12	5.25 133.35	.61 15.49	.62 15.75	1.75 44.45	—	1.40 35.56	53684-2					

\* Cleaned but not plated.

\*\* No sight hole.

<sup>4</sup> Per NEMA Specifications.

### Terminals (Continued)

#### Base Material:

 Annealed Copper  
(ASTM B-188)

 Electrodeposited Tin Plate  
(MIL-T-10727)

A

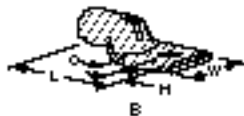

B



C



D



E



F



G



H



I

Wire Size	Wire Range	Barrel I.D. Min.	Tongue Thickness Max.	Style	Stud Size	Dimensions					Part Number			
						L Max.	H Max.	C Min.	K	F Min.		W Max.		
350 MCM 177mm <sup>2</sup>	325-375 MCM	.819	20.80			A	4.54	—	—	—	3.00	1.51	325917	
						B	1/2 M12	4.06	.54	.71	1.25	—	1.51	325926-1**
						A	—	2.86	—	—	—	1.41	1.51	325956*
						B	3/8	2.79	.63	.62	—	—	1.51	325903
						B	1/2 M12	2.79	.63	.62	—	—	1.51	325905
						B	1/2 M12	2.79	.63	.62	—	—	1.51	325905-1**
						A	—	2.91	—	—	—	1.42	1.51	325906
						C	3/8	3.79	.63	.62	1.00	—	1.51	326806
						C	3/8	3.79	.63	.62	1.00	—	1.51	326806-1**
						C	1/2 M12	4.55	.63	.62	1.75	—	1.51	327287
						I	1/2 M12	5.47	.63	.62	1.75	—	1.51	53641-2
						400 MCM 203mm <sup>2</sup>	375-450 MCM	.876	22.25			A	3/8	2.89
B	1/2 M12	2.89	.63	.62	—							—	1.61	326005
B	1/2 M12	2.89	.63	.62	—							—	1.61	326005-2**
B	5/8 M16	3.01	.63	.75	—							—	1.61	326007
A	—	3.59	—	—	—							1.99	1.61	1-326012-2*
B	—	4.88	—	—	—							3.24	1.61	326016
C	3/8	3.90	.63	.62	1.00							—	1.61	326807
G	—	5.87	—	—	—							3.21	1.61	326021
H	5/8 M16	4.00	.63	.75	—							—	1.61	326020
B	3/8	3.29	.76	.75	—							—	1.80	326103
B	1/2 M12	3.29	.76	.75	—							—	1.80	326105
B	5/8 M16	3.29	.76	.75	—							—	1.80	326106
500 MCM 253mm <sup>2</sup>	450-550 MCM	.981	24.92			A	—	3.43	—	—	—	1.68	1.80	326107-1*
						A	—	3.79	—	—	—	2.04	1.80	2-326111-1*
						A	—	5.00	—	—	—	3.25	1.80	326117
						C	1/2 M12	4.80	.61	.62	1.75	—	1.80	327289
						C	3/8	4.05	.63	.62	1.00	—	1.80	326808
						G	—	6.08	—	—	—	3.20	1.80	326123
						I	1/2 M12	5.88	.63	.62	1.75	—	1.80	53642-2

\*Cleaned but not plated.

\*\*No sight hole.

†Per NEMA specification.



### Terminals (Continued) and Splices

**Base Material:**

Annealed Copper  
(ASTM B-188)

Electrodeposited Tin Plate  
(MIL-T-10727)

**Note:** Refer to art on facing page.

Wire Size	Wire Range	Barrel I.D. Min.	Tongue Thickness Max.	Style	Stud Size	Dimensions						Part Number	
						L Max.	H Max.	C Min.	K	F Min.	W Max.		
600 <sup>2</sup> MCM 304mm <sup>2</sup>	550-650 MCM	1.075 27.31	.22 5.59	F	1/2 M12	4.46 113.28	.54 13.72	.71 18.03	1.25 31.75	—	1.95 49.53	276916-1	
					D	4.02 102.11	—	—	—	2.12 53.85	1.95 49.53	1-326211-1	
					G	6.28 159.51	—	—	—	3.25 82.55	1.95 49.53	326222	
					F	3/8 —	4.22 107.19	.63 16.00	.62 15.75	1.00 25.40	—	1.95 49.53	326809-1**
					F	1/2 M12	4.97 126.24	.63 16.00	.62 15.75	1.75 44.45	—	1.95 49.53	327290
					F	1/2 M12	4.97 126.24	.63 16.00	.62 15.75	1.75 44.45	—	1.95 49.53	327290-1**
700 <sup>2</sup> MCM 355mm <sup>2</sup>	650-750 MCM	1.162 29.51	.24 6.10	E	1/2 M12	3.59 91.19	.76 19.30	.75 19.05	—	—	2.12 53.85	326305	
					I	1/2 M12	6.35 161.29	.63 16.00	.62 15.75	1.75 44.45	—	2.12 53.85	53686-2
800 <sup>2</sup> MCM 405mm <sup>2</sup>	750-850 MCM	1.242 31.55	.25 6.35	E	1/2 —	3.72 94.49	.76 19.30	.75 19.05	—	—	2.26 57.40	326405	
					E	5/8 M12	3.72 94.49	.76 19.30	.75 19.05	—	—	2.26 57.40	326406
					D	—	4.47 113.54	—	—	—	2.24 56.90	2.26 57.40	2-326413-1*
					F	1/2 M12	5.23 132.84	.63 16.00	.62 15.75	1.75 44.45	—	2.26 57.40	327292
1000 <sup>2</sup> MCM 507mm <sup>2</sup>	950-1125 MCM	1.390 35.31	.28 7.11	F	1/2 M12	5.63 143.00	.63 16.00	.81 20.57	1.75 44.45	—	2.51 63.75	327294	

\* Cleaned but not plated.  
\*\* No sight hole.  
<sup>2</sup> Two crimps necessary.

### Splices

#### Long Barrel Butt Splice

**Wire Size Range:**

1/0 AWG to 500 MCM  
[50 to 253 mm<sup>2</sup>]

**Base Material:**

Annealed Copper  
(ASTM B-188)

Electrodeposited Tin Plate  
(MIL-T-10727)

Wire Size	Wire Range	Barrel I.D. Min.	Dimensions			Part Number
			T	L Max.		
1/0 AWG	83,700-119,500 CM	.468 11.89	.042 1.07	2.42 61.47		53081
4/0 AWG	190-231 MCM	.658 16.71	.059 1.50	3.24 82.30		53084
250 MCM	231-275 MCM	.700 17.78	.065 1.65	3.51 89.15		53085
350 MCM	325-378 MCM	.829 21.06	.077 1.96	4.06 103.12		53087
400 MCM	375-450 MCM	.886 22.50	.083 2.11	4.34 110.24		53088
500 MCM	450-550 MCM	.991 25.17	.092 2.34	4.75 120.65		53089

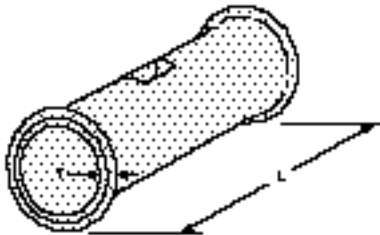

### Splices (Continued)

#### Butt Splice

#### Wire Size Range:

2 AWG to 1500 MCM  
[34 to 760 mm<sup>2</sup>]

#### Base Material:

Annealed Copper  
(ASTM B-188)

Electrodeposited Tin Plate  
(MIL-T-10727)

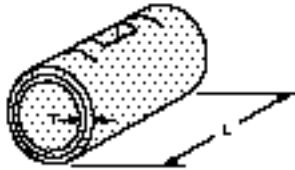

Wire Size	Wire Range	Barrel I.D. Min.	Dimensions		Part Number
			T	L Max.	
2 AWG	52,600-83,700 CM	.372 9.45	.039 .99	1.05 26.67	324457
1/0 AWG	83,700-119,500 CM	.468 11.89	.042 1.07	1.24 31.50	324458
2/0 AWG	119,500-150,500 CM	.523 13.28	.047 1.19	1.38 35.05	324459
3/0 AWG	150,500-190,000 CM	.586 14.88	.053 1.35	1.52 38.61	324460
3/0 AWG	150,500-190,000 CM	.586 14.88	.053 1.35	1.77 44.96	1-324460-3
4/0 AWG	190-231 MCM	.658 16.71	.059 1.50	1.65 41.91	324461
4/0 AWG	190-231 MCM	.658 16.71	.059 1.50	1.89 48.01	2-324461-3
250 MCM	231-275 MCM	.700 17.78	.065 1.65	1.79 45.47	324462
300 MCM	275-325 MCM	.768 19.51	.071 1.80	1.93 49.02	324463
300 MCM	275-325 MCM	.768 19.51	.071 1.80	2.15 54.61	2-324463-4*
350 MCM	325-375 MCM	.829 21.06	.077 1.96	2.06 52.32	324464
400 MCM	375-450 MCM	.886 22.50	.083 2.11	2.20 55.88	324465
500 MCM	450-550 MCM	.991 25.17	.092 2.34	2.41 61.21	324466
500 MCM	450-550 MCM	.991 25.17	.092 2.34	2.64 67.06	2-324466-2
600 MCM <sup>†</sup>	550-650 MCM	1.085 27.56	.101 2.57	2.61 66.29	324467
600 MCM <sup>†</sup>	550-650 MCM	1.085 27.56	.101 2.57	2.84 72.14	2-324467-3
700 MCM <sup>†</sup>	650-750 MCM	1.172 29.77	.109 2.77	2.79 70.87	324468
800 MCM <sup>†</sup>	750-850 MCM	1.252 31.80	.118 3.00	2.96 75.18	324469
800 MCM <sup>†</sup>	750-850 MCM	1.252 31.80	.118 3.00	3.31 84.07	2-324469-2
900 MCM <sup>†</sup>	850-950 MCM	1.328 33.73	.125 3.18	3.13 79.50	324470
1000 MCM <sup>†</sup>	950-1125 MCM	1.400 35.56	.131 3.33	3.27 83.06	324471
1000 MCM <sup>†</sup>	950-1125 MCM	1.400 35.56	.131 3.33	3.62 91.95	2-324471-1
1250 MCM <sup>†</sup>	1125-1300 MCM	1.812 46.02	.140 3.56	4.06 103.12	53182-1
1500 MCM <sup>†</sup>	1300-1600 MCM	1.718 43.64	.158 4.01	5.07 128.78	53646-3

\*Cleaned but not plated.  
†Two crimps necessary on each end.

### Splices (Continued)

#### Parallel Splice

##### Wire Size Range:

2 AWG to 1000 MCM  
[34 to 507 mm<sup>2</sup>]

##### Base Material:

Annealed Copper  
(ASTM B-188)

Electrodeposited Tin Plate  
(MIL-T-10727)

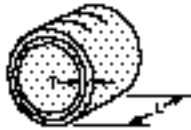

Wire Size	Wire Range	Barrel I.D. Min.	Dimensions		Part Number
			T	L Max.	
2 AWG	52,600-83,700 CM	.372 9.45	.039 .99	.49 12.45	324442
2 AWG	52,600-83,700 CM	.372 9.45	.039 .99	.49 12.45	1-324442-0*
1/0 AWG	83,700-119,500 CM	.468 11.89	.042 1.07	.58 14.73	324443
2/0 AWG	119,500-190,000 CM	.523 13.28	.047 1.19	.64 16.26	324444
2/0 AWG	119,500-190,000 CM	.523 13.28	.047 1.19	.64 16.26	1-324444-0*
3/0 AWG	150,500-190,000 CM	.586 14.88	.053 1.35	.71 18.03	324445
4/0 AWG	190-231 MCM	.658 16.71	.059 1.50	.77 19.56	324446
4/0 AWG	190-231 MCM	.658 16.71	.059 1.50	.77 19.56	1-324446-0*
250 MCM	231-275 MCM	.700 17.78	.065 1.65	.83 21.08	324447
300 MCM	275-325 MCM	.768 19.51	.071 1.80	.89 22.61	324448
300 MCM	275-325 MCM	.768 19.51	.071 1.80	.89 22.61	1-324448-0*
350 MCM	325-375 MCM	.829 21.05	.077 1.96	.96 24.38	324449
400 MCM	375-450 MCM	.886 22.50	.083 2.11	1.02 25.91	324450
500 MCM	450-550 MCM	.991 25.17	.092 2.34	1.11 28.19	324451
500 MCM	450-550 MCM	.991 25.17	.092 2.34	1.11 28.19	1-324451-0*
600 MCM <sup>†</sup>	550-650 MCM	1.085 27.56	.101 2.57	1.21 30.73	324452
700 MCM <sup>†</sup>	650-750 MCM	1.172 29.77	.109 2.77	1.29 32.77	324453
800 MCM <sup>†</sup>	750-850 MCM	1.252 31.80	.118 3.00	1.36 34.54	324454
800 MCM <sup>†</sup>	750-850 MCM	1.252 31.80	.118 3.00	1.36 34.54	1-324454-0*
900 MCM <sup>†</sup>	850-950 MCM	1.328 33.73	.125 3.18	1.44 36.58	324455
900 MCM <sup>†</sup>	850-950 MCM	1.328 33.73	.125 3.18	1.44 36.58	1-324455-0*
1000 MCM <sup>†</sup>	950-1125 MCM	1.400 35.56	.131 3.33	1.50 38.10	324456
1000 MCM <sup>†</sup>	950-1125 MCM	1.400 35.56	.131 3.33	1.50 38.10	1-324456-0*

\*Cleaned but not plated.

<sup>†</sup>Two crimps necessary.

### Special Terminals

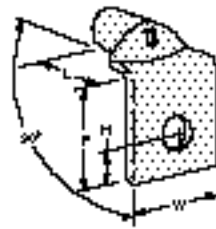

90° Bent



Centerline 2-Hole



Slotted Stud Hole



Heavy Duty 4-Hole

### 90° Bent Terminals

#### Wire Size Range:

 2 AWG to 350 MCM  
 [34 to 375 mm<sup>2</sup>]

Wire Size	Wire Range	Stud Size	Barrel I.D. Min.	Tongue Thickness Max.	Dimensions				Part Number
					L Min.	W Max.	F Min.	H Max.	
2 AWG 34-35 mm <sup>2</sup>	52,600 83,700 CM	3/16	.362	.09	.76	.71	.70	.30	325223-1
		—	9.19	2.29	19.30	18.03	17.78	7.62	
		(2) 1/4	.362	.09	1.68	.69	.144	.28	325221-1*
		M6	9.19	2.29	42.67	17.53	3.66	7.11	
1/0 AWG	83,700-119,500 CM	1/4	.362	.09	.76	.71	.70	.30	55813-1
		M6	9.19	2.29	19.30	18.03	17.78	7.62	
3/8	—	3/8	.362	.09	.76	.71	.70	.30	55817-1
		—	9.19	2.29	19.30	18.03	17.78	7.62	
1/0 AWG	83,700-119,500 CM	5/16	.468	.10	.85	.87	.95	.42	325320
M8	—	M8	11.89	2.54	21.59	22.10	24.13	10.67	
		4/0 AWG	190-231 MCM	3/8	.658	.13	1.20	1.19	2.24
M8	—	M8	16.71	3.30	30.46	30.23	56.90	14.99	

\* Two Stud Holes

### Slotted Stud Hole

#### Wire Size Range:

 400 to 500 MCM  
 [203 to 253 mm<sup>2</sup>]

Wire Size	Wire Range	Stud Size	Barrel I.D. Min.	Tongue Thickness Max.	Dimensions					Part Number
					L Max.	H Max.	C Min.	K	W Max.	
400 MCM	375-450 MCM	3/8	.876	.18	5.82	.44	3.29	1.30	1.61	276963-1
500 MCM	450-550 MCM	3/8	.981	.20	6.01	.44	3.25	1.30	1.80	276964-1
		—	24.92	5.08	6.35	11.18	82.55	33.02	45.72	

### Heavy Duty 4-Hole

#### Wire Size Range:

 350 to 600 MCM  
 [177mm<sup>2</sup> to 304mm<sup>2</sup>]

Wire Size	Wire Range	Stud Size	Barrel I.D. Min.	Tongue Thickness Max.	Dimensions					Part Number
					L Max.	H Max.	C Min.	K	W Max.	
350 MCM	325-375 MCM	1/2	.850	.26	4.85	.531	2.50	1.25	2.38	276920-1
500 MCM	450-550 MCM	1/2	.991	.27	4.93	.531	2.50	1.25	2.38	277146-1
		M12	25.17	6.85	125.22	13.49	63.50	31.75	60.45	
600 <sup>2</sup> MCM	550-650 MCM	1/2	1.120	.26	4.93	.531	2.50	1.25	2.38	276919-1
M12	—	M12	28.45	6.60	125.22	13.49	63.50	31.75	60.45	

<sup>2</sup> Two crimps necessary.

### Center 2-Hole Terminals

#### Wire Size Range:

 4/0 AWG to 600 MCM  
 [100 mm<sup>2</sup> to 304 mm<sup>2</sup>]

Wire Size	Wire Range	Stud Size	Barrel I.D. Min.	Tongue Thickness Max.	Dimensions					Part Number
					L Max.	H Max.	C Min.	K	W Max.	
4/0 AWG	190-231 MCM	5/16	.648	.13	4.24	.45	1.93	.875	1.19	277143-1
444.4 MCM	444.4 MCM	3/8	.991	.26	4.01	.45	2.00	1.00	1.26	326151-1
		—	25.17	6.60	101.85	11.43	50.80	25.40	32.00	
500 MCM	450-550 MCM	3/8	.991	.26	4.01	.45	2.00	1.00	1.26	276887-1
600 <sup>2</sup> MCM	550-650 MCM	3/8	1.085	.31	4.10	.45	2.00	1.00	1.26	
		—	27.56	7.87	104.14	11.43	50.80	25.40	32.00	

<sup>2</sup> Two crimps necessary.

---

**Tooling**

---

**DYNA-CRIMP Tool  
Heads and Dies****Hydraulic Hand Tool  
Part No. 59973-1  
(See chart for die numbers)**

### Tooling (Continued)

AMP application tools are designed to produce a carefully controlled uniform pressure crimp, regardless of how they are powered. All tools shown are specially designed for AMP products and are precision machined from hard tool steel.

#### Foot Operated Power Unit

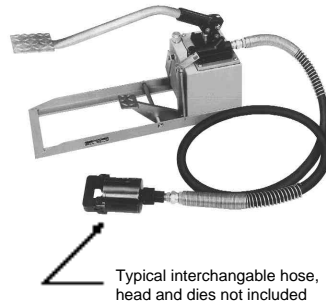

Typical interchangeable hose, head and dies not included

**314979-1** (Hose, head and dies not included)

Refer to the table below for accessories.

#### DYNA-CRIMP Electric Hydraulic Power Unit



**Power Unit Only**  
(Includes Pressure Release)

**115 Volts (60 Hz) — 69120-1<sup>3</sup>**

**230 Volts (60 Hz) — 69120-2<sup>3</sup>**

#### Power Units Accessories

For Use With Power Unit No.	Accessory Description	Accessory Part No.	Remarks
69120-1 <sup>3</sup> 69120-2 <sup>3</sup> 314979-1	7' Handle Control Assembly—Hose & Cord	59907-7	
	15' Handle Control Assembly—Hose & Cord	1-59907-5	
	21' Handle Control Assembly—Hose & Cord	2-59907-1	
	28' Handle Control Assembly—Hose & Cord	2-59907-8	
	15' Foot Switch Assembly	68284-1	Need Hose Assembly
	3' Hose Assembly	59909-3	68284-1 Foot Switch Assembly needed with these Hose Assemblies and 69120
	7' Hose Assembly	59909-7	
	15' Hose Assembly	1-59909-5	
	21' Hose Assembly	2-59909-1	
69120-1 <sup>3</sup> 69120-2 <sup>3</sup>	3-Way Multi-Directional Valve	59220 <sup>1</sup>	For use with Foot Switch only
	3-Way Multi-Directional Valve (Elec.Ct)	59220-2 <sup>1</sup>	
	6-Way Multi-Directional Valve	59221 <sup>1</sup>	
	6-Way Multi-Directional Valve (Elec.Ct)	59221-2 <sup>1</sup>	

<sup>1</sup> Contact AMP Incorporated for usage recommendations.

<sup>2</sup> Also see AMP Customer Manual CM 1980.

<sup>3</sup> Also see AMP Customer Manual CM 1950.

**Note:** All Hoses and Handle Control Assemblies have a 3/8" high male coupler (311470-1) on each end. All Power Units and Heads have a 3/8" high female coupler (311471-1).

### Part Number Index

**Note:** This numerical index lists all cataloged parts by base no. only. Complete part nos. (with prefixes and/or suffixes) are shown on the page(s) indicated.

Part No.	Page	Part No.	Page	Part No.	Page
50990	6	324450	11	325410	6
52682	6	324451	11	325411	6
53081	9	324452	11	325502	6
53084	9	324453	11	325503	6
53085	9	324454	11	325505	6
53087	9	324455	11	325508	6
53088	9	324456	11	325514	6
53089	9	324457	10	325516	6
53182	10	324458	10	325600	6
53641	8	324459	10	325602	6
53642	8	324460	10	325603	6
53646	10	324461	10	325605	6
53680	5	324462	10	325610	6
53681	6	324463	10	325611	6
53683	6	324464	10	325614	6
53684	7	324465	10	325702	7
53686	9	324466	10	325703	7
54634	12	324467	10	325705	7
55813	12	324468	10	325707	7
55817	12	324469	10	325708	7
55992	6	324470	10	325712	7
55993	7	324471	10	325716	7
276887	12	325200	5	325719	7
276916	9	325201	5	325802	7
276917	7	325202	5	325803	7
276918	12	325203	5	325805	7
276919	12	325207	5	325806	7
276920	12	325221	12	325807	7
276963	12	325223	12	325814	7
277143	12	325250	5	325816	7
277146	12	325300	5	325821	7
321860	5	325301	5	325903	8
324442	11	325302	5	325905	8
324443	11	325303	5	325906	8
324444	11	325304	5	325917	8
324445	11	325305	5	325924	12
324446	11	325308	5	326003	8
324447	11	325318	5	326005	8
324448	11	325320	12	326007	8
324449	11	325401	6	326012	8
		325402	6	326016	8
		325403	6	326020	8
		325405	6	326021	8
		325406	6	326103	8
				326105	8
				326106	8
				326107	8
				326111	8
				326117	8
				326123	8
				326151	12
				326211	9
				326222	9
				326305	9
				326405	9
				326406	9
				326413	9
				326799	5
				326800	5
				326801	6
				326802	6
				326803	6
				326804	7
				326805	7
				326806	8
				326807	8
				326808	8
				326809	9
				327284	6
				327285	7
				327286	7
				327287	8
				327289	8
				327290	9
				327292	9
				327294	9
				328140	5
				328141	5
				328142	5
				328143	5
				328144	5
				328158	5
				328162	5
				328163	5
				328164	5
				328169	5
				328178	5



Answers  
to your  
questions are  
just a phone  
call or mouse  
click away.



**tyco**  
Electronics

### **On-Line Catalog**

<http://catalog.tycoelectronics.com>

If you prefer to find your information electronically, check out our web site featuring a catalog containing over 155,000 products. Customer drawings, specifications, test reports, CAD models and electrical SPICE models, PCB layouts and panel cutouts can be downloaded from the web site. Cross references to hundreds of competitors makes it even easier to find the right part for nearly any application.

### **Technical Support**

USA: 1-800-522-6752 • Canada: 1-905-475-6222

Mexico: 01-800-733-8926

[www.tycoelectronics.com/help](http://www.tycoelectronics.com/help)

Our Technical Support Specialists provide information on distributor locations, drawing/prints, application/product specifications, PCB layouts, technical information, plating, electrical characteristics, dimensions, value added capabilities, and 3D modeling/simulation.

### **Tooling Assistance**

USA: 1-800-522-6752 • Canada: 1-905-475-6222

Mexico: 01-800-733-8926

[www.tycoelectronics.com/help](http://www.tycoelectronics.com/help)

Tooling support specialists will assist you in selecting hand tools, machines and applicators, identify tooling parts, and provide information about maintenance, adjustment and repair.

### **Customer Service**

USA: 1-800-522-6752 • Canada: 1-905-475-6222

Mexico: 01-800-733-8926

[www.tycoelectronics.com/help](http://www.tycoelectronics.com/help)

Receive price and delivery information immediately. You can also place new orders, change or expedite existing orders, and request product samples and literature through the Customer Service Department.

### **AMP FAX<sup>®</sup> Service**

USA: 1-800-522-6752 • Canada: 1-800-245-4356

Mexico: 001-717-986-3500 (toll call to USA)

Documents available through AMP FAX include part-numbers/catalog pages, drawings, application/product specifications, PCB layouts, and distributor information. Order as many as 20 pages of information at a time, with more than 100,000 drawings, specs, and more available.