

## 3.5 mm Blind Mate Connectors (Continued)

### Press-Fit Connectors

**Center Contact**—Brass per QQ-B-626 or Beryllium Copper per QQ-C-530, gold plated

#### Plug

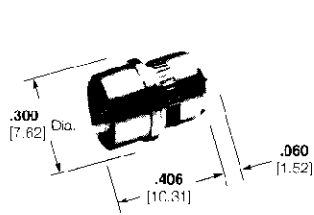

Part No. 222645-1

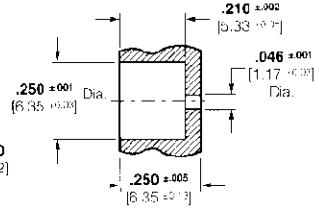

Recommended Panel Cutout

#### Jack

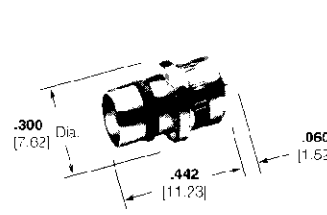

Part No. 222644-1

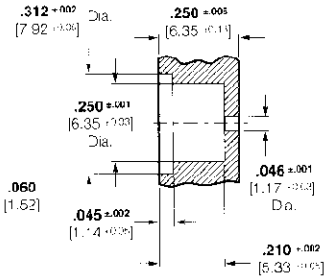

Recommended Panel Cutout

### Adapters

**Center Contact**—Brass per QQ-B-626 or Beryllium Copper per QQ-C-530, gold plated

#### SMA Jack to 3.5 mm Blind Mate Plug

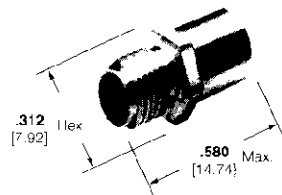

Part No. 222699-1

#### SMA Plug to 3.5 mm Blind Mate Plug

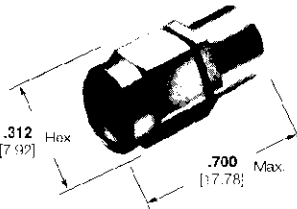

Part No. 222695-1

#### SMA Jack to 3.5 mm Blind Mate Jack

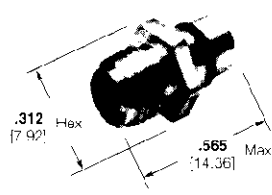

Part No. 222692-1

#### SMA Plug to 3.5 mm Blind Mate Jack

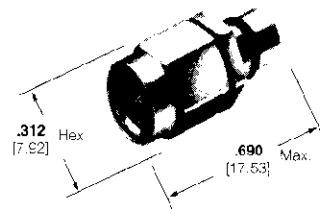

Part No. 222689-1

### Floating Plug 3.5 mm

**Center Contact**—Beryllium copper per ASTM-B-196, gold plated per MIL-G-45204

#### Blind Mate to SMA Jack

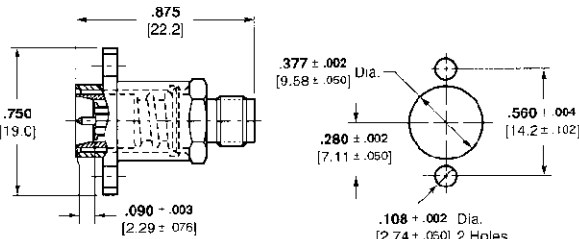
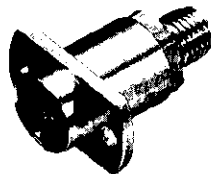

Nickel Plated  
Part No. 448091-1  
Stainless Steel  
Part No. 448091-2

#### Blind Mate to BNC Jack

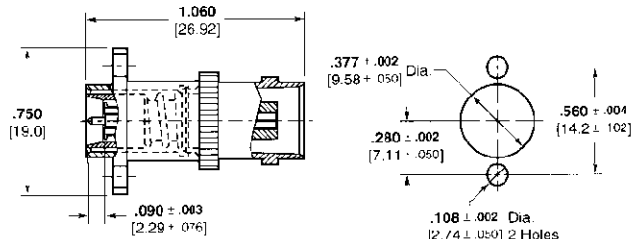
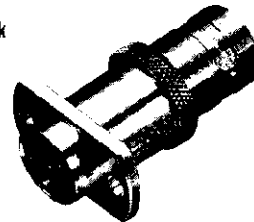

Nickel Plated  
Part No. 448435-1  
Stainless Steel  
Part No. 448435-2

Blind Mate Connectors