

REVISIONS

LTR	DESCRIPTION	DATE	APPROVED
A	REVISED PER DCR NO R030267	MAY 03	KJW
B	REVISED PER ECO-10-003828	11MAR10	A. BUI

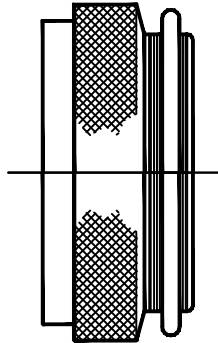

PANCAKE TINEL-LOCK ADAPTER

NOTES:

- THIS PRODUCT IS DESIGNED TO TERMINATE A BRAIDED CABLE SHIELD AND A HEAT SHRINKABLE LIPPED BOOT TO A CONNECTOR.
- SEE DRAWING "TR" FOR DETAILS ON TINEL-LOCK RING. RINGS ARE DESIGNED TO BE HEATED ELECTRICALLY. ALL RINGS ARE MARKED WITH THERMOCHROMIC PAINT WHICH CHANGES COLOR WHEN INSTALLATION TEMPERATURE IS REACHED.
- ADAPTER TO BE PERMANENTLY MARKED WITH CODE IDENT. NO. AND PART NO. LESS RING DESIGNATOR (E.G.: 06090-PNT54AB00-1410). RINGS SHALL BEAR NO MARKING.
- FOR PART NUMBER BREAKDOWN SEE CH00-0250-008. REPLACE "TXR" DESIGNATOR WITH "PNT". TINEL-LOCK RING IS TO BE SPECIFIED IN PART NUMBER WHEN ORDERING.
- ADAPTER MATES TO MIL-C-81703, SERIES III, MS3424, MS3446, MS3464, MS3467 AND MS3468 CLASSES E AND L.
- ADAPTER MATES TO MIL-C-5015G, MS3400 SERIES CLASS D, E, K, L, U AND W: MS3400, MS3401, MS3404, MS3406, MS3450, MS3451, MS3454, MS3456, MS3470, MS3471, MS3472, MS3474, MS3475 AND MS3476.
MIL-C-83723 SERIES II, CLASS A AND L, MIL-C-83723 SERIES I AND III CLASS A, G, K, R AND S:
M83723/1 TO /8, /13, /14, /36 TO /43, /48, /49, /65 TO /78, /82 TO /87, /91, /92, /95, /97 AND /98, (MS3155 CONTROLLED INTERFACE).

If this document is printed it becomes uncontrolled. Check for the latest revision

©2010 Tyco Electronics Corporation. All rights reserved.

CUSTOMER DRAWING

UNLESS OTHERWISE SPECIFIED
DIMENSIONS ARE IN INCHES.
[METRIC DIMENSIONS ARE
IN BRACKETS.]

DECIMALS
.X ±.005 [mm]
.XX ±.01 [mm]
.XXX ±.1 [mm]
ANGLES
.X ± .5°

REDRAWN A. BUI	DATE 5MAR10
CHECKED -	DATE -
APPROVED -	DATE -
APPROVED I. MYONG	DATE 5MAR10
CAD NAME PNT54	
THIRD ANGLE PROJECTION	

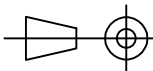

Tyco Electronics

Raychem Adapters
300 Constitution Drive
Menlo Park, CA 94025 U.S.A

TITLE

TINEL-LOCK™ ADAPTER
(PANCAKE CODE 54)

SIZE	CODE IDENT. NO.	DWG. NO.	REV
A	06090	PNT54	B
DO NOT SCALE THIS DWG		SHEET 1 OF 3	

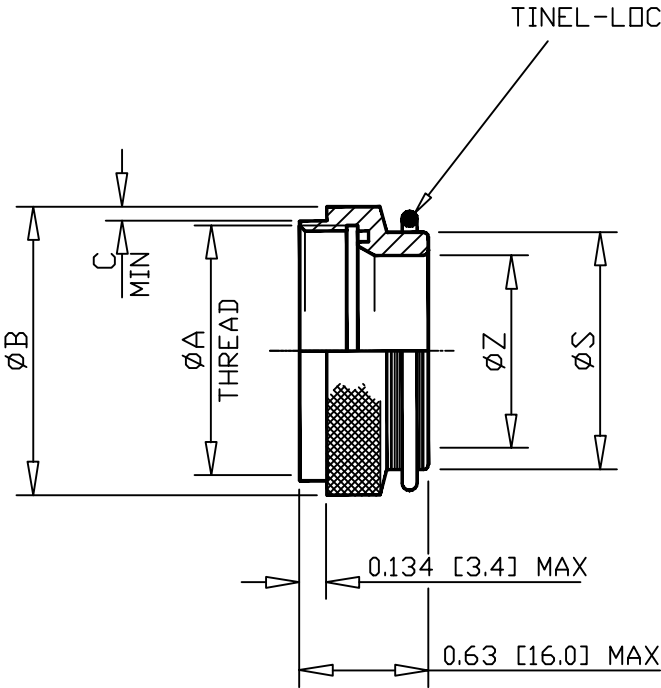

If this document is printed it becomes uncontrolled. Check for the latest revision

CUSTOMER DRAWING

SIZE	CODE IDENT. NO.	DWG. NO.	REV
A	06090	PNT54	B
DO NOT SCALE THIS DWG		SHEET 2 OF 3	



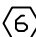
TABLE I						
ORDER NUMBER	SHELL SIZE		MAX ENTRY  SIZE	ØA UNIFIED THREAD CLASS 2B	ØB MAX	C MIN
						
08		8/8S	04	0.500-20 UNF	.65 [16.5]	.040 [1.00]
10		10/10S/10SL	06	0.625-24 UNEF	.77 [19.6]	.040 [1.00]
12	7	12/12S	08	0.750-20 UNEF	.90 [22.9]	.040 [1.00]
14	12	14/14S	10	0.875-20 UNEF	1.04 [26.4]	.040 [1.00]
16	19	16/16S	12	1.000-20 UNEF	1.22 [31.0]	.065 [1.65]
18	27	18	14	1.062-18 UNEF	1.28 [32.5]	.065 [1.65]
20	37	20	16	1.188-18 UNEF	1.40 [35.6]	.065 [1.65]
22		22	18	1.312-18 UNEF	1.53 [38.9]	.065 [1.65]
24		24	20	1.438-18 UNEF	1.65 [41.9]	.065 [1.65]

TABLE II			
ENTRY SIZE	ØZ	ØS	
	+0.010 -0.020 [+0.25] [-0.50]		
04	.250	0.376	[9.56]
	[6.35]	0.370	[9.39]
06	.375	0.501	[12.73]
	[9.53]	0.495	[12.57]
08	.500	0.626	[15.91]
	[12.70]	0.619	[15.72]
10	.625	0.752	[19.11]
	[15.87]	0.742	[18.84]
12	.750	0.877	[22.28]
	[19.05]	0.867	[22.02]
14	.875	1.002	[25.46]
	[22.23]	0.991	[25.17]
16	1.000	1.127	[28.63]
	[25.40]	1.116	[28.34]
18	1.125	1.252	[31.81]
	[28.57]	1.241	[31.52]
20	1.250	1.377	[34.98]
	[31.75]	1.366	[34.69]

If this document is printed it becomes uncontrolled. Check for the latest revision

CUSTOMER DRAWING

SIZE	CODE IDENT. NO.	DWG. NO.	REV
A	06090	PNT54	B
DO NOT SCALE THIS DWG			SHEET 3 OF 3