

4

3

2

1

THIS DRAWING IS UNPUBLISHED.
 VERTRAULICHE UNVEROEFFENTLICHTE ZEICHNUNG
 RELEASED FOR PUBLICATION
 FREI FUER VEROEFFENTLICHUNG
 ,19-
 MATED WITH:
 PASSEND ZU:
 -

LOC		DIST		REVISIONS AENDERUNGEN		
P	LTR	DESCRIPTION BESCHREIBUNG	DATE	DWN	APVD	
AI	-					
PROJEKT NR.:		C1	NEW CAD DRAWING PUBLISHED	26-FEB-04	MAH.	BRUN.

REMARKS
Bemerkungen

- △ 1 SUITABLE FOR 0.64x0.64 PIN
- △ 2 CRIMP AREA PLATED WITH MIN. 2.5µM TIN OVER 0.8µM NICKEL
- △ 3 GOLD PLATING
 - 2 0.4µM GOLD OVER 0.8µM NICKEL
 - 3 0.8µM GOLD OVER 0.8µM NICKEL
 - 4 1.25µM GOLD OVER 0.8µM NICKEL
 - 5 2.0µM GOLD OVER 0.8µM Nickel
 - 1- -5 1.5µM GOLD OVER 0.8µM NICKEL
 - 1- -6 1µM GOLD OVER 1.25µM NICKEL
 - 8 1.7µM GOLD OVER 0.8µM NICKEL
- △ 4 PIN STOP DIMENSION
- △ 5 PHOSPHORBRONZE

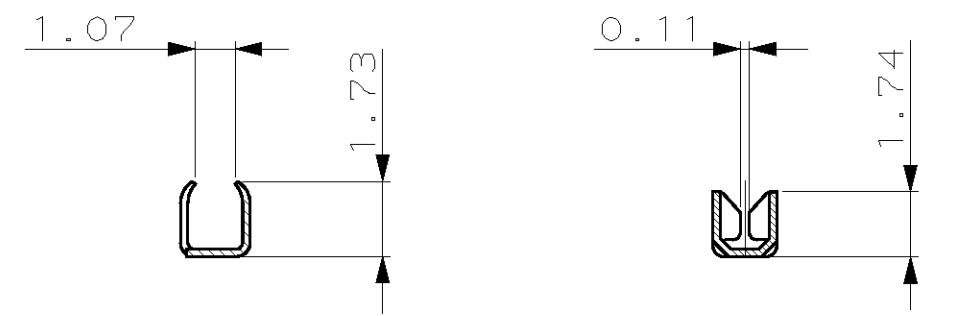
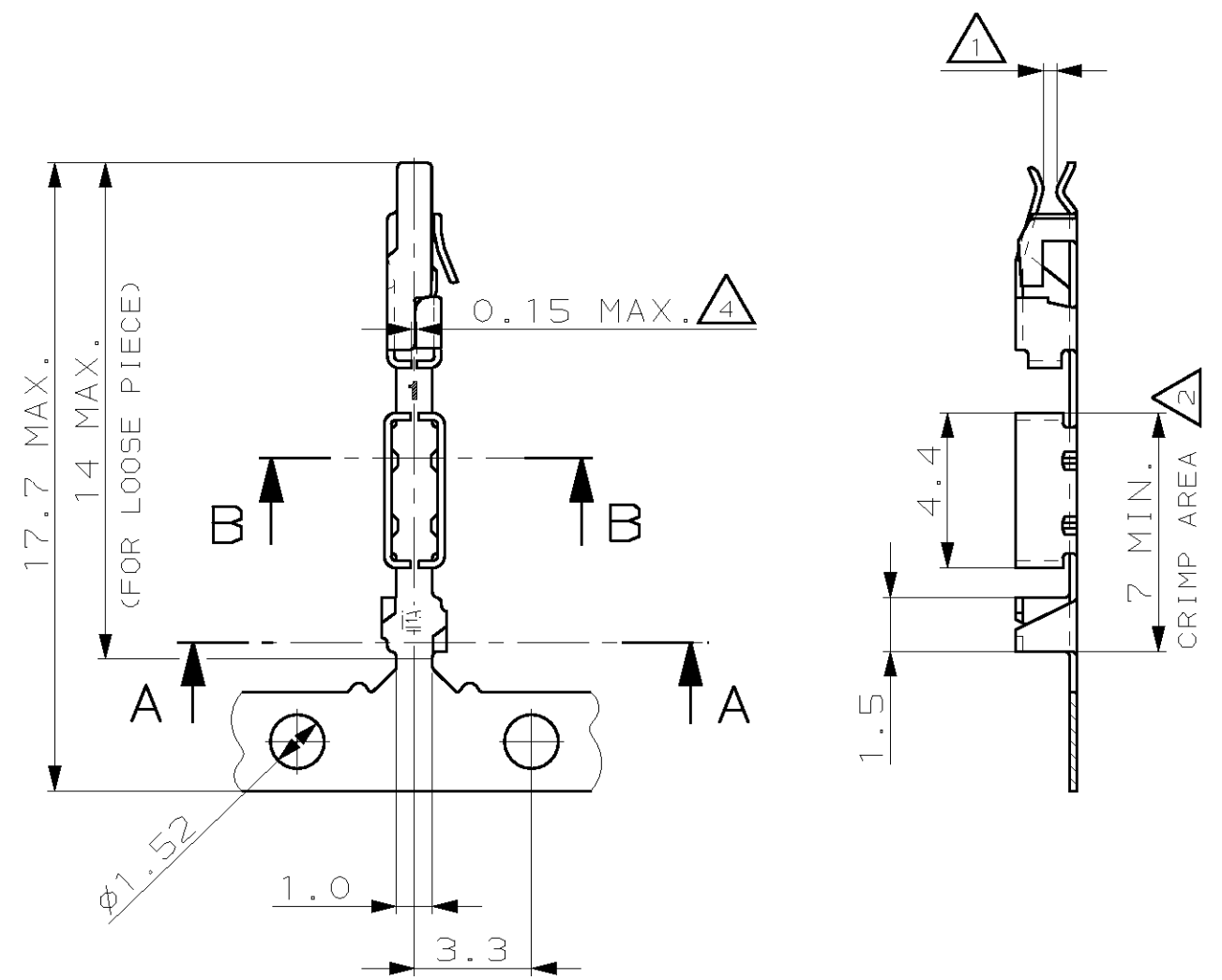

△ 5	-	△ 2 △ 3	0-215192-8	-
△ 5	-	△ 2 △ 3	1-215192-6	-
△ 5	-	△ 2 △ 3	1-215192-5	-
△ 5	-	△ 2 △ 3	0-215192-5	-
△ 5	-	△ 2 △ 3	0-215192-4	-
△ 5	-	△ 2 △ 3	0-215192-3	-
△ 5	-	△ 2 △ 3	0-215192-2	-
MATERIAL	SURFACE COLOR		PART NO.	ITEM NO

SECTION A-A SECTION B-B

THIS DRAWING IS A CONTROLLED DOCUMENT FOR AMP INCORPORATED. IT IS SUBJECT TO CHANGE AND THE CONTROLLING ENGINEERING ORGANIZATION SHOULD BE CONTACTED FOR THE LATEST REVISION. DIESES ZEICHNUNGSDOKUMENT WIRD DURCH AMP INCORPORATED KONTROLLIERT. AENDERUNGEN, DIE DEN TECHNISCHEN FORTSCHRITT DIENEN, SIND VORBEHALTEN. DEN JEWEILS LETZTUELTIGEN AENDERUNGSSTAND ERFAHREN SIE AUF ANFRAGE.

DIMENSIONS: DIMENSIONEN: mm	TOLERANCES UNLESS OTHERWISE SPECIFIED, ALLGEMEINTOLERANZEN n. 150 8015 n. 150 2768 - mH -E n. DIN 16901 - 140	DWN Mahnke, B. 26-FEB-04	AMP tyco Electronics AMP GmbH D - 64625 Bensheim
INSUL. RANGE: $\phi 1.2$ MAX.	FINISH / OBERFLAECHE / FARBE -	CHK Brunner, M. 27-FEB-04	
APVD Bleicher, M. 01-MAR-04		NAME RECEPTACLE CONTACT WITH MASS TERMINATION AREA FOR AWG 30-26.	
APPLICATION SPEC VERARBEITUNGSSPEZ. -		SIZE A3	CAGE CODE 00779
WEIGHT GEWICHT -		DRAWING NO ZEICHNUNGS-NR. C-215192	
CUSTOMER DRAWING / KUNDENZEICHNUNG		RESTRICTED TO NUR FUER -	
MASSSTAB 5:1		BLATT 1 OF 1 VON 1	REV C1