

THIS DRAWING IS UNPUBLISHED. RELEASED FOR PUBLICATION  
 © COPYRIGHT BY TYCO ELECTRONICS CORPORATION. ALL RIGHTS RESERVED.

| LOC | DIST | REVISIONS |     |                           |         |     |      |
|-----|------|-----------|-----|---------------------------|---------|-----|------|
| FT  | 64   | P         | LTR | DESCRIPTION               | DATE    | DWN | APVD |
|     |      |           | 01  | REVISED PER ECO-05-013685 | 14FEB06 | JDP | JGH  |
|     |      |           | 02  | REVISED PER ECO-10-000444 | 16JAN10 | KK  | AEG  |

- 1. TIN PLATE PER ASTM B 545 .000254 [.000100] MIN THICK.
- 2. GOLD PLATE PER ASTM B 488, 0.00076 [.000030] MIN THICK OVER NICKEL PLATE PER QQ-N-290 0.00028 [.000011] MIN THICK ON CONTACT AREA.
- 3. RECOMMENDED HOLE SIZE, PLATED OR UNPLATED:  
 MACHINE INSERTION: 1.04±0.05 [.041±.002]  
 HAND INSERTION: 1.02 <sup>+0.10</sup>/<sub>-0.00</sub> [.040 <sup>+0.004</sup>/<sub>-0.000</sub>]
- 4. APPLICATION TOOL PART NUMBER:  
 MACHINE NO. 682127-2  
 INSERTION HEAD NO. 682039-1
- 5. TO INSURE PROPER SPRING TENSION DO NOT EXCEED A 0.10 [.004] DIFFERENCE IN PIN DIA WHEN CHANGING TO A SMALLER PIN.
- 6. BOTTOM PLUG KNOCKOUT TOOL PART NUMBER 69729 WITH TIP PART NUMBER 69728.
- 7. MATERIAL:  
 SPRING: BERYLLIUM COPPER PER ASTM B 194  
 EYELET: COPPER PER ASTM B 152
- 8. OBSOLETE PARTS: OBSOLETE CIS STREAMLINING PER D.RENAUD/D.SINISI

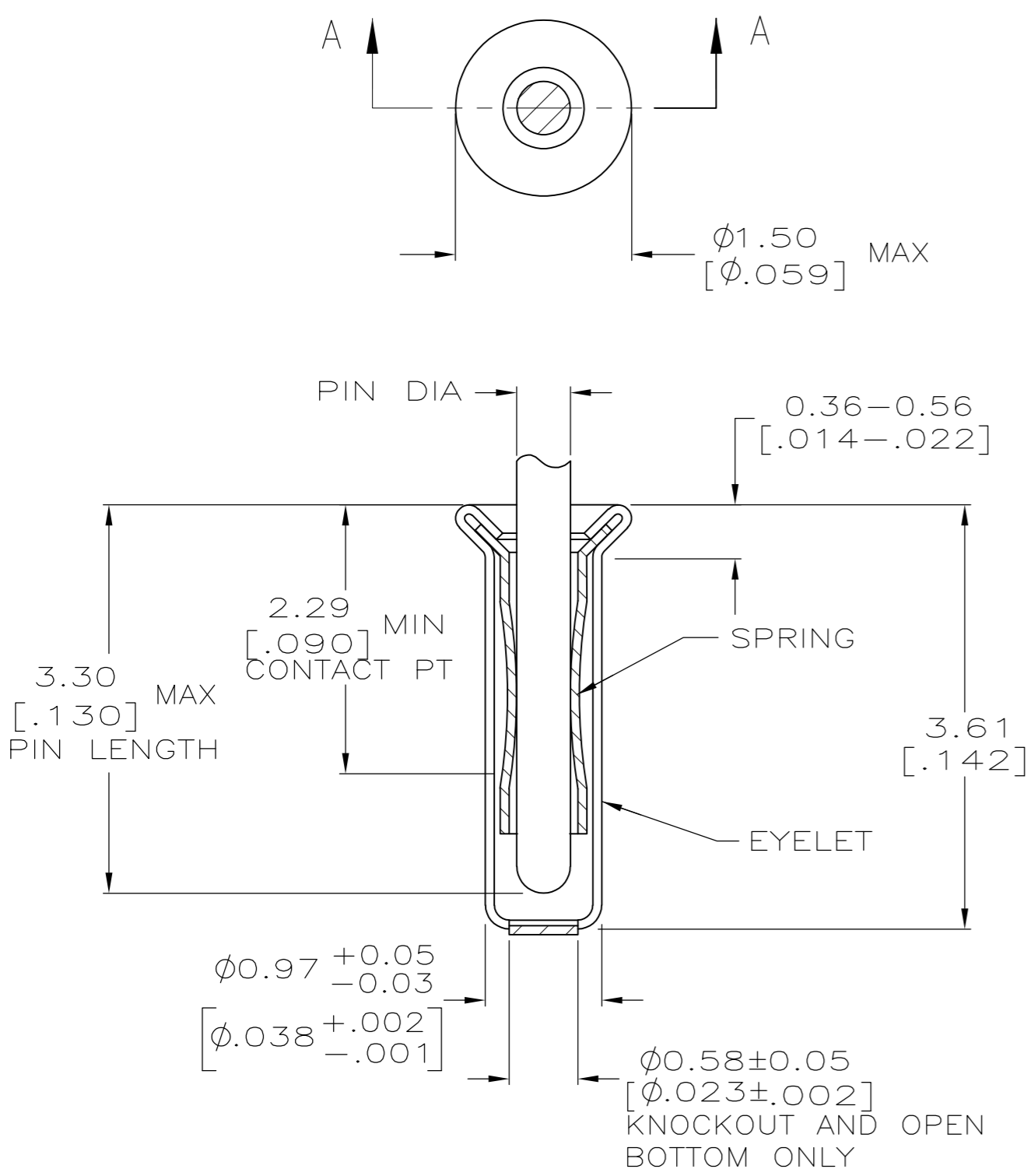

SECTION A-A

SUPERSEDED BY 5-5330808-4

| 8 OBSOLETE | OPEN        | 0.46-0.51 [.018-.020] | TIN 1  | GOLD 2 | 6-5330808-9 |
|------------|-------------|-----------------------|--------|--------|-------------|
|            | CLOSED      | 0.33-0.51 [.013-.020] |        |        |             |
|            | OPEN        | 0.25-0.33 [.010-.013] |        |        | 5-5330808-6 |
|            | KNOCKOUT    | 0.33-0.51 [.013-.020] |        |        | 5-5330808-4 |
|            | CLOSED      | 0.25-0.33 [.010-.013] |        |        | 5-5330808-3 |
|            | OPEN        | 0.33-0.51 [.013-.020] |        | TIN 1  | 5-5330808-0 |
|            | CLOSED      | 0.33-0.51 [.013-.020] |        |        | 4-5330808-7 |
|            |             |                       |        |        | 2-5330808-7 |
|            | BOTTOM TYPE | RECOMMENDED PIN DIA 5 | EYELET | SPRING | PART NO     |

|   |  |  |   |                    |
|---|--|--|---|--------------------|
| THIS DRAWING IS A CONTROLLED DOCUMENT.  |  | DWN<br>A. FERNANDEZ-DOCK5<br>20APR2005 | Tyco Electronics Corporation<br>Harrisburg, PA 17105-3608 |                    |
| DIMENSIONS: INCHES  |  | CHK<br>J. HAVENER<br>20APR2005         | NAME<br>MINIATURE SPRING SOCKET ASSEMBLY SERIES 1         |                    |
| TOLERANCES UNLESS OTHERWISE SPECIFIED:<br>0 PLC ± -<br>1 PLC ± -<br>2 PLC ± -<br>3 PLC ± 0.20 [.008]<br>4 PLC ± -<br>ANGLES ± - |  | APVD<br>J. HAVENER<br>20APR2005        | PRODUCT SPEC<br>108-14008                                 |                    |
| MATERIAL 1  |  | FINISH<br>SEE TABLE                    | APPLICATION SPEC<br>114-13152                             | RESTRICTED TO      |
|   |  | WEIGHT<br>-                            | SIZE<br>A2  | CAGE CODE<br>00779 |
|   |  | CUSTOMER DRAWING                       | DRAWING NO<br>C=5330808                                   | SCALE<br>20:1      |
|   |  |  | SHEET<br>1 of 1   | REV<br>02          |

5330808