



Ultra-Pod Fully Insulated FASTON Receptacles and Tabs

Product Facts

- Reduced insertion force
- Designed for correct lead-in of tab
- Mates with typical 110, 187 and 250 Series tab styles including those with shoulders
- UL rated at +105°C
- 110 Series accepts 22-18 AWG [0.3–1 mm²], 187 Series accepts 20-16 AWG [0.5–1.4mm²] wire and 250 Series accepts 22-10 AWG [0.3–5 mm²] wire
- Visual inspection of crimp and wire brush
- Terminated by automatic or semi-automatic equipment to meet production requirements
- Complies with the IEC 380, 601 and 950 and UL 1950 requirements for a secondary means of insulation fixing
- Listed by Underwriters Laboratories Inc., File No. E66717 
- CSA Certified, File No. LR 7189 
- VDE tested according to DIN VDE 0627/9.91, VDE Reg. No. 5193 

Technical Documents

Product Specification

108-1285

108-2215

Application Specification

114-2124

Hand Tools — Insertion

250 Series—314916-1

250 Series Flag—314919-1

Hand Tools — Extraction

250 Series—314917-1

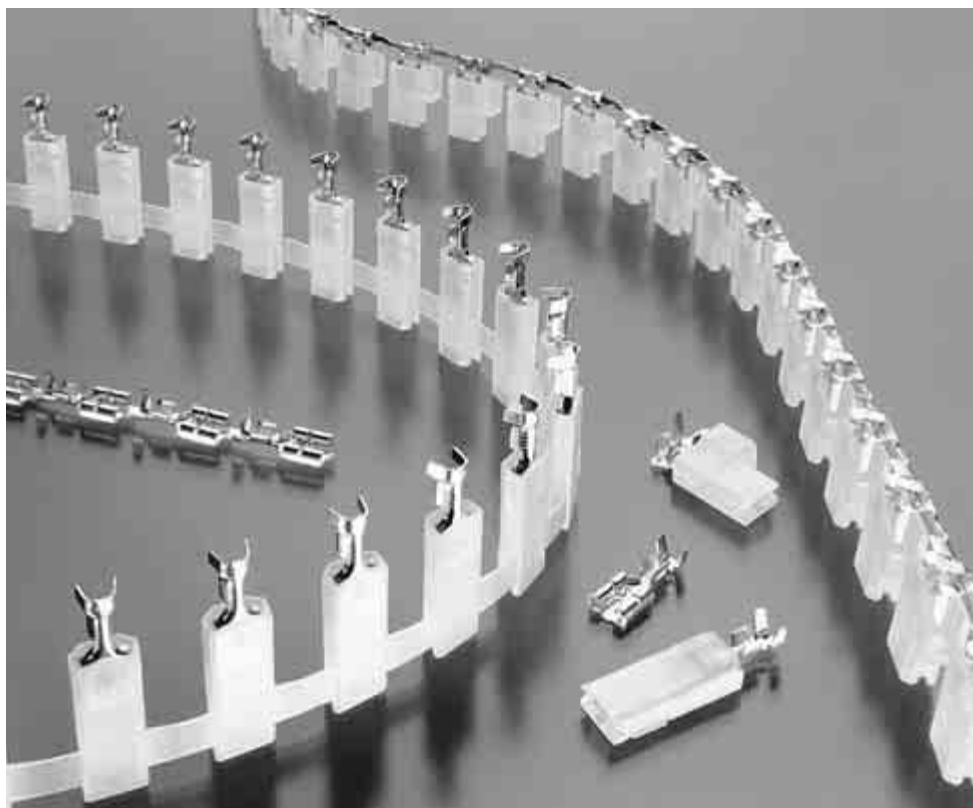

Ultra-Pod Fully Insulated FASTON Receptacles offer the newest in one-step automatic application of insulated quick connects. The unique integral plastic carrier designed specifically for this product allows insulated F-Crimp terminations to be produced quickly and easily. Applied cost savings are attainable with either bench or high-speed automatic termination equipment and the elimination of any secondary insulation operations. Both the crimping of the terminal and the terminal insulating occur in a single stroke of the press and applicator—the crimping on the down-stroke and the insulating on the up-stroke.

The receptacles contained within the Ultra-Pod FASTON Receptacle assemblies are tested and customer qualified and can be used in existing applications where insulation has been accomplished by other means. The low insertion force design provides easier tab insertion, reduces operator fatigue and improves the productivity and reliability of the end assembly operation.

The insulating housing is produced by a unique molding process which provides an integral carrier and eliminates the crimp location problems related to secondary carriers. This housing, produced from 130°C rated 6/6 nylon,

covers the FASTON receptacle sufficiently to provide for use in 600-volt applications. Most importantly, this insulating system helps eliminate the workplace hazards and labor costs of chemically expanded or heat shrink tubing.

Depending on production requirements, Tyco Electronics provides a complete selection of terminating equipment from bench press to automatic lead maker.

Ultra-Pod Fully Insulated FASTON Receptacles and Tabs (Continued)

Insulation Support

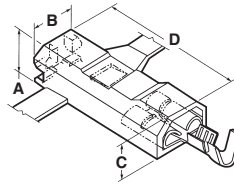

Description	Wire Range	Ins. Dia. Range	Dimensions				Mating Tab	UL 94 ¹	Color	Material and Finish	Part Numbers								
			A	B	C	D													
.110 Series	22-18	.080-.120 2.03-3.05	.151 3.83	.224 5.69	.205 5.21	.805 20.45	.020 0.51	V-2	Natural	Brass	521228-1								
							Tin Plated Brass			521228-2									
							.032 0.81	V-2	Natural	Brass	521436-1								
										Tin Plated Brass	521436-2								
								V-0	Natural	Brass	521437-1 ²								
										Tin Plated Brass	521437-2 ²								
.187 Series	20-16	.090-.130 2.29-3.30	.170 4.32	.295 7.49	.200 5.08	.775 19.68	.020 0.51	V-2	Natural	Brass	520973-1								
										Tin Plated Brass	520973-2								
							V-0	Natural	Brass	521225-1									
									Tin Plated Brass	521225-2									
							.032 0.81	V-2	Natural	Brass	520982-1								
										Tin Plated Brass	520982-2								
	V-0	Natural	Brass	521284-1															
			Tin Plated Brass	521284-2															
	18-16 or 2-18	(2) .105 Max. 2.67	.170 5.33	.295 7.49	.200 5.08	.775 19.68	.020 0.51	V-2	Natural	Brass	521293-1 ⁴								
										Tin Plated Brass	521293-2 ⁴								
							V-0	Natural	Brass	521586-1 ⁴									
									Tin Plated Brass	521586-2 ⁴									
.250 Series									22-18	.090-.130 2.29-3.30	.195 4.95	.370 9.40	.225 5.72	.945 24.00	.032 0.81	V-2	Natural	Brass	520988-1
																		Tin Plated Brass	520988-2
	V-0	Natural	Brass	521368-1															
			Tin Plated Brass	521368-2															
	18-14	.120-.170 3.05-4.32	.195 4.95	.370 9.40	.225 5.72	.945 24.00	.032 0.81	V-2								Natural	Brass	520963-1	
																	Tin Plated Brass	520963-2	
								V-0	Natural	Brass	521367-1								
										Tin Plated Brass	521367-2								
	18-14 or 2-18	(2) .105 Max. 2.67	.195 4.95	.370 9.40	.225 5.72	.945 24.00	.032 0.81	V-2	Black	Tin Plated Brass	521011-2								
										Nickel Plated Steel	521011-1 ^{2,3}								
								V-2	Natural	Brass	521637-1								
										Tin Plated Brass	521637-2								
V-0								Natural	Brass	521632-1									
									Tin Plated Brass	521632-2									
14-10	.130-.180 3.30-4.57	.195 4.95	.370 9.40	.225 5.72	.945 24.00	.032 0.81	V-2	Natural	Brass	520974-1									
									Tin Plated Brass	520974-2									
							V-0	Natural	Brass	521366-1									
									Tin Plated Brass	521366-2									

¹ Flammability rating of plastic material.

² 150°C rated nylon.

³ UL Recognized.

⁴ UL pending for double wire termination.

Note: All part numbers are RoHS compliant.

Ultra-Pod Fully Insulated FASTON Receptacles and Tabs (Continued)

Flag Insulation Support

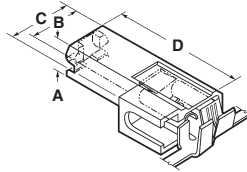

Description	Wire Range	Ins. Dia. Range	Dimensions				Mating Tab	UL 94 ¹	Color	Material and Finish	Part Numbers
			A	B	C	D					
.187 Series	22-18	.060-.110 1.52-2.79	.170 4.32	.295 7.49	.485 12.32	.680 17.27	.020 0.51	V-2	Natural	Brass	521470-1
										Tin Plated Brass	521470-2
							.032 0.81	V-0	Natural	Brass	521596-1
										Tin Plated Brass	521596-2
							.032 0.81	V-2	Natural	Brass	521598-1
										Tin Plated Brass	521598-2
	18-14 (2) 20 or (2) 18	(2) .105 Max. 2.66	.170 4.32	.295 7.49	.485 12.32	.680 17.27	.020 0.51	V-2	Natural	Brass	521600-1
										Tin Plated Brass	521600-2
							.032 0.81	V-0	Natural	Brass	521471-1 ²
										Tin Plated Brass	521471-2 ²
							.032 0.81	V-2	Natural	Brass	521597-1 ²
										Tin Plated Brass	521597-2 ²
.250 Series	22-18	.050-.100 1.27-2.54	.200 5.08	.370 9.40	.585 14.86	.680 17.27	.032 0.81	V-2	Natural	Brass	521050-1
										Tin Plated Brass	521050-2
							.032 0.81	V-0	Natural	Brass	521411-1
										Tin Plated Brass	521411-2
	18-14	.110-.160 2.79-4.06	.200 5.08	.370 9.40	.585 14.86	.680 17.27	.032 0.81	V-2	Natural	Brass	520971-1
										Tin Plated Brass	520971-2
							.032 0.81	V-2	Black	Tin Plated Brass	520971-4
										Nickel Plated Steel	521087-1 ³
							.032 0.81	V-0	Natural	Brass	521282-1
										Tin Plated Brass	521282-2
	18-14 (2) 20 or (2) 18	(2) .105 Max. 2.66	.200 5.08	.370 9.40	.585 14.86	.680 17.27	.032 0.81	V-2	Natural	Brass	521112-1
								V-0	Natural	Brass	521633-1
										Tin Plated Brass	521633-2

¹Flammability rating of plastic material.

²UL pending for double wire terminations.

³No UL or CSA approvals.

Note: All part numbers are RoHS compliant.

Ultra-Pod Fully Insulated FASTON Receptacles and Tabs (Continued)

Positive Lock Insulation Support

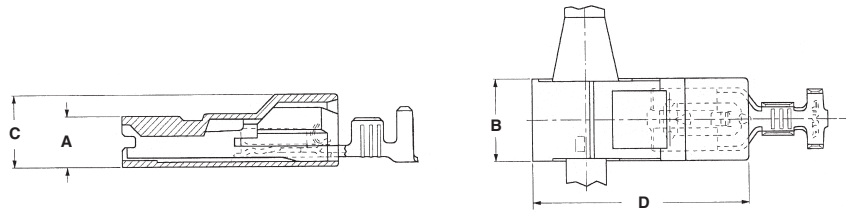

Description	Wire Range	Ins. Dia. Range	Dimensions				Mating Tab	UL 94 ¹	Color	Material and Finish	Part Numbers
			A	B	C	D					
.187 Series	18-14	.110-.180 2.79-4.57	.186 4.72	.307 7.80	.265 6.73	.812 20.62	.020 0.51	V-2	Natural	Brass	521271-1 ²
										Tin Plated Brass	521271-2 ²
										Tin Plated Brass	521212-2 ²
.250 Series	18-14	.110-.180 2.79-4.57	.205 5.21	.370 9.40	.245 6.22	.950 24.13	.032 0.81	V-2	Natural	Brass	521213-1 ²
										Tin Plated Brass	521213-2 ²
										Brass	521317-1 ²
								V-0	Natural	Tin Plated Brass	521317-2 ²

¹ Flammability rating of plastic material.

² UL Recognized, CSA Certified

Tabs Insulation Support

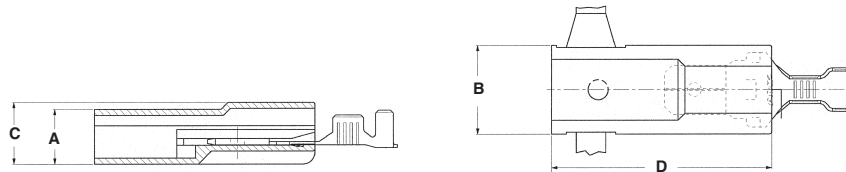

Description	Wire Range	Ins. Dia. Range	Dimensions				Tab	UL 94 ¹	Color	Material and Finish	Part Numbers
			A	B	C	D					
.250 Series	18-14	.130-.180 3.30-4.57	.275 6.99	.450 11.43	.310 7.87	1.120 28.45	.032 0.81	V-2	Natural	Brass	521217-1
										Tin Plated Brass	521217-2
	12-10	.150-.200 3.81-5.08	.275 6.99	.450 11.43	.310 7.87	1.120 28.45	.032 0.81	V-0	Natural	Brass	521451-1
										Tin Plated Brass	521451-2
								V-2	Natural	Brass	521227-1 ²
										Tin Plated Brass	521227-2 ²

¹ Flammability rating of plastic material.

² No UL or CSA approvals

Note: All part numbers are RoHS compliant.