

THIS DRAWING IS UNPUBLISHED. RELEASED FOR PUBLICATION ,19 .  
 © COPYRIGHT 19 BY AMP INCORPORATED. ALL INTERNATIONAL RIGHTS RESERVED.

LOC	DIST	P	F	ZONE	LTR	DESCRIPTION	DATE	APPD
G	14				B	REVISED PER 0720-0124-94	25JUL94	OKS DAP

**METRIC**  
 DIMENSIONS LISTED IN mm [ INCHES ]

<b>AMP</b> WIRE RANGE	E13288 Listed
2 AWG SOLID OR STRANDED	2 AWG STRANDED
LR7189 Certified	MILITARY P/N AND CLASS
2 AWG SOLID OR STRANDED	NOT APPLICABLE

① STAMP AMP 2W\* APPROX AS SHOWN

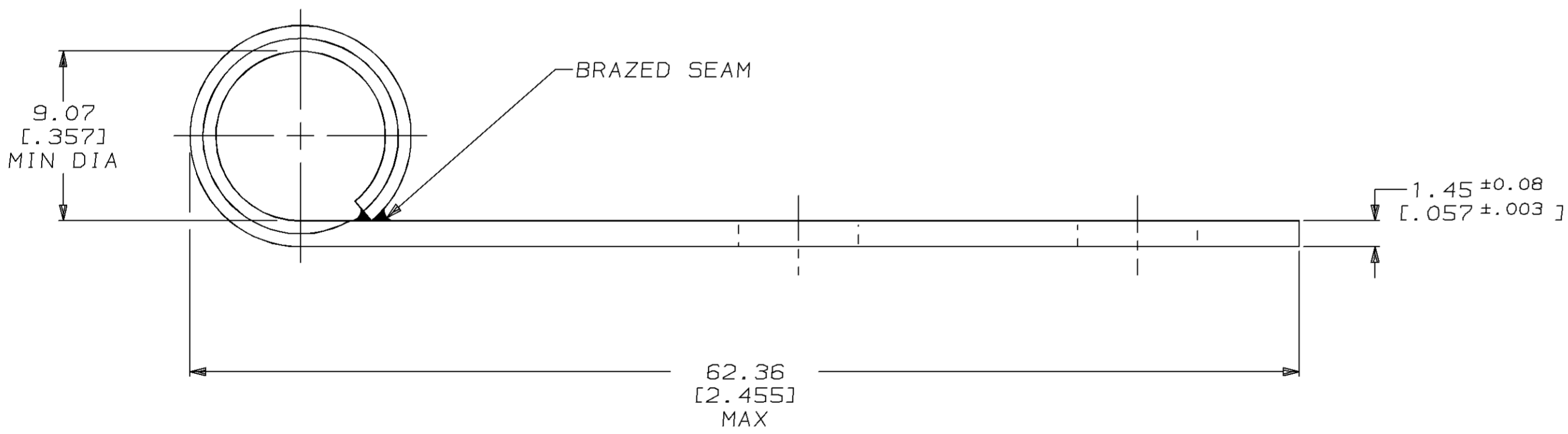
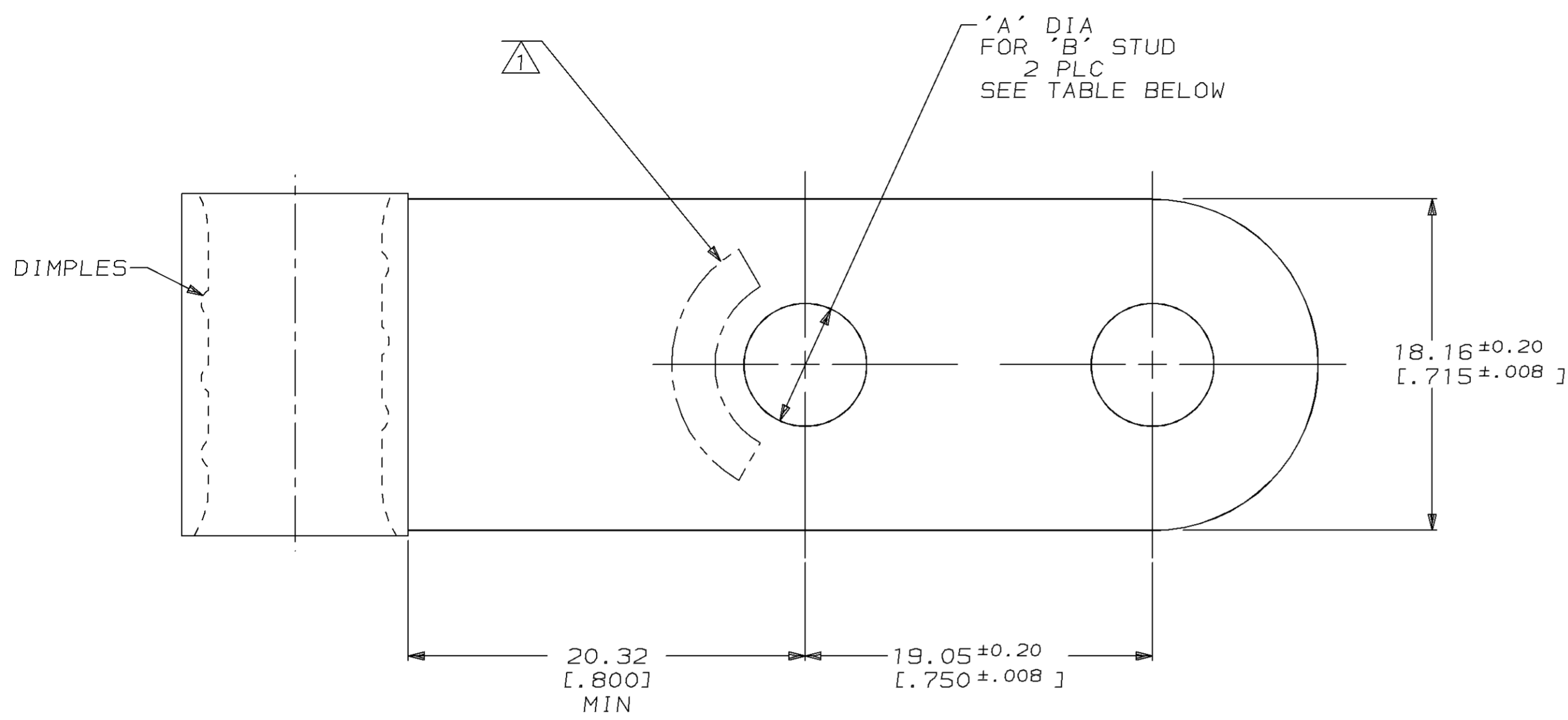

6.73 ±0.13 [.265 ±.005]	1/4	54686-2
5.00 ±0.08 [.197 ±.003]	#10	54686-1
'A'	'B'	PART NO

**AMP INCORPORATED**  
**CUSTOMER SERVICE SYSTEMS**

MAX RECOMMENDED OPERATING TEMPERATURE:  
 170°C MAX

DO NOT SCALE PRINT. UNLESS SPECIFIED  
 DIMENSIONS IN mm [INCHES]—  
 TOLERANCES ON:  
 2 PLC DEC ± -  
 3 PLC DEC ± -  
 ANGLES ± -

DR 11/29/93  
 DK SCHRUM  
 CHK 2/8/94  
 DA PATTERSON  
 APPD 2/8/94  
 CH KULYNYCH  
 APPD 2/8/94  
 JL MECKLEY  
 PRODUCT SPEC -

**AMP** AMP Incorporated  
 Harrisburg, PA 17105-3608

FOR ADDITIONAL PRODUCT INFORMATION OR COPIES OF DRAWINGS AND TECHNICAL DOCUMENTS

PRODUCT INFORMATION CENTER  
 1-800-522-6752

VOLTAGE RATING:  
 NOT APPLICABLE

MATERIAL  
 COPPER PER ASTM B-152 ANNEALED

APPLICATION SPEC -

NAME  
**TERMINAL, RING TONGUE, FLAG, SOLISTRAND™**

FOR APPLICATION TOOLING INFORMATION

TOOLING ASSISTANCE CENTER  
 1-800-722-1111

WIRE CROSS SECTIONAL AREA RANGE:  
 26.7-42.4mm<sup>2</sup> [52,600-83,700] CIR MILS  
 SOLID OR STRANDED

FINISH  
 TIN PLATE  
 0.00254[.000100] MIN THK PER MIL-T-10727

WEIGHT -

SIZE CAGE CODE DRAWING NO  
 C 00779 C=54686  
 SCALE 4:1 SHEET 1 OF 1

FOR ORDER ENTRY

1-800-526-5142

THIS DRAWING IS A CONTROLLED DOCUMENT FOR AMP INCORPORATED. IT IS SUBJECT TO CHANGE AND THE CONTROLLING ENGINEERING ORGANIZATION SHOULD BE CONTACTED FOR THE LATEST REVISION.