

# ECX-5488-25.600M TR

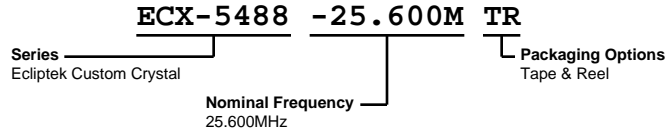

**PLEASE NOTE:** Due to the inherent proprietary nature of custom part numbers, certain parameters are intentionally excluded from this specification sheet.



## ELECTRICAL SPECIFICATIONS

|                   |           |
|-------------------|-----------|
| Nominal Frequency | 25.600MHz |
|-------------------|-----------|

## ENVIRONMENTAL & MECHANICAL SPECIFICATIONS

|                              |                                       |
|------------------------------|---------------------------------------|
| Fine Leak Test               | MIL-STD-883, Method 1014, Condition A |
| Gross Leak Test              | MIL-STD-883, Method 1014, Condition C |
| Lead Integrity               | MIL-STD-883, Method 2004              |
| Mechanical Shock             | MIL-STD-202, Method 213, Condition C  |
| Resistance to Soldering Heat | MIL-STD-202, Method 210               |
| Resistance to Solvents       | MIL-STD-202, Method 215               |
| Solderability                | MIL-STD-883, Method 2003              |
| Temperature Cycling          | MIL-STD-883, Method 1010              |
| Vibration                    | MIL-STD-883, Method 2007, Condition A |

## MECHANICAL DIMENSIONS (all dimensions in millimeters)

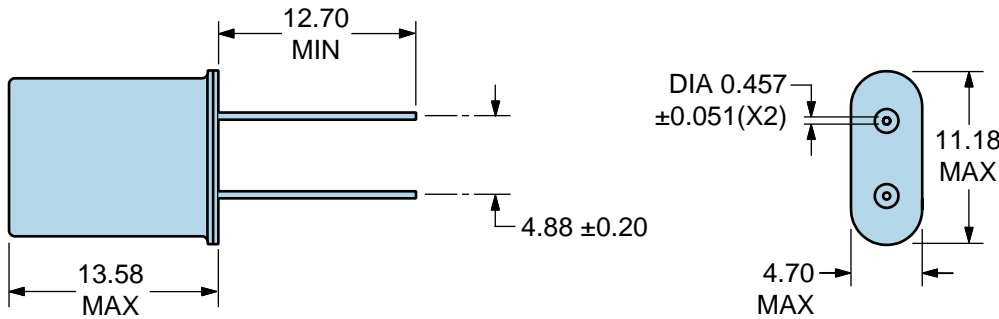

| LINE | MARKING   |
|------|---|
| 1    | <b>ECX-5488</b>   |
| 2    | <b>25.600M</b>  |
| 3    | <b>XXYZZ</b><br>XX=Ecliptek Manufacturing Designator<br>Y=Last Digit Of Year<br>ZZ=Week of Year |

# ECX-5488-25.600M TR

## Tape & Reel Dimensions

Quantity Per Reel: 1,000 Pieces

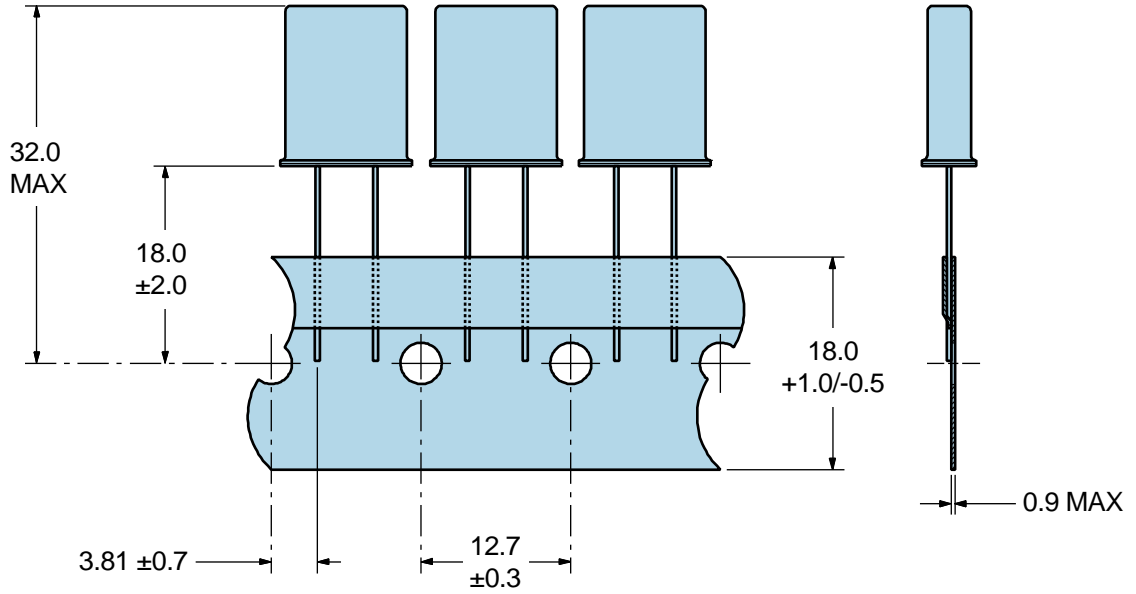

\*Compliant to EIA 468B

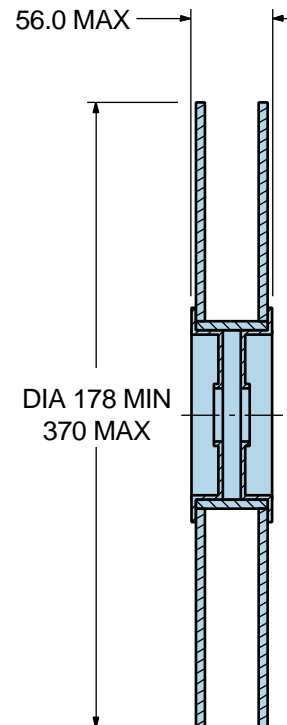
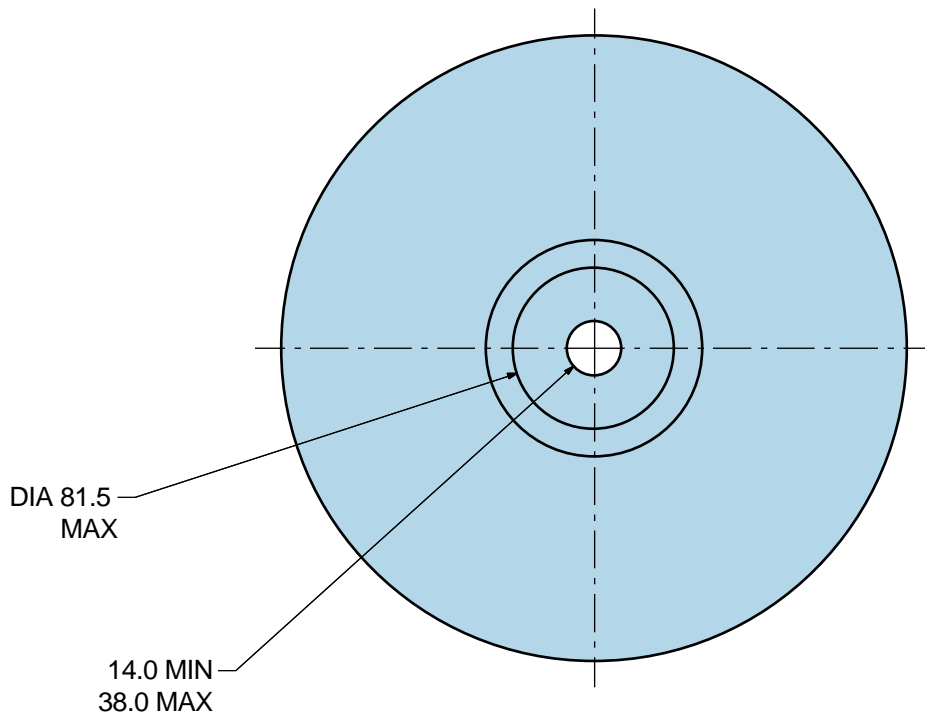

## Recommended Solder Reflow Methods



### High Temperature Solder Bath (Wave Solder)

**$T_S$  MAX to  $T_L$  (Ramp-up Rate)** 3°C/second Maximum

#### Preheat

- Temperature Minimum ( $T_S$  MIN) 150°C
- Temperature Typical ( $T_S$  TYP) 175°C
- Temperature Maximum ( $T_S$  MAX) 200°C
- Time ( $t_s$  MIN) 60 - 180 Seconds

**Ramp-up Rate ( $T_L$  to  $T_P$ )** 3°C/second Maximum

#### Time Maintained Above:

- Temperature ( $T_L$ ) 217°C
- Time ( $t_L$ ) 60 - 150 Seconds

**Peak Temperature ( $T_P$ )** 260°C Maximum for 10 Seconds Maximum

**Target Peak Temperature ( $T_P$  Target)** 250°C +0/-5°C

**Time within 5°C of actual peak ( $t_p$ )** 20 - 40 seconds

**Ramp-down Rate** 6°C/second Maximum

**Time 25°C to Peak Temperature (t)** 8 minutes Maximum

**Moisture Sensitivity Level** Level 1

## Recommended Solder Reflow Methods



### Low Temperature Solder Bath (Wave Solder)

|  |   |
|--|---|
| <b><math>T_s</math> MAX to <math>T_L</math> (Ramp-up Rate)</b> | 5°C/second Maximum                                    |
| <b>Preheat</b>   |   |
| - Temperature Minimum ( $T_s$ MIN)                             | N/A   |
| - Temperature Typical ( $T_s$ TYP)                             | 150°C   |
| - Temperature Maximum ( $T_s$ MAX)                             | N/A   |
| - Time ( $t_s$ MIN)  | 30 - 60 Seconds                                       |
| <b>Ramp-up Rate (<math>T_L</math> to <math>T_p</math>)</b>     | 5°C/second Maximum                                    |
| <b>Time Maintained Above:</b>                                  |   |
| - Temperature ( $T_L$ )  | 150°C   |
| - Time ( $t_L$ )   | 200 Seconds Maximum                                   |
| <b>Peak Temperature (<math>T_p</math>)</b>                     | 245°C Maximum   |
| <b>Target Peak Temperature (<math>T_p</math> Target)</b>       | 245°C Maximum 1 Time / 235°C Maximum 2 Times          |
| <b>Time within 5°C of actual peak (<math>t_p</math>)</b>       | 5 seconds Maximum 1 Time / 15 seconds Maximum 2 Times |
| <b>Ramp-down Rate</b>  | 5°C/second Maximum                                    |
| <b>Time 25°C to Peak Temperature (t)</b>                       | N/A   |
| <b>Moisture Sensitivity Level</b>                              | Level 1   |

### Low Temperature Manual Soldering

185°C Maximum for 10 seconds Maximum, 2 times Maximum.

### High Temperature Manual Soldering

260°C Maximum for 5 seconds Maximum, 2 times Maximum.