

# LCS Series Subminiature Sealed Snap-acting Switches



## Features/Benefits

- Compact design
- Long life and high electrical capacity
- Quick connect, solder terminals, PC terminals, wire leads
- Wide variety of actuator styles
- RoHS compatible, RoHS compliant
- IP67

## Typical Applications

- Motorized equipment
- Sump pump
- Thermostatic controls
- Computers
- Air conditioners

UL61058-1  

## Specifications

CONTACT RATING: from low level to 5 Amp  
 ELECTRICAL LIFE: 10,000 cycles  
 INSULATION RESISTANCE: 100 M ohm min.  
 DIELECTRIC STRENGTH: 1,000 VAC  
 OPERATING TEMPERATURE:  
 -40°C to +120°C (without wire)  
 -40°C to +85°C (with UL1007 wire)  
 -40°C to +105°C (with UL1015 wire)  
 -40°C to +105°C (with UL1430 wire)  
 -40°C to +80°C (with UL1061 wire)  
 -40°C to +120°C (with UL1330 wire)  
 OPERATING FORCE: (see ACTUATOR'S option sections).  
 MOUNTING: 2-56 screws, torque 2.3 in/lbs max.

**NOTE:** Specifications and materials listed above are for switches with standard options.  
 For information on specific and custom switches, consult Customer Service center.

## Materials

SWITCH HOUSING: Thermoplastic polyester or high temperature thermoplastic (PTS) (UL 94V-0).  
 ACTUATOR BUTTON: Thermoplastic polyester.  
 SPRING: Copper alloy.  
 PIVOT: Copper alloy.  
 MOVABLE CONTACTS: Silver nickel  
 STATIONARY CONTACTS: Silver nickel on copper alloy.  
 TERMINALS: Copper alloy.  
 ACTUATOR LEVEL: Stainless steel.

Snap-acting

## Build-A-Switch

To order, simply select desired option from each category and place in the appropriate box. Available options are shown and described on pages J-27 thru J-29. For additional options not shown in catalog, consult Customer Service Center.

<div style="text-align: center;"> <span style="border: 1px solid black; padding: 2px;">L</span> <span style="border: 1px solid black; padding: 2px;">C</span> <span style="border: 1px solid black; padding: 2px;">S</span> <span style="border: 1px solid black; padding: 2px;"> </span> <span style="border: 1px solid black; padding: 2px;"> </span> <span style="border: 1px solid black; padding: 2px;"> </span> <span style="border: 1px solid black; padding: 2px;"> </span> <span style="border: 1px solid black; padding: 2px;"> </span> <span style="border: 1px solid black; padding: 2px;"> </span> <span style="border: 1px solid black; padding: 2px;"> </span> <span style="border: 1px solid black; padding: 2px;"> </span> <span style="border: 1px solid black; padding: 2px;"> </span> <span style="border: 1px solid black; padding: 2px;"> </span> <span style="border: 1px solid black; padding: 2px;"> </span> <span style="border: 1px solid black; padding: 2px;"> </span> <span style="border: 1px solid black; padding: 2px;"> </span> <span style="border: 1px solid black; padding: 2px;"> </span> <span style="border: 1px solid black; padding: 2px;"> </span> <span style="border: 1px solid black; padding: 2px;"> </span> <span style="border: 1px solid black; padding: 2px;"> </span> <span style="border: 1px solid black; padding: 2px;"> </span> </div>											
<p><b>Series</b> LCS</p>											
<p><b>Electrical Rating</b></p> <table border="1"> <thead> <tr> <th>Option Code</th> <th>UL 1054</th> <th>UL 61058</th> </tr> </thead> <tbody> <tr> <td>01</td> <td>0.1 A 125/250 V AC</td> <td>0.1 A, 125/250 V AC 0.1 A 30 V DC</td> </tr> <tr> <td>05</td> <td>5 A 125/250 V AC</td> <td>5 A 125/250 V AC .5 A 125/250 V AC</td> </tr> </tbody> </table>			Option Code	UL 1054	UL 61058	01	0.1 A 125/250 V AC	0.1 A, 125/250 V AC 0.1 A 30 V DC	05	5 A 125/250 V AC	5 A 125/250 V AC .5 A 125/250 V AC
Option Code	UL 1054	UL 61058									
01	0.1 A 125/250 V AC	0.1 A, 125/250 V AC 0.1 A 30 V DC									
05	5 A 125/250 V AC	5 A 125/250 V AC .5 A 125/250 V AC									
<p><b>Operating Force</b></p> <p>1 150 grams 2 203 grams</p>											
<p><b>Actuator</b></p> <p>P00 Pin plunger              T00 11.9 mm short lever              T05 17.4 mm short lever              T07 19.4 mm short lever              T13 25.5 mm lever              T19 33.3 mm lever              T28 40.7 mm lever              T43 55.9 mm lever              S26 18.6 mm simulated lever              A05 17.2 mm lever roller</p>											
<p><b>Terminations</b></p> <p>S Solder              Q 0.110 Quick Connect              P PC Thru Hole              W Wire leads potted              Z Wire leads non-potted</p>											
<p><b>Wire Type AWG</b></p> <p>20 20 AWG              22 22 AWG              24 24 AWG              26 26 AWG              28 28 AWG              30 30 AWG</p>											
<p><b>Wire UL # (when required)</b></p> <p>A UL1007              B UL1015              C UL1430              D UL1061              E UL1330</p>											
<p><b>Wire Side (when required)</b></p> <p>A Wire out the bottom              B Wire out the right side              C Wire out the left side              D None</p>											
<p><b>Circuitry</b></p> <p>C SPDT              W SPST N.C.              Y SPST N.O.</p>											



# LCS Series Subminiature Sealed Snap-acting Switches

## SERIES

### LCS

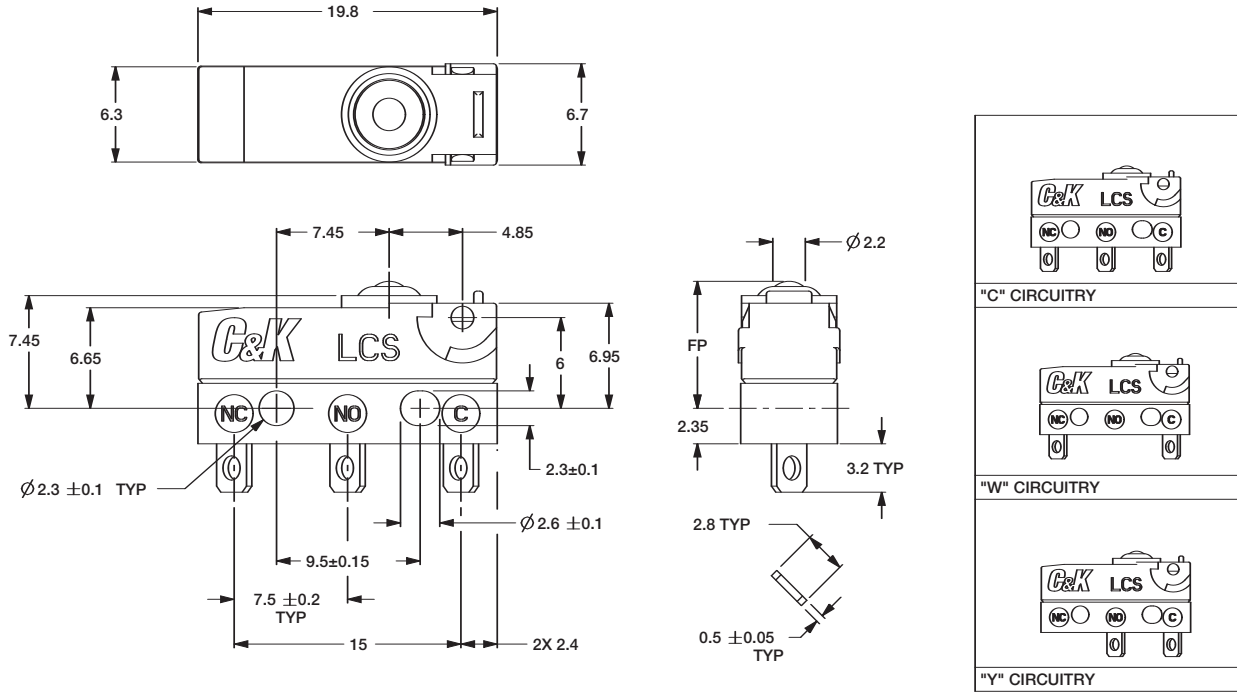

## ELECTRICAL RATING

RoHS COMPLIANT *	RoHS COMPATIBLE *	OPTION CODE	ELECTRICAL RATING
YES	YES	<b>05</b>	5 AMP, 125/250 V AC
YES	YES	<b>01</b>	0.1 AMP, 125/250 V AC

## OPERATING FORCE

OPTION CODE	OPERATING FORCES (grams)
<b>1</b>	150 g. max.
<b>2</b>	203 g. max.

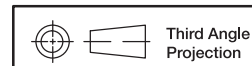

Third Angle Projection

Dimensions are shown: mm  
Specifications and dimensions subject to change



Snap-acting

# LCS Series Subminiature Sealed Snap-acting Switches

ACTUATOR

**P00**

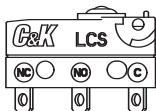

**T19**

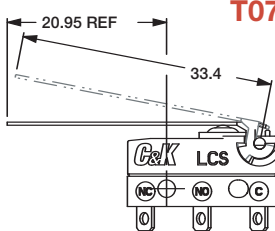

**T07**

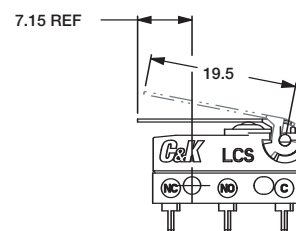

**A05**

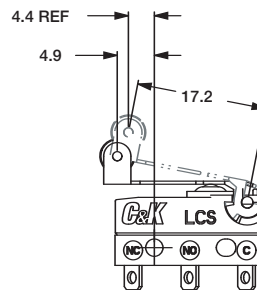

**T00**

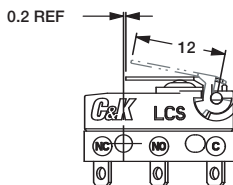

**T28**

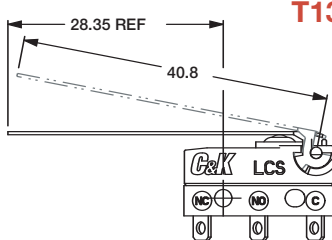

**T13**

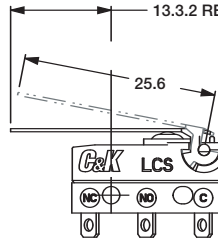

**S26**

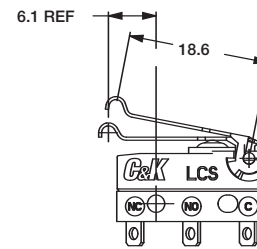

**T05**

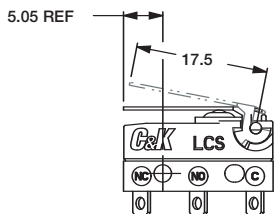

**T43**

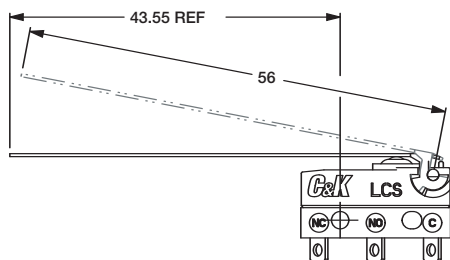

Snap-acting

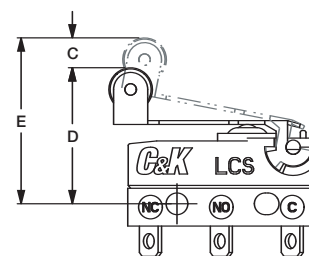
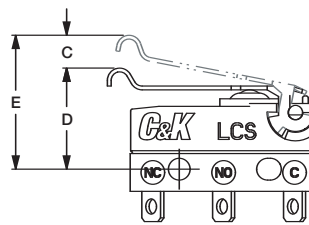
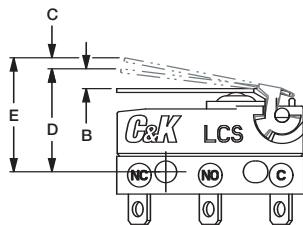
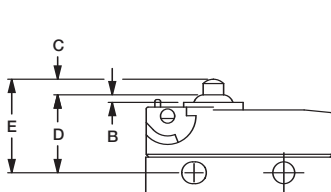

ACTUATOR OPTION CODE	A LENGTH OF LEVER	B OVER TRAVEL (MIN)	C PRE TRAVEL (MAX)	D OPERATING POSITION	E FREE POSITION (MAX)	DIFFERENTIAL MOTION (MAX)		OPERATING FORCE (MIN)		RELEASE FORCE (MIN)	
						150	203	150	203	150	203
P00	N/A	0.6	1.2	8.4 ± 3	9.9	0.2	0.2	150	203	30	50
T00	11.9	0.6	3.2	8.8 ± 9	11.1	0.5	0.5	66	98	10	21
T05	17.40	0.9	4.3	8.8 ± 1.1	12	0.6	0.6	73	82	14	16
T07	19.40	1	4.8	8.8 ± 1.2	12.4	0.7	0.7	55	66	11	13
T13	25.5	1.6	6.3	8.8 ± 1.6	13.5	0.9	0.9	29	54	6	11
T19	33.3	1.95	8	8.8 ± 2.0	15	1.75	1.75	32	40	2	5
T28	40.7	2.1	10.1	8.8 ± 2.6	16.3	2.3	2.3	33	39	1	8
T43	55.9	2.9	13.8	8.8 ± 3.5	19.1	3.6	3.6	23	33	1	7
S26	18.6	1	4.6	10.7 ± 1.2	14.1	0.65	0.65	42	68	7	14
A05	17.20	0.9	4.3	14.5 ± 1.1	17.7	0.6	0.6	60	72	12	15



Third Angle  
Projection

Dimensions are shown: mm  
Specifications and dimensions subject to change



# LCS Series Subminiature Sealed Snap-acting Switches

## TERMINATIONS

### S SOLDER

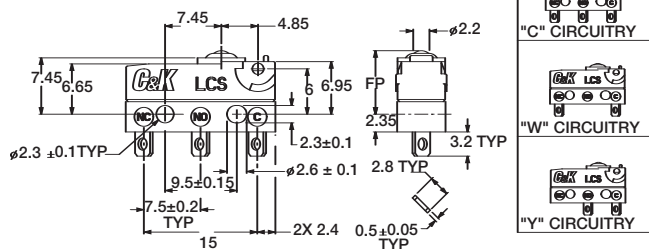

### Q QUICK CONNECT 2.8mm / 0.110"

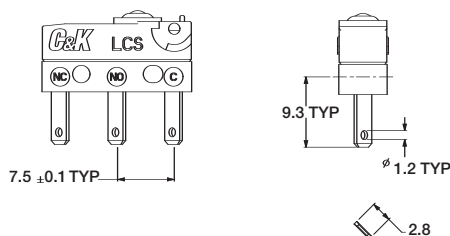

### P PC THRU HOLE

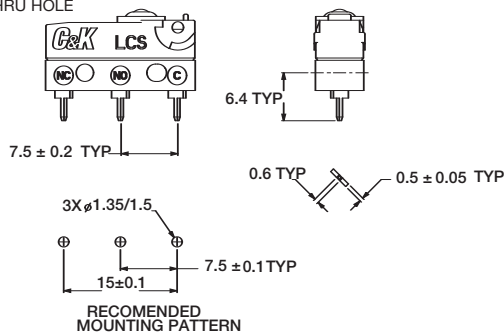

### Z or W "A" WIRE ORIENTATION

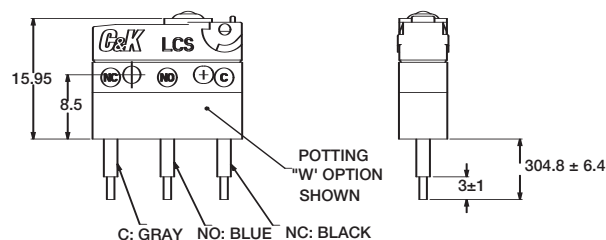

### Z or W "B" WIRE ORIENTATION "Y" OR "W" CIRCUITRY

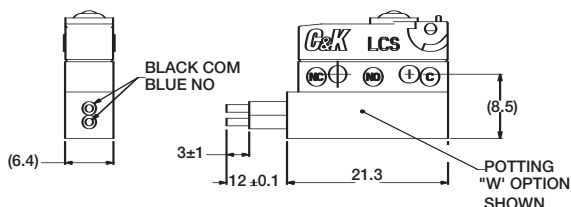

### Z or W "C" WIRE ORIENTATION "Y" OR "W" CIRCUITRY

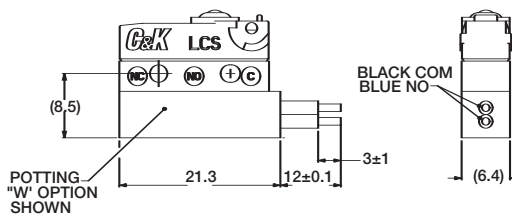

### Z or W "B" WIRE ORIENTATION "C" CIRCUITRY

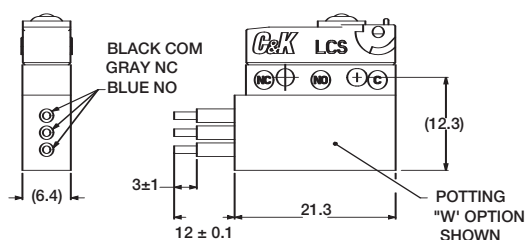

### Z or W "C" WIRE ORIENTATION "C" CIRCUITRY

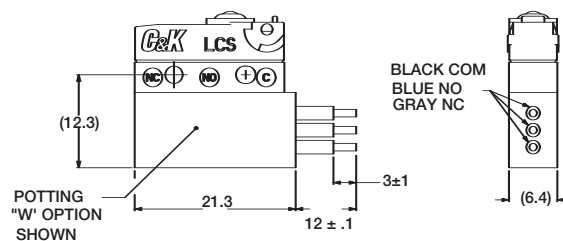

Snap-acting

## CIRCUITRY

- C** SPDT (Single Pole, Double Throw)
- W** SPST N.C. (Single Pole, Single Throw, Normally Closed)
- Y** SPST N.O. (Single Pole, Single Throw, Normally Open)



Third Angle  
Projection

Dimensions are shown: mm  
Specifications and dimensions subject to change

