

FP Series Sealed Ultra Miniature Pushbutton Switches



A

Pushbutton

Features/Benefits

- Vertical and right angle mount
- Extended operating life 50,000 cycles
- Optional caps
- Sealed against soldering and cleaning processes
- RoHS compliant

Typical Applications

- Networking equipment
- Modems
- Reset functions
- Instrumentation

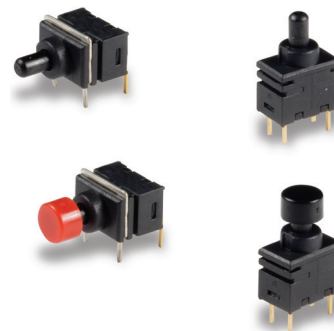

Specifications

CONTACT RATING: Max. 0.4 VA (28 V DC or V AC).

ELECTRICAL LIFE: 50,000 cycles.

CONTACT RESISTANCE: (10mA @ 2 V DC) 80 mΩ/105 max. initial.

INSULATION RESISTANCE: 500MΩ 105min. @ 500 V DC - 1 minute.

OPERATING TEMPERATURE: -20°105C to 80°105C.

SOLDERABILITY: Per MIL-STD-202F method 208D, or

EIA RS-186E method 9.

PACKAGING:

Tray pack - 100 switches per tray.

Caps (optional) - Bulk bag; 100 caps per bag.

Materials

MOVABLE CONTACTS:

Base metal: Phosphor bronze

Plating: Gold over nickel plate

FIXED CONTACTS:

Base metal: Brass

Plating: Gold over nickel plate

COVER: PA66 - Black

ACTUATOR: PPS - Black

BASE: PPS - Black

SUPPORT BRACKET (A1 Terminal Style only): Steel with tin plate

NOTE: Specifications and materials listed above are for switches with standard options. For information on specific and custom switches, consult Customer Service Center.

Build-A-Switch

To order, simply select desired option from each category and place in the appropriate box. Available options are shown and described on pages A-106 thru A-107. For additional options not shown in catalog, consult Customer Service Center.

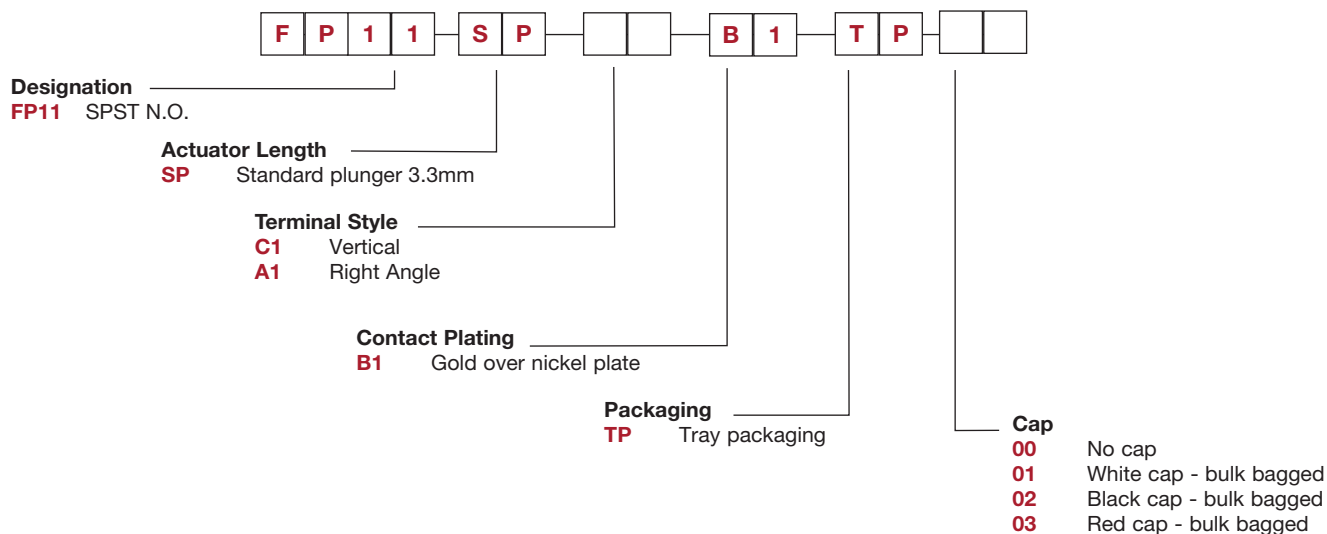

Dimensions are shown: Inches (mm)
Specifications and dimensions subject to change



FP Series Sealed Ultra Miniature Pushbutton Switches

SWITCH FUNCTION

Pushbutton

C1 VERTICAL

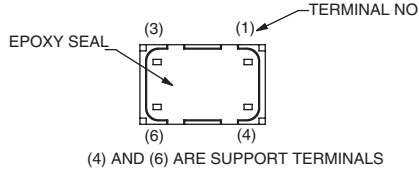
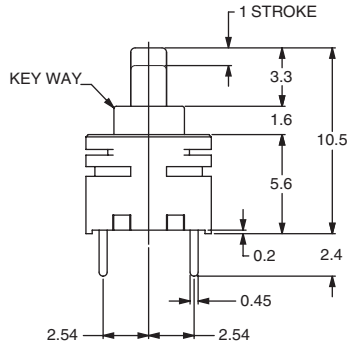
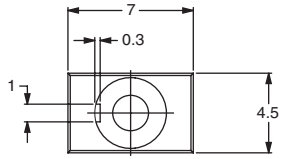

A1 RIGHT ANGLE

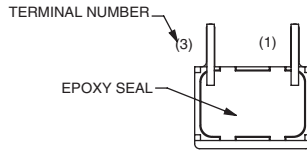
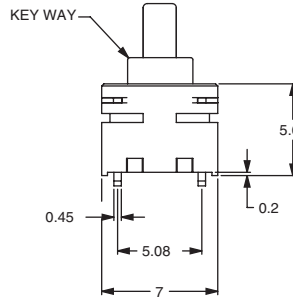
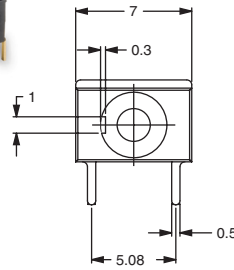

MODEL NO.	SWITCH FUNCTION	
	POS. 1	POS. 2
FP11	OFF	MOM
	CONNECTED TERMINALS	
	OPEN	1-3

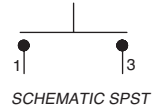

ACTUATOR LENGTH

SP STANDARD PLUNGER 3.3MM

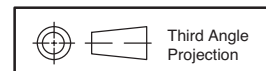
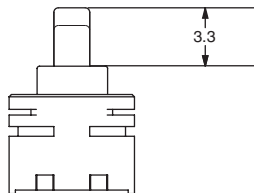

Dimensions are shown: mm
Specifications and dimensions subject to change



FP Series Sealed Ultra Miniature Pushbutton Switches



A

Pushbutton

TERMINAL STYLE

C1 VERTICAL

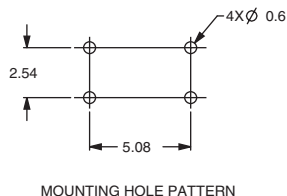
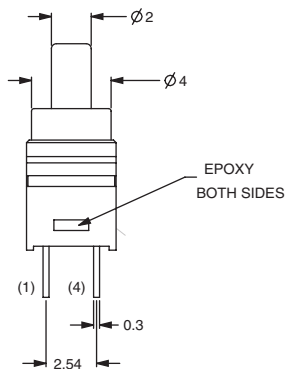

A1 RIGHT ANGLE

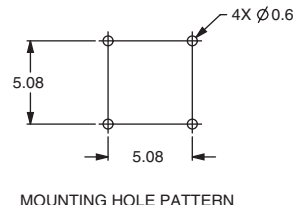
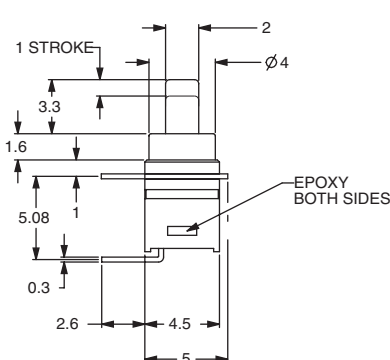

CONTACT PLATING

B1 GOLD OVER NICKEL PLATE

PACKAGING

TP TRAY PACKAGING

CAPS

OPTION CODE	DESCRIPTION
00	NO CAP
01	WHITE CAP, BULK BAGGED
02	BLACK CAP, BULK BAGGED
03	RED CAP, BULK BAGGED

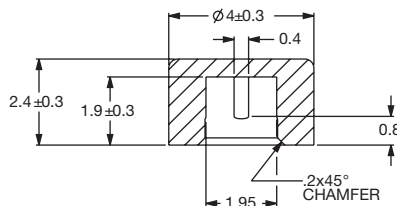

To purchase Caps separately without switch, please use these part numbers

PART #	COLOR
798D01000	WHITE
798D02000	BLACK
798D03000	RED

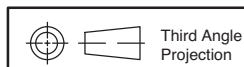

Dimensions are shown: mm
Specifications and dimensions subject to change

