

REV	DESCRIPTION	DATE	DWN	APVD
B	REVISED PER ECO-14-014293	20SEP2014	NK	RH

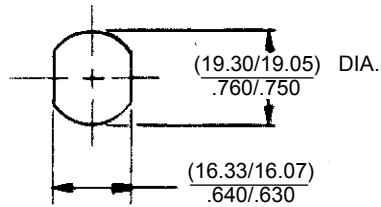

PANEL CUTOUT

SPECIFICATIONS:

CONTACT RATING:
SILVER - 3A @ 125 VAC OR 28 VDC (RESISTIVE)
GOLD PLATING - 0.4 VA MAX @ 20 VDC OR PEAK AC.

CONTACT RESISTANCE:
SILVER - 10 MILLIOHMS MAX.
GOLD PLATING - 20 MILLIOHMS MAX.

INSULATION RESISTANCE:
SILVER - 1000 MEGOHMS MIN.
GOLD PLATING - 1000 MEGOHMS MIN. @ 500 VDC

DIELECTRIC STRENGTH: 1000 VOLTS RMS @ SEA LEVEL.

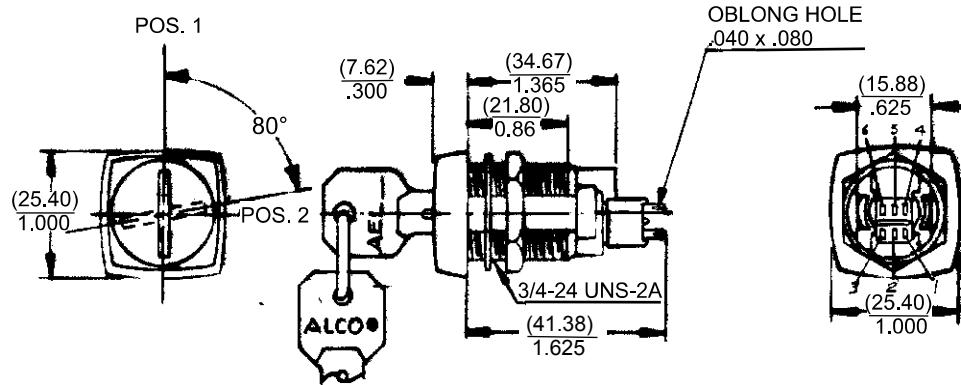

2 TO 3 5 TO 6	2 TO 1 5 TO 4	GOLD OVER NICKEL	POSITION 1 AND 2	SKT332GAEL01
2 TO 3 5 TO 6	2 TO 1 5 TO 4	SOLID SILVER	POSITION 1 AND 2	SKT331GAEL01
2 TO 3 5 TO 6	2 TO 1 5 TO 4	GOLD OVER NICKEL	POSITION 1 ONLY	SKT332AEL01
2 TO 3 5 TO 6	2 TO 1 5 TO 4	SOLID SILVER	POSITION 1 ONLY	SKT331AEL01
POS 2	POS 1	SWITCH CONTACTS	REMOVE KEY IN:	DESCRIPTIVE PART NUMBER
TERMINALS CONNECTED WHEN KEYS IS IN:				

TOLERANCES UNLESS NOTED:
±.010 IN ±0.25 MM ±5° ANGLE

TITLE
KEY LOCK SWITCH SKT-13 SERIES

STE TE Connectivity

DWG. NO. C-1437598-9

SHEET OF REV B