

THIS DRAWING IS UNPUBLISHED.
 © copyright - By - - - - -
 RELEASED FOR PUBLICATION
 ALL RIGHTS RESERVED.

WHEN ORDERING CONTACT ON TAPE, ORDER BY THE TAPE NUMBER PLUS THE PACKAGING CODE AS FOLLOWS:

- 2. FOR USE WITH AMP TAPETRONIC, PNEUMATIC TOOL-
 - A. 1000 PARTS TO A BOX ADD PACKAGING CODE: 1MBOX
- 3. FOR USE WITH 4/8 INDENT STRIPPER CRIMP-
 - A. 1000 PARTS TO A REEL ADD PACKAGING CODE: 1MREEL
 - B. 5000 PARTS TO A REEL ADD PACKAGING CODE: 5MREEL

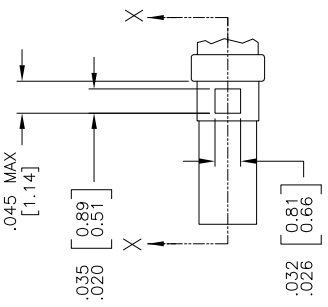
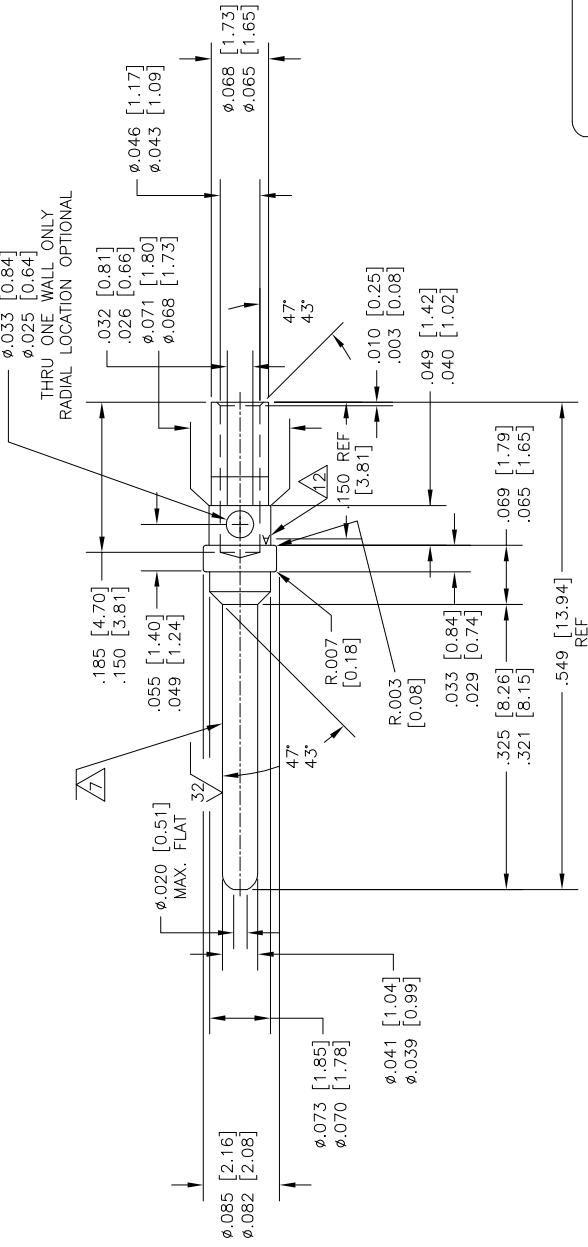

INSPECTION WINDOW
OPTIONAL DESIGN

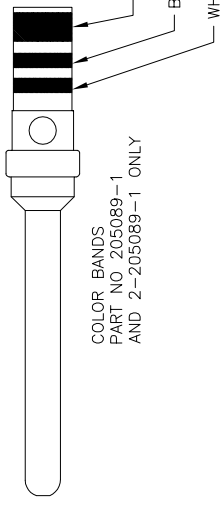
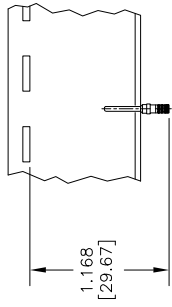

COLOR BANDS
 PART NO. 205089-1
 AND 2-205089-2 ONLY

REVISIONS		
P	TR	DATE
AA	REV PER ECO 17-005913	5-2-17

- 1 MATERIAL: COPPER ALLOY PER MIL-C-39029 & MIL-DTL-24308.
- 2 ALL DIMENSIONS APPLY AFTER PLATING.
- 3 ---
- 4 ALL DIAMETERS CONCENTRIC WITH EACH OTHER WITHIN .004 T.I.R.
- 5 PIN MATES WITH SOCKET 205090 (AS 39029/63).
- 6 ALL SURFACES HAVE $\sqrt{63}$ OR BETTER FINISH, UNLESS SHOWN.
- 7 POINT OF PLATING MEASUREMENT .188 [4.78] FROM TIP OF PIN.
- 8 PLATING: GOLD PER ASTM-B-488 (TYPE II) OVER NICKEL PER AMS-QQ-N-290.
- 9 PLATING: GOLD PER ASTM-B-488 (TYPE II) OVER COPPER PER MIL-C-14550, CLASS 4.
- 10 PLATING: GOLD PER ASTM-B-488 (TYPE II, CLASS 0) OVER NICKEL PER AMS-QQ-N-290.
- 11 PLATING:
 - MATING AREA: GOLD PER ASTM-B-488 (TYPE II) OVER NICKEL PER AMS-QQ-N-290.
 - NON MATING AREA: GOLD PER ASTM-B-488 OVER NICKEL PER AMS-QQ-N-290.
- 12 MANUFACTURER'S LOGO ("A" OR ".") LOCATION OPTIONAL
- 13 CONTACTS QUALIFIED TO AS39029/64-369
- 14 CONTACTS QUALIFIED TO GSFC-S-311-P-4/10, NASA P/N G-10-P1
- 15 RESTRICTED PART NUMBER.
- 16 CONTACTS MUST MEET DIMENSIONAL & PERFORMANCE REQUIREMENTS OF GSFC-S-311-P-4/08, NASA P/N G-10-P1 & 100% RESIDUAL MAGNETISM.

THIS DRAWING IS A CONTROLLED DOCUMENT.		DRAWN: KAISER		25062003	
DIMENSIONS: INCHES (mm)		CHECKED: MILLER		10-13-03	
TOLERANCES UNLESS OTHERWISE SPECIFIED:		DESIGNED: MILLER		10-13-03	
0 P/LC	±	PRODUCT SPEC:			
1 P/LC	±	APPLICATION SPEC:			
2 P/LC	±	WEIGHT:		0.000000	
3 P/LC	±	CUSTOMER DRAWING:		AZ 00779	
ANGLES	±	SCALE:		10:1	
FINISH	±	SHEET:		1 of 1	
MATERIAL: 1		RESTRICTED TO:		---	
		REV:		AA	



TE Connectivity
 PIN SIZE 20 CONTACT,
 AMPLIMITE